

# BUILDING 38 (DUPLEX)

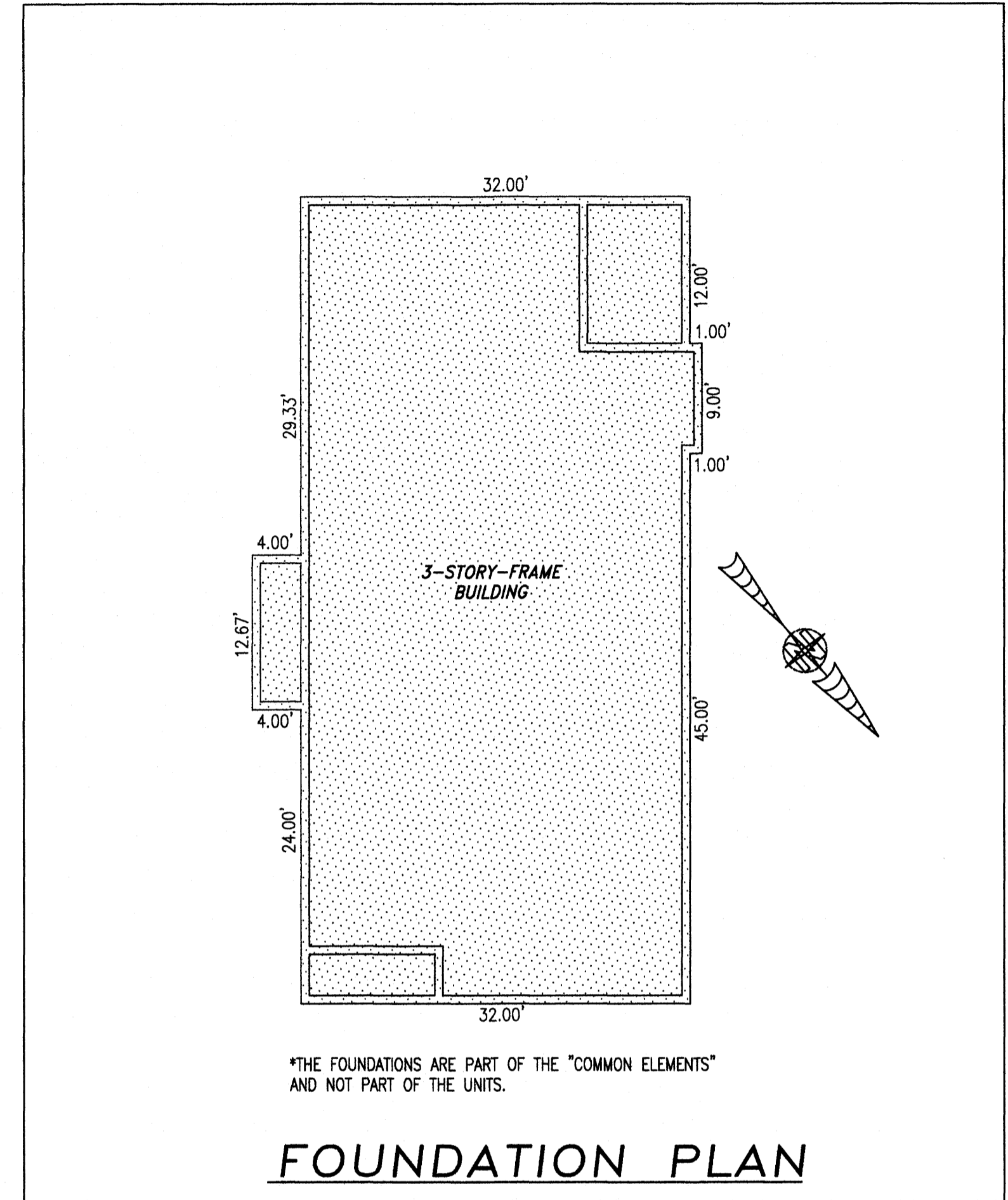

## FOUNDATION PLAN

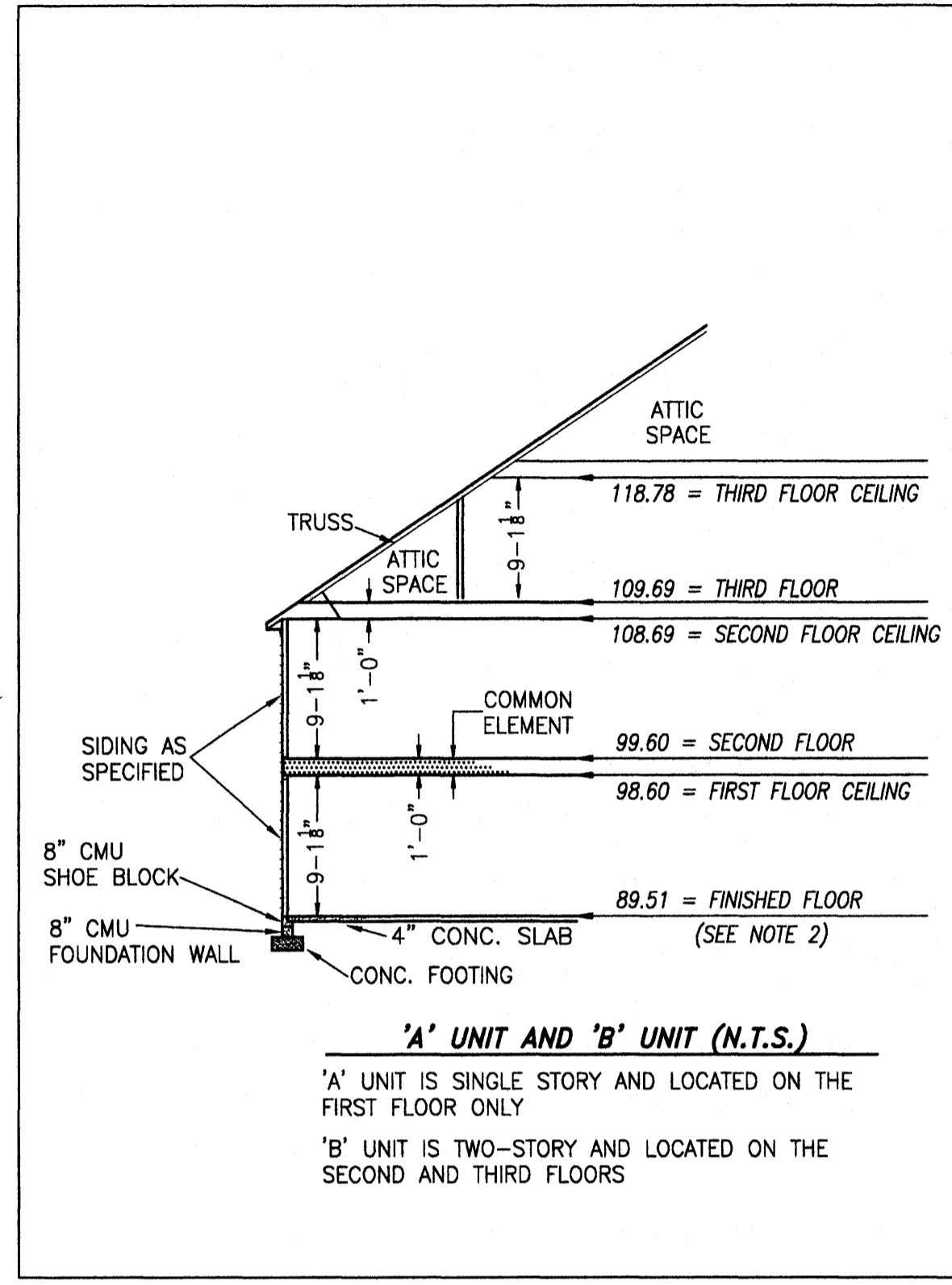

## TYPICAL BUILDING SECTION

NOT TO SCALE (N.T.S.)

### NOTES:

1. VERTICAL DATUM REFERENCE: NATIONAL GEODETIC VERTICAL DATUM OF 1929 (NGVD29).
2. FINISHED FLOOR ELEVATION SHOWN WAS TAKEN FROM AS-BUILT SURVEY OF BUILDING #38 (DUPLEX) THE PROMENADE AT JOHN TYLER BY HAYDEN FRYE AND ASSOCIATES. FIELD WORK WAS PERFORMED ON 07-20-21.

I HEREBY CERTIFY THAT THIS PLAT IS ACCURATE AND THAT IT COMPLIES WITH THE PROVISIONS OF THE CODE OF VIRGINIA OF 1950 AS AMENDED, § 55.1-1920A & B AND I FURTHER CERTIFY THAT ALL IMPROVEMENTS THEREOF DEPICTED HEREON, PURSUANT TO THE CODE OF VIRGINIA § 55.1-1920B, ARE SUBSTANTIALLY COMPLETE.

5 Large/Small Plat(s) Recorded  
 herewith as # 210016359

City of Williamsburg & County of James City  
 Circuit Court: This PLAT was recorded on  
 August 10, 2021  
 at 2:50 AM/PM PB PG  
 Document # 210016359  
 MONA A. FOLEY, CLERK  
 Clerk

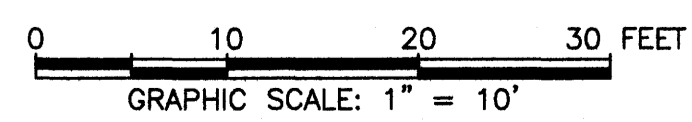

-INDICATES COMMON ELEMENT

THIS SHEET: FOUNDATION PLAN AND SECTION

**PHASE 38**  
**CONDOMINIUM PLAT AND PLAN**  
 OF  
**THE PROMENADE**  
 AT  
**JOHN TYLER**  
 A CONDOMINIUM  
 JAMES CITY COUNTY, VIRGINIA

Hayden Frye and Associates, Inc.  
**Land Surveyors**  
 333 KELLAM ROAD, SUITE 200  
 VIRGINIA BEACH, VA, 23462  
 PH: (757) 491-7228 FX: (757) 491-7229

DATE: JULY 29, 2021  
 SCALE: 1"=10'  
 SHEET 4 OF 5 THIS PHASE

