

PROJECT MANAGER Mr. Wali Zaman, PE - VDOT Hampton Roads District - (757) 956-3272
SURVEYED BY, DATE Dewberry Engineers Inc., 03/2020
DESIGNED BY, Dewberry Engineers Inc. - (804) 205-3340
SUBSURFACE UTILITY BY, Accumark, 04/2020

REVISED	STATE	ROUTE	STATE PROJECT	SHEET NO.
	VA.	60	0060-047-627 R-201 C-501	3A

DESIGN FEATURES RELATING TO CONSTRUCTION OR TO REGULATION AND CONTROL OF TRAFFIC MAY BE SUBJECT TO CHANGE AS DEEMED NECESSARY BY THE DEPARTMENT

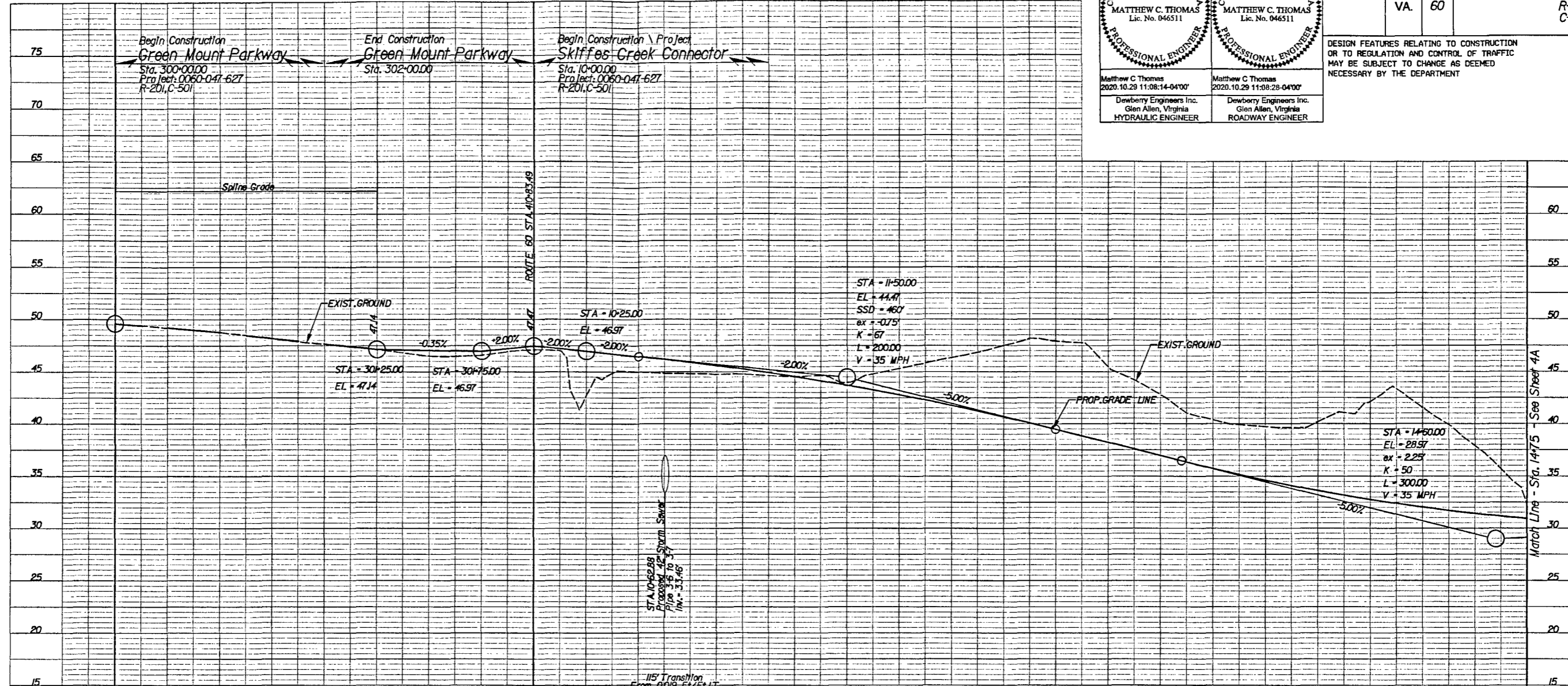

RT E/P (1/2' OFFSET)	PGL EXIST.	LT E/P (24' OFFSET)
	49.59	
	49.59	
	49.21	49.05 (1378')
	49.21	
	48.78	48.55 (1595')
	48.78	
	48.18	47.96 (1813')
	48.18	
	47.66	47.46 (2030')
	47.66	
	47.14	
	47.14	
	46.06	
	46.51	
	46.97	
	46.59	
	47.47	
	47.11	
	46.97	
	42.70	
	46.47	
	45.02	
	45.92	
	44.84	
	45.28	44.94
	44.77	
	44.55	44.07
	44.52	
	43.44	43.24
	43.94	
	42.56	42.32
	45.34	
	41.54	41.30
	46.36	
	40.67	40.19
	47.52	
	39.47	38.99
	47.93	
	38.22	37.74
	45.50	
	36.97	36.49
	42.80	
	35.74	35.26
	40.37	
	34.63	34.15
	39.71	
	33.64	33.19
	40.07	(2256')
	32.78	32.36
	42.15	(2106')
	32.04	31.65
	41.54	(1956')
	31.43	31.07
	37.91	(1806')
	30.94	30.61
	32.28	(1656')

RWV Self Storage II LLC
 Instrument 210015055
 7/23/2021
 State Hwy Plat Book 11 Page 22