

GENERAL NOTES:

1. Plan Sheet Is Intended For Acquisition Only And Does Not Constitute A Boundary Survey.
2. Property Line Information Is Based on Highway Plans,Plats And Deeds Of Record. Limited Field Work Was Performed For The Creation Of This Sketch.
3. Sketch Was Prepared Without The Benefit Of A Title Report, Consequently Not All Encumbrances May Be Depicted.
4. This Sketch Was Forwarded Electronically In "Read Only" Format. Any Attempt At Alteration Invalidates The Seal And Signature. An Original Hard Copy Remains On File At The Virginia Department Of Transportation, Hampton Roads District Office.
5. This Survey Datum Based On NAD 83 (NSRS 2011)



001

#8725
MARY K SCHUSZLER
 Inst.# 020012531
 1.16 AC.
 TAX MAP# 1210100011

002

#8733
JAMES W DEAL
DENISE A DEAL
 Inst.# 980019276
 PLAT DB 139 PG 480
 1.051 AC.
 TAX MAP# 1210100010

Proposed 10' Temporary Construction Easement 2, 040 Sq. Ft. / 0.046 Ac.

Proposed 20' Temporary Access Easement 4,924 Sq. Ft. / 0.113 Ac.
 Proposed 10' Temporary Construction Easement 2, 087 Sq. Ft. / 0.047 Ac.

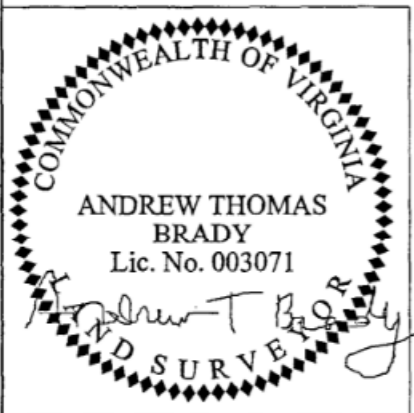
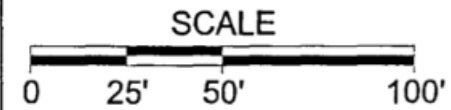

Off Rev EBL
 $\Delta = 22^\circ 16' \text{ Rt}$
 $D = 3.55439^\circ$
 $T = 317.23'$
 $L = 626.46'$
 $R = 1611.97'$
 $PC 609+64.67$
 $PI 612+81.90$
 $PT 615+91.13$

- LEGEND
- Computed Point
 - Iron Pipe (Found)
 - R/W Monument

04/24/21

VDOT Location and Design
 Suffolk, Virginia
 LAND SURVEYOR

Alignment Based On Plans:
 0030-047-101,C501,PE101,RW101

COMMONWEALTH OF VIRGINIA
DEPARTMENT OF TRANSPORTATION
SKETCH SHOWING PROPOSED 20' TEMPORARY
ACCESS EASEMENT AND PROPOSED 10'
TEMPORARY CONSTRUCTION EASEMENTS
FOR EXISTING DITCH MAINTENANCE



Andrew T. Brady, LS
 Hampton Roads District
 1700 North Main Street
 Suffolk, VA 23434
 (757) 925-2661

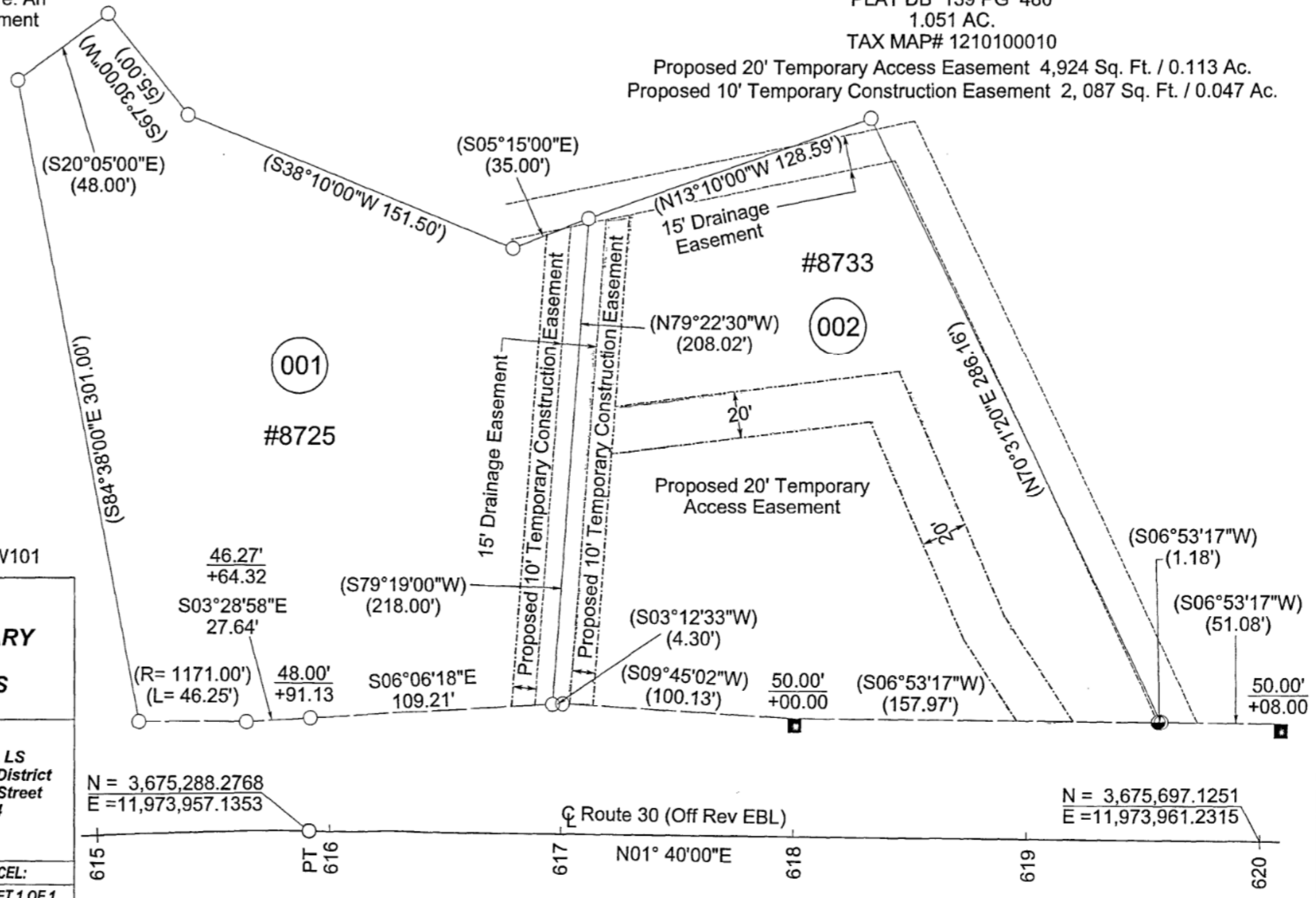

UPC: 115806	PROJECT:	DRAWN BY: JEP	PARCEL:
SCALE: 1" = 50'	DATE: December 14, 2020	CHECKED BY: ATB	SHEET 1 OF 1

Deal, James W. Instrument 210014494 07/19/2021 State Highway Plat Book 11 Page 19