



PROJECT MANAGER Mr. Wolf Zeman, PE - VDOT Hampton Roads District - (757) 956-3272  
 SURVEYED BY DATE Dewberry Engineers Inc., 03/2020  
 DESIGNED BY Dewberry Engineers Inc. - (804) 205-3340  
 SUBSURFACE UTILITY BY Accurmark, 04/2020

Matthew C. Thomas 2021.03.25 10:38:22-04'00"	Matthew C. Thomas 2021.03.25 10:38:51-04'00"
Dewberry Engineers Inc. Glen Allen, Virginia HYDRAULIC ENGINEER	Dewberry Engineers Inc. Glen Allen, Virginia ROADWAY ENGINEER

REVISED	STATE	ROUTE	PROJECT	SHEET NO.
03/24/21	VA.	60	0060-047-627 R-201 C-501	14

DESIGN FEATURES RELATING TO CONSTRUCTION OR TO REGULATION AND CONTROL OF TRAFFIC MAY BE SUBJECT TO CHANGE AS DEEMED NECESSARY BY THE DEPARTMENT

Stiffes-Rte143 NW Elevations (F1)	Stiffes-Rte143 NE Elevations (F1)
A 58.71	F 58.25
B 58.47	G 58.24
C 58.05	H 58.01
D 57.20	I 57.68
E 56.59	J 57.11

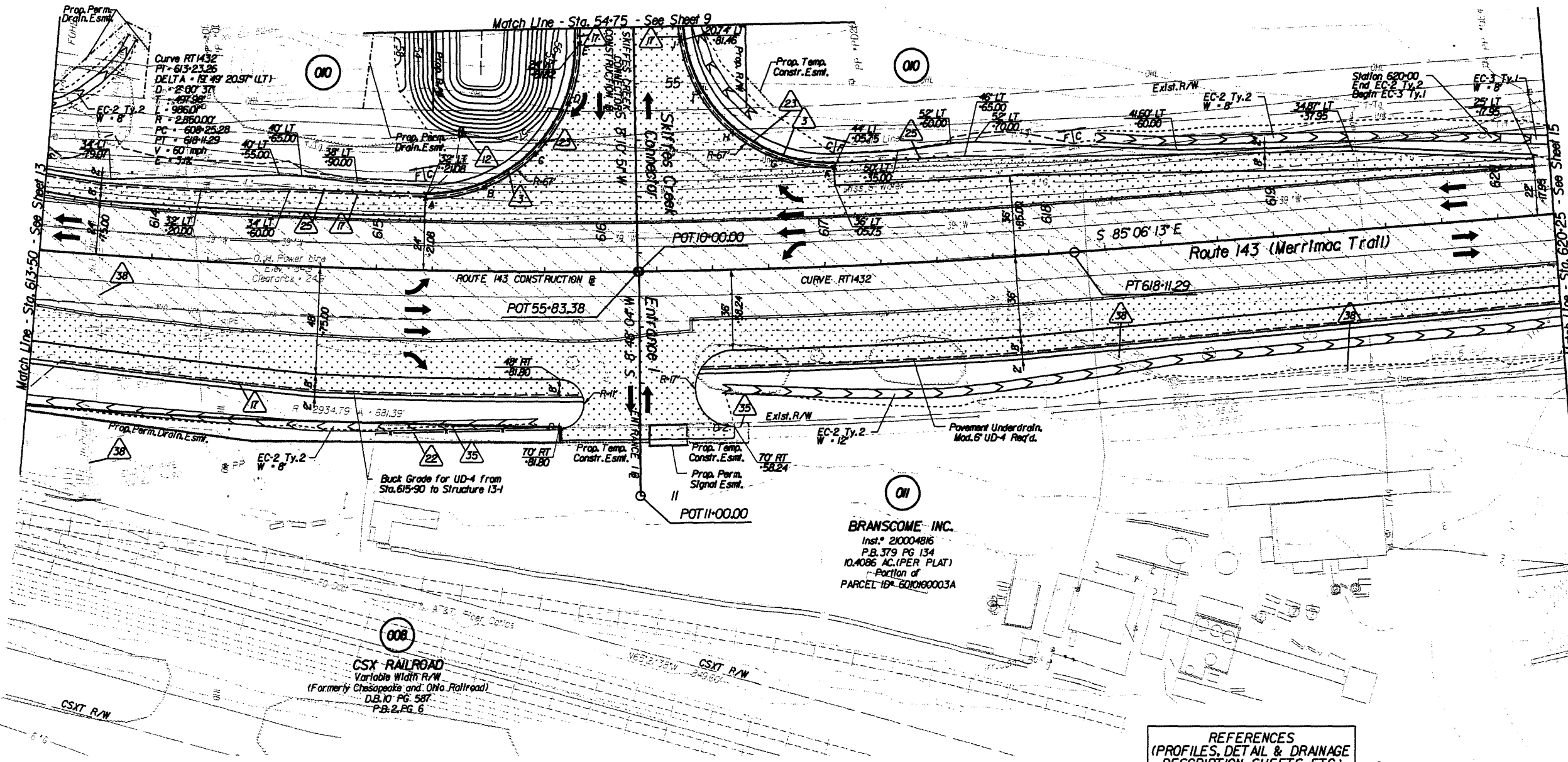

BRANSCOME INC.  
Inst. # 210004816  
P.B. 379 PG 134  
10.4086 AC. (PER PLAT)  
-Portion of  
PARCEL ID# 601060003A

CSX RAILROAD  
Variable Width R/W  
(Formerly Chesapeake and Ohio Railroad)  
D.B. 10 PG. 587  
P.B. 2, PG. 6

- Key Legend (XX)
- 6' Curb, Sfd, CG-2 Req'd.
  - 4' Curb, Sfd, CG-3 Req'd.
  - 4' Curb and Gutter, Sfd, CG-6 Req'd.
  - 4' Curb and Gutter, Sfd, CG-7 Req'd.
  - Conc. Raised Median, Sfd, MS-1 Req'd.
  - Conc. Raised Median, Sfd, MS-1A Req'd.
  - Grass Raised Median, Sfd, MS-2 Req'd.
  - Entrance Gutter, Sfd, CG-90 Req'd.
  - Entrance Gutter, Sfd, CG-90 Req'd.
  - Entrance Sfd, CG-11 Req'd.
  - Curb Ramp, Sfd, CG-12 Req'd.
  - Underdrain Endwall, Sfd, EW-12 Req'd.
  - Abandon Pipe, Sfd, AP-1 Req'd.
  - Groundwater Underdrain, Sfd, UD-1 Req'd.
  - Median Underdrain, Sfd, UD-2 Req'd.
  - Sidewalk Underdrain, Sfd, UD-3 Req'd.
  - Pavement Underdrain, Sfd, UD-4 Req'd.
  - Crossdrain, Sfd, CD-1 Req'd.
  - Crossdrain, Sfd, CD-2 Req'd.
  - Handrail, Sfd, HR-1 Type II Req'd.
  - Barbed Wire Fence, Sfd, FE-B Req'd.
  - Chain Link Fence, Sfd, FE-CL Req'd.
  - Guardrail, Sfd, GR-MGS1 Req'd.
  - Guardrail, Sfd, GR-MGS1A Req'd.
  - Guardrail Terminal, Sfd, GR-MGS2 Req'd.
  - Guardrail, Sfd, GR-10, 3' Height, Type I Req'd.
  - Guardrail, Sfd, GR-10, 3' Height, Type II Req'd.
  - Guardrail, Sfd, GR-10, 3' Height, Type III Req'd.
  - Trailing End Terminal, Sfd, GR-LES-3 Req'd.
  - Fixed Object Mt., Sfd, GR-FOA-5 Req'd.
  - Fixed Object Mt., Sfd, GR-FOA-2 Req'd.
  - Guardrail, Sfd, GR-MGS4
  - Bridge Pier Protection, Sfd, BPPS-1
  - Remove Exst. Guardrail
  - Remove Exst. Fence
  - Remove Exst. Structure
  - Remove Exst. Pipe
  - Abandon and Plug Exst. Pipe
  - Adjust Exst. Structure
  - Clean Out Exst. Structure
  - Clean Out Exst. Pipe
  - Full Depth Sawcut
  - 6' Curb and Dry Gutter, Mod. CG-5 Req'd.
  - Conc. Median Barrier, Sfd, MB-7F Req'd.

- Denotes Full Depth Pavement
- Denotes Guardrail Bumpout Pavement Section
- Denotes Pavement Demolition
- Denotes Mill & Variable Depth Overlay
- Denotes Milling and Overlay
- Denotes Construction Limits In Cuts
- Denotes Construction Limits In Fills

REFERENCES  
(PROFILES, DETAIL & DRAINAGE DESCRIPTION SHEETS, ETC.)

Alignment Data	1G
ESC Phase 1	2D series
ESC Phase 2	2E series
ESC Phase 3	2F series
Stiffes Creek Profile	9A
Merrimac Trail Profile	14A
Entrance I Profile	15A
Right-of-Way Plan	14RW

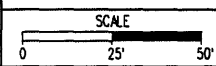

PROJECT	0060-047-627	SHEET NO.	14
---------	--------------	-----------	----