

210008803

BUILDING 56 (10-PLEX)

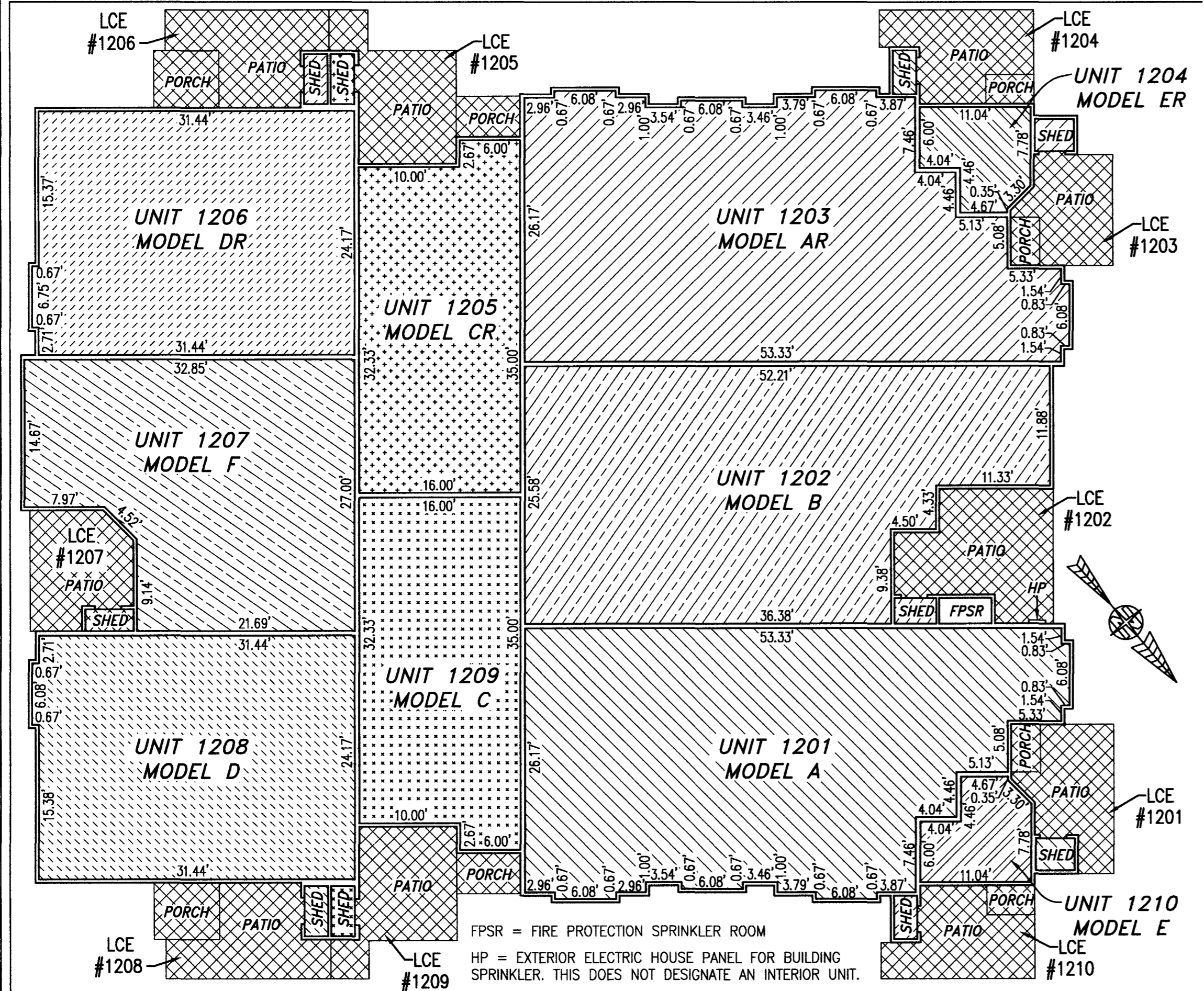

FIRST FLOOR

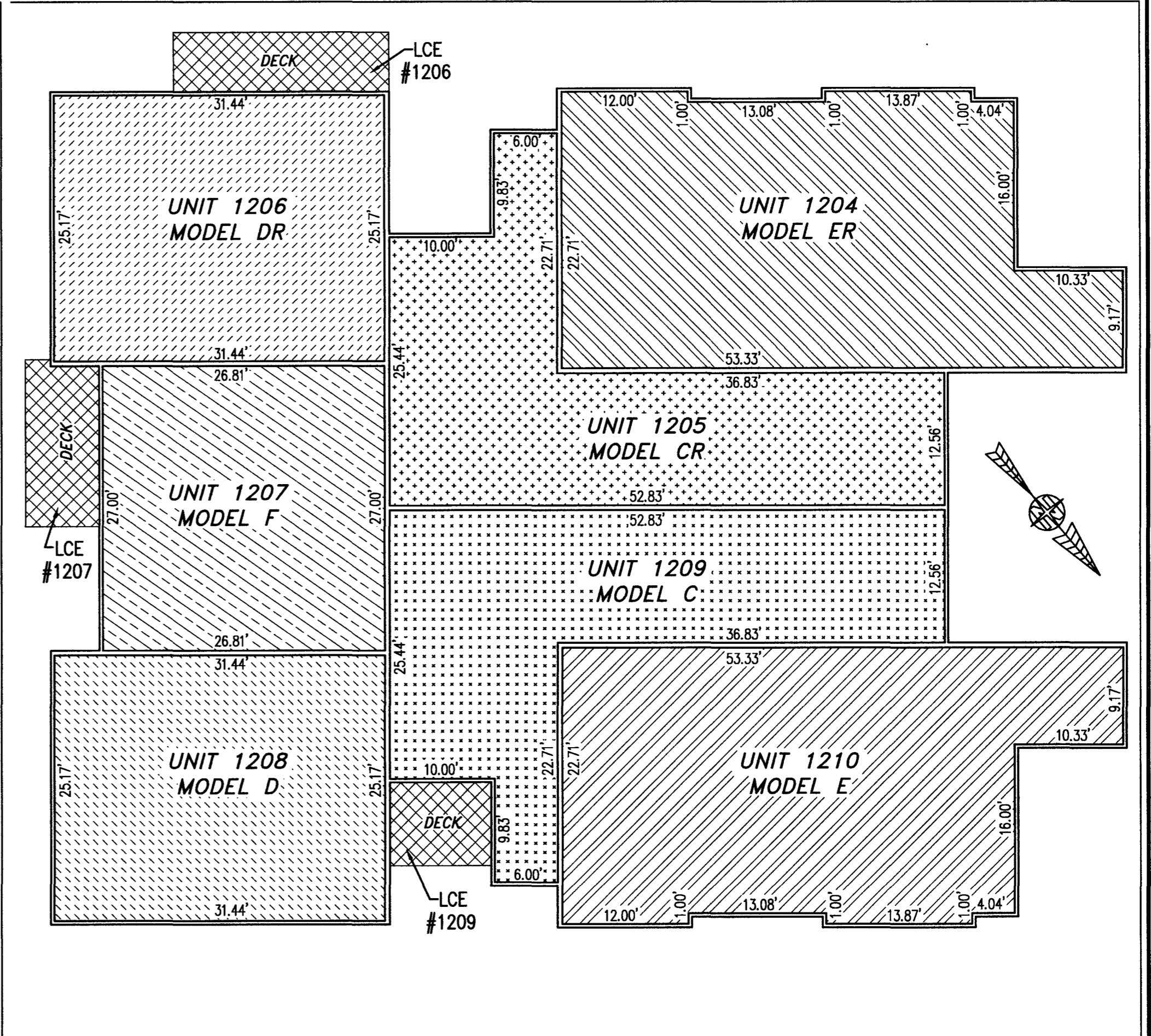

SECOND FLOOR

UNIT ID	UNIT DESCRIPTION	UNIT ADDRESS	PARKING SPACE
A	-INDICATES AREA OF UNIT 1201	#1201 KING'S LAND CT.	311
B	-INDICATES AREA OF UNIT 1202	#1202 KING'S LAND CT.	310
AR	-INDICATES AREA OF UNIT 1203	#1203 KING'S LAND CT.	308
ER	-INDICATES AREA OF UNIT 1204	#1204 KING'S LAND CT.	325
CR	-INDICATES AREA OF UNIT 1205	#1205 KING'S LAND CT.	326
DR	-INDICATES AREA OF UNIT 1206	#1206 KING'S LAND CT.	328
F	-INDICATES AREA OF UNIT 1207	#1207 KING'S LAND CT.	329
D	-INDICATES AREA OF UNIT 1208	#1208 KING'S LAND CT.	330
C	-INDICATES AREA OF UNIT 1209	#1209 KING'S LAND CT.	315
E	-INDICATES AREA OF UNIT 1210	#1210 KING'S LAND CT.	314
HP	HOUSE PANEL (ELECTRIC)	#1211 KING'S LAND CT.	N/A
FPSR	FIRE PROTECTION SPRINKLER ROOM	#1212 KING'S LAND CT.	N/A
	-INDICATES COMMON ELEMENT (EXCLUDING AREAS OUTSIDE OF SUBMITTED LAND)		
	-INDICATES LIMITED COMMON ELEMENT (LCE) ASSIGNED TO A UNIT. # UNIT ASSIGNED		

I HEREBY CERTIFY THAT THIS PLAT IS ACCURATE AND THAT IT COMPLIES WITH THE PROVISIONS OF THE CODE OF VIRGINIA OF 1950 AS AMENDED, § 55.1-1920A & B AND I FURTHER CERTIFY THAT ALL IMPROVEMENTS THEREOF DEPICTED HEREON, PURSUANT TO THE CODE OF VIRGINIA § 55.1-1920B, ARE SUBSTANTIALLY COMPLETE.



5 Large/Small Plat(s) Recorded herewith as # 210008803

City of Williamsburg & County of James City Circuit Court: This PLAT was recorded on April 30, 2021 at 11:04 AM PM, PG Document # 210008803 MONA A. FOLEY, CLERK

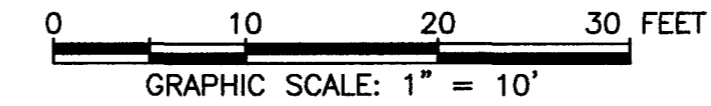

THIS SHEET: FLOOR PLANS

PHASE 56
CONDOMINIUM PLAT AND PLAN
 OF
THE PROMENADE
 AT
JOHN TYLER
 A CONDOMINIUM
 JAMES CITY COUNTY, VIRGINIA

DATE: APRIL 20, 2021
 SCALE: 1"=10'
 SHEET 5 OF 5 THIS PHASE

Hayden Frye and Associates, Inc.
Land Surveyors
 333 KELLAM ROAD, SUITE 200
 VIRGINIA BEACH, VA., 23462
 PH: (757) 491-7228 FX: (757) 491-7229

