

PROJECT MANAGER: NANCY MARSHALL (757) 956-3266 (Hampton Roads District)  
 SURVEYED BY: BOB HARMON, L.S. (757) 925-2662 (Hampton Roads District) 11/13/2012, Updated 10/8/2019  
 DESIGN BY: DAWN HARRIS, E.L.T. (757) 956-3209 (Hampton Roads District) --  
 SUBSURFACE UTILITY BY: JIM JACO, (757) 499-1094 (Virginia Beach, VA) 11/25/2019

**PAC PLANS**

THESE PLANS ARE UNFINISHED AND ARE NOT TO BE USED FOR ANY TYPE OF CONSTRUCTION.

REVISED 4/23/2021	STATE VA.	ROUTE 60	STATE PROJECT BW00-047-103 R-201, C-501	SHEET NO. 5
VDOT Location and Design Suffolk, Virginia ROADWAY ENGINEER			VDOT Location and Design Suffolk, Virginia HYDRAULIC ENGINEER	

DESIGN FEATURES RELATING TO CONSTRUCTION OR TO REGULATION AND CONTROL OF TRAFFIC MAY BE SUBJECT TO CHANGE AS DEEMED NECESSARY BY THE DEPARTMENT

Poplar Creek LLC  
 Instrument #210008588  
 4/29/2021  
 Plat Book 10 Page 544

Utility Owners:  
 SEE SHEET 3

**MANISH V MEHTA TRUSTEE & MEGHNA M TRUSTEE**  
 Inst. # 180013527  
 PB 684 PG 892  
 1.84 AC.  
 Tax # 2320100071E

**POPLAR CREEK, LLC.**  
 Inst. # 060015363  
 Inst. # 170019888 (Plat)  
 5.936 AC.  
 Tax # 2321000020D

**OUR SAVIOUR'S EVANGELICAL LUTHERAN CHURCH, WILLIAMSBURG, VIRGINIA, a Virginia non-stock corporation**  
 Inst. # 150014475  
 Inst. # 160002058 (Plat)  
 DB 45 PG 5  
 4.11 AC.  
 Tax # 2320100064

MATCHLINE SHEET 4 STATION 114+00.00

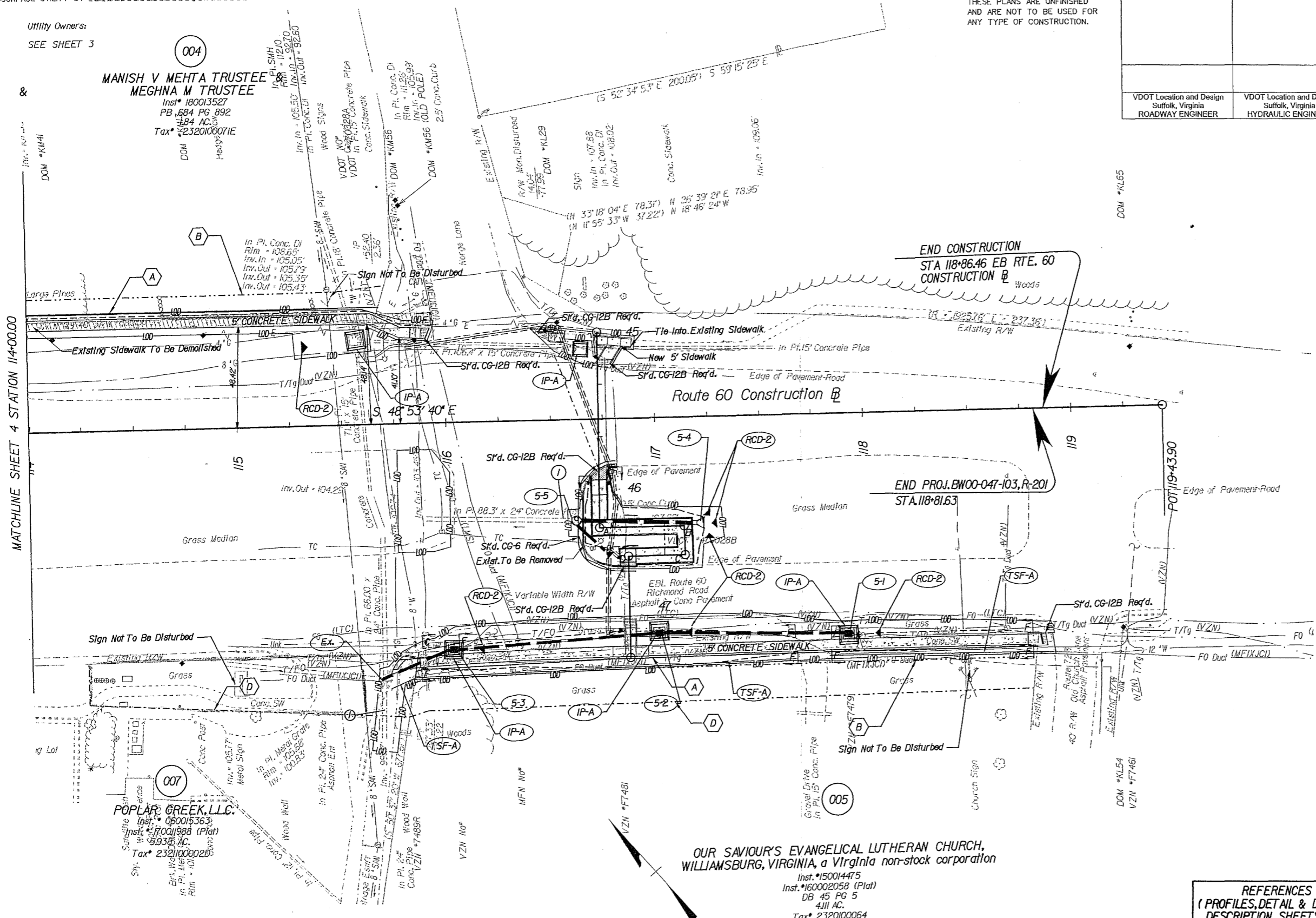

**INCIDENTAL LEGEND**

- DENOTES CONSTRUCTION LIMITS IN CUTS
- DENOTES CONSTRUCTION LIMITS IN FILLS
- DENOTES AREAS OF PROPOSED CONCRETE SIDEWALK
- DENOTES AREA OF PAVEMENT TO BE DEMOLISHED

- DENOTES AREA OF PROPOSED PAVEMENT
- DENOTES AREA OF RESURFACING
- DENOTES DRAINAGE STRUCTURE NUMBERS
- DENOTES EXIST'G. STRUCTURE AND PIPE TO BE CLEANED CUT.
- DENOTES EXIST'G. STRUCTURE AND PIPE TO BE REMOVED.

**LINE LEGEND**

- PROPOSED RIGHT OF WAY LINE
- PROPOSED TEMPORARY CONSTRUCTION EASEMENT
- VARIABLE WIDTH PERMANENT STANDARD UTILITY EASEMENT REQUIRED FOR DOMINION ENERGY AND VDOT UTILITY EASEMENT
- VARIABLE WIDTH PERMANENT STANDARD VDOT UTILITY EASEMENT

**SHEET NOTES:**

- 1) SEE GENERAL NOTES FOR E&S LEGEND.
- 2) IF EXISTING INCIDENTALS LABELED "DO NOT DISTURB" ARE DISTURBED DURING CONSTRUCTION, IT IS THE CONTRACTOR'S RESPONSIBILITY TO RETURN THEM TO THEIR ORIGINAL STATE.

**REFERENCES (PROFILES, DETAIL & DRAINAGE DESCRIPTION SHEETS, ETC.)**

Mainline Profile	5A
Drainage Descr.	2B(1)
E&S Legend	2

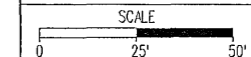

PROJECT BW00-047-103	SHEET NO. 5
-------------------------	----------------