



PROJECT MANAGER Mr. Wolf Zaman, PE - VDOT Hampton Roads District - (757) 956-3272
SURVEYED BY, DATE Dewberry Engineers Inc., 03/2020
DESIGNED BY, Dewberry Engineers Inc., (804) 205-3340
SUBSURFACE UTILITY BY, Accumark, 04/2020

COMMONWEALTH OF VIRGINIA
MATTHEW C. THOMAS
Lic. No. 046511
PROFESSIONAL ENGINEER

COMMONWEALTH OF VIRGINIA
MATTHEW C. THOMAS
Lic. No. 046511
PROFESSIONAL ENGINEER

Matthew C Thomas
2020.10.29 11:38:39-04'00"
Dewberry Engineers Inc.
Glen Allen, Virginia
HYDRAULIC ENGINEER

Matthew C Thomas
2020.10.29 11:38:51-04'00"
Dewberry Engineers Inc.
Glen Allen, Virginia
ROADWAY ENGINEER

REVISED	STATE	ROUTE	STATE	PROJECT	SHEET NO.
	VA.	60		0060-047-627 R-201 C-501	11A

DESIGN FEATURES RELATING TO CONSTRUCTION OR TO REGULATION AND CONTROL OF TRAFFIC MAY BE SUBJECT TO CHANGE AS DEEMED NECESSARY BY THE DEPARTMENT

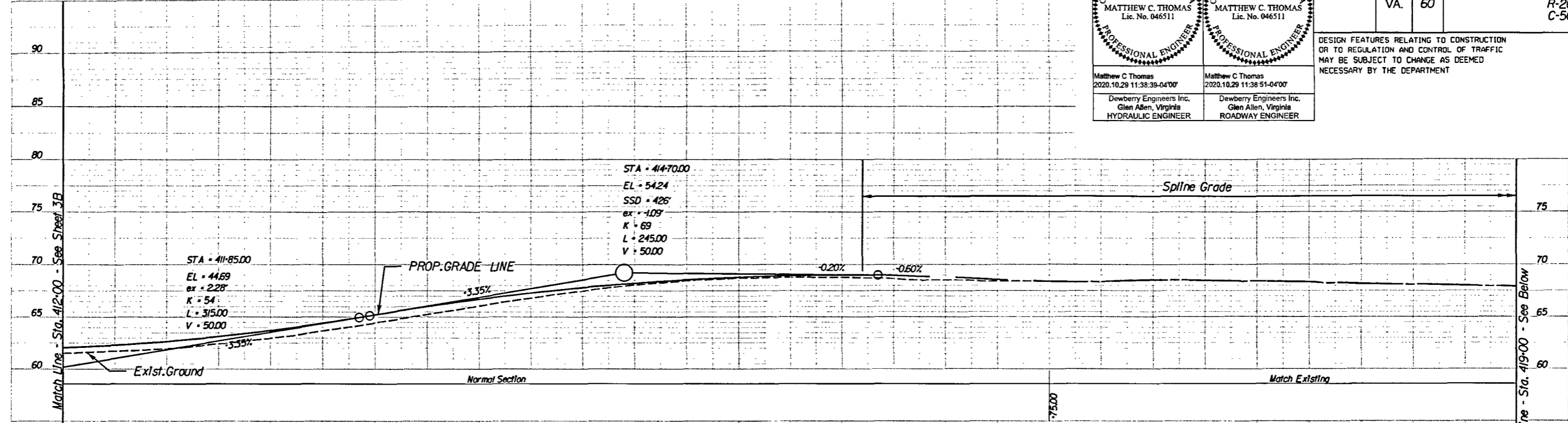

RT E/P (LY OFFSET)	PGL EXIST.	LT E/P (LY OFFSET)
46.35 (34.30)	47.06 (46.14)	46.62 (29.80)
46.60 (34.80)	47.30 (46.77)	46.89 (20.30)
46.97 (34.30)	47.66 (46.97)	47.28 (18.80)
47.45 (33.80)	48.13 (47.43)	47.78 (17.30)
48.04 (33.30)	48.71 (47.9)	48.39 (15.80)
48.75 (32.80)	49.41 (48.6)	49.12 (14.30)
49.55 (32.30)	50.22 (49.43)	49.94 (12.80)
50.37 (31.80)	51.00 (50.24)	50.76 (12.00)
51.09 (30.80)	51.70 (51.05)	51.46 (12.6)
51.71 (29.80)	52.30 (51.7)	52.06 (12.08)
52.24 (28.80)	52.81 (52.5)	52.57 (11.97)
52.74 (27.80)	53.23 (53.16)	53.05 (12.07)
53.03 (26.80)	53.56 (53.47)	53.32 (12.07)
53.29 (25.80)	53.80 (53.73)	53.56 (11.88)
53.46 (24.80)	53.95 (53.79)	53.71 (11.88)
53.54 (23.80)	54.01 (53.79)	53.77 (12.07)
53.51 (22.80)	53.96 (53.65)	53.72 (12.12)
53.38 (21.80)	53.81 (53.52)	53.57 (12.04)
53.16 (20.80)	53.57 (53.43)	53.33 (11.99)
53.01 (19.80)	53.40 (53.4)	53.16 (11.82)
52.99 (18.80)	53.38 (53.4)	53.38 (11.80)
53.11 (17.80)	53.55 (53.55)	53.55 (11.80)
53.15 (16.80)	53.49 (53.49)	53.49 (11.60)
53.02 (15.80)	53.42 (53.4)	53.42 (11.58)
52.89 (14.30)	53.34 (53.34)	53.34 (11.34)
52.77 (14.80)	53.16 (53.16)	53.16 (11.30)
52.56 (14.30)	53.10 (53.10)	53.10 (11.30)
52.57 (13.30)	53.01 (53.01)	53.01 (11.30)
52.57 (13.30)	52.92 (52.92)	52.92 (11.30)

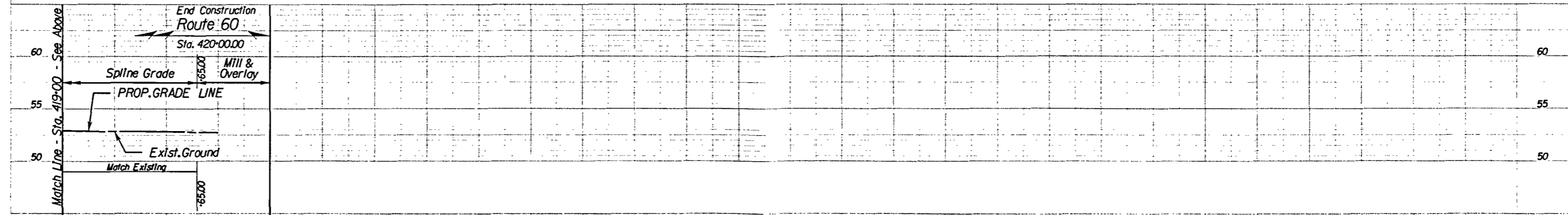

RT E/P (LY OFFSET)	PGL EXIST.	LT E/P (LY OFFSET)
52.56 (13.30)	52.92 (52.92)	52.92 (13.30)
52.56 (12.80)	52.87 (52.87)	52.87 (12.80)
52.44 (12.30)	52.85 (52.85)	52.85 (12.30)
	52.72 (52.72)	52.72 (11.80)

ROUTE 60 (POCAHONTAS TRAIL)

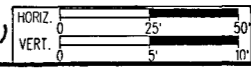

PROJECT	SHEET NO.
0060-047-627	11A