

PROJECT MANAGER Mr. Wali Zaman, PE - VDOT Hampton Roads District - (757) 956-3272
SURVEYED BY, DATE Dewberry Engineers Inc., 03/2020
DESIGNED BY, Dewberry Engineers Inc. - (804) 205-3340
SUBSURFACE UTILITY BY, Accumark, 04/2020

		REVISED	STATE	ROUTE	STATE	PROJECT	SHEET NO.
		03/24/21	VA.	60		0060-047-627	R-201 C-501
DESIGN FEATURES RELATING TO CONSTRUCTION OR TO REGULATION AND CONTROL OF TRAFFIC MAY BE SUBJECT TO CHANGE AS DEEMED NECESSARY BY THE DEPARTMENT							
Matthew C Thomas 2021.03.25 10:37:44-04'00"	Matthew C Thomas 2021.03.25 10:38:02-04'00"						
Dewberry Engineers Inc. Glen Allen, Virginia HYDRAULIC ENGINEER	Dewberry Engineers Inc. Glen Allen, Virginia ROADWAY ENGINEER						

Dewberry

City of Newport News Virginia Instrument #210008452 4/27/2021 Plat Book 10 Page 536

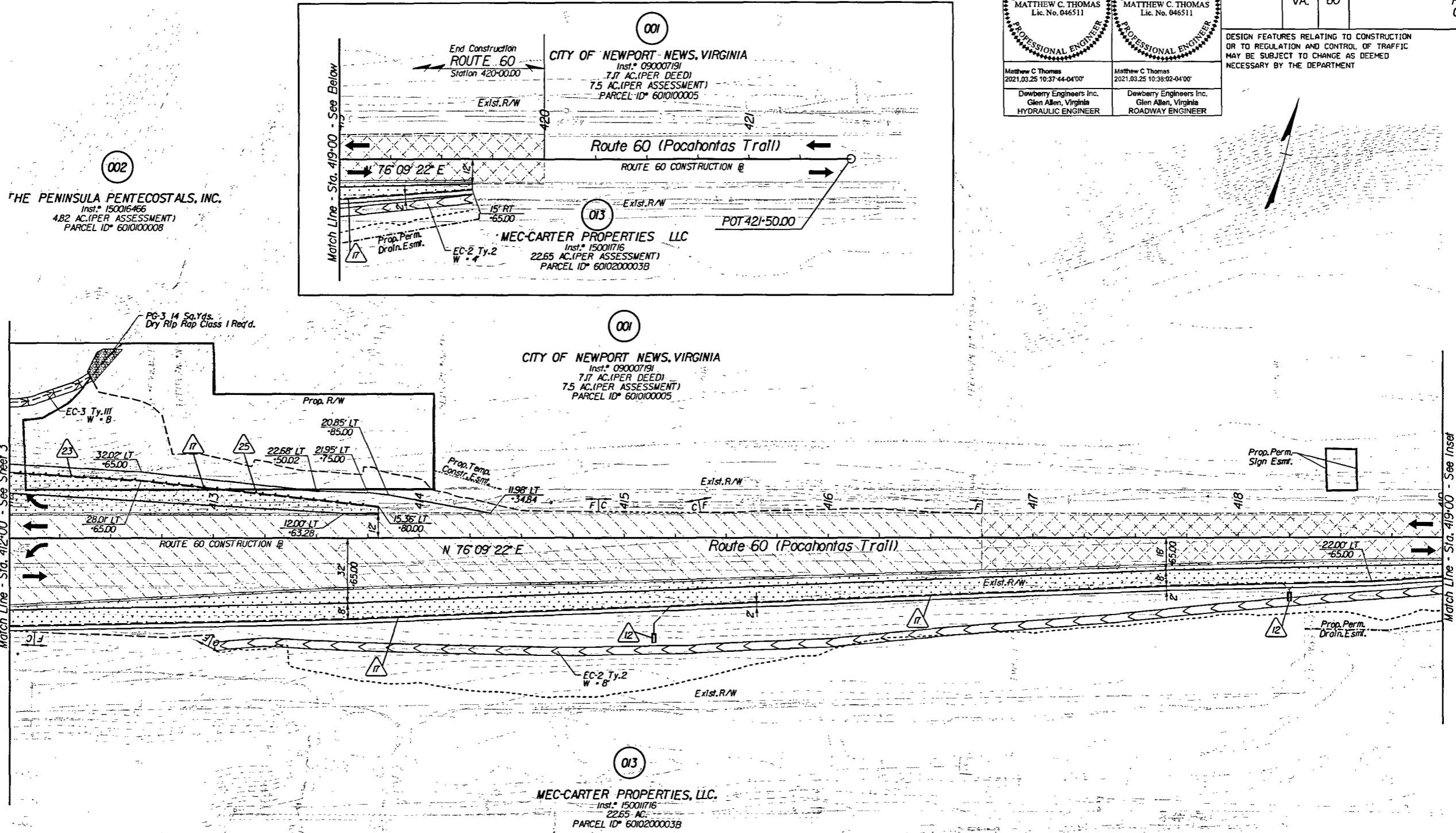

- Key Legend**
- | | | | |
|--|---|--|---|
| 1 6" Curb, Sfd. CG-2 Req'd. | 12 Underdrain Endwall, Sfd. EW-12 Req'd. | 23 Guardrail, Sfd. GR-MGS1 Req'd. | 34 Remove Exst. Guardrail |
| 2 4" Curb, Sfd. CG-3 Req'd. | 13 Abandon Pipe, Sfd. PP-1 Req'd. | 24 Guardrail, Sfd. GR-MGSIA Req'd. | 35 Remove Exst. Fence |
| 3 6" Curb and Gutter, Sfd. CG-6 Req'd. | 14 Groundwater Underdrain, Sfd. UD-1 Req'd. | 25 Guardrail Terminal, Sfd. GR-MGS2 Req'd. | 36 Remove Exst. Structure |
| 4 4" Curb and Gutter, Sfd. CG-7 Req'd. | 15 Median Underdrain, Sfd. UD-2 Req'd. | 26 Guardrail, Sfd. GR-10, 3' Height, Type I Req'd. | 37 Remove Exst. Pipe |
| 5 Conc. Raised Median, Sfd. MS-1 Req'd. | 16 Sidewalk Underdrain, Sfd. UD-3 Req'd. | 27 Guardrail, Sfd. GR-10, 3' Height, Type II Req'd. | 38 Abandon and Plug Exst. Pipe |
| 6 Conc. Raised Median, Sfd. MS-1A Req'd. | 17 Pavement Underdrain, Sfd. UD-4 Req'd. | 28 Guardrail, Sfd. GR-10, 3' Height, Type III Req'd. | 39 Ad Just Exst. Structure |
| 7 Grass Raised Median, Sfd. MS-2 Req'd. | 18 Crossdrain, Sfd. CD-1 Req'd. | 29 Trailing End Terminal, Sfd. GR-MGS3 Req'd. | 40 Clean Out Exst. Structure |
| 8 Entrance Gutter, Sfd. CG-9B Req'd. | 19 Crossdrain, Sfd. CD-2 Req'd. | 30 Fixed Object Att. Sfd. GR-FOA-5 Req'd. | 41 Clean Out Exst. Pipe |
| 9 Entrance Gutter, Sfd. CG-9D Req'd. | 20 Handrail, Sfd. HR-1 Type II Req'd. | 31 Fixed Object Att. Sfd. GR-FOA-2 Req'd. | 42 Full Depth Sawcut |
| 10 Entrance, Sfd. CG-11 Req'd. | 21 Barbed Wire Fence, Sfd. FE-B Req'd. | 32 Guardrail, Sfd. GR-MGS4 | 43 6" Curb and Dry Gutter, Mod. CG-6 Req'd. |
| 11 Curb Ramp, Sfd. CG-12 Req'd. | 22 Chain Link Fence, Sfd. FE-CL Req'd. | 33 Bridge Pier Protection, Sfd. BPPS-1 | 44 Conc. Median Barrier, Sfd. MB-7F Req'd. |

- | | | | |
|--|-----------------------------|--|--|
| | Denotes Full Depth Pavement | | Denotes Guardrail Bumpout Pavement Section |
| | Denotes Pavement Demolition | | Denotes Mill & Variable Depth Overlay |
| | Denotes Milling and Overlay | | Denotes Construction Limits In Cuts |
| | | | Denotes Construction Limits In Fills |

REFERENCES
(PROFILES, DETAIL & DRAINAGE DESCRIPTION SHEETS, ETC.)

Alignment Data	IG
ESC Phase 1	2D series
ESC Phase 2	2E series
ESC Phase 3	2F series
Pocahontas Trail Profile	IIA
Right-of-Way Plan	IIRW

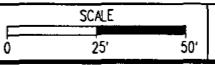

PROJECT	0060-047-627	SHEET NO.	11
---------	--------------	-----------	----