



PROJECT MANAGER Mr. Wali Zaman, PE - VDOT Hampton Roads District - (757) 956-3272
SURVEYED BY, DATE Dewberry Engineers Inc., 03/2020
DESIGNED BY, Dewberry Engineers Inc. - (804) 205-3340
SUBSURFACE UTILITY BY, Accumark, 04/2020

COMMONWEALTH OF VIRGINIA
MATTHEW C. THOMAS
Lic. No. 046511
PROFESSIONAL ENGINEER

COMMONWEALTH OF VIRGINIA
MATTHEW C. THOMAS
Lic. No. 046511
PROFESSIONAL ENGINEER

Matthew C Thomas
2020.10.29 11:38:39-04'00"
Dewberry Engineers Inc.
Glen Allen, Virginia
HYDRAULIC ENGINEER

Matthew C Thomas
2020.10.29 11:38:51-04'00"
Dewberry Engineers Inc.
Glen Allen, Virginia
ROADWAY ENGINEER

REVISED	STATE	ROUTE	STATE	PROJECT	SHEET NO.
	VA.	60		0060-047-627 R-201 C-501	11A

DESIGN FEATURES RELATING TO CONSTRUCTION OR TO REGULATION AND CONTROL OF TRAFFIC MAY BE SUBJECT TO CHANGE AS DEEMED NECESSARY BY THE DEPARTMENT

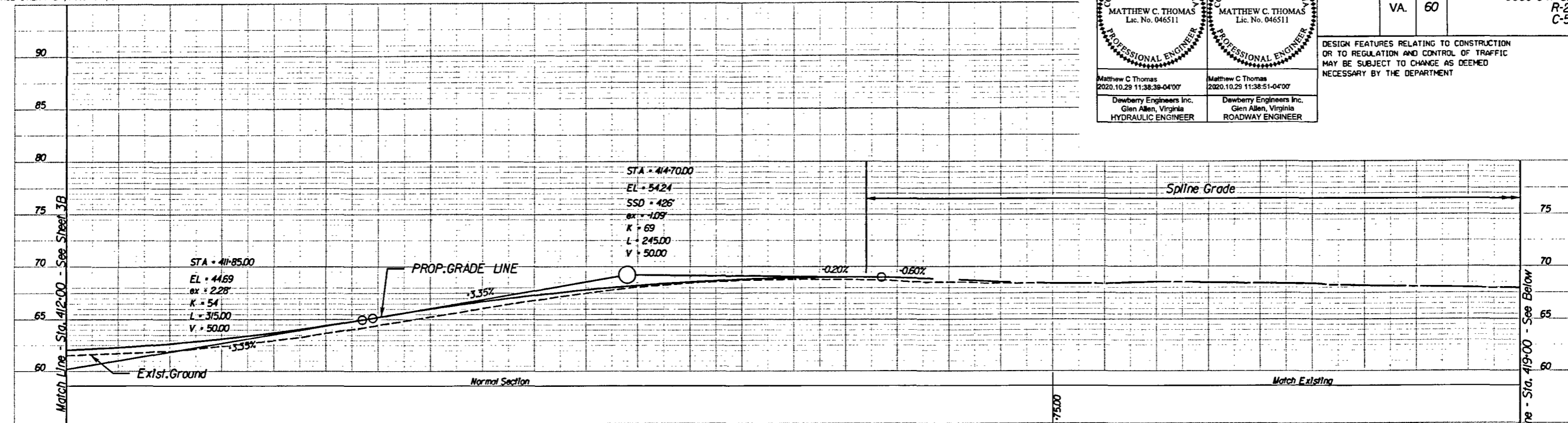

LT E/P (XX' OFFSET)	PGL EXIST.	RT E/P (XX' OFFSET)
46.62	47.06	46.35
46.89	47.30	46.60
47.28	47.66	46.97
47.78	48.13	47.45
48.39	48.71	48.04
49.12	49.41	48.75
49.94	50.22	49.55
50.76	51.00	50.37
51.46	51.70	51.09
52.06	52.30	51.71
52.57	52.81	52.24
53.05	53.23	52.74
53.32	53.56	53.03
53.56	53.80	53.29
53.71	53.95	53.46
53.77	54.01	53.54
53.72	53.96	53.51
53.57	53.81	53.38
53.33	53.57	53.16
53.06	53.40	53.01
52.74	53.18	52.99
52.37	52.81	52.57
51.94	52.38	52.14
51.46	51.90	51.66
50.94	51.38	51.14
50.37	50.74	50.57
49.74	50.11	49.94
49.06	49.42	49.26
48.33	48.69	48.53
47.56	47.92	47.76
46.74	47.10	46.94
45.87	46.23	46.07
44.94	45.30	45.14
43.96	44.32	44.16
42.93	43.29	43.13
41.85	42.21	42.05
40.72	41.08	40.92
39.54	99.94	39.74
38.31	99.71	38.51
37.03	99.43	37.23
35.70	99.10	35.90
34.32	98.72	34.52
32.89	98.29	33.09
31.41	97.81	31.61
29.88	97.28	30.08
28.30	96.70	28.50
26.67	96.07	26.87
25.00	95.40	25.20
23.29	94.69	23.49
21.54	93.94	21.74
19.74	93.14	19.94
17.89	92.29	18.09
15.99	91.39	16.19
14.04	90.44	14.24
12.04	89.44	12.24
10.00	88.40	10.20
7.91	87.31	8.11
5.77	86.17	5.97
3.59	85.00	3.79
1.36	83.79	1.56
0.09	82.54	0.29
0.00	81.25	0.00
0.00	79.92	0.00
0.00	78.55	0.00
0.00	77.14	0.00
0.00	75.69	0.00
0.00	74.20	0.00
0.00	72.67	0.00
0.00	71.10	0.00
0.00	69.49	0.00
0.00	67.84	0.00
0.00	66.15	0.00
0.00	64.42	0.00
0.00	62.65	0.00
0.00	60.84	0.00
0.00	59.00	0.00
0.00	57.12	0.00
0.00	55.20	0.00
0.00	53.24	0.00
0.00	51.34	0.00
0.00	49.40	0.00
0.00	47.42	0.00
0.00	45.40	0.00
0.00	43.34	0.00
0.00	41.24	0.00
0.00	39.10	0.00
0.00	36.92	0.00
0.00	34.70	0.00
0.00	32.44	0.00
0.00	30.14	0.00
0.00	27.80	0.00
0.00	25.42	0.00
0.00	22.99	0.00
0.00	20.52	0.00
0.00	18.01	0.00
0.00	15.45	0.00
0.00	12.84	0.00
0.00	10.16	0.00
0.00	7.47	0.00
0.00	4.77	0.00
0.00	2.06	0.00
0.00	0.00	0.00

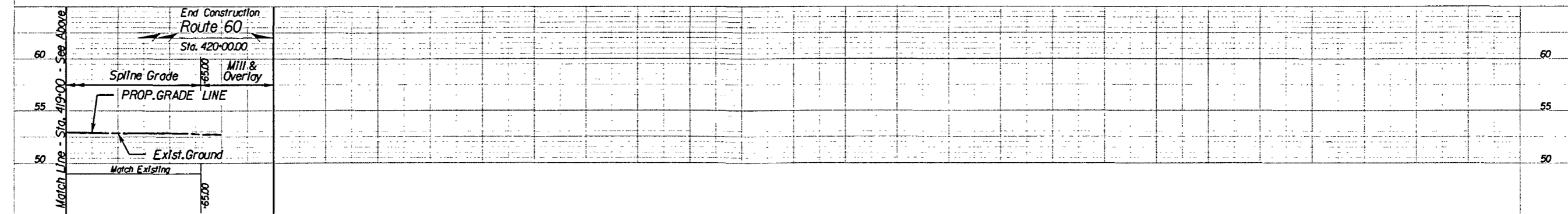

LI E/P (XX' OFFSET)	PGL EXIST.	RT E/P (XX' OFFSET)
52.92	52.92	52.57
52.87	52.87	52.56
52.85	52.85	52.44
52.72	52.72	52.30
52.57	52.57	52.14
52.41	52.41	51.98
52.24	52.24	51.81
52.06	52.06	51.63
51.87	51.87	51.44
51.67	51.67	51.24
51.46	51.46	51.03
51.24	51.24	50.81
51.00	51.00	50.57
50.74	50.74	50.32
50.46	50.46	50.05
50.16	50.16	49.75
49.84	49.84	49.43
49.50	49.50	49.09
49.14	49.14	48.73
48.76	48.76	48.35
48.36	48.36	47.95
47.94	47.94	47.53
47.50	47.50	47.09
47.04	47.04	46.63
46.56	46.56	46.15
46.06	46.06	45.65
45.54	45.54	45.13
45.00	45.00	44.59
44.44	44.44	44.03
43.86	43.86	43.45
43.26	43.26	42.85
42.64	42.64	42.23
42.00	42.00	41.59
41.34	41.34	40.93
40.66	40.66	40.25
39.96	39.96	39.55
39.24	39.24	38.83
38.50	38.50	38.09
37.74	37.74	37.33
36.96	36.96	36.55
36.16	36.16	35.75
35.34	35.34	34.93
34.50	34.50	34.09
33.64	33.64	33.23
32.76	32.76	32.35
31.86	31.86	31.45
30.94	30.94	30.53
30.00	30.00	29.59
29.04	29.04	28.63
28.06	28.06	27.65
27.06	27.06	26.65
26.04	26.04	25.63
25.00	25.00	24.59
23.94	23.94	23.53
22.86	22.86	22.45
21.76	21.76	21.35
20.64	20.64	20.23
19.50	19.50	19.09
18.34	18.34	17.93
17.16	17.16	16.75
15.96	15.96	15.55
14.74	14.74	14.33
13.50	13.50	13.09
12.24	12.24	11.83
10.96	10.96	10.55
9.66	9.66	9.25
8.34	8.34	7.93
7.00	7.00	6.59
5.64	5.64	5.23
4.26	4.26	3.85
2.86	2.86	2.45
1.44	1.44	1.03
0.00	0.00	0.00

ROUTE 60 (POCAHONTAS TRAIL)

HORIZ. 1" = 25'

VERT. 1" = 5'

PROJECT 0060-047-627

SHEET NO. 11A