

PROJECT MANAGER Mr. Wali Zaman, PE - VDOT Hampton Roads District - (757) 956-3272  
SURVEYED BY DATE Dewberry Engineers Inc., 03/2020  
DESIGNED BY Dewberry Engineers Inc., (804) 205-3340  
SUBSURFACE UTILITY BY Accumark, 04/2020

Matthew C. Thomas  
2020.10.29 11:08:14-04'00"  
Dewberry Engineers Inc.  
Glen Allen, Virginia  
HYDRAULIC ENGINEER

Matthew C. Thomas  
2020.10.29 11:08:28-04'00"  
Dewberry Engineers Inc.  
Glen Allen, Virginia  
ROADWAY ENGINEER

REVISED	STATE	ROUTE	STATE PROJECT	SHEET NO.
	VA.	60	0060-047-627 R-201 C-501	3A

DESIGN FEATURES RELATING TO CONSTRUCTION OR TO REGULATION AND CONTROL OF TRAFFIC MAY BE SUBJECT TO CHANGE AS DEEMED NECESSARY BY THE DEPARTMENT

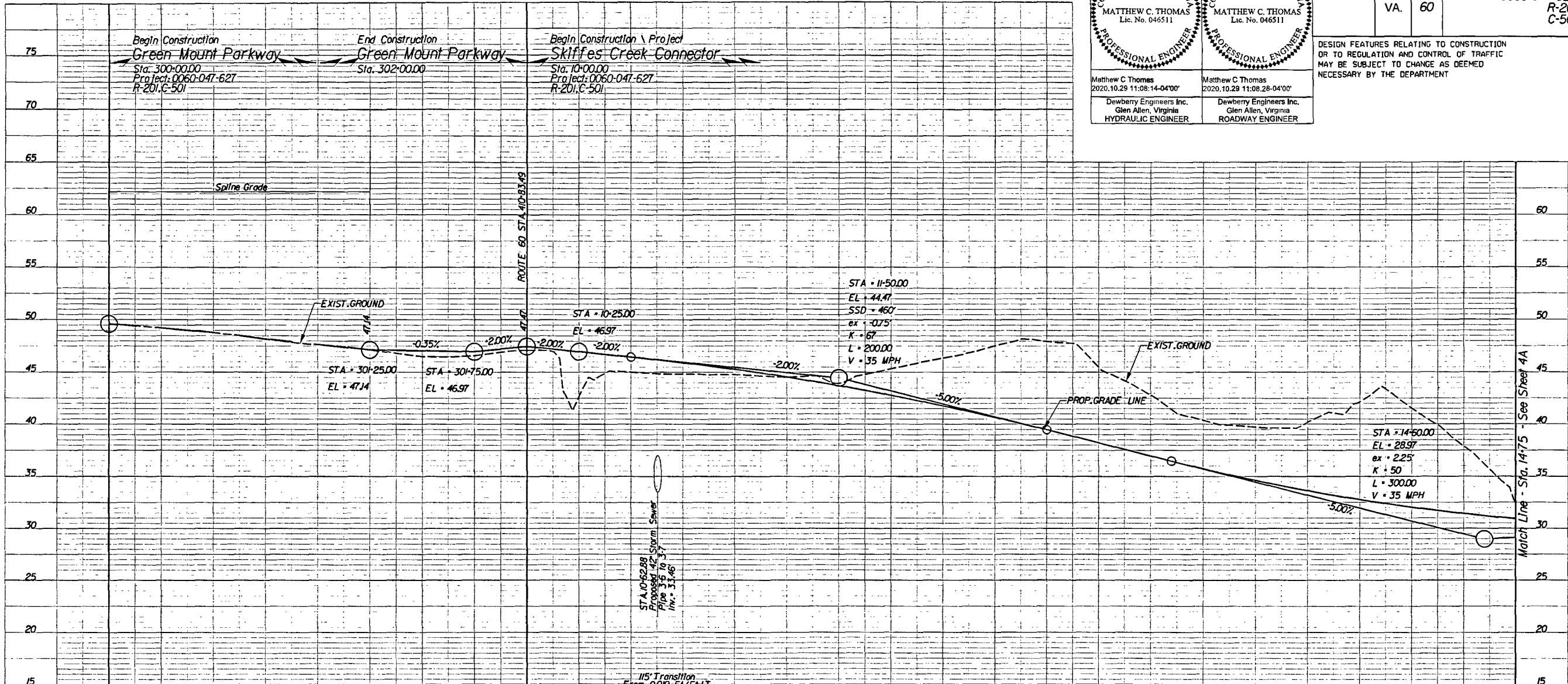

RT E/P (12' OFFSET)	PGL EXIST.	LT E/P (24' OFFSET)
	49.59	
	49.59	
	49.21	49.05 (137.81)
	49.21	49.21 (137.81)
	48.78	48.55 (159.51)
	48.78	48.78 (159.51)
	48.18	47.96 (181.31)
	48.18	48.18 (181.31)
	47.66	47.46 (203.01)
	47.66	47.66 (203.01)
	47.14	47.14
	47.14	47.14
	46.06	45.51
	46.06	46.06
	46.57	46.57
	46.57	46.57
	47.47	47.47
	47.47	47.47
	46.97	46.97
	46.97	46.97
	46.47	46.47
	46.47	46.47
	45.92	45.92
	45.92	45.92
	44.94	44.94
	44.94	44.94
	44.55	44.55
	44.55	44.55
	44.21	44.21
	44.21	44.21
	43.72	43.72
	43.72	43.72
	43.44	43.44
	43.44	43.44
	43.24	43.24
	43.24	43.24
	42.80	42.80
	42.80	42.80
	42.56	42.56
	42.56	42.56
	42.32	42.32
	42.32	42.32
	41.80	41.80
	41.80	41.80
	41.54	41.54
	41.54	41.54
	41.30	41.30
	41.30	41.30
	40.87	40.87
	40.87	40.87
	40.67	40.67
	40.67	40.67
	40.43	40.43
	40.43	40.43
	39.97	39.97
	39.97	39.97
	39.47	39.47
	39.47	39.47
	38.99	38.99
	38.99	38.99
	38.22	38.22
	38.22	38.22
	37.98	37.98
	37.98	37.98
	37.74	37.74
	37.74	37.74
	36.97	36.97
	36.97	36.97
	36.49	36.49
	36.49	36.49
	35.74	35.74
	35.74	35.74
	35.26	35.26
	35.26	35.26
	34.74	34.74
	34.74	34.74
	34.63	34.63
	34.63	34.63
	34.39	34.39
	34.39	34.39
	33.40	33.40
	33.40	33.40
	33.64	33.64
	33.64	33.64
	33.19	33.19
	33.19	33.19
	32.78	32.78
	32.78	32.78
	32.36	32.36
	32.36	32.36
	32.04	32.04
	32.04	32.04
	31.65	31.65
	31.65	31.65
	31.19	31.19
	31.19	31.19
	31.07	31.07
	31.07	31.07
	30.94	30.94
	30.94	30.94
	30.61	30.61
	30.61	30.61
	30.28	30.28
	30.28	30.28
	30.04	30.04
	30.04	30.04
	29.70	29.70
	29.70	29.70
	29.38	29.38
	29.38	29.38
	29.04	29.04
	29.04	29.04
	28.70	28.70
	28.70	28.70
	28.36	28.36
	28.36	28.36
	28.02	28.02
	28.02	28.02
	27.68	27.68
	27.68	27.68
	27.34	27.34
	27.34	27.34
	27.00	27.00
	27.00	27.00
	26.66	26.66
	26.66	26.66
	26.32	26.32
	26.32	26.32
	25.98	25.98
	25.98	25.98
	25.64	25.64
	25.64	25.64
	25.30	25.30
	25.30	25.30
	24.96	24.96
	24.96	24.96
	24.62	24.62
	24.62	24.62
	24.28	24.28
	24.28	24.28
	23.94	23.94
	23.94	23.94
	23.60	23.60
	23.60	23.60
	23.26	23.26
	23.26	23.26
	22.92	22.92
	22.92	22.92
	22.58	22.58
	22.58	22.58
	22.24	22.24
	22.24	22.24
	21.90	21.90
	21.90	21.90
	21.56	21.56
	21.56	21.56
	21.22	21.22
	21.22	21.22
	20.88	20.88
	20.88	20.88
	20.54	20.54
	20.54	20.54
	20.20	20.20
	20.20	20.20
	19.86	19.86
	19.86	19.86
	19.52	19.52
	19.52	19.52
	19.18	19.18
	19.18	19.18
	18.84	18.84
	18.84	18.84
	18.50	18.50
	18.50	18.50
	18.16	18.16
	18.16	18.16
	17.82	17.82
	17.82	17.82
	17.48	17.48
	17.48	17.48
	17.14	17.14
	17.14	17.14
	16.80	16.80
	16.80	16.80
	16.46	16.46
	16.46	16.46
	16.12	16.12
	16.12	16.12
	15.78	15.78
	15.78	15.78
	15.44	15.44
	15.44	15.44
	15.10	15.10
	15.10	15.10
	14.76	14.76
	14.76	14.76
	14.42	14.42
	14.42	14.42
	14.08	14.08
	14.08	14.08
	13.74	13.74
	13.74	13.74
	13.40	13.40
	13.40	13.40
	13.06	13.06
	13.06	13.06
	12.72	12.72
	12.72	12.72
	12.38	12.38
	12.38	12.38
	12.04	12.04
	12.04	12.04
	11.70	11.70
	11.70	11.70
	11.36	11.36
	11.36	11.36
	11.02	11.02
	11.02	11.02
	10.68	10.68
	10.68	10.68
	10.34	10.34
	10.34	10.34
	10.00	10.00
	10.00	10.00
	9.66	9.66
	9.66	9.66
	9.32	9.32
	9.32	9.32
	8.98	8.98
	8.98	8.98
	8.64	8.64
	8.64	8.64
	8.30	8.30
	8.30	8.30
	7.96	7.96
	7.96	7.96
	7.62	7.62
	7.62	7.62
	7.28	7.28
	7.28	7.28
	6.94	6.94
	6.94	6.94
	6.60	6.60
	6.60	6.60
	6.26	6.26
	6.26	6.26
	5.92	5.92
	5.92	5.92
	5.58	5.58
	5.58	5.58
	5.24	5.24
	5.24	5.24
	4.90	4.90
	4.90	4.90
	4.56	4.56
	4.56	4.56
	4.22	4.22
	4.22	4.22
	3.88	3.88
	3.88	3.88
	3.54	3.54
	3.54	3.54
	3.20	3.20
	3.20	3.20
	2.86	2.86
	2.86	2.86
	2.52	2.52
	2.52	2.52
	2.18	2.18
	2.18	2.18
	1.84	1.84
	1.84	1.84
	1.50	1.50
	1.50	1.50
	1.16	1.16
	1.16	1.16
	0.82	0.82
	0.82	0.82
	0.48	0.48
	0.48	0.48
	0.14	0.14
	0.14	0.14
	0.00	0.00
	0.00	0.00

GREEN MOUNT PARKWAY / SKIFFES CREEK CONNECTOR

HORIZ. 1" = 25'  
VERT. 1" = 5'

PROJECT 0060-047-627  
SHEET NO. 3A

Peninsula Pentecostals Inc Instrument no. 210006426 04/02/2021 State Highway Plat Book 10 Page 513