

Dewberry

PROJECT MANAGER Mr. Wali Zaman, PE - VDOT Hampton Roads District - (757) 956-3272
SURVEYED BY, DATE Dewberry Engineers Inc., 03/2020
DESIGNED BY, Dewberry Engineers Inc. - (804) 205-3340
SUBSURFACE UTILITY BY, Accumark, 04/2020

REVISED	STATE	ROUTE	STATE PROJECT	SHEET NO.
12/8/20	VA.	60	0060-047-627 R-201 C-501	6

DESIGN FEATURES RELATING TO CONSTRUCTION OR TO REGULATION AND CONTROL OF TRAFFIC MAY BE SUBJECT TO CHANGE AS DEEMED NECESSARY BY THE DEPARTMENT

Skiffes Creek LLC Instrument 210004922 03/16/2021 Statehighway Plat Book 10 Page 502

007
SKIFFES CREEK, LLC
Inst. # 020023301
102.60 AC. (PER ASSESSMENT)
102.60 AC.
PARCEL ID# 6010100004A

Curve SCC2
PI = 33+55.56
DELTA = 74° 54' 22.67" (RT)
D = 15' 16" 4/8"
T = 287.26'
L = 490.26'
R = 375.00'
PC = 30+68.30
PT = 35+58.56
V = 35 mph
E = 4.0%

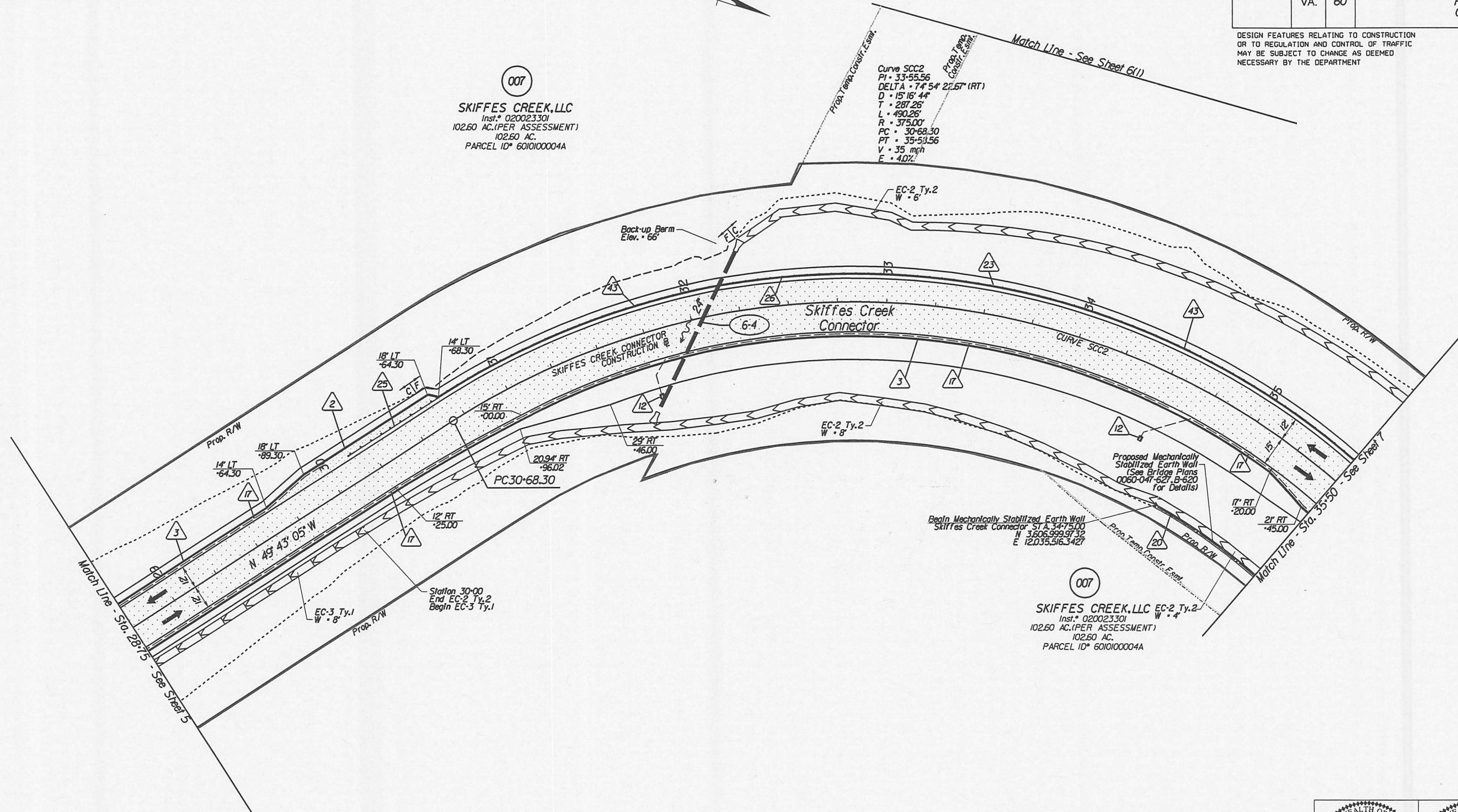

007
SKIFFES CREEK, LLC
Inst. # 020023301
102.60 AC. (PER ASSESSMENT)
102.60 AC.
PARCEL ID# 6010100004A

Key Legend

- | | | | |
|--|---|--|---|
| 1 6" Curb, S'd, CG-2 Req'd. | 12 Underdrain Endwall, S'd, EW-12 Req'd. | 23 Guardrail, S'd, GR-MGS1 Req'd. | 34 Remove Ex'ist. Guardrail |
| 2 4" Curb, S'd, CG-3 Req'd. | 13 Abandon Pipe, S'd, PP-1 Req'd. | 24 Guardrail, S'd, GR-MGS1A Req'd. | 35 Remove Ex'ist. Fence |
| 3 6" Curb and Gutter, S'd, CG-6 Req'd. | 14 Groundwater Underdrain, S'd, UD-1 Req'd. | 25 Guardrail Terminal, S'd, GR-MGS2 Req'd. | 36 Remove Ex'ist. Structure |
| 4 4" Curb and Gutter, S'd, CG-7 Req'd. | 15 Median Underdrain, S'd, UD-2 Req'd. | 26 Guardrail, S'd, GR-10, 3" Height, Type I Req'd. | 37 Remove Ex'ist. Pipe |
| 5 Conc. Raised Median, S'd, MS-1 Req'd. | 16 Sidewalk Underdrain, S'd, UD-3 Req'd. | 27 Guardrail, S'd, GR-10, 3" Height, Type II Req'd. | 38 Abandon and Plug Ex'ist. Pipe |
| 6 Conc. Raised Median, S'd, MS-1A Req'd. | 17 Pavement Underdrain, S'd, UD-4 Req'd. | 28 Guardrail, S'd, GR-10, 3" Height, Type III Req'd. | 39 Adj. Ex'ist. Structure |
| 7 Grass Raised Median, S'd, MS-2 Req'd. | 18 Crossdrain, S'd, CD-1 Req'd. | 29 Trailing End Terminal, S'd, GR-MGS3 Req'd. | 40 Clean Out Ex'ist. Structure |
| 8 Entrance Gutter, S'd, CG-9B Req'd. | 19 Crossdrain, S'd, CD-2 Req'd. | 30 Fixed Object Att., S'd, GR-FOA-5 Req'd. | 41 Clean Out Ex'ist. Pipe |
| 9 Entrance Gutter, S'd, CG-9D Req'd. | 20 Handrail, S'd, HR-1 Type II Req'd. | 31 Fixed Object Att., S'd, GR-FOA-2 Req'd. | 42 Full Depth Sawcut |
| 10 Entrance, S'd, CG-11 Req'd. | 21 Barbed Wire Fence, S'd, FE-B Req'd. | 32 Guardrail, S'd, GR-MGS4 | 43 6" Curb and Dry Gutter, Mod. CG-6 Req'd. |
| 11 Curb Ramp, S'd, CG-12 Req'd. | 22 Chain Link Fence, S'd, FE-CL Req'd. | 33 Bridge Pier Protection, S'd, BPPS-1 | 44 Conc. Median Barrier, S'd, MB-7F Req'd. |

- Denotes Full Depth Pavement
- Denotes Guardrail Bumpout Pavement Section
- Denotes Pavement Demolition
- Denotes Mill & Variable Depth Overlay
- Denotes Milling and Overlay
- Denotes Construction Limits In Cuts
- Denotes Construction Limits In Fills

REFERENCES
(PROFILES, DETAIL & DRAINAGE DESCRIPTION SHEETS, ETC.)

Alignment Data	IG
ESC Phase 1	2D series
ESC Phase 2	2E series
ESC Phase 3	2F series
Skiffes Creek Profile	6A
Right-of-Way Plan	6RW
Drainage Descriptions	16
Storm Sewer Profiles	17

Matthew C. Thomas 2020.12.09 12:00:33-05'00" Dewberry Engineers Inc. Glen Allen, Virginia HYDRAULIC ENGINEER	Matthew C. Thomas 2020.12.09 12:00:50-05'00" Dewberry Engineers Inc. Glen Allen, Virginia ROADWAY ENGINEER
SCALE 0 25 50'	PROJECT: 0060-047-627 SHEET NO.: 6