

Dewberry

PROJECT MANAGER Mr. Wai Zaman, PE - VDOT Hampton Roads District - (757) 956-3272
SURVEYED BY, DATE Dewberry Engineers Inc., 03/2020
DESIGNED BY, Dewberry Engineers Inc. - (804) 205-3340
SUBSURFACE UTILITY BY, Accumark, 04/2020

 COMMONWEALTH OF VIRGINIA MATTHEW C. THOMAS Lic. No. 046511 PROFESSIONAL ENGINEER	 COMMONWEALTH OF VIRGINIA MATTHEW C. THOMAS Lic. No. 046511 PROFESSIONAL ENGINEER
Matthew C Thomas 2020.12.09 12:01:51-05'00" Glen Allen, Virginia Dewberry Engineers Inc. HYDRAULIC ENGINEER	Matthew C Thomas 2020.12.09 12:02:21-05'00" Glen Allen, Virginia Dewberry Engineers Inc. ROADWAY ENGINEER

REVISED	STATE	ROUTE	STATE PROJECT	SHEET NO.
12/8/20	VA.	60	0060-047-627 R-201 C-501	4

DESIGN FEATURES RELATING TO CONSTRUCTION OR TO REGULATION AND CONTROL OF TRAFFIC MAY BE SUBJECT TO CHANGE AS DEEMED NECESSARY BY THE DEPARTMENT

Skiffes Creek LLC Instrument 210004922 03/16/2021 State Highway Plat Book 10 Page 496

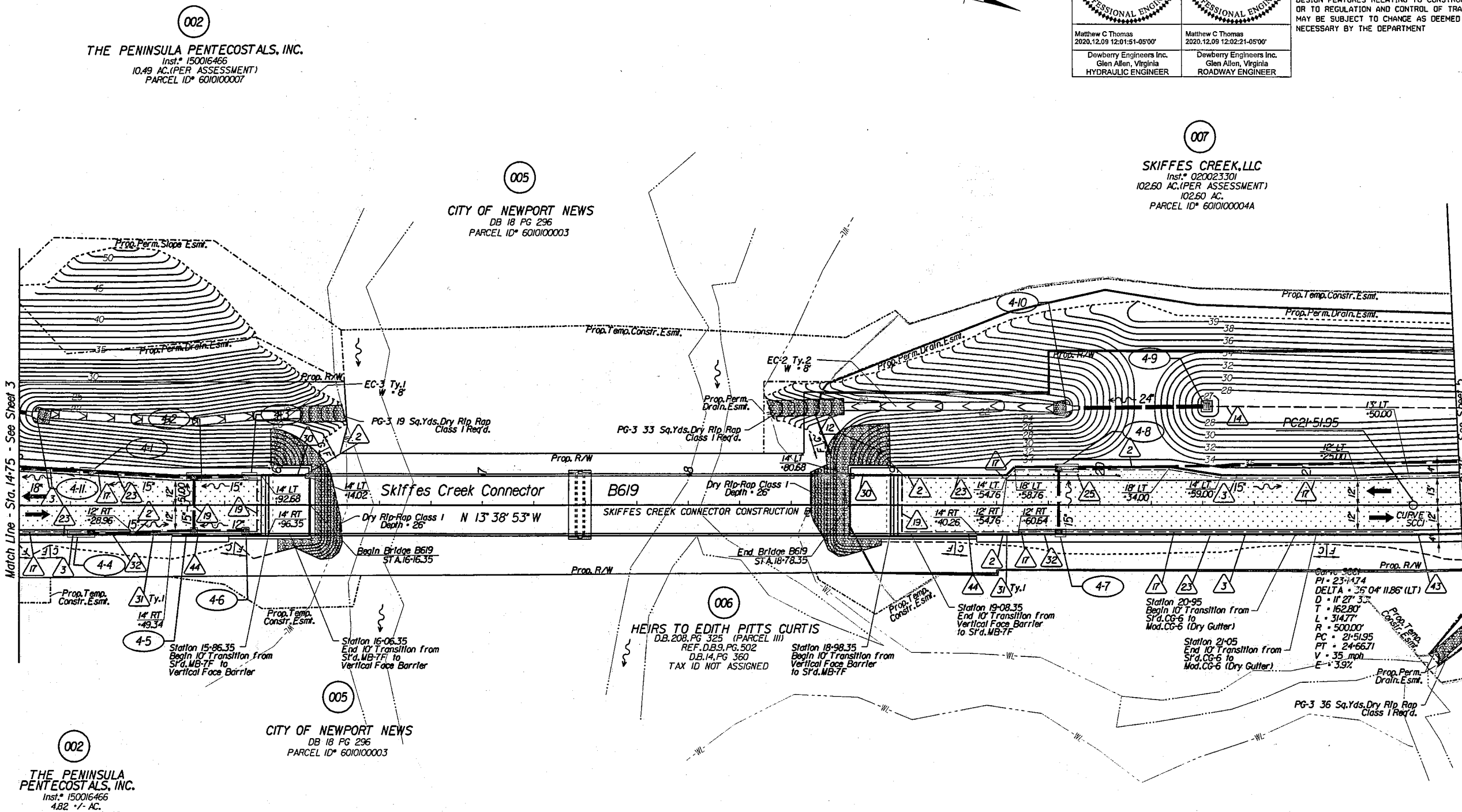

Key Legend

- | | | | |
|--|---|--|---|
| 1 6" Curb, Sfd, CG-2 Req'd. | 12 Underdrain Endwall, Sfd, EW-12 Req'd. | 23 Guardrail, Sfd, GR-MGS1 Req'd. | 34 Remove Exist. Guardrail |
| 2 4" Curb, Sfd, CG-3 Req'd. | 13 Abandon Pipe, Sfd, PP-1 Req'd. | 24 Guardrail, Sfd, GR-MGS1A Req'd. | 35 Remove Exist. Fence |
| 3 6" Curb and Gutter, Sfd, CG-6 Req'd. | 14 Groundwater Underdrain, Sfd, UD-1 Req'd. | 25 Guardrail Terminal, Sfd, GR-MGS2 Req'd. | 36 Remove Exist. Structure |
| 4 4" Curb and Gutter, Sfd, CG-7 Req'd. | 15 Median Underdrain, Sfd, UD-2 Req'd. | 26 Guardrail, Sfd, GR-10, 3" Height, Type I Req'd. | 37 Remove Exist. Pipe |
| 5 Conc. Raised Median, Sfd, MS-1 Req'd. | 16 Sidewalk Underdrain, Sfd, UD-3 Req'd. | 27 Guardrail, Sfd, GR-10, 3" Height, Type II Req'd. | 38 Abandon and Plug Exist. Pipe |
| 6 Conc. Raised Median, Sfd, MS-1A Req'd. | 17 Pavement Underdrain, Sfd, UD-4 Req'd. | 28 Guardrail, Sfd, GR-10, 3" Height, Type III Req'd. | 39 Adj. Exist. Structure |
| 7 Grass Raised Median, Sfd, MS-2 Req'd. | 18 Crossdrain, Sfd, CD-1 Req'd. | 29 Trailing End Terminal, Sfd, GR-MGS3 Req'd. | 40 Clean Out Exist. Structure |
| 8 Entrance Gutter, Sfd, CG-9B Req'd. | 19 Crossdrain, Sfd, CD-2 Req'd. | 30 Fixed Object Att., Sfd, GR-FOA-5 Req'd. | 41 Clean Out Exist. Pipe |
| 9 Entrance Gutter, Sfd, CG-9D Req'd. | 20 Handrail, Sfd, HR-1 Type II Req'd. | 31 Fixed Object Att., Sfd, GR-FOA-2 Req'd. | 42 Full Depth Sawcut |
| 10 Entrance Gutter, Sfd, CG-11 Req'd. | 21 Barbed Wire Fence, Sfd, FE-B Req'd. | 32 Guardrail, Sfd, GR-MGS4 | 43 6" Curb and Dry Gutter, Mod, CG-6 Req'd. |
| 11 Curb Ramp, Sfd, CG-12 Req'd. | 22 Chain Link Fence, Sfd, FE-CL Req'd. | 33 Bridge Pler Protection, Sfd, BPPS-1 | 44 Conc. Median Barrier, Sfd, MB-7F Req'd. |

- | | | | |
|--|-----------------------------|--|--|
| | Denotes Full Depth Pavement | | Denotes Guardrail Bumpout Pavement Section |
| | Denotes Pavement Demolition | | Denotes Mill & Variable Depth Overlay |
| | Denotes Milling and Overlay | | Denotes Construction Limits In Cuts |
| | | | Denotes Construction Limits In Fills |

REFERENCES
(PROFILES, DETAIL & DRAINAGE DESCRIPTION SHEETS, ETC.)

- | | |
|-----------------------|-----------|
| Alignment Data | 1G |
| SWM 3B Detail | 2B(3) |
| SWM 5 Detail | 2B(5) |
| ESC Phase 1 | 2D series |
| ESC Phase 2 | 2E series |
| ESC Phase 3 | 2F series |
| Skiffes Creek Profile | 4A |
| Right-of-Way Plan | 4RW |
| Drainage Descriptions | 16 |
| Storm Sewer Profiles | 17 |

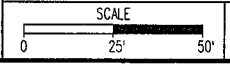

PROJECT	0060-047-627	SHEET NO.	4
---------	--------------	-----------	---