

210004049

BUILDING 36 (DUPLEX)

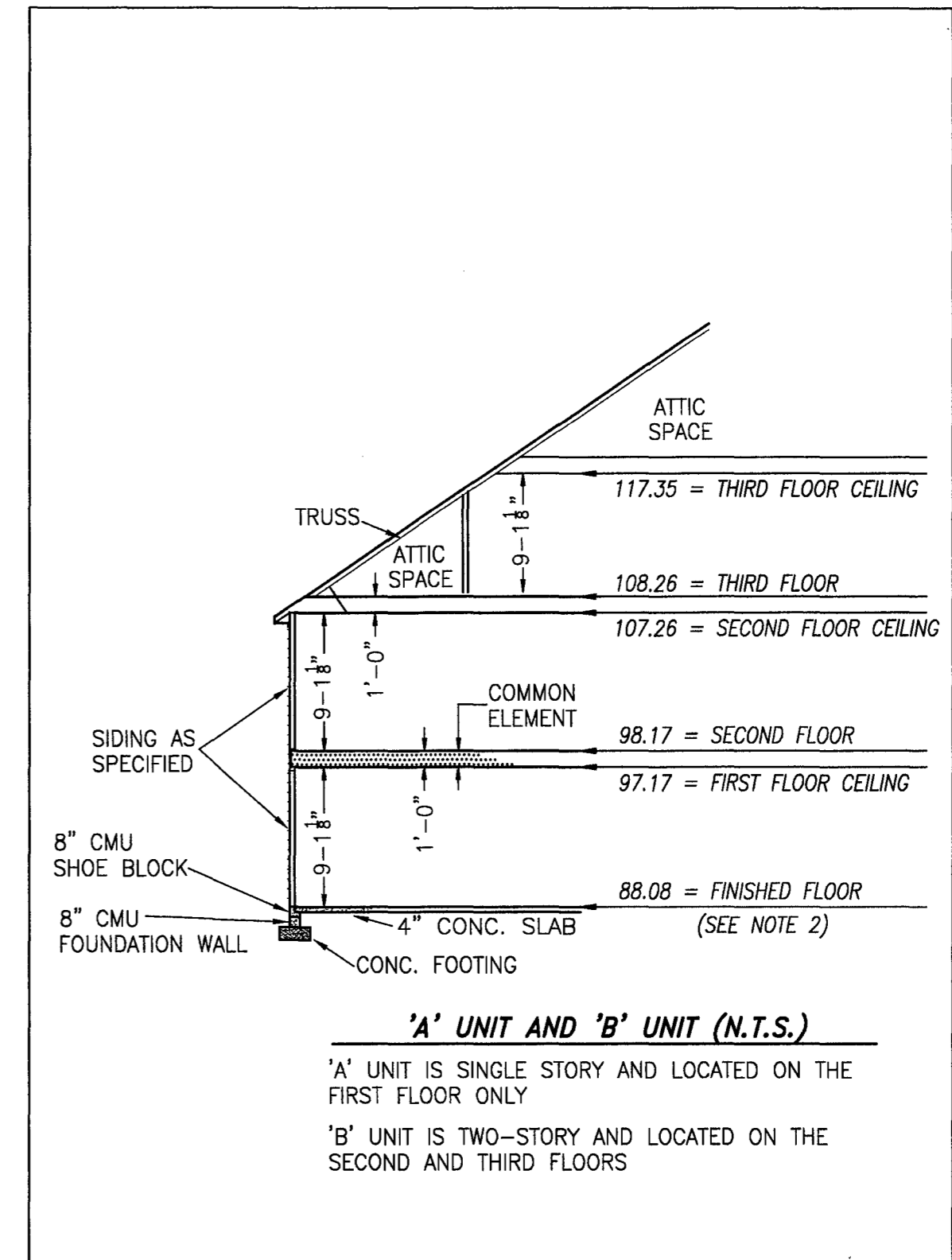
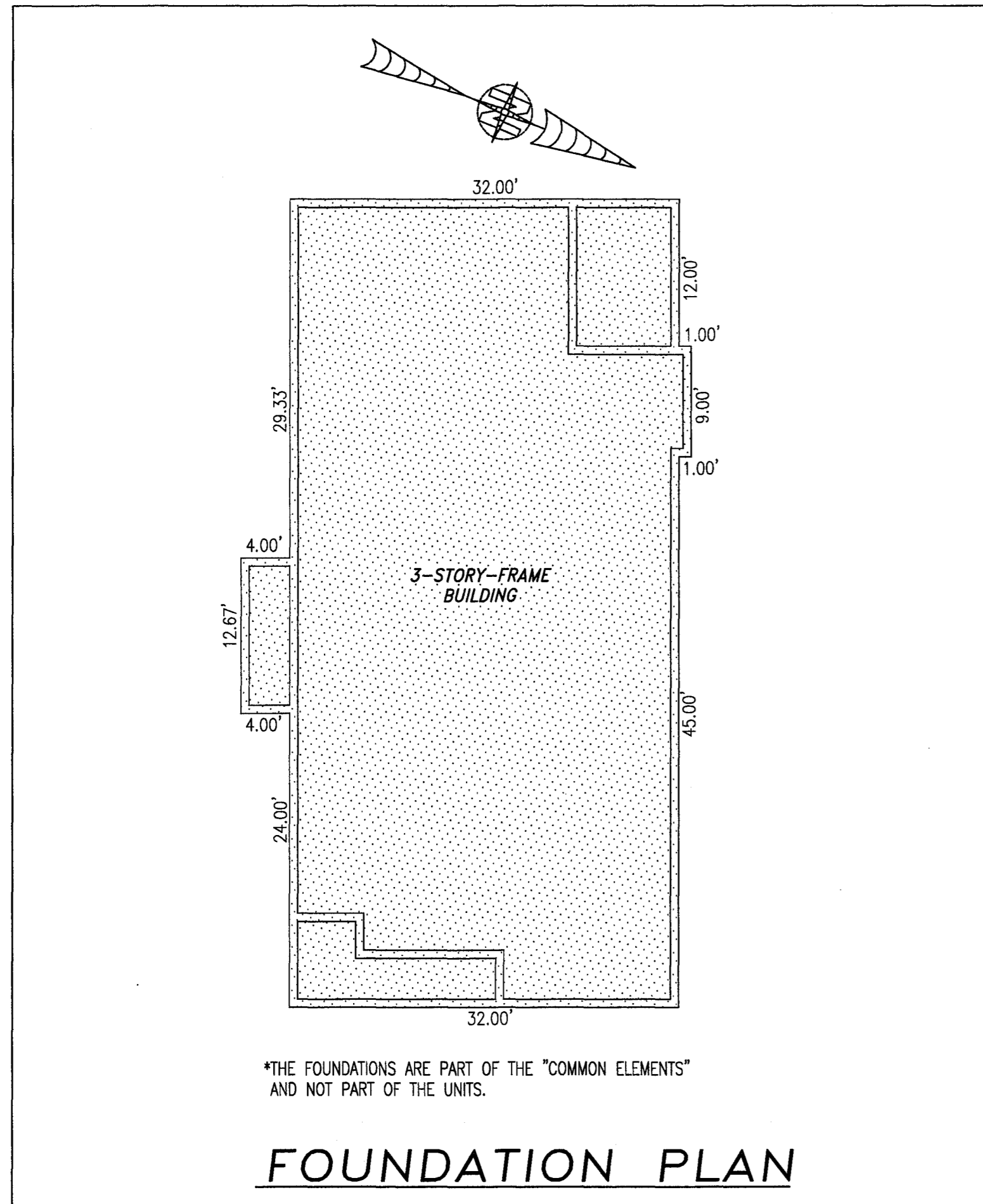

TYPICAL BUILDING SECTION

NOT TO SCALE (N.T.S.)

NOTES:

1. VERTICAL DATUM REFERENCE: NATIONAL GEODETIC VERTICAL DATUM OF 1929 (NGVD29).
2. FINISHED FLOOR ELEVATION SHOWN WAS TAKEN FROM AS-BUILT SURVEY OF BUILDING #36 (DUPLEX) THE PROMENADE AT JOHN TYLER BY HAYDEN FRYE AND ASSOCIATES. FIELD WORK WAS PERFORMED ON 02-09-2021.

50 Large Small Plat(s) Recorded herewith as # 210004049

I HEREBY CERTIFY THAT THIS PLAT IS ACCURATE AND THAT IT COMPLIES WITH THE PROVISIONS OF THE CODE OF VIRGINIA OF 1950 AS AMENDED, § 55.1-1920A & B AND I FURTHER CERTIFY THAT ALL IMPROVEMENTS THEREOF DEPICTED HEREON, PURSUANT TO THE CODE OF VIRGINIA § 55.1-1920B, ARE SUBSTANTIALLY COMPLETE.

City of Williamsburg & County of James City
 Circuit Court: This PLAT was recorded on
 March 3, 2021
 at 2:13 AM (PM) PB PG
 Document # 210004049
 MONA A. FOLEY, CLERK
 Mona A. Foley, Clerk



-INDICATES COMMON ELEMENT

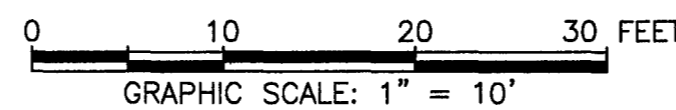

THIS SHEET: FOUNDATION PLAN AND SECTION

PHASE 36
 CONDOMINIUM PLAT AND PLAN
 OF
 THE PROMENADE
 AT
 JOHN TYLER
 A CONDOMINIUM
 JAMES CITY COUNTY, VIRGINIA

Job# 160921

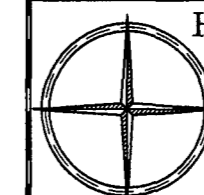

Hayden Frye and Associates, Inc.
 Land Surveyors

333 KELLAM ROAD, SUITE 200
 VIRGINIA BEACH, VA., 23462
 PH: (757) 491-7228 FX: (757) 491-7229

DATE: FEBRUARY 17, 2021
 SCALE: 1"=10'
 SHEET 4 OF 5 THIS PHASE

210004049

BUILDING 36 (DUPLEX)

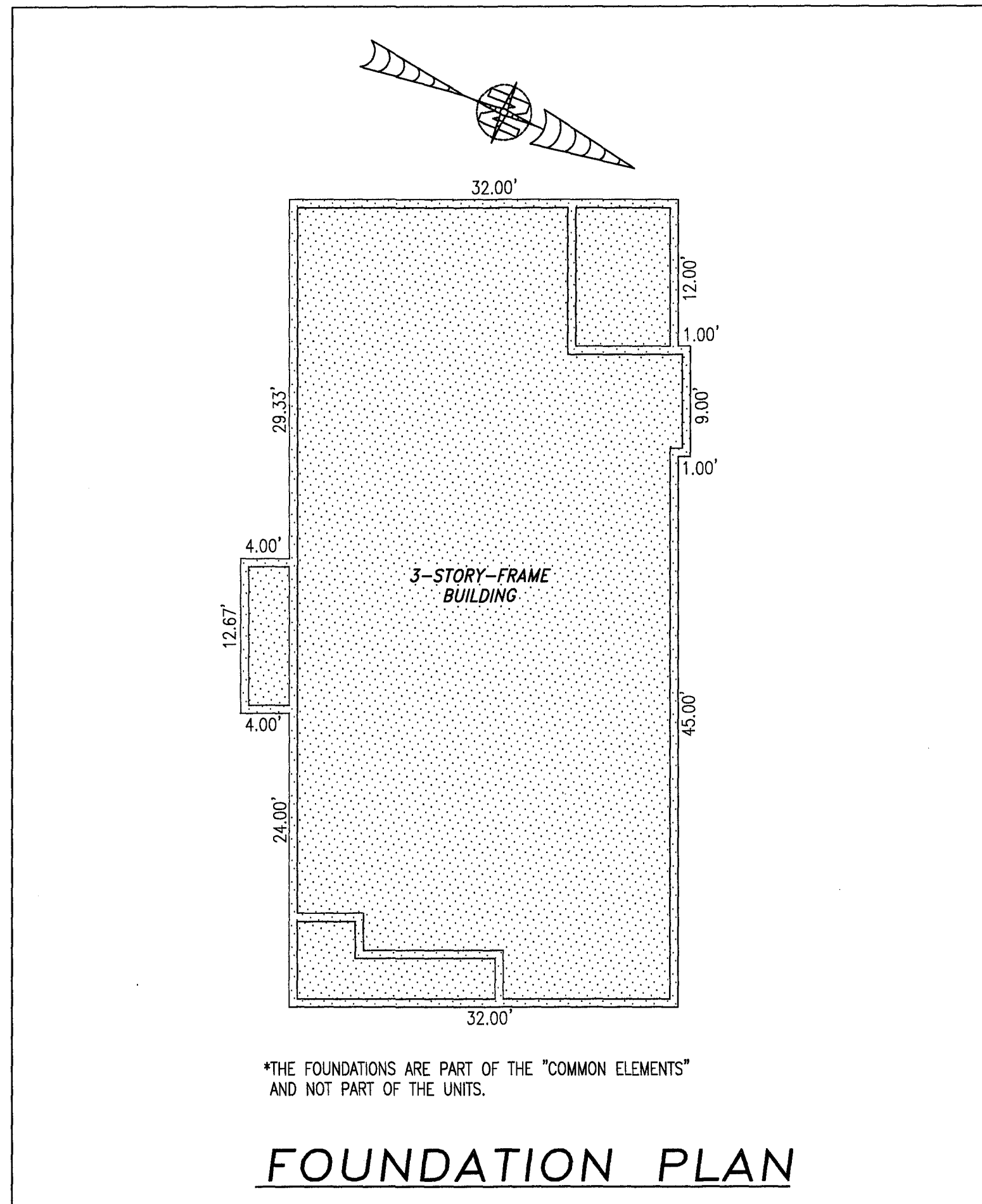

FOUNDATION PLAN

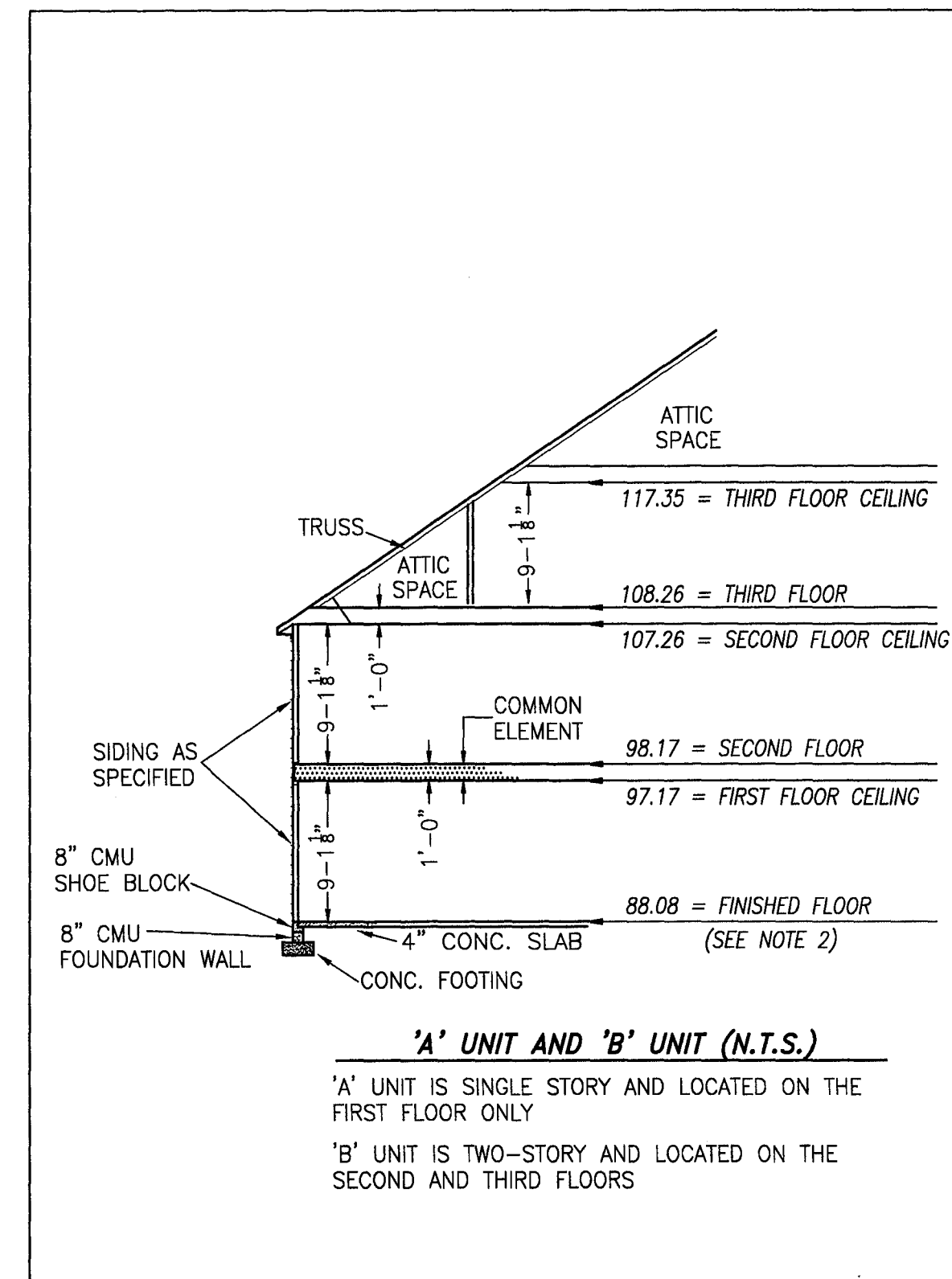

TYPICAL BUILDING SECTION

NOT TO SCALE (N.T.S.)

NOTES:

1. VERTICAL DATUM REFERENCE: NATIONAL GEODETIC VERTICAL DATUM OF 1929 (NGVD29).
2. FINISHED FLOOR ELEVATION SHOWN WAS TAKEN FROM AS-BUILT SURVEY OF BUILDING #36 (DUPLEX) THE PROMENADE AT JOHN TYLER BY HAYDEN FRYE AND ASSOCIATES. FIELD WORK WAS PERFORMED ON 02-09-2021.

5 Large/Small Plat(s) Recorded
 herewith as # 210004049

I HEREBY CERTIFY THAT THIS PLAT IS ACCURATE AND THAT IT COMPLIES WITH THE PROVISIONS OF THE CODE OF VIRGINIA OF 1950 AS AMENDED, § 55.1-1920A & B AND I FURTHER CERTIFY THAT ALL IMPROVEMENTS THEREOF DEPICTED HEREON, PURSUANT TO THE CODE OF VIRGINIA § 55.1-1920B, ARE SUBSTANTIALLY COMPLETE.

City of Williamsburg & County of James City
 Circuit Court: This PLAT was recorded on
 March 3, 2021
 at 2:13 AM (PM) PB PG
 Document # 210004049
 MONA A. FOLEY, CLERK
 Clerk



 -INDICATES COMMON ELEMENT

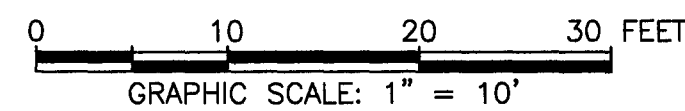

THIS SHEET: FOUNDATION PLAN AND SECTION

PHASE 36
CONDOMINIUM PLAT AND PLAN
 OF
THE PROMENADE
 AT
JOHN TYLER
 A CONDOMINIUM
 JAMES CITY COUNTY, VIRGINIA

Job# 160921

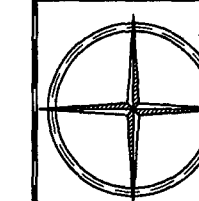

Hayden Frye and Associates, Inc.

Land Surveyors
 333 KELLAM ROAD, SUITE 200
 VIRGINIA BEACH, VA., 23462
 PH: (757) 491-7228 FX: (757) 491-7229

DATE: FEBRUARY 17, 2021

SCALE: 1"=10'

SHEET 4 OF 5 THIS PHASE

210004049

BUILDING 36 (DUPLEX)

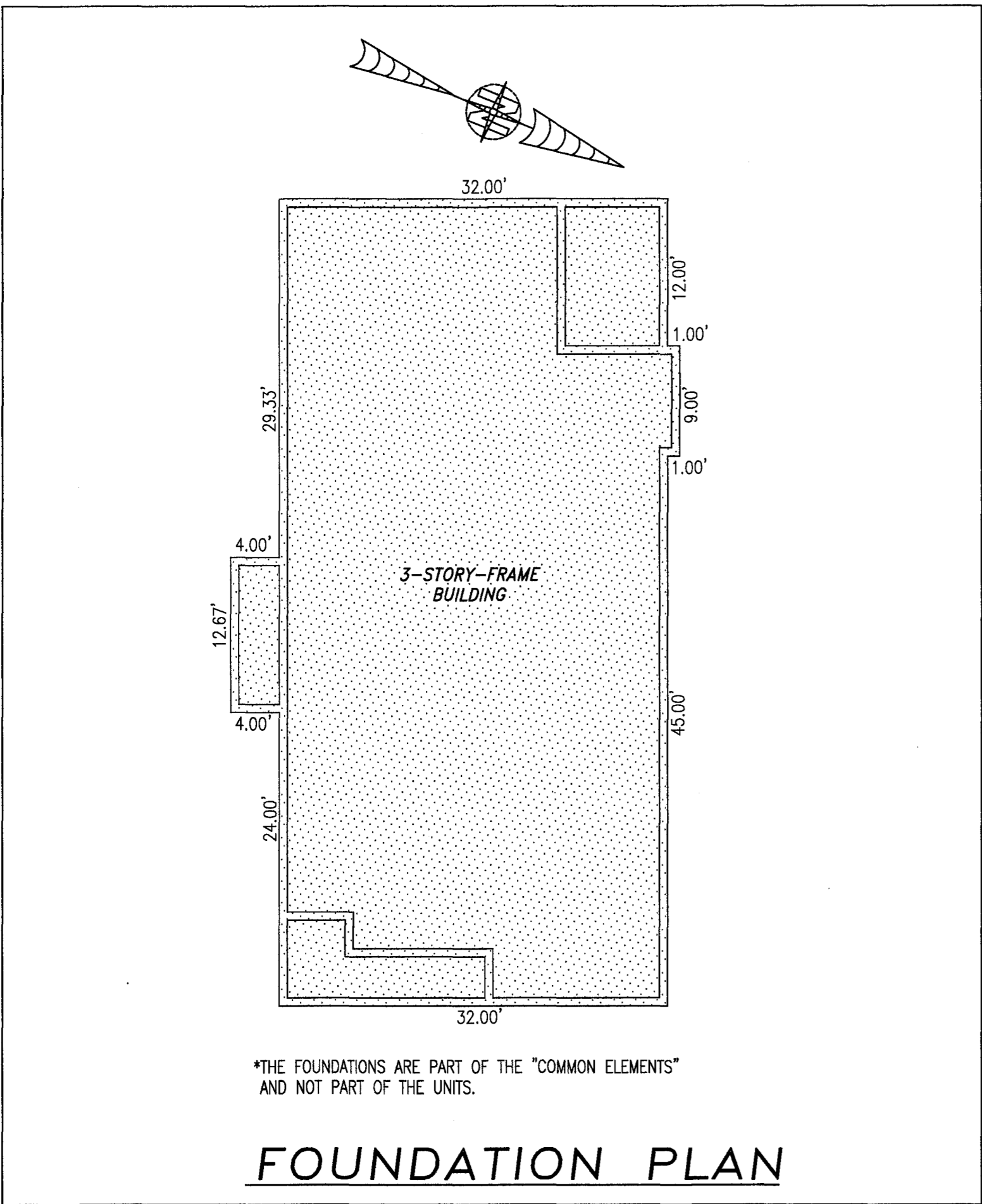

FOUNDATION PLAN

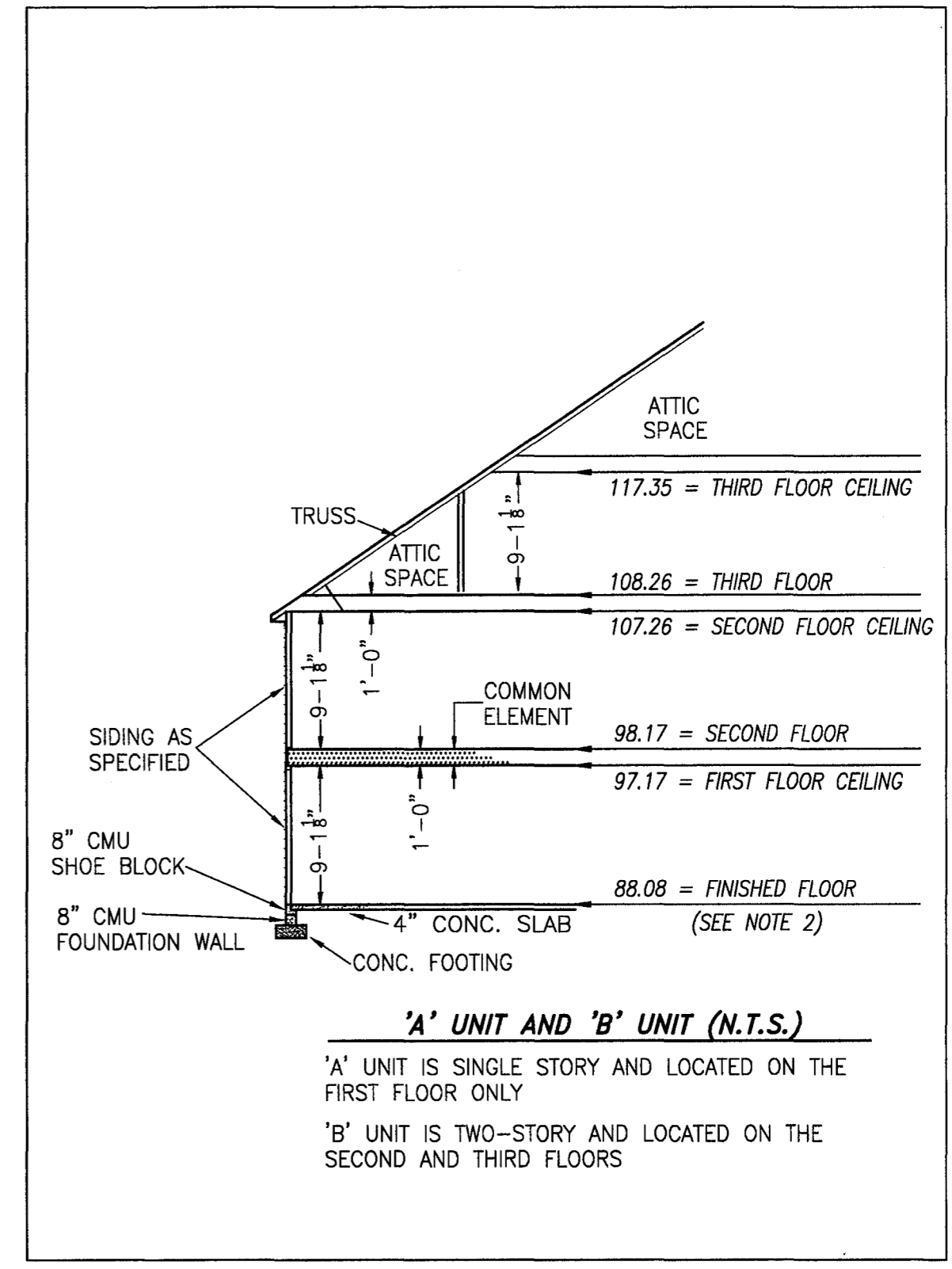

TYPICAL BUILDING SECTION

NOT TO SCALE (N.T.S.)

NOTES:

- VERTICAL DATUM REFERENCE: NATIONAL GEODETIC VERTICAL DATUM OF 1929 (NGVD29).
- FINISHED FLOOR ELEVATION SHOWN WAS TAKEN FROM AS-BUILT SURVEY OF BUILDING #36 (DUPLEX) THE PROMENADE AT JOHN TYLER BY HAYDEN FRYE AND ASSOCIATES. FIELD WORK WAS PERFORMED ON 02-09-2021.

5 Large/Small Plat(s) Recorded
 herewith as # 210004049

I HEREBY CERTIFY THAT THIS PLAT IS ACCURATE AND THAT IT COMPLIES WITH THE PROVISIONS OF THE CODE OF VIRGINIA OF 1950 AS AMENDED, § 55.1-1920A & B AND I FURTHER CERTIFY THAT ALL IMPROVEMENTS THEREOF DEPICTED HEREON, PURSUANT TO THE CODE OF VIRGINIA § 55.1-1920B, ARE SUBSTANTIALLY COMPLETE.

City of Williamsburg & County of James City
 Circuit Court: This PLAT was recorded on
 March 3, 2021
 at 2:13 AM PM PB PG
 Document # 210004049
 MONA A. FOLEY, CLERK
 Clerk



-INDICATES COMMON ELEMENT

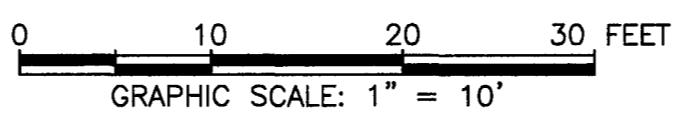

THIS SHEET: FOUNDATION PLAN AND SECTION

PHASE 36
 CONDOMINIUM PLAT AND PLAN
 OF
 THE PROMENADE
 AT
 JOHN TYLER
 A CONDOMINIUM
 JAMES CITY COUNTY, VIRGINIA

Jo# 160921
 Hayden Frye and Associates, Inc.
 Land Surveyors
 333 KELLAM ROAD, SUITE 200
 VIRGINIA BEACH, VA., 23462
 PH: (757) 491-7228 FX: (757) 491-7229

DATE: FEBRUARY 17, 2021
 SCALE: 1"=10'
 SHEET 4 OF 5 THIS PHASE

