

(DC) CONTRACTOR SHALL PROVIDE ADEQUATE DUST CONTROL MEASURES IN ACCORDANCE WITH SPECIFICATION (C-SSM-01) OF THE VIRGINIA STORMWATER MANAGEMENT HANDBOOK TO ENSURE TRAFFIC AND PEDESTRIAN SAFETY ALONG KINGSMILL ROAD.

(PS) CONTRACTOR SHALL PROVIDE ALL DENuded AREAS WITH PERMANENT SEEDING IN ACCORDANCE WITH SPECIFICATION (C-SSM-10) OF THE VIRGINIA STORMWATER MANAGEMENT HANDBOOK.

EROSION AND SEDIMENTATION CONTROL LEGEND

(CIP)		CULVERT INLET PROTECTION (C-SSM-03 WITH STONE COMBINATION INSTEAD OF BILT FENCE)
(PS)		PERMANENT SEEDING (C-SSM-10)
(DC)		DUST CONTROL (C-SSM-01)
(TP)		TREE PROTECTION (C-SSM-01)

NOTE: SEE VIRGINIA STORMWATER MANAGEMENT HANDBOOK CHAPTER 7 FOR EROSION CONTROL SPECIFICATIONS.

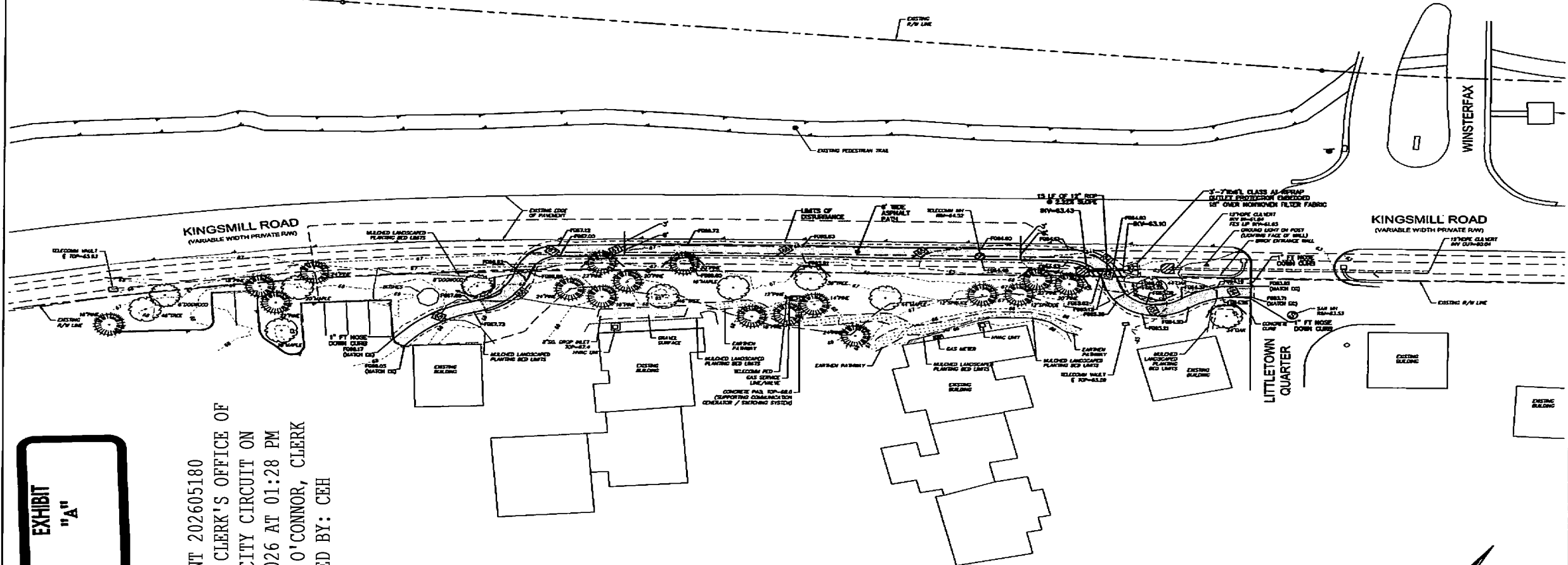

EXHIBIT "A"
Blumberg No. 5119

INSTRUMENT 202605180
RECORDED IN THE CLERK'S OFFICE OF
WMSBG/JAMES CITY CIRCUIT ON
APRIL 30, 2026 AT 01:28 PM
ELIZABETH E. O'CONNOR, CLERK
RECORDED BY: CEH

