

202302256

PLAT OF CORRECTION
SUBDIVISION OF
STONEHOUSE
LAND BAY 5
PHASE 1

LOTS 1 THROUGH 15, 76 THROUGH 92
& M1 THROUGH M43

STONEHOUSE DISTRICT JAMES CITY COUNTY VIRGINIA
DATE: 02/13/2023 JOB # 20-224

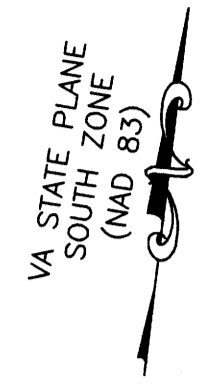
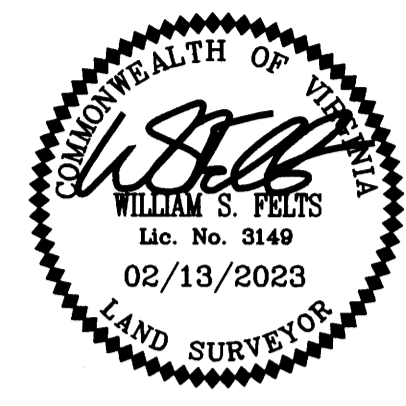

LandTech
Resources, Inc.

Engineering & Surveying Consultants
205 Bulifants Blvd., Suite E, Williamsburg, Virginia 23188
Phone: (757) 565-1677 Fax: (757) 565-0782
web: landtechresources.com

SHEET 2 OF 9

JCC-S-22-0005

SHEET INDEX

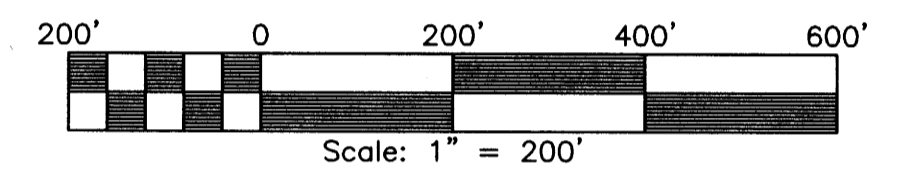

9 Large Small Plat(s) Recorded

herewith as # 202302256

City of Williamsburg & County of James City
Circuit Court: This PLAT was recorded on
March 9, 2023
at 9:51 AM PM, PB PG
Document # 202302256
MONA A. FOLEY, CLERK
Mona A. Foley, Clerk

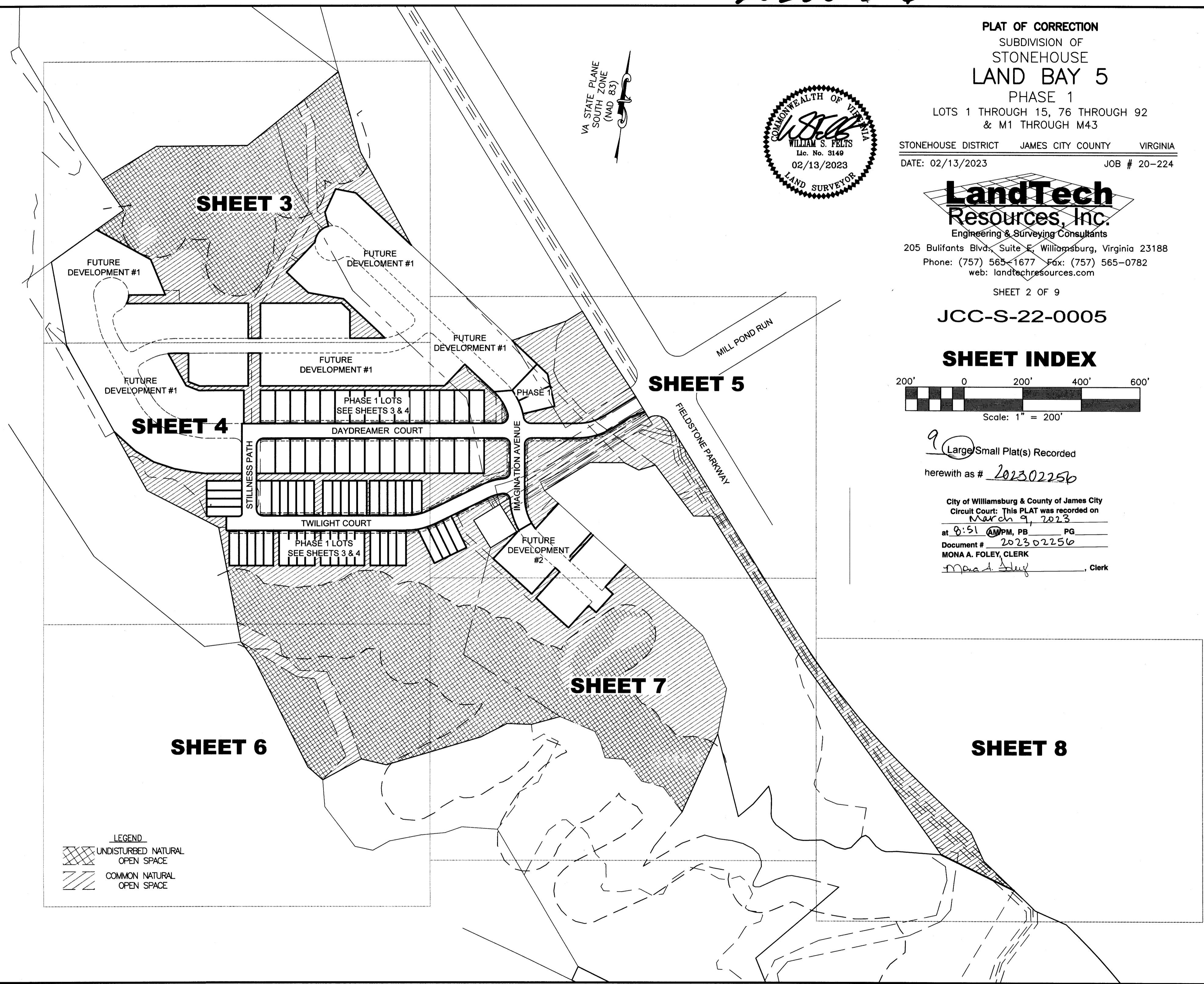

LEGEND
UNDISTURBED NATURAL OPEN SPACE
COMMON NATURAL OPEN SPACE