

202301316

SUBDIVISION OF
STONEHOUSE
LAND BAY 5
PHASE 1

LOTS 1 THROUGH 15, 76 THROUGH 92
& M1 THROUGH M43
STONEHOUSE DISTRICT JAMES CITY COUNTY VIRGINIA
DATE: 09/13/2022 JOB #20-224



Engineering & Surveying Consultants
205 Bulfinch Blvd., Suite E, Williamsburg, Virginia 23188
Phone: (757) 565-1677 Fax: (757) 565-0782
web: landtechresources.com

SHEET 9 OF 9

JCC-S-22-0005

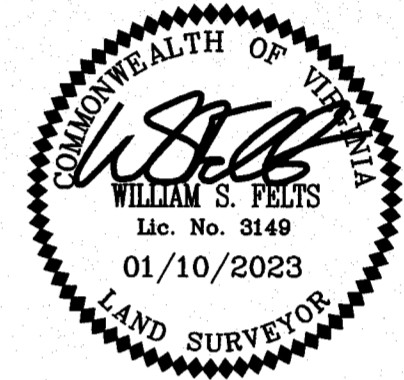

MULTI-FAMILY

LOT AREAS		
LOT NO.	SQUARE FEET	ACRES
M1	3960.00	0.091
M2	3360.00	0.077
M3	3360.00	0.077
M4	3938.54	0.091
M5	6070.27	0.139
M6	3360.00	0.077
M7	3360.00	0.077
M8	3360.00	0.077
M9	3360.00	0.077
M10	3960.00	0.091
M11	3960.00	0.091
M12	3360.00	0.077
M13	3360.00	0.077
M14	3360.00	0.077
M15	3960.00	0.091
M16	3960.00	0.091
M17	3360.00	0.077
M18	3360.00	0.077
M19	3360.00	0.077
M20	3352.75	0.077
M21	3826.24	0.088
M22	3960.00	0.091
M23	3360.00	0.077
M24	3377.51	0.078
M25	4118.31	0.095
M26	3960.00	0.091
M27	3360.00	0.077
M28	3360.00	0.077
M29	3960.00	0.091
M30	3960.00	0.091
M31	3360.00	0.077
M32	3360.00	0.077
M33	3360.00	0.077
M34	3960.00	0.091
M35	3960.00	0.091
M36	3360.00	0.077
M37	3360.00	0.077
M38	3960.00	0.091
M39	3960.00	0.091
M40	3360.00	0.077
M41	3360.00	0.077
M42	3360.00	0.077
M43	3959.69	0.091

SINGLE FAMILY

LOT AREAS		
LOT NO.	SQUARE FEET	ACRES
1	6120.00	0.140
2	6120.00	0.140
3	6120.00	0.140
4	6120.00	0.140
5	6120.00	0.140
6	6120.00	0.140
7	6120.00	0.140
8	6120.00	0.140
9	6120.00	0.140
10	6120.00	0.140
11	6120.00	0.140
12	6120.00	0.140
13	6120.00	0.140
14	6120.00	0.140
15	7547.28	0.173
76	8235.65	0.189
77	6728.99	0.154
78	5737.50	0.132
79	5737.50	0.132
80	5737.50	0.132
81	5737.50	0.132
82	5737.50	0.132
83	5737.50	0.132
84	5737.50	0.132
85	5737.50	0.132
86	5737.50	0.132
87	5737.50	0.132
88	5737.50	0.132
89	5737.50	0.132
90	5737.50	0.132
91	5737.50	0.132
92	5737.50	0.132

CURVE TABLE

CURVE	RADIUS	ARC LENGTH	TANGENT	CHORD LENGTH	CHORD BEARING	DELTA ANGLE
C1	175.00'	96.41'	49.46'	95.19'	N 63°49'58" E	31°33'51"
C2	225.00'	123.95'	63.59'	122.39'	N 63°49'58" E	31°33'51"
C4	25.00'	34.74'	20.84'	32.01'	S 60°34'37" E	79°37'00"
C5	22.00'	34.56'	22.00'	31.11'	S 34°36'53" W	90°00'00"
C6	175.00'	115.41'	59.89'	113.33'	S 29°16'43" E	37°47'13"
C7	225.00'	110.91'	56.60'	109.79'	S 26°19'48" E	28°14'32"
C8	22.00'	37.03'	24.63'	32.81'	N 60°25'54" W	96°26'44"
C9	175.00'	54.27'	27.36'	54.06'	S 62°27'40" W	17°46'09"
C10	225.00'	46.76'	23.46'	46.68'	N 29°48'14" W	11°54'27"
C11	225.00'	28.08'	14.06'	28.06'	N 57°19'27" E	7°09'00"
C12	225.00'	33.72'	16.89'	33.69'	N 65°11'34" E	8°35'14"
C13	225.00'	39.77'	19.94'	39.72'	N 74°33'02" E	10°07'42"
C14	175.00'	33.79'	16.95'	33.73'	N 67°38'04" E	11°03'44"
C15	175.00'	19.70'	9.86'	19.69'	N 76°23'25" E	6°26'57"
C16	22.00'	34.56'	22.00'	31.11'	S 55°23'07" E	90°00'00"
C17	10.00'	15.71'	10.00'	14.14'	N 34°36'53" E	90°00'00"
C18	25.00'	39.27'	25.00'	35.36'	S 34°36'53" W	90°00'00"
C19	25.01'	44.71'	31.12'	38.99'	N 28°22'59" E	102°25'37"
C20	174.61'	91.34'	46.74'	90.30'	N 42°03'42" W	29°58'20"
C21	225.00'	12.10'	6.05'	12.10'	N 22°18'34" W	3°04'54"
C22	175.00'	16.78'	8.40'	16.78'	S 76°52'02" W	5°29'43"
C23	60.00'	30.92'	15.81'	30.58'	N 04°22'47" E	29°31'46"
C24	60.00'	75.21'	43.45'	70.38'	S 29°55'20" W	71°48'58"
C28	2718.12'	693.63'	348.71'	691.75'	S 49°15'35" E	14°37'16"
C29	50.00'	78.54'	50.00'	70.71'	N 86°56'57" W	89°59'56"
C30	175.00'	26.04'	13.05'	26.02'	N 57°50'24" E	8°31'37"
C31	225.00'	82.07'	41.49'	81.61'	S 64°01'32" W	20°53'53"
C32	22.00'	32.58'	20.11'	29.69'	N 32°02'41" E	84°51'35"
C33	22.00'	34.56'	22.00'	31.11'	N 55°23'07" W	90°00'00"
C34	225.00'	41.68'	20.90'	41.62'	S 41°03'53" E	10°36'52"

LINE TABLE

LINE	BEARING	DISTANCE
L1	S 41°56'57" E	35.00'
L2	S 41°56'57" E	59.37'
L3	S 41°56'57" E	25.63'
L4	N 58°37'40" E	51.03'
L5	N 48°03'03" E	74.97'
L6	N 49°32'56" E	50.00'
L7	S 58°02'20" E	20.00'
L8	N 58°02'20" W	10.00'
L9	S 31°57'40" W	85.00'
L10	S 58°02'20" E	35.00'
L11	N 58°02'20" W	35.00'
L12	N 10°23'07" W	25.00'
L13	N 10°23'07" W	23.00'
L14	S 86°32'17" W	57.99'
L15	N 89°44'03" W	54.98'
L16	N 81°55'58" W	73.30'
L17	N 69°44'13" W	73.30'
L18	N 57°40'27" W	96.67'
L19	N 79°36'53" E	52.16'
L20	S 10°23'07" E	97.15'
L21	N 78°49'48" W	41.78'
L22	S 10°23'07" E	112.50'
L23	S 79°36'53" W	41.51'
L24	N 10°23'07" W	112.50'
L25	S 79°36'53" W	41.51'
L26	S 57°03'39" E	39.11'
L27	N 24°10'11" W	48.85'
L28	N 47°24'25" W	106.32'
L29	N 85°27'09" W	77.14'
L30	N 49°19'29" W	94.62'
L31	S 84°19'20" W	65.27'
L32	N 26°36'33" W	53.31'
L33	N 37°28'44" W	43.80'
L34	N 77°20'13" W	128.92'
L40	S 73°54'59" E	55.32'
L41	N 62°49'34" E	59.13'
L42	N 79°49'05" E	62.23'
L43	S 68°12'15" E	28.03'
L44	S 66°32'02" E	61.79'
L45	N 22°56'42" E	24.36'
L46	S 57°01'41" E	45.41'
L47	S 13°50'33" W	18.28'
L48	N 10°23'07" W	44.94'
L49	N 34°36'46" W	18.28'
L50	N 75°05'32" E	62.18'
L51	N 32°49'59" W	24.37'
L52	N 57°03'39" W	44.94'
L53	S 81°17'19" E	24.37'

DEDICATED RIGHT-OF-WAY LINE TABLE

LINE	BEARING	DISTANCE
L100	S 48°03'03" W	125.14'
L101	S 79°36'53" W	205.84'
L102	N 79°36'53" E	916.50'
L103	S 10°23'07" E	315.00'
L104	S 79°36'53" W	78.00'
L105	S 79°36'53" W	536.79'
L106	N 53°34'35" E	199.50'
L107	N 10°23'07" W	40.73'
L108	N 10°23'07" W	186.83'
L109	N 10°23'07" W	4.94'
L110	N 79°36'53" E	24.87'

DEDICATED RIGHT-OF-WAY CURVE TABLE

CURVE	RADIUS	ARC LENGTH	TANGENT	CHORD LENGTH	CHORD BEARING	DELTA ANGLE
C100	200.00'	110.18'	56.53'	108.79'	N 63°49'58" E	31°33'51"
C101	200.00'	52.01'	26.15'	51.87'	N 17°50'08" W	14°54'03"
C102	200.00'	90.89'	46.24'	90.11'	N 66°35'44" E	26°02'18"
C103	200.00'	104.95'	53.71'	103.75'	S 25°25'05" E	30°03'57"
C104	200.00'	90.89'	46.24'	90.11'	S 66°35'44" W	26°02'18"

PROPERTY LINES HEREBY EXTINGUISHED

LINE	BEARING	DISTANCE
L35	S 48°03'03" W	316.93'
L36	N 48°03'03" E	316.93'
L37	S 48°03'03" W	316.93'
L38	S 34°42'38" E	32.35'
L39	N 24°45'57" W	65.88'

PROPERTY LINES HEREBY EXTINGUISHED

CURVE	RADIUS	ARC LENGTH	TANGENT	CHORD LENGTH	CHORD BEARING	DELTA ANGLE
C25	810.00'	273.10'	137.86'	271.81'	N 57°42'52" E	19°19'05"
C26	850.00'	254.93'	128.43'	253.97'	N 56°38'29" E	17°11'02"
C27	890.00'	112.44'	56.30'	112.37'	N 51°40'13" E	7°14'20"

JCSA EASEMENT

LINE	BEARING	DISTANCE
L200	S 41°56'57" E	45.00'
L201	N 48°03'03" E	40.00'
L202	N 41°56'57" W	55.00'
L203	N 48°03'03" E	30.00'

9 Large/Small Plat(s) Recorded
herewith as # 202301316

City of Williamsburg & County of James City
Circuit Court: This PLAT was recorded on
Feb. 6th 2023
at 8:57 AM PB PG
Document # 202301316
MONA A. FOLEY, CLERK
Mona A. Foley, Clerk