

2022/2897

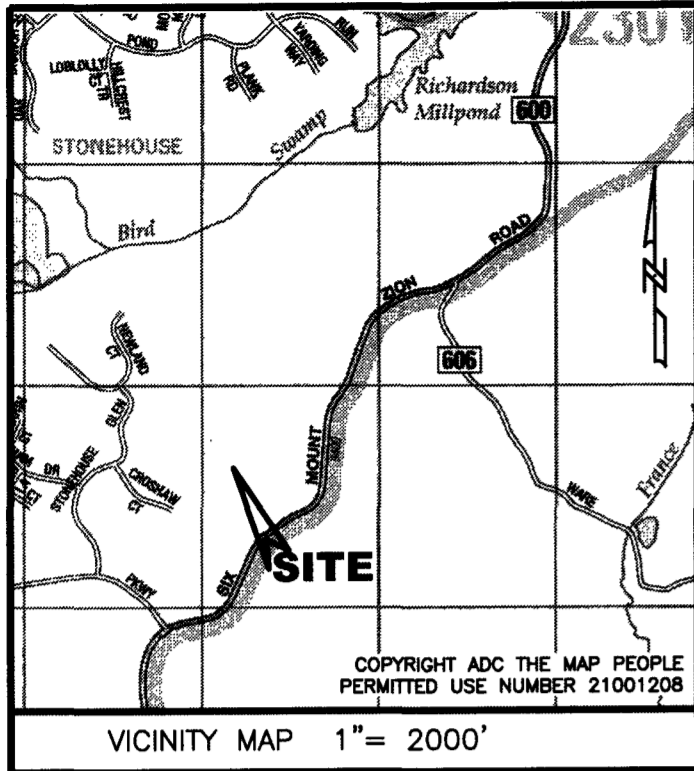

GENERAL NOTES

- 1. EASEMENTS DENOTED AS "JCSA UTILITY EASEMENTS" ARE FOR THE EXCLUSIVE USE OF THE JAMES CITY SERVICE AUTHORITY AND THE PROPERTY OWNER. OTHER UTILITY SERVICE PROVIDERS DESIRING TO USE THESE EASEMENTS WITH THE EXCEPTION OF PERPENDICULAR UTILITY CROSSINGS MUST OBTAIN AUTHORIZATION FOR ACCESS AND USE FROM JCSA AND THE PROPERTY OWNER. ADDITIONALLY, JCSA SHALL NOT BE HELD RESPONSIBLE FOR ANY DAMAGE TO IMPROVEMENTS WITHIN THIS EASEMENT, FROM ANY CAUSE.
2. ANY EXISTING UNUSED WELL(S) SHALL BE ABANDONED IN ACCORDANCE WITH STATE PRIVATE WELL REGULATIONS AND JAMES CITY COUNTY CODE.
3. PROPOSED PARCELS WILL BE SERVED BY PUBLIC WATER AND SEWER.
4. ANY SERVICES REQUIRING ABANDONMENT/RELOCATION OF EXISTING WATER AND/OR SANITARY SEWER SERVICE CONNECTIONS SHALL BE DONE IN ACCORDANCE WITH THE JCSA REQUIREMENTS.
5. WETLANDS AND LAND WITHIN RESOURCE PROTECTION AREAS SHALL REMAIN IN NATURAL UNDISTURBED STATE EXCEPT FOR THOSE ACTIVITIES PERMITTED BY SECTION 23-7 OF THE JAMES CITY COUNTY CODE.
6. NATURAL OPEN SPACE EASEMENTS SHALL REMAIN IN A NATURAL UNDISTURBED STATE EXCEPT FOR THOSE ACTIVITIES REFERENCED ON THE DEED OF EASEMENT.
7. THIS PLAT WAS PRODUCED WITHOUT THE BENEFIT OF A TITLE REPORT AND MAY NOT DEPICT ALL EASEMENTS AND/OR ENCUMBRANCES ON THE SUBJECT PROPERTY.
8. ALL NEW UTILITIES SHALL BE PLACED UNDERGROUND.
9. PROPERTY LIES IN FIRM ZONE "X" ACCORDING TO FLOOD INSURANCE RATE MAP #51095C0041D, DATED DECEMBER 16, 2015.
10. THIS PROPERTY FALLS PARTIALLY WITHIN THE RPA.
11. UNLESS OTHERWISE NOTED, ALL DRAINAGE EASEMENTS DESIGNATED ON THIS PLAT SHALL REMAIN PRIVATE.
12. MONUMENTS SHALL BE SET IN ACCORDANCE WITH SECTIONS 19-34 THROUGH 19-36 OF THE COUNTY CODE.
13. LIMITS OF WETLANDS AND RESOURCE PROTECTION AREA (RPA) SHOWN ON THIS PLAT WERE TAKEN FROM APPROVED DESIGN PLANS TITLED "STONEHOUSE TRACT 3 - PARCEL A & B SUBDIVISION PLAN" DATED AUGUST 4, 2017 PREPARED BY TIMMONS GROUP AND USED WITH THEIR PERMISSION. (JCC CASE #SP-0011-2017)
14. PARCEL A, SECTION 3 IS PLATTING LOT 34 & LOT 35. (2 LOTS)
15. NO BUILDING OR PERMANENT STRUCTURES SHALL BE CONSTRUCTED WITHIN A JCSA UTILITY EASEMENT. NO TREES, SHRUBS, STRUCTURES, FENCES, IRRIGATION MAINS, INVISIBLE PET FENCES OR OTHER OBSTACLES SHALL BE PLACED WITHIN AN EASEMENT WHICH WOULD RENDER THE EASEMENT INACCESSIBLE BY EQUIPMENT. SHRUBS SHALL BE A MINIMUM OF 5 FEET, AND TREES A MINIMUM OF 10 FEET, FROM THE CENTER OF WATER AND SANITARY SEWER MAINS. JCSA WILL NOT BE RESPONSIBLE FOR REPLACEMENT OF TREES AND SHRUBS PLACED WITHIN THE EASEMENT.
16. THIS PROJECT IS ASSOCIATED WITH CASES Z-0004-2007/MP-0004-2007, Z-0006-2012 & Z-19-0010, MP-18-0002, Z-0009-2014 WITH PROFFERS.
17. VDOT SHALL HAVE NO RESPONSIBILITY FOR THE MAINTENANCE OF ANY STORMWATER MANAGEMENT FACILITY OR OUTFALL STRUCTURE LOCATED OUTSIDE OF VDOT MAINTAINED RIGHT OF WAY LIMITS. VDOT SHALL HAVE THE RIGHT TO ENTER ANY STORMWATER MANAGEMENT FACILITY OR OUTFALL STRUCTURE WITHIN THE PROPERTY SHOWN ON THIS PLAT IN ORDER TO UNDERTAKE ANY CORRECTIVE MEASURES TO ALLEVIATE PROBLEMS THAT MAY ADVERSELY AFFECT THE SAFE OPERATION OR INTEGRITY OF ANY VDOT MAINTAINED RIGHT OF WAY. VDOT MAY ALSO ENTER OTHER PROPERTY SHOWN ON THIS PLAT AS COMMON AREA IN ORDER TO OBTAIN ACCESS TO, OR TO UNDERTAKE SUCH CORRECTIVE MEASURES TO, SUCH STORMWATER MANAGEMENT FACILITY OR OUTFALL STRUCTURE. THE OWNER AGREES TO INDEMNIFY AND HOLD VDOT HARMLESS FROM AND AGAINST ANY AND ALL CLAIMS, DEMANDS, LAWSUITS, LIABILITIES, LOSSES, DAMAGES AND PAYMENTS, INCLUDING ATTORNEY'S FEES, CLAIMED BY THE OWNER OR ANY THIRD PARTY AS A RESULT OF VDOT'S ACCESS TO FACILITIES OR STRUCTURES, OR CORRECTIVE MEASURES DESCRIBED ABOVE.
18. PROPOSED RIGHTS-OF-WAY, FOXGLOVE DRIVE & ASTILBE LANE ARE HEREBY DEDICATED FOR PUBLIC USE.
19. THE VIRGINIA DEPARTMENT OF TRANSPORTATION, ITS AGENTS AND ASSIGNS ARE GRANTED THE EXCLUSIVE RIGHT TO MAINTAIN THE AREA DEDICATED FOR PUBLIC USE.

SUBDIVISION OF

STONEHOUSE TRACT 3
PARCEL "A", SECTION 3
LOT 34 & LOT 35

STONEHOUSE DISTRICT JAMES CITY COUNTY VIRGINIA
DATE: 07/22/2022 JOB # 17-378



SHEET 1 OF 3

JCC: S-21-0075

OWNERS CERTIFICATE: SCP-JTL STONEHOUSE OWNER 2 LLC

THE SUBDIVISION OF THE PROPERTY AS SHOWN ON THIS PLAT IS WITH FREE CONSENT AND IN ACCORDANCE WITH THE DESIRES OF THE UNDERSIGNED OWNERS, PROPRIETORS AND OR TRUSTEES.

Signature of Jody D. Lane dated 8/8/22, Owners Rep. Name printed: Jody D. Lane, Title: Owners Rep.

CERTIFICATE OF NOTARIZATION

STATE OF TEXAS
COUNTY OF Dallas
BEFORE ME, Allyson C Macatee, on this day personally appeared Jody D. Lane, known to me or proved to me on the oath of DL to be the person whose name is subscribed to the foregoing instrument and acknowledged to me that he/she executed the same for the purposes and consideration therein expressed.

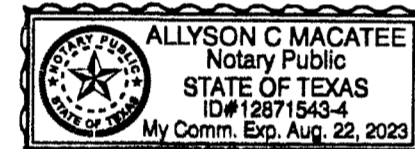

GIVEN UNDER MY HAND AND SEAL OF OFFICE THIS 8 DAY OF August, 2022. Signature of Allyson C Macatee, Notary's Signature.

NOTARY PUBLIC, STATE OF TEXAS

CERTIFICATE OF SOURCE OF TITLE

THIS IS TO CERTIFY THAT THE LAND EMBRACED IN THIS SUBDIVISION STANDS IN THE NAME OF SCP-JTL STONEHOUSE OWNER 2 LLC AND WAS ACQUIRED FROM GS STONEHOUSE GREEN LAND SUB 2, LLC BY THAT CERTAIN DEED DATED APRIL 28, 2016 AND RECORDED IN THE CLERK'S OFFICE OF THE CIRCUIT COURT OF JAMES CITY COUNTY, VIRGINIA AS INSTRUMENT NO. 160007743. THE LAND EMBRACED WAS ALSO ACQUIRED FROM MCP STONEHOUSE LLC BY THAT CERTAIN DEED DATED JULY 6, 2022 AND RECORDED IN THE CLERK'S OFFICE OF THE CIRCUIT COURT OF JAMES CITY COUNTY, VIRGINIA AS INSTRUMENT NO. 202210843. THE LAND EMBRACED WAS ALSO ACQUIRED FROM THE COMMONWEALTH OF VIRGINIA BY THAT CERTAIN DEED DATED MARCH 7, 2022 AND RECORDED IN THE CLERK'S OFFICE OF THE CIRCUIT COURT OF JAMES CITY COUNTY, VIRGINIA AS INSTRUMENT NO. 202206206.

AREA TABULATION

Table with 3 columns: Description, S.F., AC. Rows include: PARCEL "A" SECTION 3 (TOTAL) 42,610 S.F. 0.978 AC., DEDICATED R/W 6,954 S.F. 0.159 AC., SECTION 3 LOTS 7,108 S.F. 0.163 AC., OPEN SPACE #1 13,589 S.F. 0.312 AC., OPEN SPACE #2 14,959 S.F. 0.344 AC.

CERTIFICATE OF APPROVAL

THIS SUBDIVISION IS APPROVED BY THE UNDERSIGNED IN ACCORDANCE WITH WITH EXISTING SUBDIVISION REGULATIONS AND MAY BE ADMITTED TO RECORD.

Signature of Matt Quinn dated 26 Aug 2022, Subdivision Agent of James City County. Signature of Virginia Department of Transportation dated 08/05/22.

ENGINEERS OR SURVEYORS CERTIFICATE

I HEREBY CERTIFY THAT TO THE BEST OF MY KNOWLEDGE OR BELIEF, THIS PLAT COMPLIES WITH ALL OF THE REQUIREMENTS OF THE BOARD OF SUPERVISORS AND ORDINANCES OF THE COUNTY OF JAMES CITY, VIRGINIA, REGARDING THE PLATTING OF SUBDIVISIONS WITHIN THE COUNTY.

Date: 07/22/2022, Signature of Matthew H. Connolly, L.S. 2053.

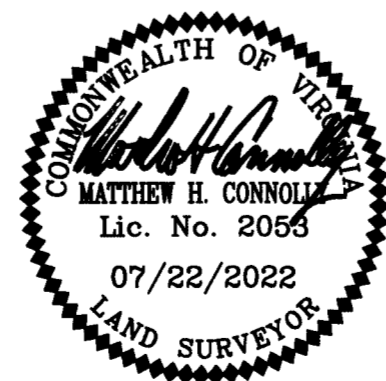

PROPERTY INFORMATION

PARCEL ID: #0540800001A
ZONING DISTRICT: PUD-R PLANNED UNIT DEVELOPMENT WITH PROFFERS
PROPERTY OWNER: SCP-JTL STONEHOUSE OWNER 2 LLC
INST. #160007743
PROPERTY ADDRESS: 9495 ASTILBE LANE TOANO, VIRGINIA 23168

3 Large/Small Plat(s) Recorded herewith as # 202212897

STATE OF VIRGINIA, JAMES CITY COUNTY

IN THE CLERKS OFFICE OF THE CIRCUIT COURT FOR THE COUNTY OF JAMES CITY THIS 26th DAY OF August, 2022. THIS PLAT WAS PRESENTED AND ADMITTED TO RECORD AS THE LAW DIRECTS AT 2:00 pm 202212897. INSTRUMENT # 202212897. TESTE MONA A. FOLEY, CLERK