

200008161

# BUILDING 11 (10-PLEX)

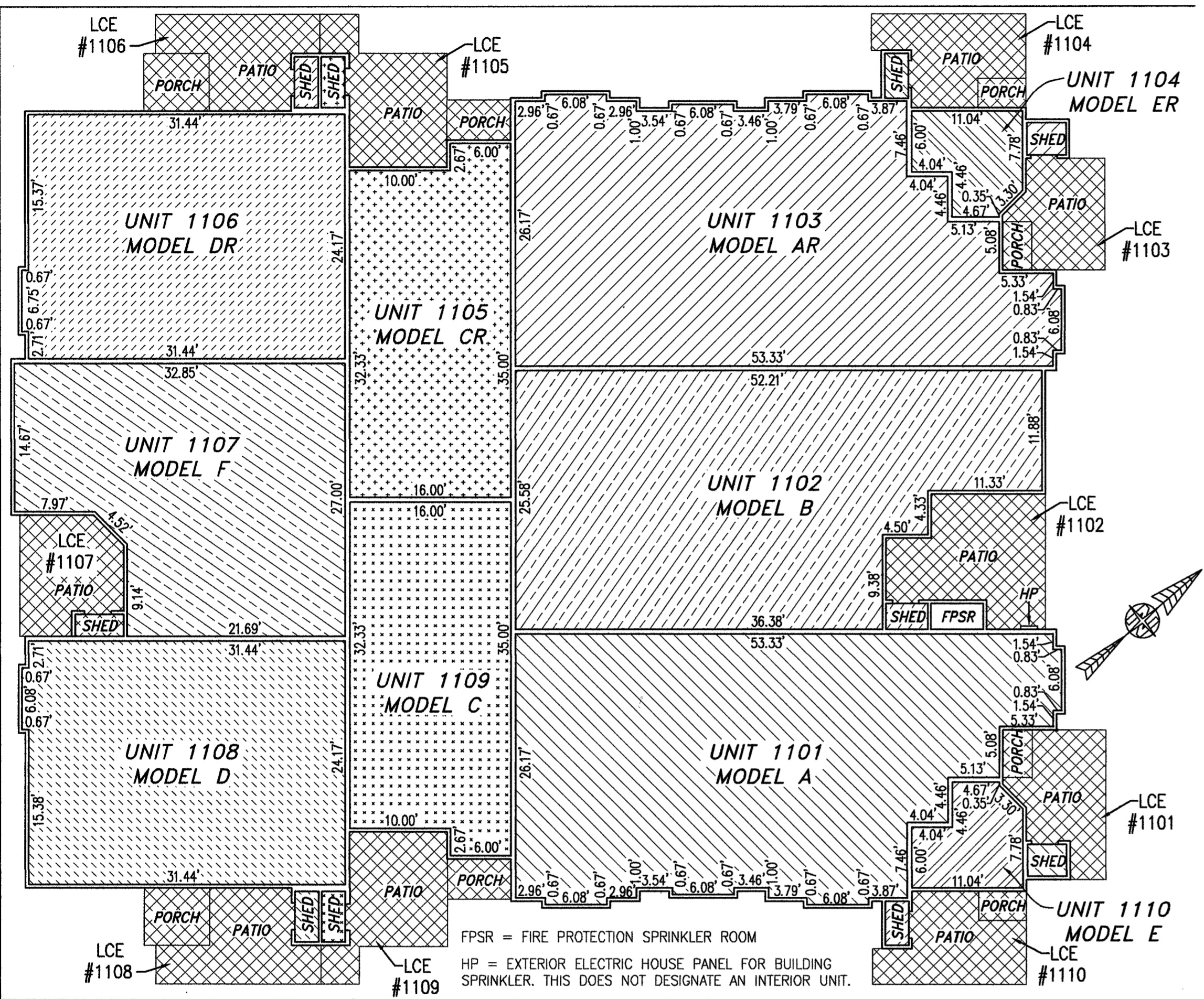

FIRST FLOOR

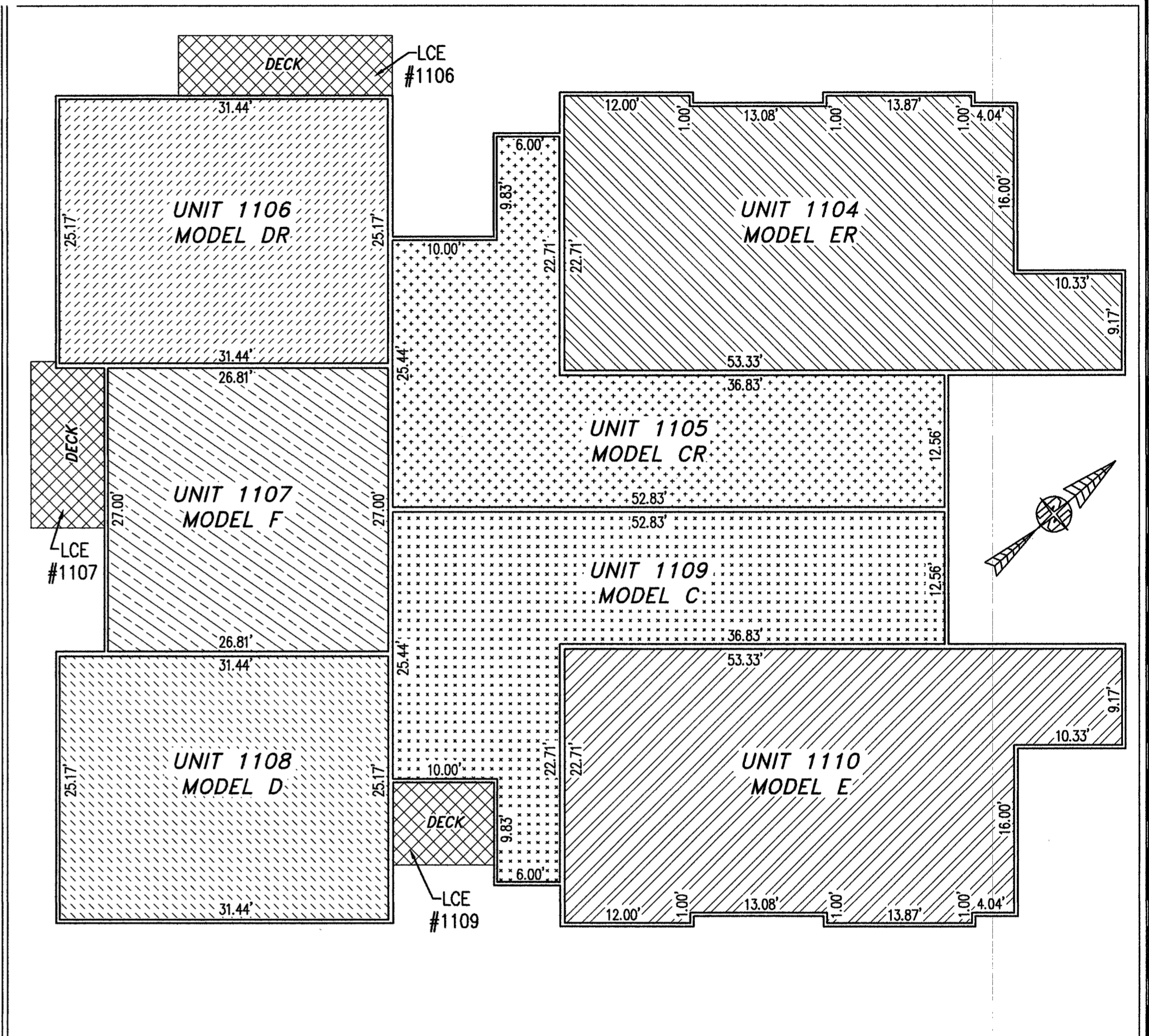

SECOND FLOOR

UNIT ID	UNIT DESCRIPTION	UNIT ADDRESS	PARKING SPACE
A	-INDICATES AREA OF UNIT 1101	#1101 MONARCH COURT	209
B	-INDICATES AREA OF UNIT 1102	#1102 MONARCH COURT	208
AR	-INDICATES AREA OF UNIT 1103	#1103 MONARCH COURT	207
ER	-INDICATES AREA OF UNIT 1104	#1104 MONARCH COURT	206
CR	-INDICATES AREA OF UNIT 1105	#1105 MONARCH COURT	204
DR	-INDICATES AREA OF UNIT 1106	#1106 MONARCH COURT	201
F	-INDICATES AREA OF UNIT 1107	#1107 MONARCH COURT	194
D	-INDICATES AREA OF UNIT 1108	#1108 MONARCH COURT	191
C	-INDICATES AREA OF UNIT 1109	#1109 MONARCH COURT	190
E	-INDICATES AREA OF UNIT 1110	#1110 MONARCH COURT	189
HP	HOUSE PANEL (ELECTRIC)	#1111 MONARCH COURT	N/A
FPSR	FIRE PROTECTION SPRINKLER ROOM	#1112 MONARCH COURT	N/A
	-INDICATES COMMON ELEMENT (EXCLUDING AREAS OUTSIDE OF SUBMITTED LAND)		
	-INDICATES LIMITED COMMON ELEMENT (LCE) ASSIGNED TO A UNIT. # UNIT ASSIGNED		

I HEREBY CERTIFY THAT THIS PLAT IS ACCURATE AND THAT IT COMPLIES WITH THE PROVISIONS OF THE CODE OF VIRGINIA OF 1950 AS AMENDED, § 55.1-1920A & B AND I FURTHER CERTIFY THAT ALL IMPROVEMENTS THEREOF DEPICTED HEREON, PURSUANT TO THE CODE OF VIRGINIA § 55.1-1920B, ARE SUBSTANTIALLY COMPLETE.

City of Williamsburg & County of James City  
 Circuit Court: This PLAT was recorded on  
June 9, 2020  
 at 10:04 AM in PB PG       
 Document # 200008161  
 MONA A. FOLEY, CLERK  
*Mona A. Foley*, Clerk



5 Large/Small Plat(s) Recorded  
 herewith as # 200008161

JCC Subdivision Agent &  
 Approval Not Required

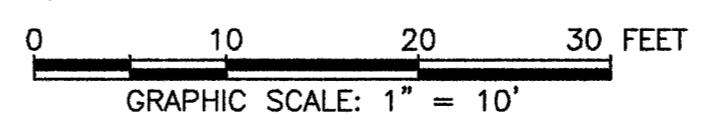

THIS SHEET: FLOOR PLANS

**PHASE 11**  
**CONDOMINIUM PLAT AND PLAN**  
 OF  
**THE PROMENADE**  
 AT  
**JOHN TYLER**  
 A CONDOMINIUM  
 JAMES CITY COUNTY, VIRGINIA

DATE: MAY 26, 2020  
 SCALE: 1"=10'  
 SHEET 5 OF 5 THIS PHASE

Hayden Frye and Associates, Inc.  
**Land Surveyors**  
 333 KELLAM ROAD, SUITE 200  
 VIRGINIA BEACH, VA., 23462  
 PH: (757) 491-7228 FX: (757) 491-7229

Jo# 160921