

200005377

CONSERVATION EASEMENT HEREBY DEDICATED TO JAMES CITY COUNTY (13.95 AC.)

BRICK BAT ROAD STATE ROUTE 613 (30' RW PER P.B. 85/15)

SUBDIVISION OF  
PARCEL ID: 4420100005  
PROPERTY OF J.E. WILSON  
BERKELEY DISTRICT JAMES CITY COUNTY VIRGINIA  
DATE: 01/28/2020 SCALE: 1"=100' JOB # 13-117

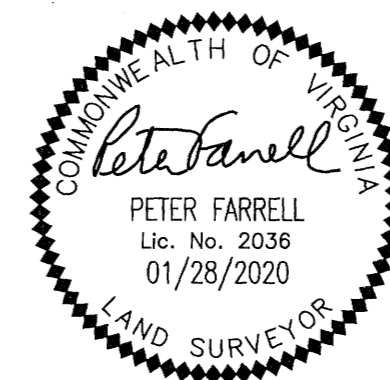

**LandTech Resources, Inc.**  
Engineering & Surveying Consultants  
3925 Midlands Road, Williamsburg, Virginia 23188  
Phone: (757) 565-1677 Fax: (757) 565-0782  
web: landtechresources.com

SHEET 3 OF 3  
JCC: S-19-0111

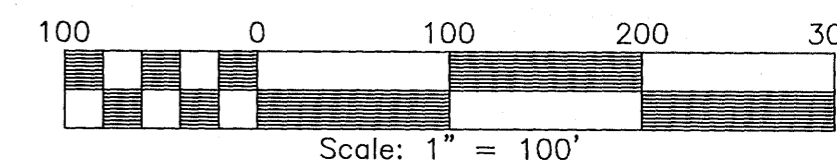

**MATCH LINE THIS SHEET**

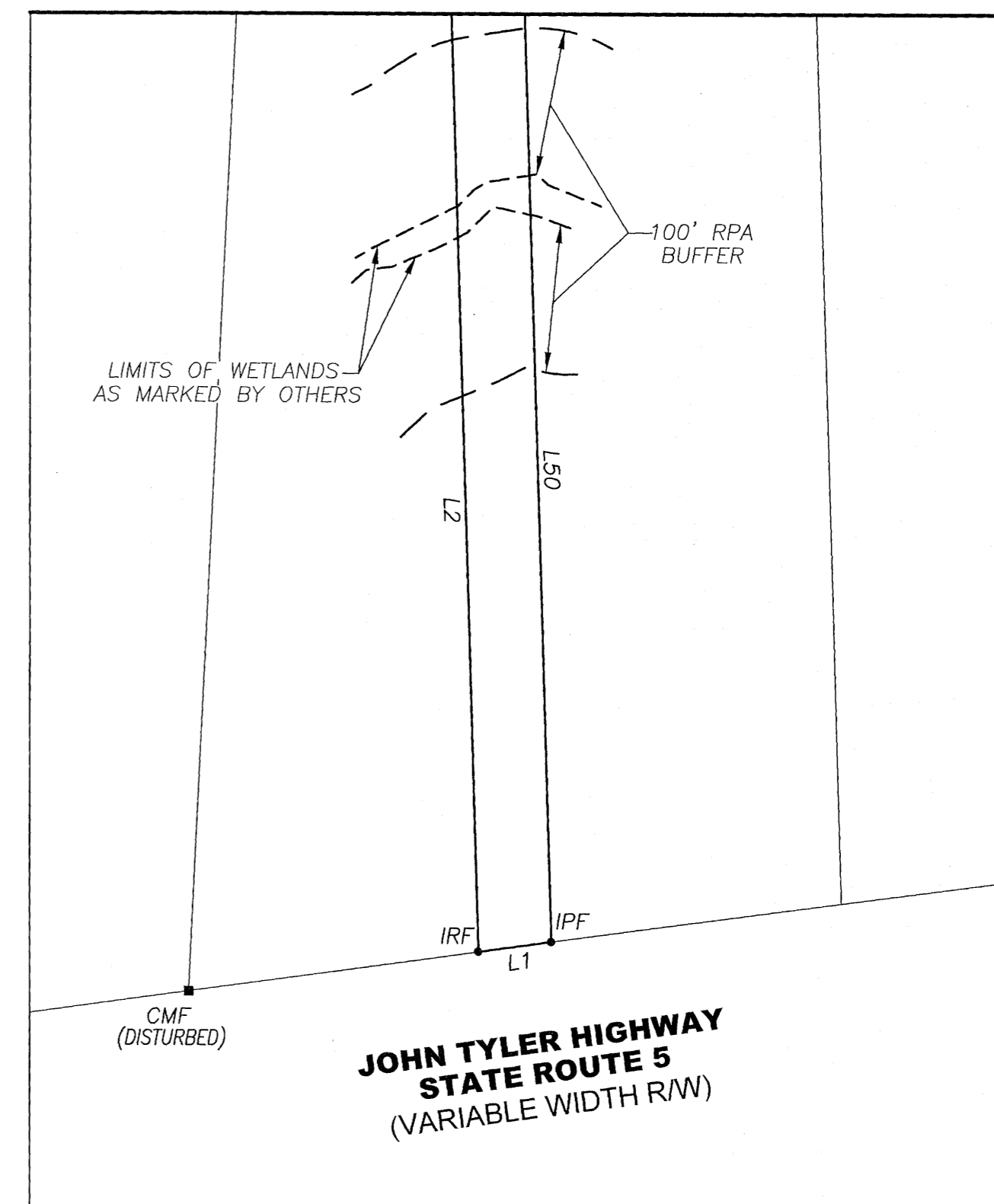

**PARCEL 2 DETAIL**

SEE SHEET 2 FOR OVERALL BOUNDARY  
SEE SHEET 2 FOR EXISTING PROPERTY LINE LINE TABLE  
SEE SHEET 1 FOR ADJOINING PROPERTY DATA.

3 Large Small Plat(s) Recorded  
herewith as # 200005377

**PARCEL 2**  
1,006,559 S.F.  
23.1074 AC.

**PARCEL 1**  
PARCEL ID: 4420100005  
#2900 MONTICELLO AVENUE  
OLD AREA  
4,500,064 S.F.  
103.3073 AC.  
NEW AREA  
3,493,505 S.F.  
80.1999 AC.

**MATCH LINE THIS SHEET**

City of Williamsburg & County of James City  
Circuit Court: This PLAT was recorded on  
April 17, 2020  
at 9:12 PM, PB PG  
Document # 200005377  
MONA A. FOLEY, CLERK  
Mona A. Foley, Clerk