









200004797

EXHIBIT B

LEGEND

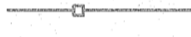
-  PROPOSED PERMANENT DRAINAGE EASEMENT
- R.O.W.** RIGHT OF WAY
- AC.** ACRE
- DB.** DEED BOOK
- PG.** PAGE NUMBER
- PIN#** PROPERTY IDENTIFICATION NUMBER
-  PERMANENT DRAINAGE EASEMENT
-  TEMPORARY CONSTRUCTION EASEMENT
-  PROPERTY LINE
-  WETLAND LINE
-  CENTERLINE OF CREEK OR STREAM
-  WOODEN FENCE
-  METAL FENCE
-  OWNER REFERENCE - ARBITRARY DESIGNATIONS ON OVERALL SITE PLAN

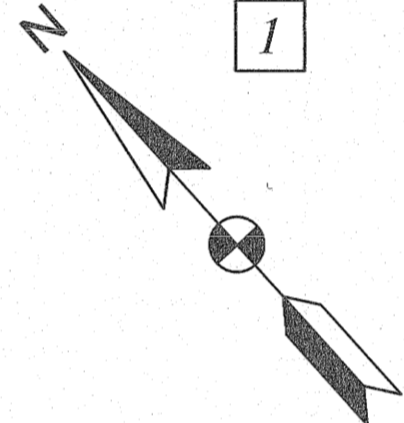
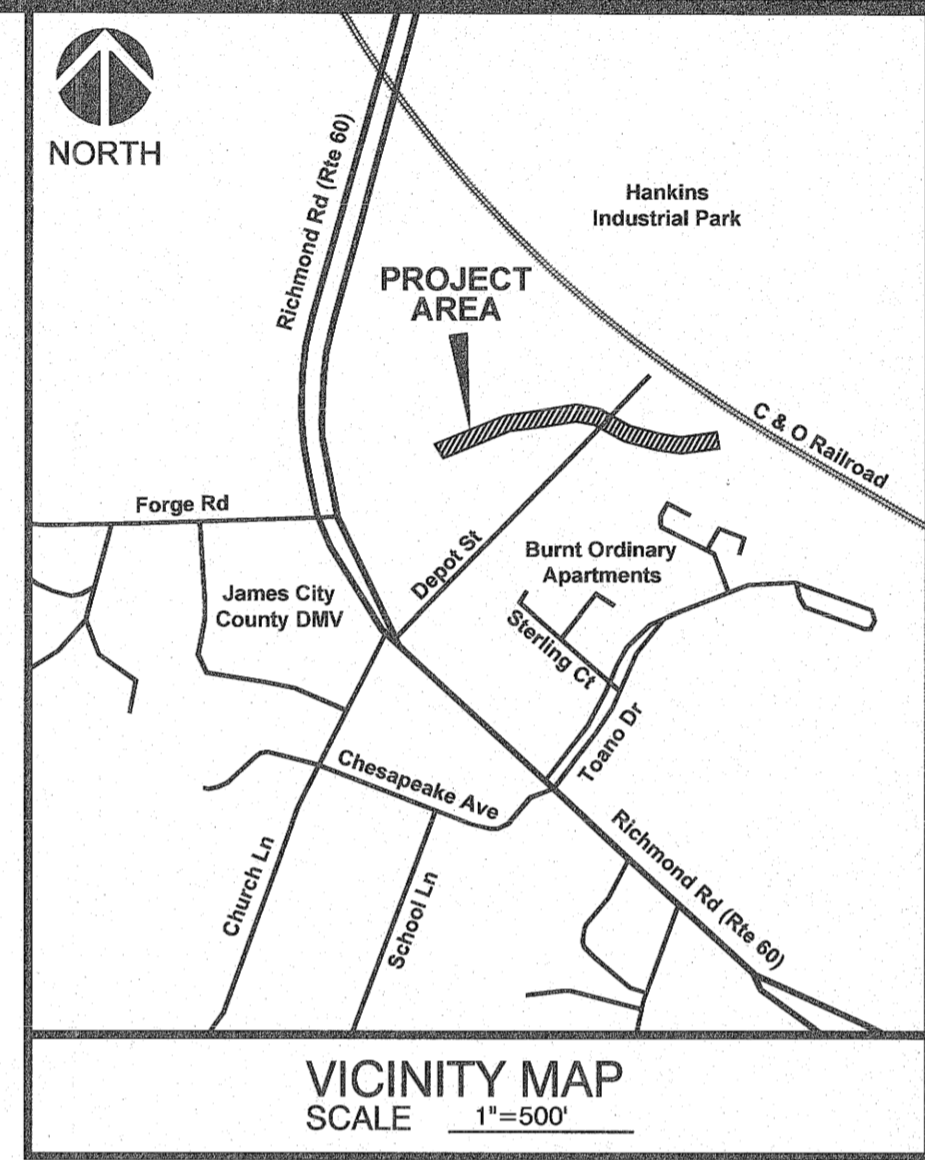

SURVEY NOTES:

1. THIS TOPOGRAPHIC SURVEY WAS COMPLETED UNDER THE DIRECT AND RESPONSIBLE CHARGE OF, JOHN S. CLAYTOR, L.S. FROM AN ACTUAL GROUND SURVEY MADE UNDER MY DIRECT SUPERVISION; THAT THE ORIGINAL DATA WAS OBTAINED ON FEBRUARY 16, 2018; AND THAT THIS PLAT, MAP, OR DIGITAL GEOSPATIAL DATA INCLUDING METADATA MEETS MINIMUM ACCURACY STANDARDS UNLESS OTHERWISE NOTED.
2. THIS FILE IS REFERENCED TO THE VDOT 2014 COORDINATE SYSTEM, NAD83 DATUM, SOUTH ZONE, US SURVEY FEET, GROUND COORDINATE VALUES. THIS COORDINATE BASIS IS ACHIEVED BY TAKING VIRGINIA STATE PLANE COORDINATE AND MULTIPLYING BY THE SCALE FACTOR OF 1.000054093.
3. THE ELEVATIONS DEPICTED IN THIS FILE ARE REFERENCED TO THE NORTH AMERICAN VERTICAL DATUM 1988 (NAVD88).
4. THE HORIZONTAL AND VERTICAL COORDINATE SYSTEMS REFERENCED IN THIS FILE WERE ACHIEVED WITH RTK-GPS SURVEYING TECHNIQUE UTILIZING MULTIPLE AND REDUNDANT OBSERVATIONS VERIFIED TO BE ACCURATE AND WITHIN THE STANDARD ESTABLISHED IN 18 VAC 10-20-382 FOR TOPOGRAPHIC SURVEYS PLOTTED TO A SCALE OF 1" = 40'.
5. THE SURVEYOR WAS NOT PROVIDED A TITLE REPORT. EASEMENTS AND OTHER ENCUMBRANCES OF RECORD MAY NOT BE DEPICTED HEREON, AND MAY BE DISCLOSED IN SUCH A REPORT.
6. UNDERGROUND UTILITIES, SUCH AS GAS, WATER, POWER DISTRIBUTION AND TELECOMMUNICATIONS WERE DESIGNATED BY MISS UTILITY TICKET #A803600193-00A, AND LOCATED IN THE AGREED SCOPE OF SERVICES.

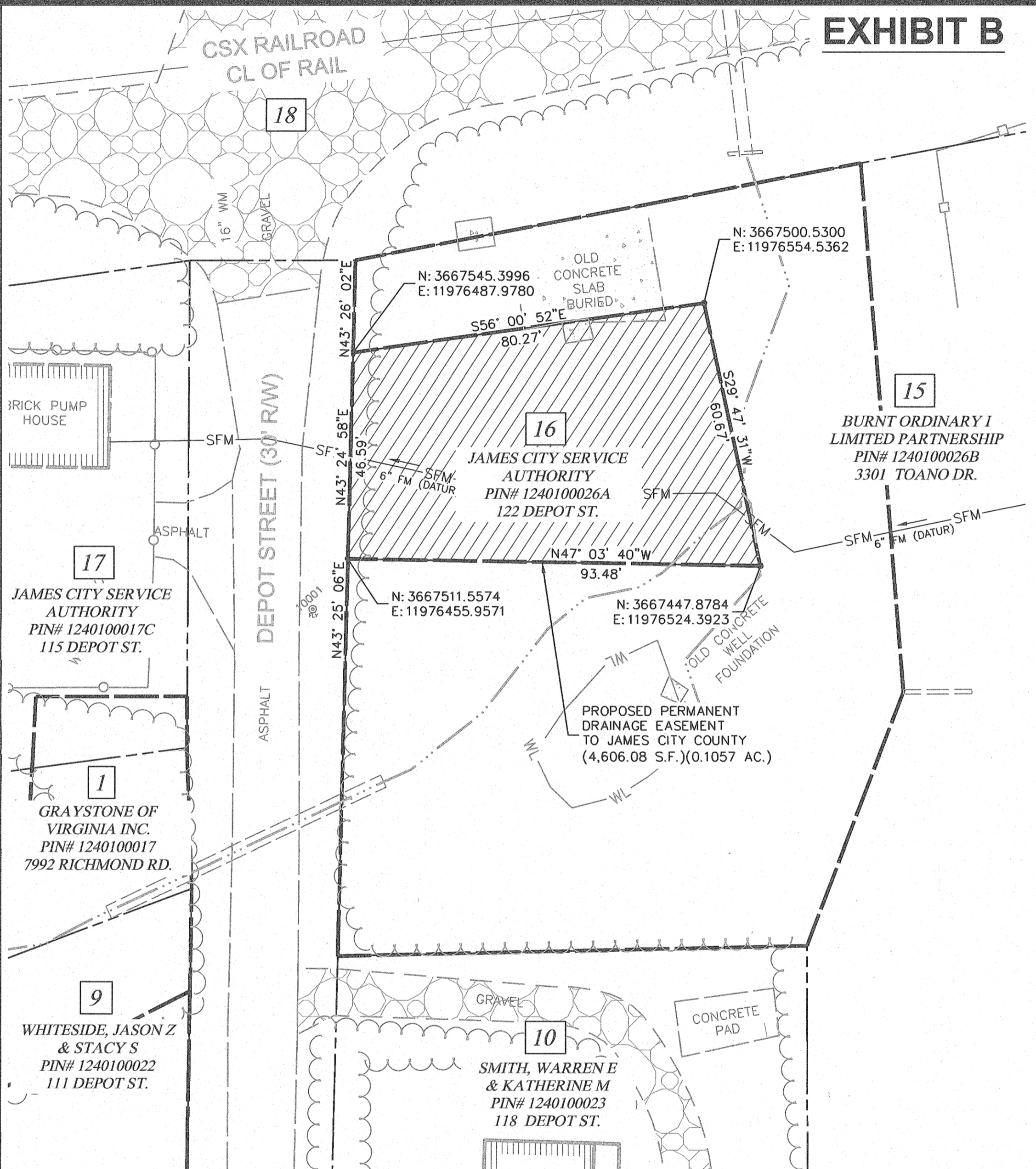

2 Large/Small Plat(s) Recorded herewith as # 200004797

City of Williamsburg & County of James City
Circuit Court: This PLAT was recorded on
April 3, 2020
at 9:14 AM/PM, PE PG
Document # 200004797
MONA A. FOLEY, CLERK
Mona A. Foley, Clerk

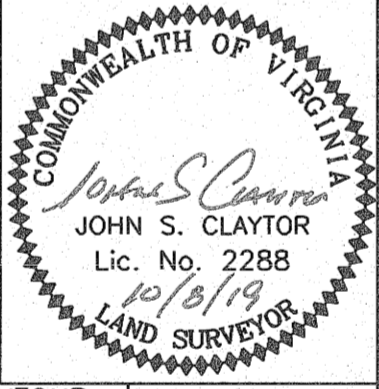
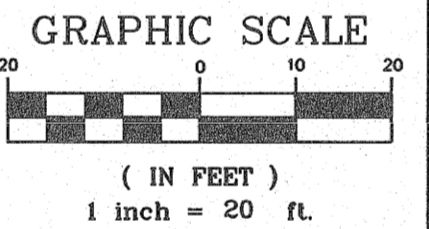

A. MORTON THOMAS AND ASSOCIATES, INC.
ENGINEERS • PLANNERS • SURVEYORS • LANDSCAPE ARCHITECTS
100 GATEWAY CENTRE PARKWAY SUITE 200 - RICHMOND, VA. 23236
PH (804) 276-6231 - FAX (804) 276-6233

RES.	AMT	SURV.	JSC	COMP.	AMT	DES.	AMT	DRN.	LAL	CHK.	JSC
------	-----	-------	-----	-------	-----	------	-----	------	-----	------	-----

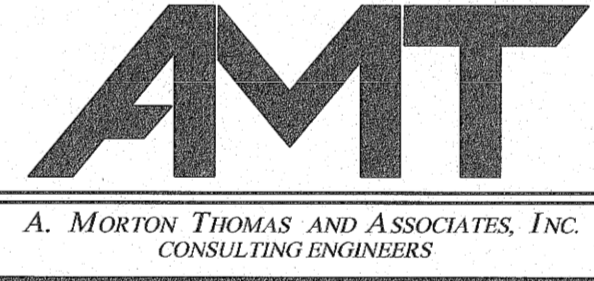

PLAT OF PROPOSED PERMANENT DRAINAGE EASEMENT ACROSS THE PROPERTY OF JAMES CITY SERVICE AUTHORITY PIN# 1240100026A		SCALE 1" = 20'	CONTOUR INTERVAL N/A	AMT FILE No. 15-0127.006
JAMES CITY COUNTY, VIRGINIA		DATE 10/08/2019	TAX MAP No. N/A	SHEET 1 of 1