

20003789

BUILDING 43 (DUPLEX)

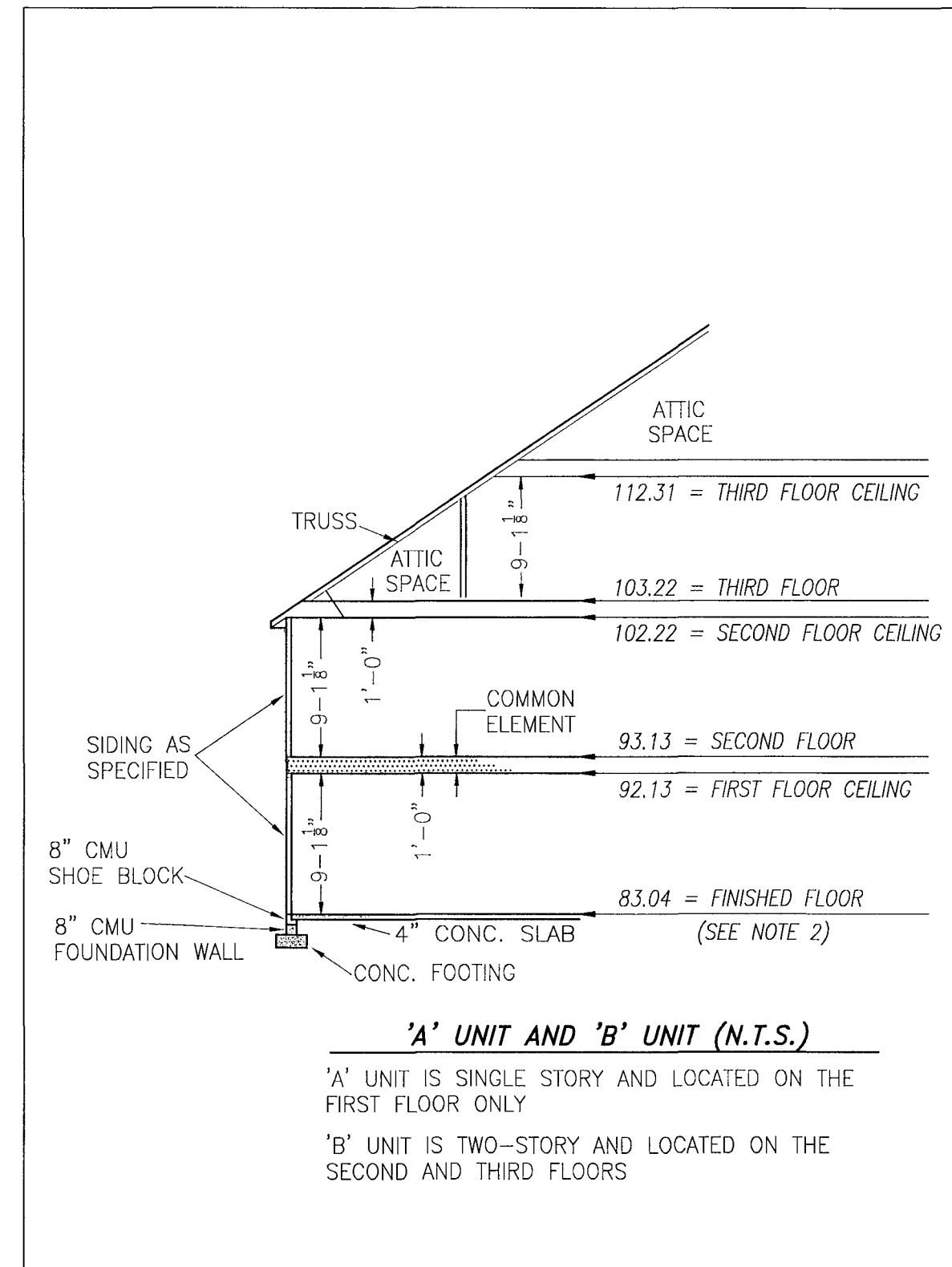
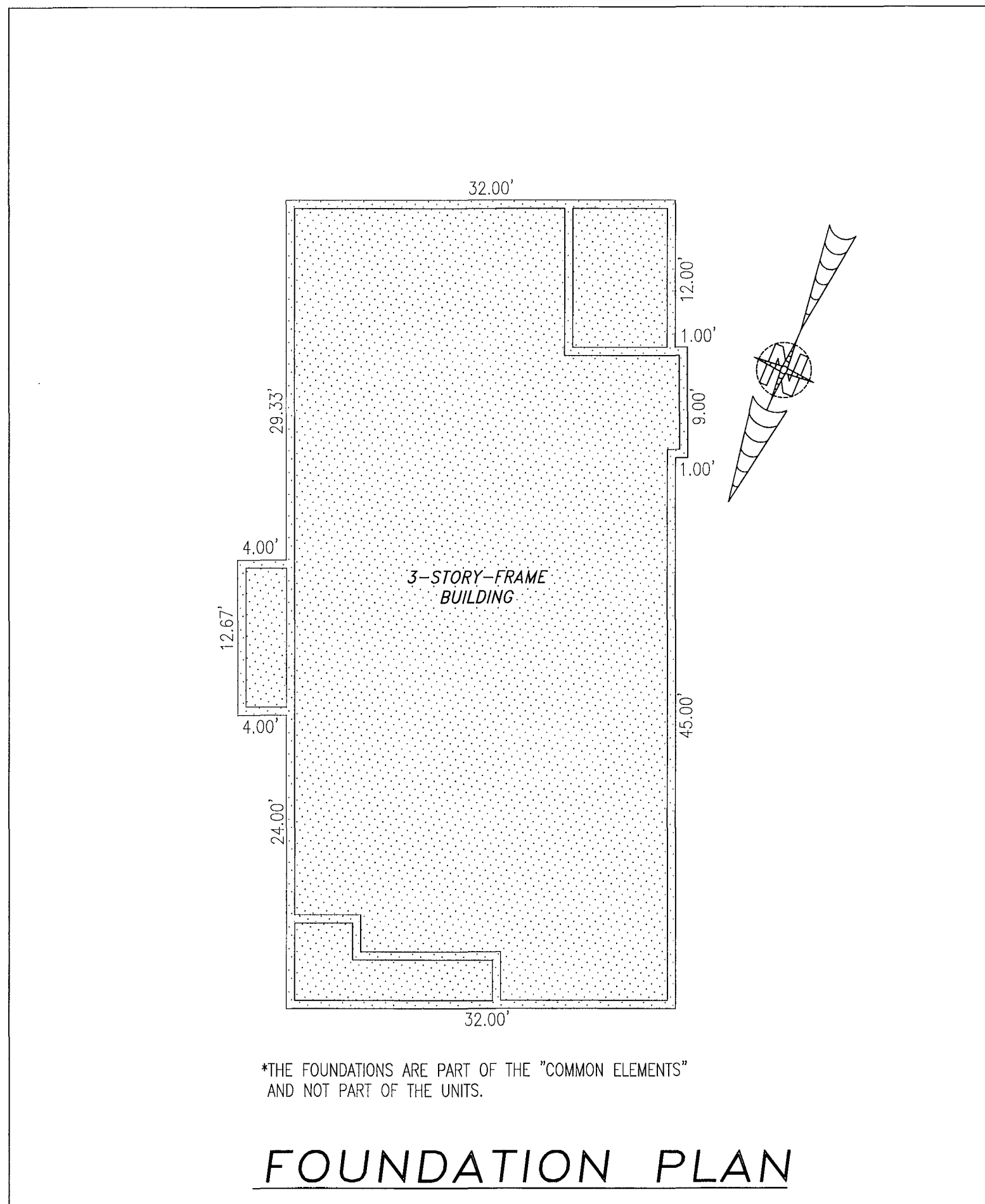

TYPICAL BUILDING SECTION

NOT TO SCALE (N.T.S.)

NOTES:

1. VERTICAL DATUM REFERENCE: NATIONAL GEODETIC VERTICAL DATUM OF 1929 (NGVD29).
2. FINISHED FLOOR ELEVATION SHOWN WAS TAKEN FROM AS-BUILT SURVEY OF BUILDING #43 (DUPLEX) THE PROMENADE AT JOHN TYLER BY HAYDEN FRYE AND ASSOCIATES. FIELD WORK WAS PERFORMED ON 01-26-2020.

I HEREBY CERTIFY THAT THIS PLAT IS ACCURATE AND THAT IT COMPLIES WITH THE PROVISIONS OF THE CODE OF VIRGINIA OF 1950 AS AMENDED, § 55.1-1920A & B AND I FURTHER CERTIFY THAT ALL IMPROVEMENTS THEREOF DEPICTED HEREON, PURSUANT TO THE CODE OF VIRGINIA § 55.1-1920B, ARE SUBSTANTIALLY COMPLETE.

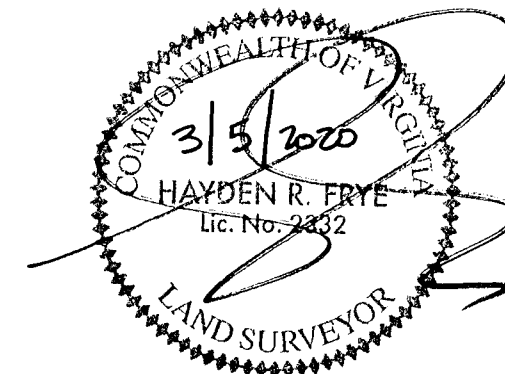

THIS SHEET: FOUNDATION PLAN AND SECTION

PHASE 43
CONDOMINIUM PLAT AND PLAN
 OF
THE PROMENADE
 AT
JOHN TYLER
 A CONDOMINIUM
 JAMES CITY COUNTY, VIRGINIA

Jo# 160921

Hayden Frye and Associates, Inc.
Land Surveyors

333 KELLAM ROAD, SUITE 200
 VIRGINIA BEACH, VA., 23462
 PH: (757) 491-7228 FX:(757) 491-7229

DATE: MARCH 2, 2020

SCALE: 1"=10'

SHEET 4 OF 5 THIS PHASE

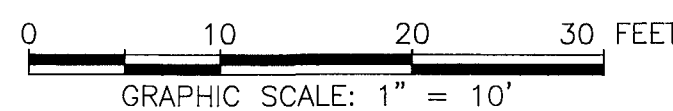
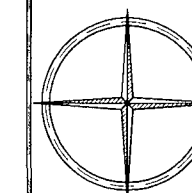

JCC Subdivision Agent
 Approval Not Required *ECW*

FOUNDATION PLAN

—INDICATES COMMON ELEMENT

City of Williamsburg & County of James City
 Circuit Court: This PLAT was recorded on
Mar. 12, 2020
 at 10:15 AM/PM, PB — PG —
 Document # 20003789
 MONA A. FOLEY, CLERK
Mon A. Foley, Clerk

5 Large/Small Plat(s) Recorded
 herewith as # 20003789