

200002243

BUILDING 45 (DUPLEX)

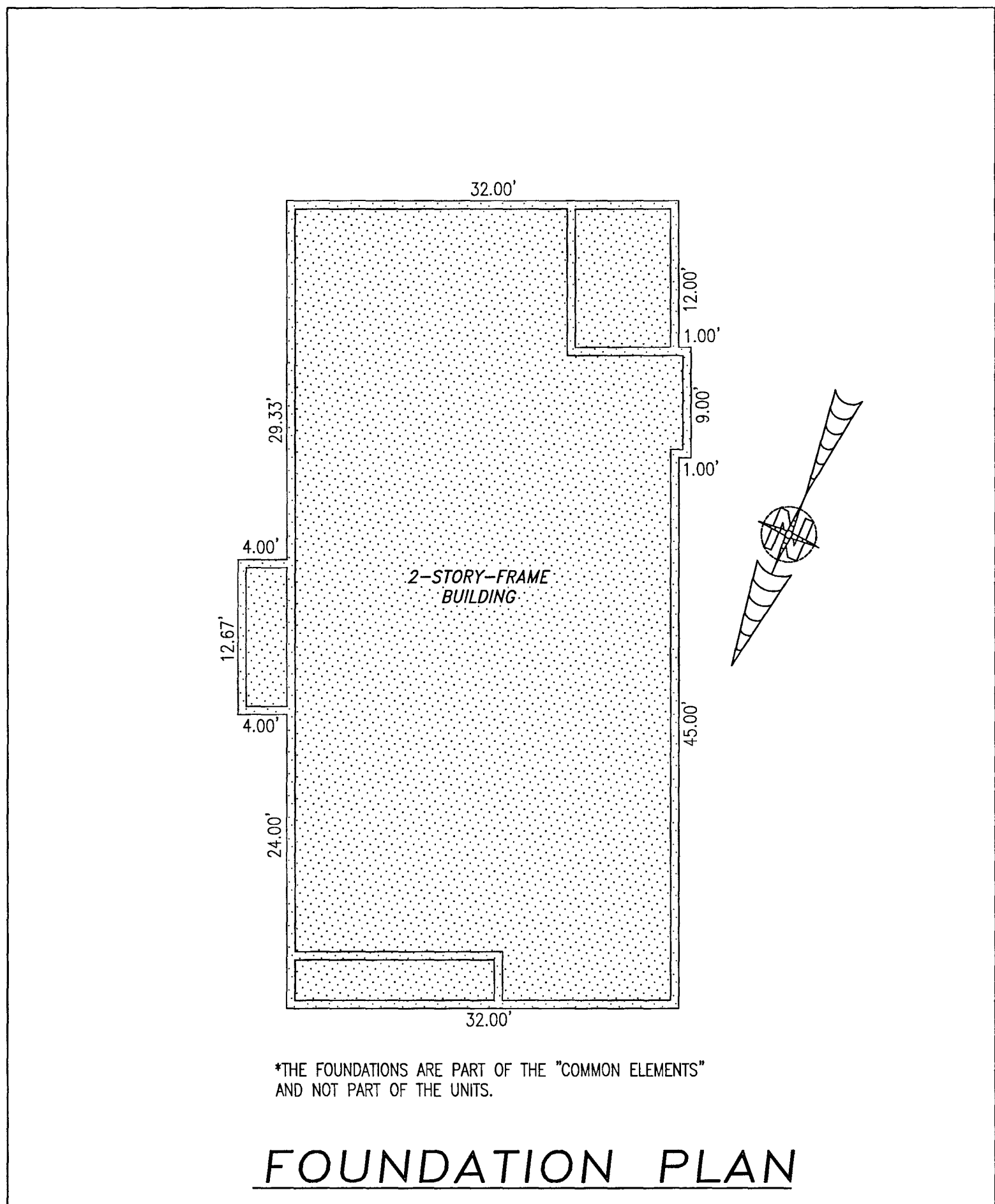

FOUNDATION PLAN

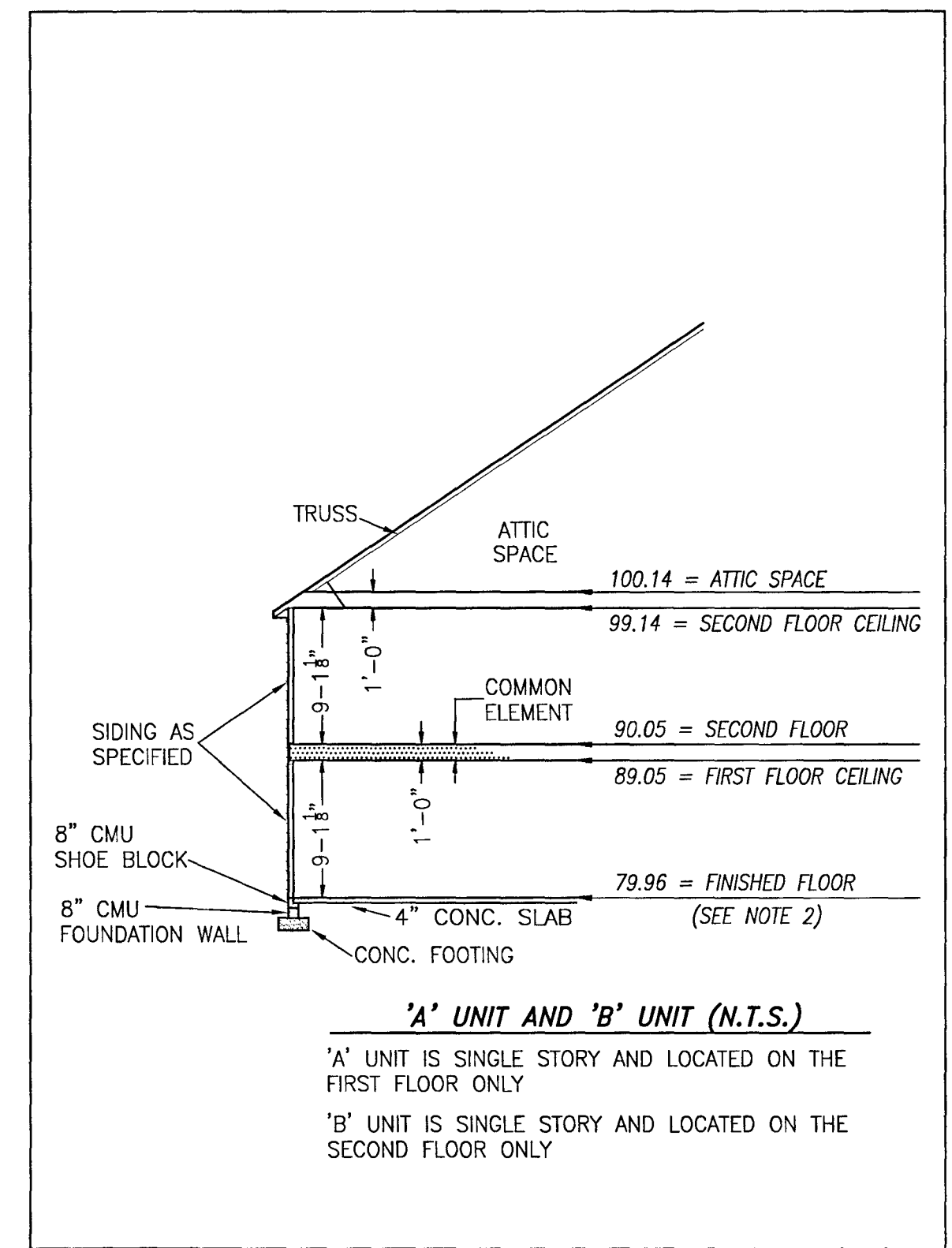

TYPICAL BUILDING SECTION
NOT TO SCALE (N.T.S.)

- NOTES:
1. VERTICAL DATUM REFERENCE: NATIONAL GEODETIC VERTICAL DATUM OF 1929 (NGVD29).
 2. FINISHED FLOOR ELEVATION SHOWN WAS TAKEN FROM AS-BUILT SURVEY OF BUILDING #45 (DUPLEX) THE PROMENADE AT JOHN TYLER BY HAYDEN FRYE AND ASSOCIATES. FIELD WORK WAS PERFORMED ON 01-07-20.

I HEREBY CERTIFY THAT THIS PLAT IS ACCURATE AND THAT IT COMPLIES WITH THE PROVISIONS OF THE CODE OF VIRGINIA OF 1950 AS AMENDED, § 55.1-1920A & B AND I FURTHER CERTIFY THAT ALL IMPROVEMENTS THEREOF DEPICTED HEREON, PURSUANT TO THE CODE OF VIRGINIA § 55.1-1920B, ARE SUBSTANTIALLY COMPLETE.

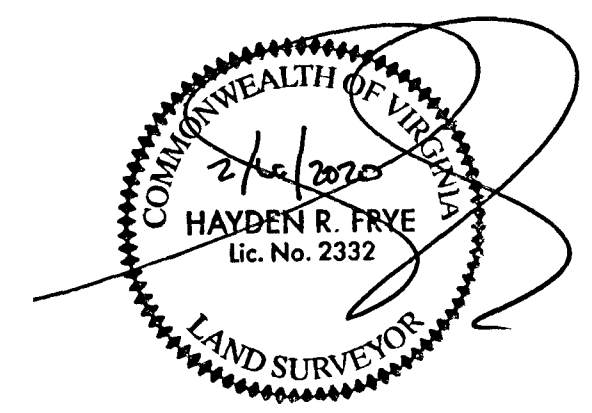

City of Williamsburg & County of James City
Circuit Court: This PLAT was recorded on
Feb. 12, 2020
at 9:39 AM PM, PB — PG —
Document # 200002243
MONA A. FOLEY, CLERK
Mona A. Foley, Clerk

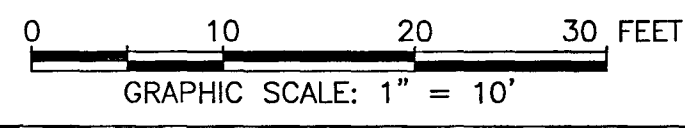

—INDICATES COMMON ELEMENT

5 Large/Small Plat(s) Recorded
herewith as # 200002243

THIS SHEET: FOUNDATION PLAN AND SECTION

PHASE 45
CONDOMINIUM PLAT AND PLAN
OF
THE PROMENADE
AT
JOHN TYLER
A CONDOMINIUM
JAMES CITY COUNTY, VIRGINIA

Jo# 160921

Hayden Frye and Associates, Inc.
Land Surveyors
333 KELLAM ROAD, SUITE 200
VIRGINIA BEACH, VA., 23462
PH: (757) 491-7228 FX: (757) 491-7229

DATE: JANUARY 31, 2020
SCALE: 1"=10'
SHEET 4 OF 5 THIS PHASE

JCC Subdivision Agent
Approval Not Required *EBC*