

PROJECT MANAGER: KEN MCKINNA, P.E. (757) 956-3271
SURVEYED BY: DATE: DANNY B WILLIAMS, L.S. (757) 925-2657
DESIGN BY: N. DIANE GEORGE, (757) 956-3263
SUBSURFACE UTILITY BY: DATE: ACCUMARK, INC. (757) 767-3147

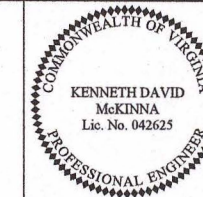

Kenneth D McKinna
2019.09.26 13:03:36-04'00"

VDOT Location & Design
Suffolk, Virginia
ROADWAY ENGINEER

REVISED	STATE	ROUTE	STATE PROJECT	SHEET NO.
04/06/18 09/19/19	VA.	612	0612-047-631, RW-201 C-501	5C

DESIGN FEATURES RELATING TO CONSTRUCTION OR TO REGULATION AND CONTROL OF TRAFFIC MAY BE SUBJECT TO CHANGE AS DEEMED NECESSARY BY THE DEPARTMENT

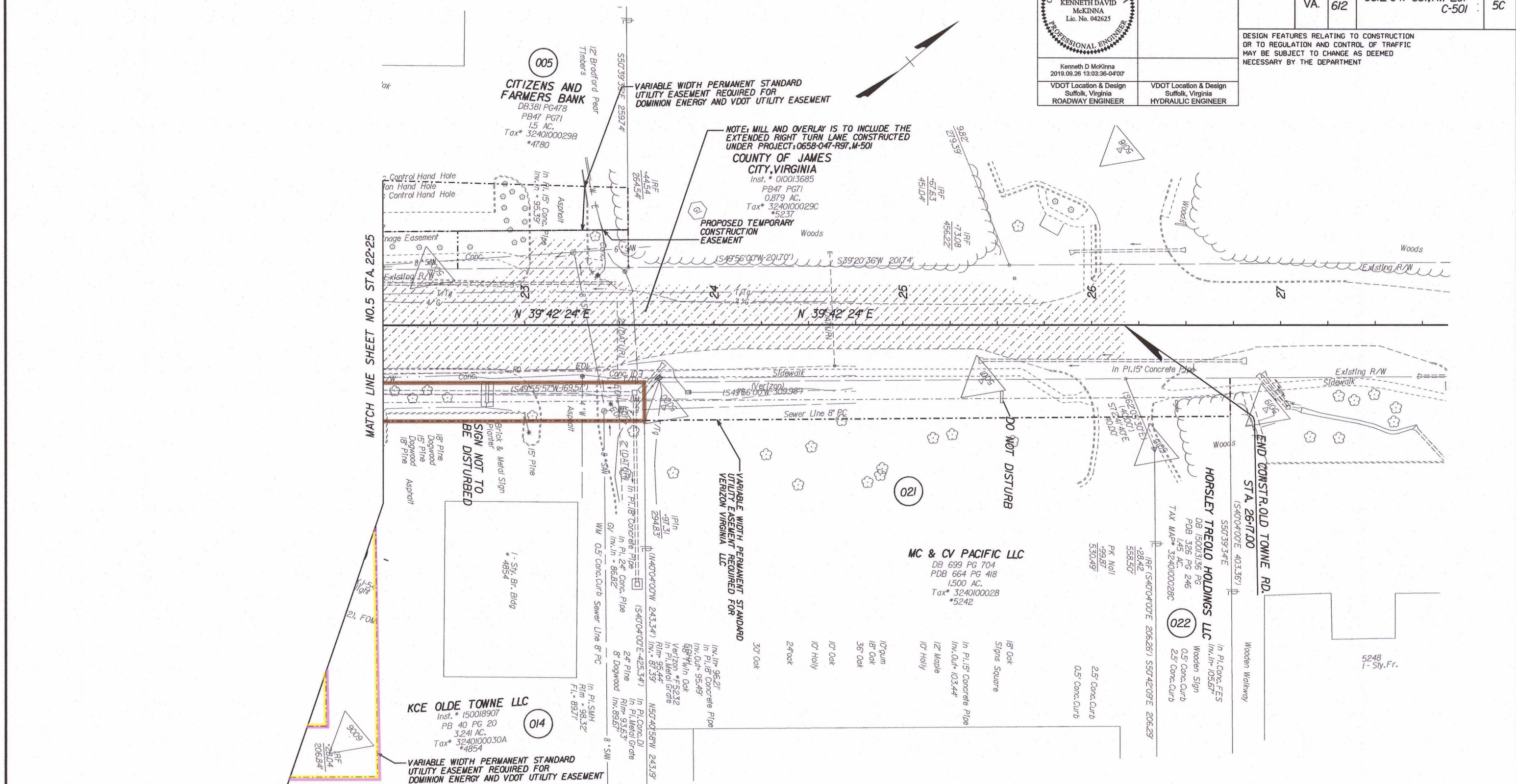

LEGEND
 ○ Denotes Drainage Structure Number
 [C] Denotes Construction Limits In Cuts
 [F] Denotes Construction Limits In Fills
 [X] Denotes Areas Of Demolition of Flexible Pavement.

000 Figures without parentheses or brackets and solid lines denote Proposed Right of Way.
 (00) Figures in parentheses and dot - dashed lines denote Temporary Easements.
 [00] Figures in double brackets and dot - dashed lines denote Permanent Utility Easements.

① Denotes existing structure & pipe to be removed.
 ② Denotes existing structure & pipe to be cleaned out.
 ③ Denotes existing structure & pipe to be abandoned.
 [] Denotes Prop. Pavement
 [] Denotes Pavement to be Milled and Overlayed w/1.5" SM-9.5D

- 1 ST'D. CG-7 REQ'D.
- 2 RAD. CG-7 REQ'D.
- 3 ST'D. CG-3 REQ'D.
- 4 ST'D. MS-2 REQ'D.
- 5 10' SHARED USE PATH
- 6 5' CEM. CONC. SIDEWALK
- 7 RAD. CG-2 REQ'D.
- 8 ST'D. CG-12 REQ'D.
- 9 MOD. CG-12B REQ'D.
- 12 ST'D. RAD. CG-3 REQ'D.

REFERENCES
 (PROFILES, DETAIL & DRAINAGE DESCRIPTION SHEETS, ETC.)
 Mainline Profile
 Drainage Descr.

SCALE 0 25' 50'	PROJECT 0612 - 047 - 631	SHEET NO. 5C
--------------------	-----------------------------	-----------------