

190010655

PROPOSED NEW IMPERVIOUS COVER

THIS PROJECT PROPOSES THE INSTALLATION OF 64 LINEAR FEET OF 5'-0" WIDE CONCRETE SIDEWALKS, 2916 LINEAR FEET OF 10'-0" WIDE ASPHALT CONCRETE WALKING TRAILS, 108 LINEAR FEET OF 5'-0" WIDE GRAVEL PATH, ONE (1) 10'-0" x 10'-0" GROUND MAINTENANCE SHED, ONE (1) 14'-0" DIAMETER TIMBER GAZEBO, AND ONE (1) 10'-0" x 10'-0" CAST-IN-PLACE CONCRETE MONUMENT PEDESTAL. THE TOTAL PROPOSED IMPERVIOUS COVER FOR THIS PROJECT IS 26,360 SQUARE FEET.

RECORD MERIDIAN
INSTR. 170010575

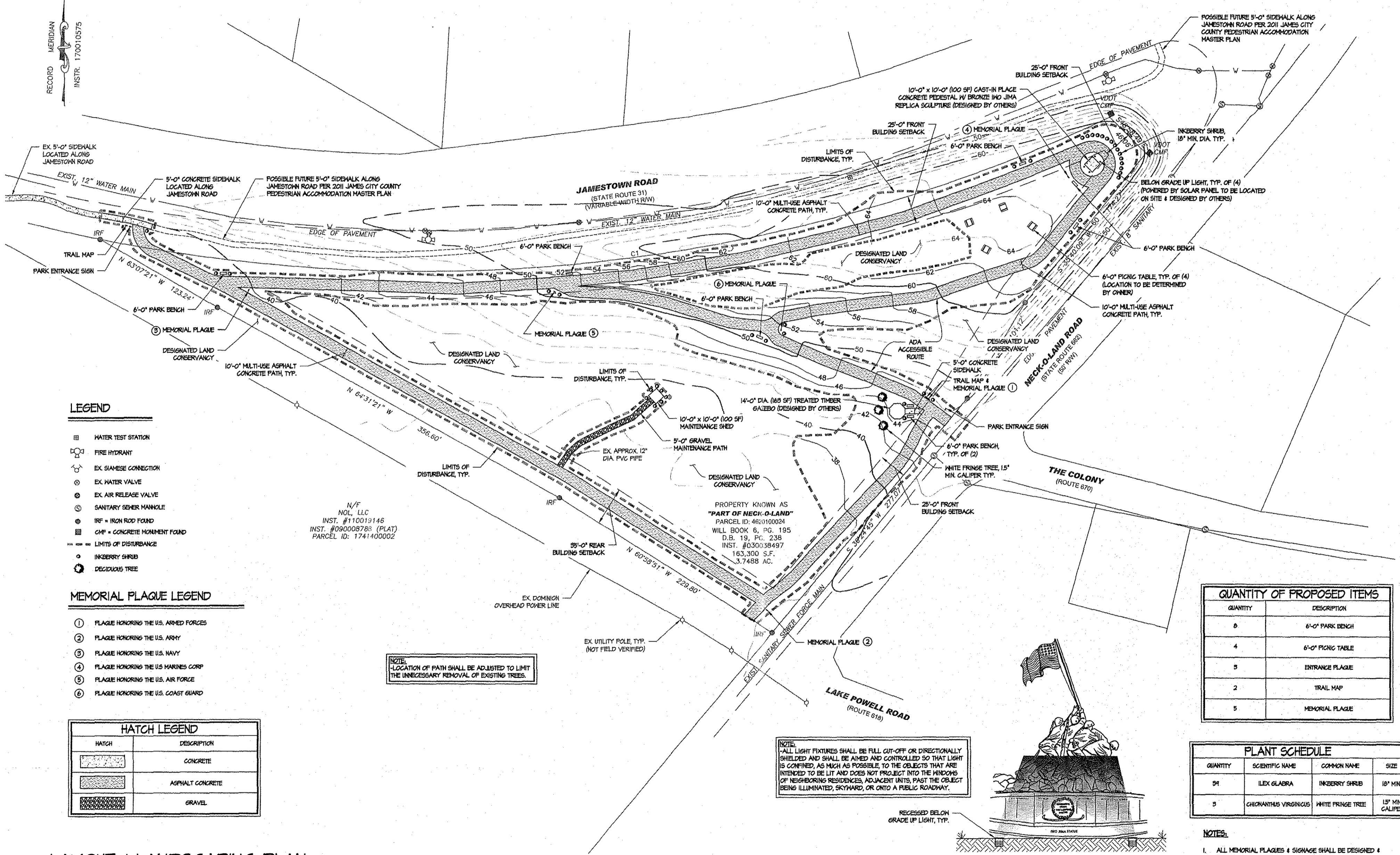

LEGEND

- WATER TEST STATION
- ⊕ FIRE HYDRANT
- ⊕ EX. SIAMENSE CONNECTION
- ⊕ EX. WATER VALVE
- ⊕ EX. AIR RELEASE VALVE
- ⊕ SANITARY SEWER MANHOLE
- ⊕ IRF = IRON ROD FOUND
- ⊕ CMF = CONCRETE MONUMENT FOUND
- LIMITS OF DISTURBANCE
- INKBERRY SHRUB
- DECIDUOUS TREE

MEMORIAL PLAQUE LEGEND

- ① PLAQUE HONORING THE U.S. ARMED FORCES
- ② PLAQUE HONORING THE U.S. ARMY
- ③ PLAQUE HONORING THE U.S. NAVY
- ④ PLAQUE HONORING THE U.S. MARINES CORP
- ⑤ PLAQUE HONORING THE U.S. AIR FORCE
- ⑥ PLAQUE HONORING THE U.S. COAST GUARD

HATCH LEGEND

HATCH	DESCRIPTION
[Solid Grey]	CONCRETE
[Diagonal Lines]	ASPHALT CONCRETE
[Cross-hatch]	GRAVEL

NOTE: LOCATION OF PATH SHALL BE ADJUSTED TO LIMIT THE UNNECESSARY REMOVAL OF EXISTING TREES.

NOTE: ALL LIGHT FIXTURES SHALL BE FULL CUT-OFF OR DIRECTIONALLY SHIELDED AND SHALL BE AIMED AND CONTROLLED SO THAT LIGHT IS CONFINED, AS MUCH AS POSSIBLE, TO THE OBJECTS THAT ARE INTENDED TO BE LIT AND DOES NOT PROJECT INTO THE WINDOWS OF NEIGHBORING RESIDENCES, ADJACENT UNITS, PAST THE OBJECT BEING ILLUMINATED, SKYWARD, OR ONTO A PUBLIC ROADWAY.



QUANTITY OF PROPOSED ITEMS

QUANTITY	DESCRIPTION
6	6'-0" PARK BENCH
4	6'-0" PICNIC TABLE
5	ENTRANCE PLAQUE
2	TRAIL MAP
5	MEMORIAL PLAQUE

PLANT SCHEDULE

QUANTITY	SCIENTIFIC NAME	COMMON NAME	SIZE
54	ILEX GLABRA	INKBERRY SHRUB	18" MIN.
5	CHIRONANTHUS VIRGINICUS	WHITE FRINGE TREE	15" MIN. CALIFER

- NOTES:**
- ALL MEMORIAL PLAQUES & SIGNAGE SHALL BE DESIGNED & FORMATTED FOR PEDESTRIAN TRAIL USE.
 - ALL NEW SIGNS & PLAQUES SHALL BE IN ACCORDANCE WITH ARTICLE II, DIVISION 3 OF THE JAMES CITY COUNTY ZONING ORDINANCE.

LAYOUT & LANDSCAPING PLAN
SCALE: 1" = 40'-0"

Project #: VA16162ES
Date: 6/11/19
Sheet: 6 of 9

Reviewed by: JMK
Drawn by: JMK

Project: SITE PLAN OF INO JIMA MEMORIAL PARK
1620 JAMESTOWN ROAD
JAMES CITY COUNTY, VIRGINIA

THE STRUCTURES GROUP, INC.
1200 OLD COLONY LANE • WILLIAMSBURG, VA 23185
(757) 220-0465 • FAX (757) 220-1546
WWW.THESTRUCTURESGROUP.COM

9 Large/Small Plat(s) Recorded
herewith as # 190010655

City of Williamsburg & County of James City
Circuit Court: This PLAT was recorded on
July 25, 2019
at 9:57 AM PM, PB PG
Document # 190010655
MONA A. FOLEY, CLERK
Mona A. Foley, Clerk