

190009757

BUILDING 47 (DUPLEX)

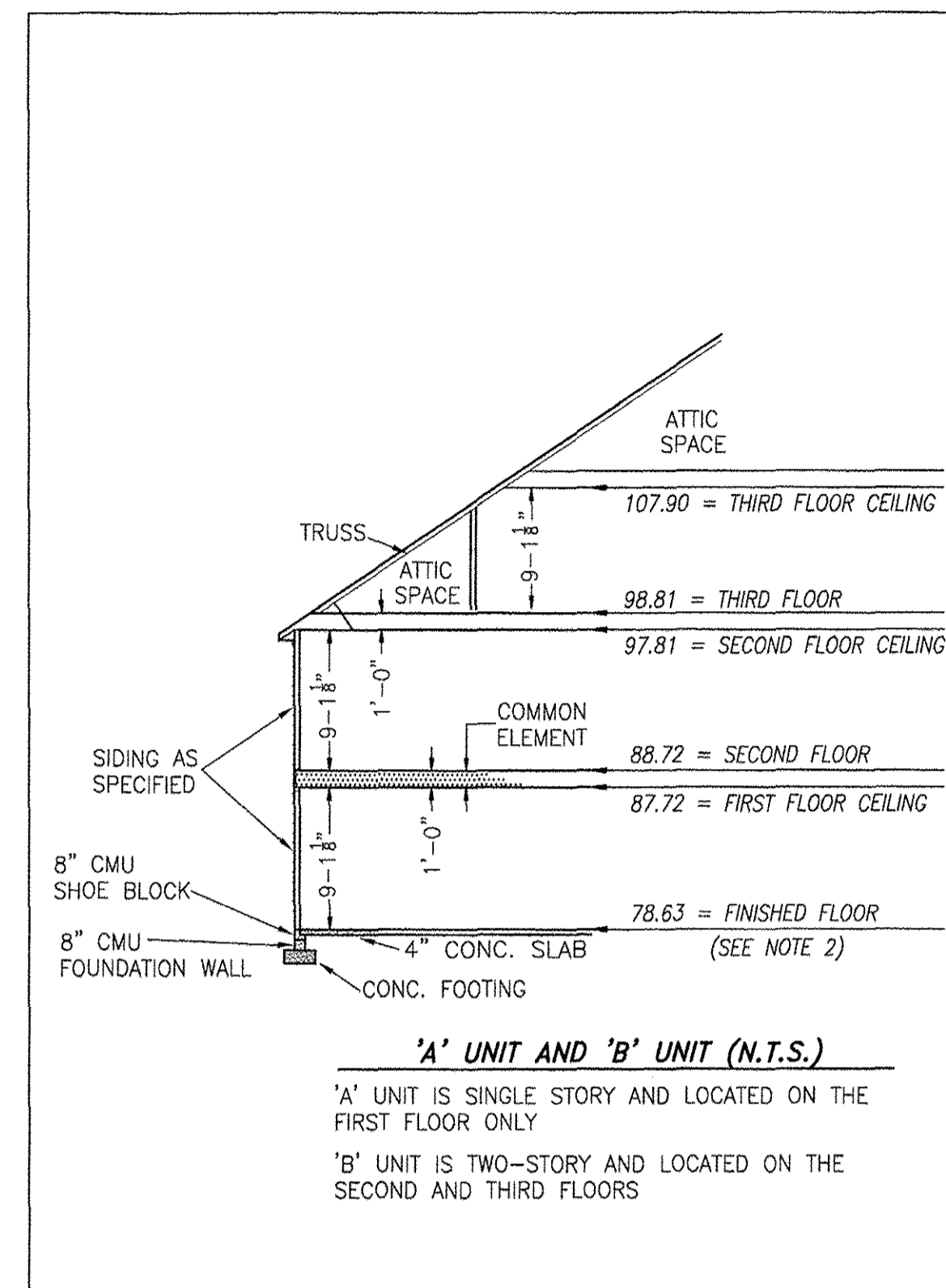
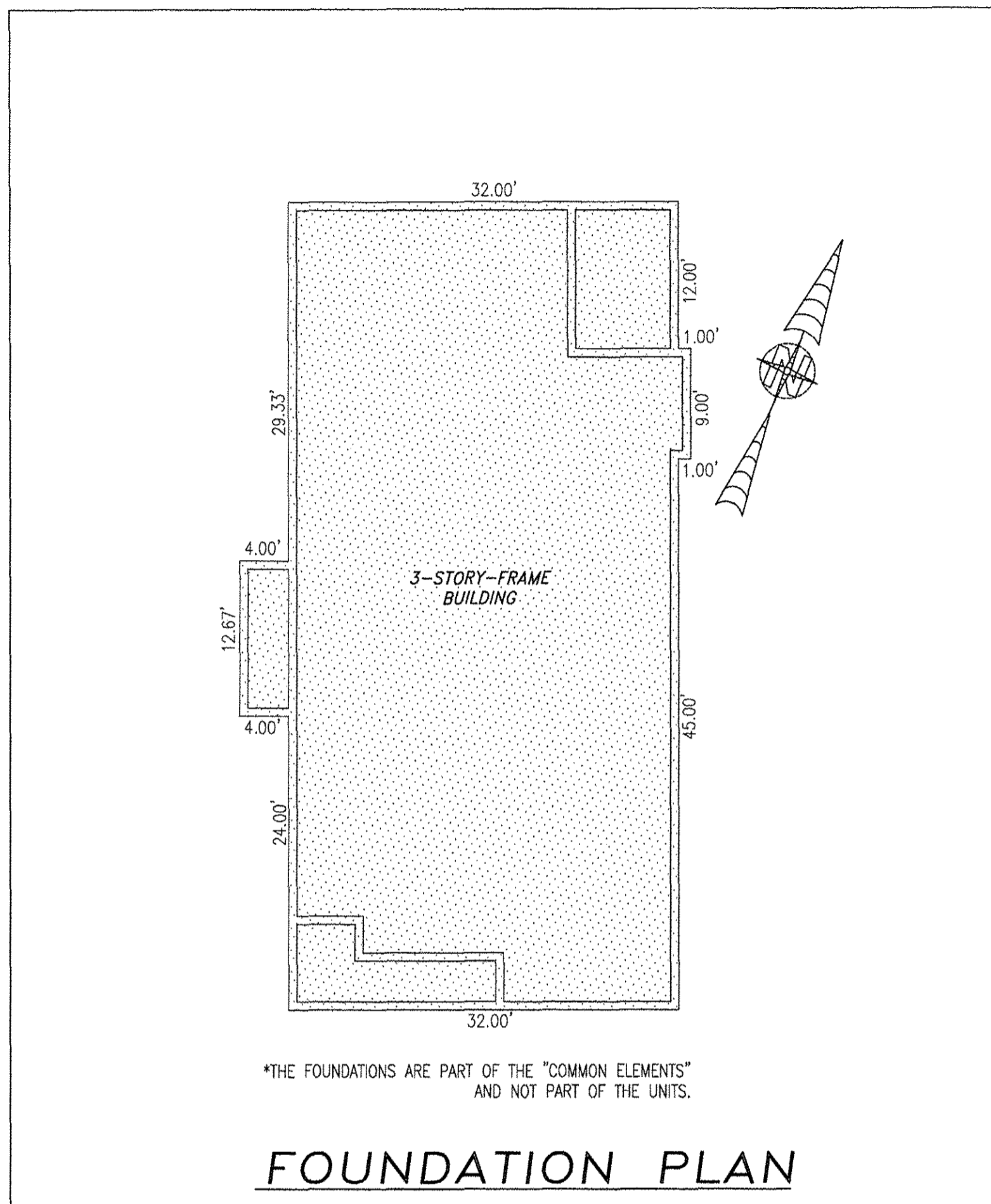

TYPICAL BUILDING SECTION

NOT TO SCALE (N.T.S.)

NOTES:

1. VERTICAL DATUM REFERENCE: NATIONAL GEODETIC VERTICAL DATUM OF 1929 (NGVD29).
2. FINISHED FLOOR ELEVATION SHOWN WAS TAKEN FROM AS-BUILT SURVEY OF BUILDING #47 (DUPLEX) THE PROMENADE AT JOHN TYLER BY HAYDEN FRYE AND ASSOCIATES. FIELD WORK WAS PERFORMED ON 05-15-19.

I HEREBY CERTIFY THAT THIS PLAN IS ACCURATE AND THAT IT COMPLIES WITH THE PROVISIONS OF THE CODE OF VIRGINIA OF 1950 AS AMENDED, § 55-79.58 AND I FURTHER CERTIFY THAT ALL UNITS THEREOF DEPICTED HEREON, PURSUANT TO THE CODE OF VIRGINIA § 55-79.58B, ARE SUBSTANTIALLY COMPLETE.



THIS SHEET: FOUNDATION PLAN AND SECTION

PHASE 47
CONDOMINIUM PLAT AND PLAN
 OF
THE PROMENADE
 AT
JOHN TYLER
 A CONDOMINIUM
 JAMES CITY COUNTY, VIRGINIA

Jo# 160921

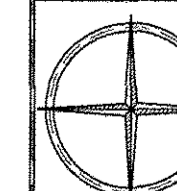

Hayden Frye and Associates, Inc.
Land Surveyors

333 KELLAM ROAD, SUITE 200
 VIRGINIA BEACH, VA., 23462
 PH: (757) 491-7228 FX:(757) 491-7229

DATE: MAY 15, 2019

SCALE: 1"=10'

SHEET 4 OF 5 THIS PHASE

JCC Subdivision Agent *efc*
 Approval Not Required

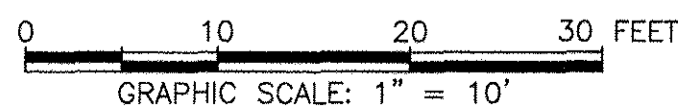

-INDICATES COMMON ELEMENT

City of Williamsburg & County of James City
 Circuit Court: This PLAT was recorded on
July 9, 2019

at *11:45* AM/PM; PB PG

Document # *190009757*

MONA A. FOLEY, CLERK

Mona A. Foley Clerk

5 Large Small Plat(s) Recorded
 herewith as # *190009757*