

190007409

BUILDING 4 (10-PLEX)

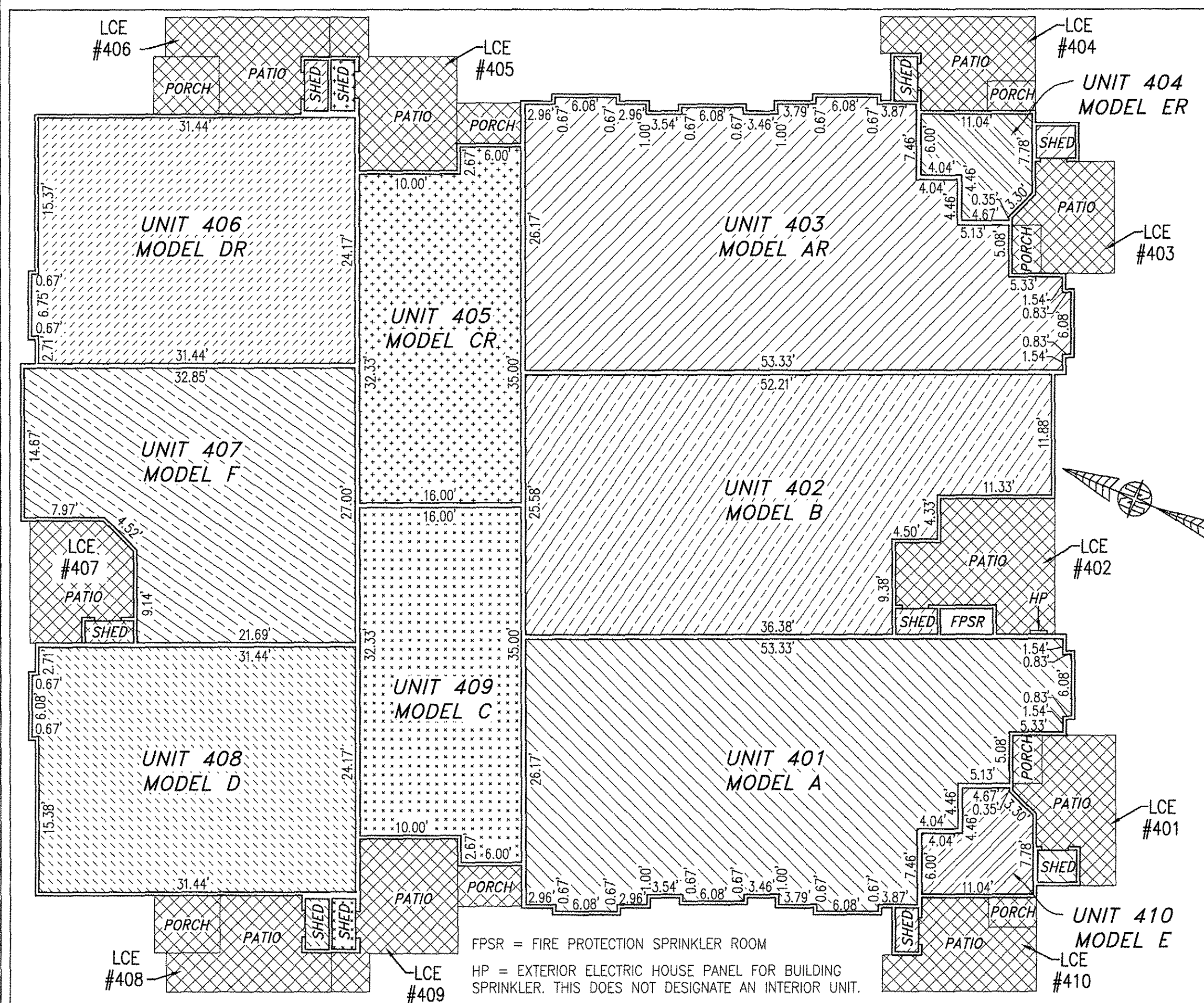

FIRST FLOOR

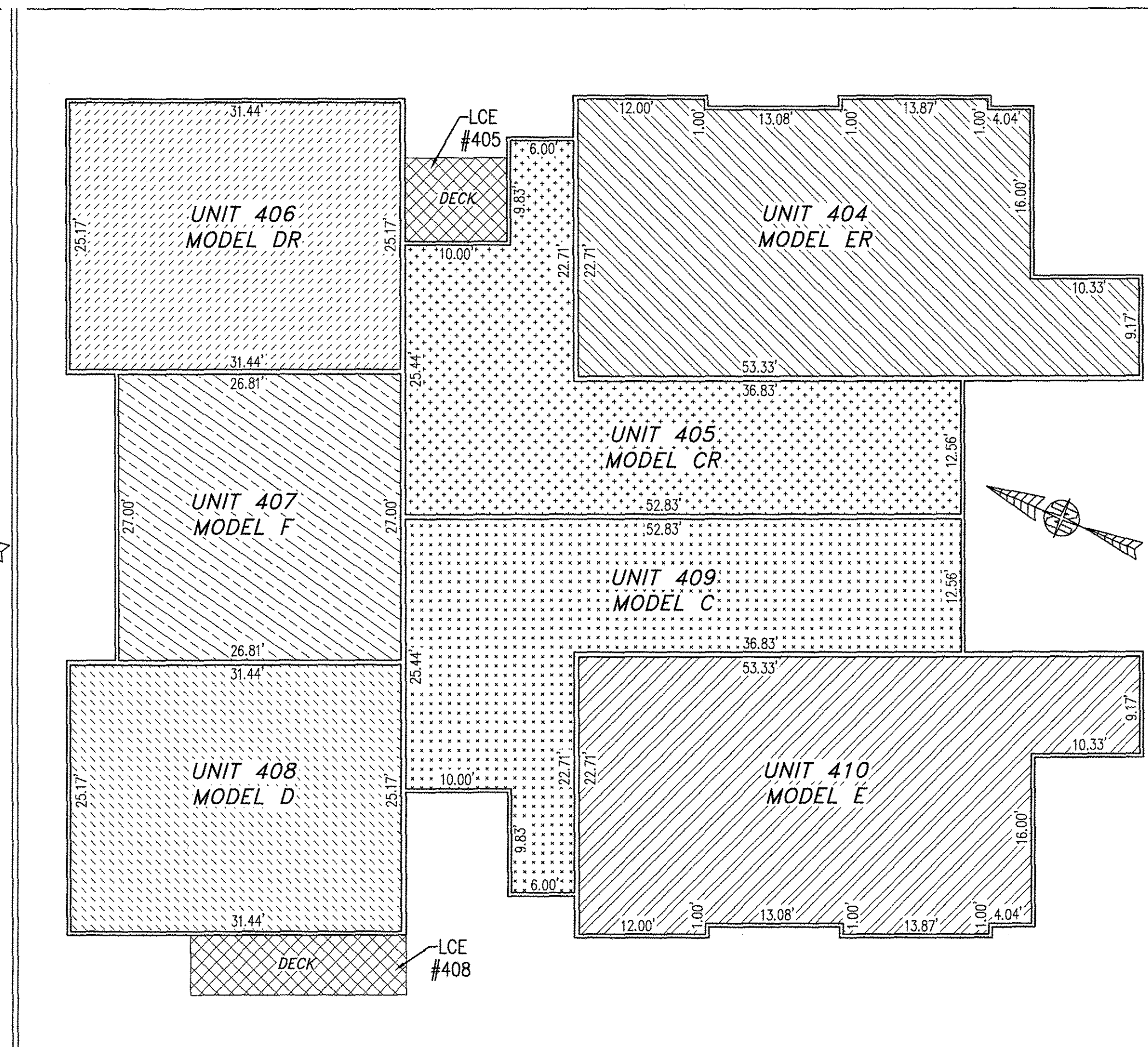

SECOND FLOOR

UNIT ID	UNIT DESCRIPTION	UNIT ADDRESS	PARKING SPACE
A	-INDICATES AREA OF UNIT 401	#401 PROMENADE LANE	56
B	-INDICATES AREA OF UNIT 402	#402 PROMENADE LANE	54
AR	-INDICATES AREA OF UNIT 403	#403 PROMENADE LANE	53
ER	-INDICATES AREA OF UNIT 404	#404 PROMENADE LANE	52
CR	-INDICATES AREA OF UNIT 405	#405 PROMENADE LANE	50
DR	-INDICATES AREA OF UNIT 406	#406 PROMENADE LANE	49
F	-INDICATES AREA OF UNIT 407	#407 PROMENADE LANE	45
D	-INDICATES AREA OF UNIT 408	#408 PROMENADE LANE	42
C	-INDICATES AREA OF UNIT 409	#409 PROMENADE LANE	41
E	-INDICATES AREA OF UNIT 410	#410 PROMENADE LANE	57
HP	HOUSE PANEL (ELECTRIC)	#411 PROMENADE LANE	N/A
FPSR	FIRE PROTECTION SPRINKLER ROOM	#412 PROMENADE LANE	N/A
	-INDICATES COMMON ELEMENT (EXCLUDING AREAS OUTSIDE OF SUBMITTED LAND)		
	-INDICATES LIMITED COMMON ELEMENT (LCE) ASSIGNED TO A UNIT. # UNIT ASSIGNED		

I HEREBY CERTIFY THAT THIS PLAN IS ACCURATE AND THAT IT COMPLIES WITH THE PROVISIONS OF THE CODE OF VIRGINIA OF 1950 AS AMENDED, § 55-79.58 AND I FURTHER CERTIFY THAT ALL UNITS THEREOF DEPICTED HEREON, PURSUANT TO THE CODE OF VIRGINIA § 55-79.58B, ARE SUBSTANTIALLY COMPLETE.



5 Large/Small Plat(s) Recorded herewith as #190007409

JCC Subdivision Agent Approval Not Required

City of Williamsburg & County of James City Circuit Court: This PLAT was recorded on May 22, 2019 at 9:03 AM/PM, PB PG

Document # 190007409
MONA A. FOLEY, CLERK
Mona A. Foley, Clerk

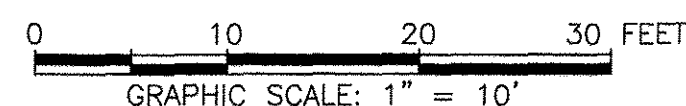

THIS SHEET: FLOOR PLANS

PHASE 4
CONDOMINIUM PLAT AND PLAN
OF
THE PROMENADE
AT
JOHN TYLER
A CONDOMINIUM
JAMES CITY COUNTY, VIRGINIA

Job# 160921

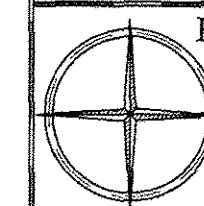

Hayden Frye and Associates, Inc.
Land Surveyors

333 KELLAM ROAD, SUITE 200
VIRGINIA BEACH, VA., 23462
PH: (757) 491-7228 FX:(757) 491-7229

DATE: MAY 10, 2019

SCALE: 1"=10'

SHEET 5 OF 5 THIS PHASE