

I HEREBY CERTIFY THAT THIS PLAN IS ACCURATE AND THAT IT COMPLES WITH THE CODE OF VIRGINIA OF 1950, AS AMENDED, 85-79.5B, AND I FURTHER CERTIFY THAT ALL IMPROVEMENTS OR PORTIONS THEREOF DEPICTED HEREON, PURSUANT TO THE CODE OF VIRGINIA, 85-79.5B(A), ARE SUBSTANTIALLY COMPLETE.

PETER FARRELL, L.S. #2036

10/11/2018
DATE

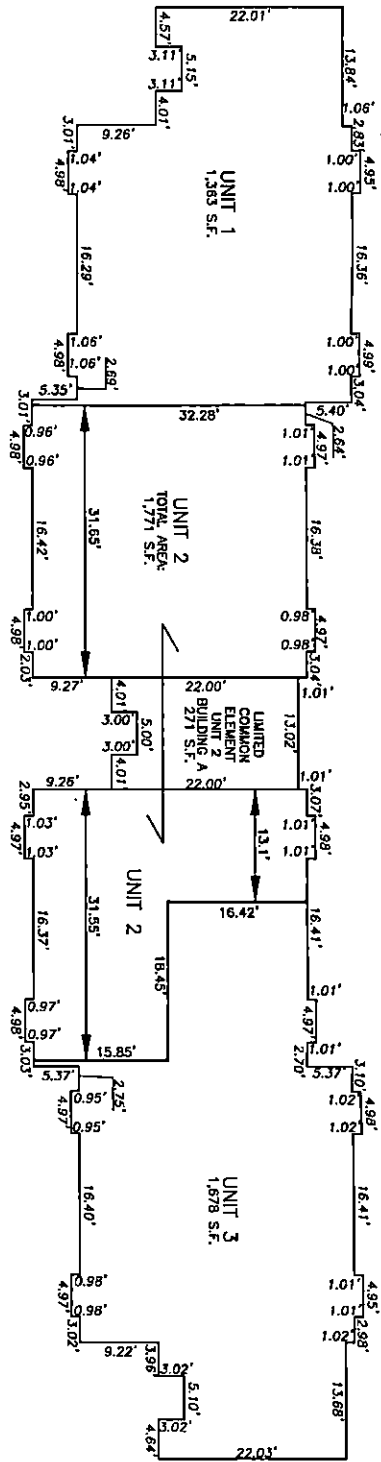

BUILDING A

EXISTING BUILDING DIMENSIONS TAKEN FROM FIFTH AMENDED EXHIBIT, PACKET'S EXECUTIVE CENTER CONDOMINIUM.
RECORDED AS INST. #090006455

AMENDED EXHIBIT
BUILDING A
PACKET'S EXECUTIVE CENTER CONDOMINIUM
PARCEL 2DV, BUSCH CORPORATE CENTER
JAMES CITY COUNTY VIRGINIA
DATE: 10/11/2018 SCALE: 1"=10' JOB # 18-425

LandTech Resources, Inc.
Engineering & Surveying Consultants
3925 Midlonda Road, Williamsburg, Virginia 23188
Phone: (757) 588-1877 Fax: (757) 565-0782
web: landtechresources.com

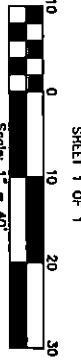

SHEET 1 OF 1