

BUILDING 5 (10-PLEX)

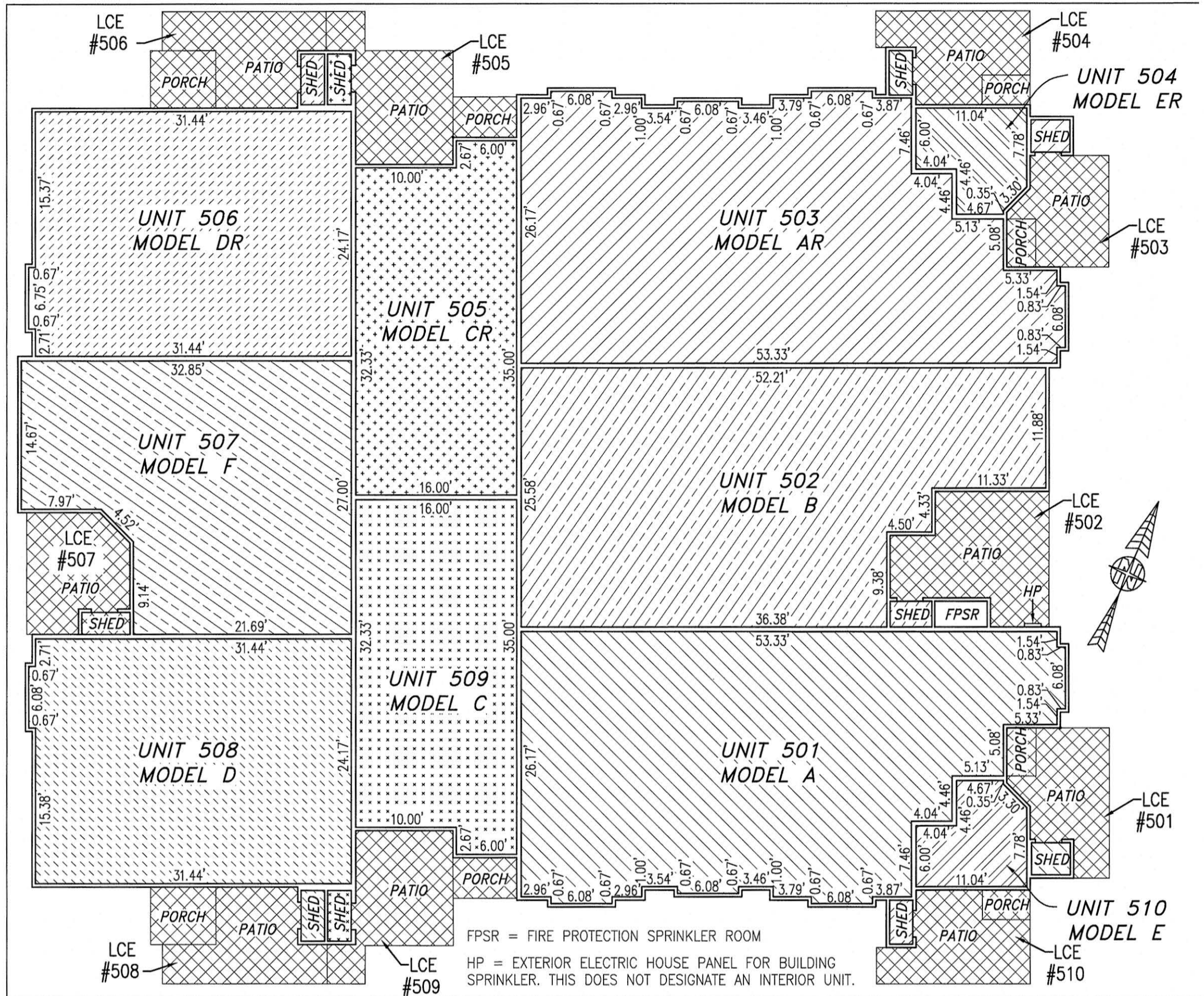

FIRST FLOOR

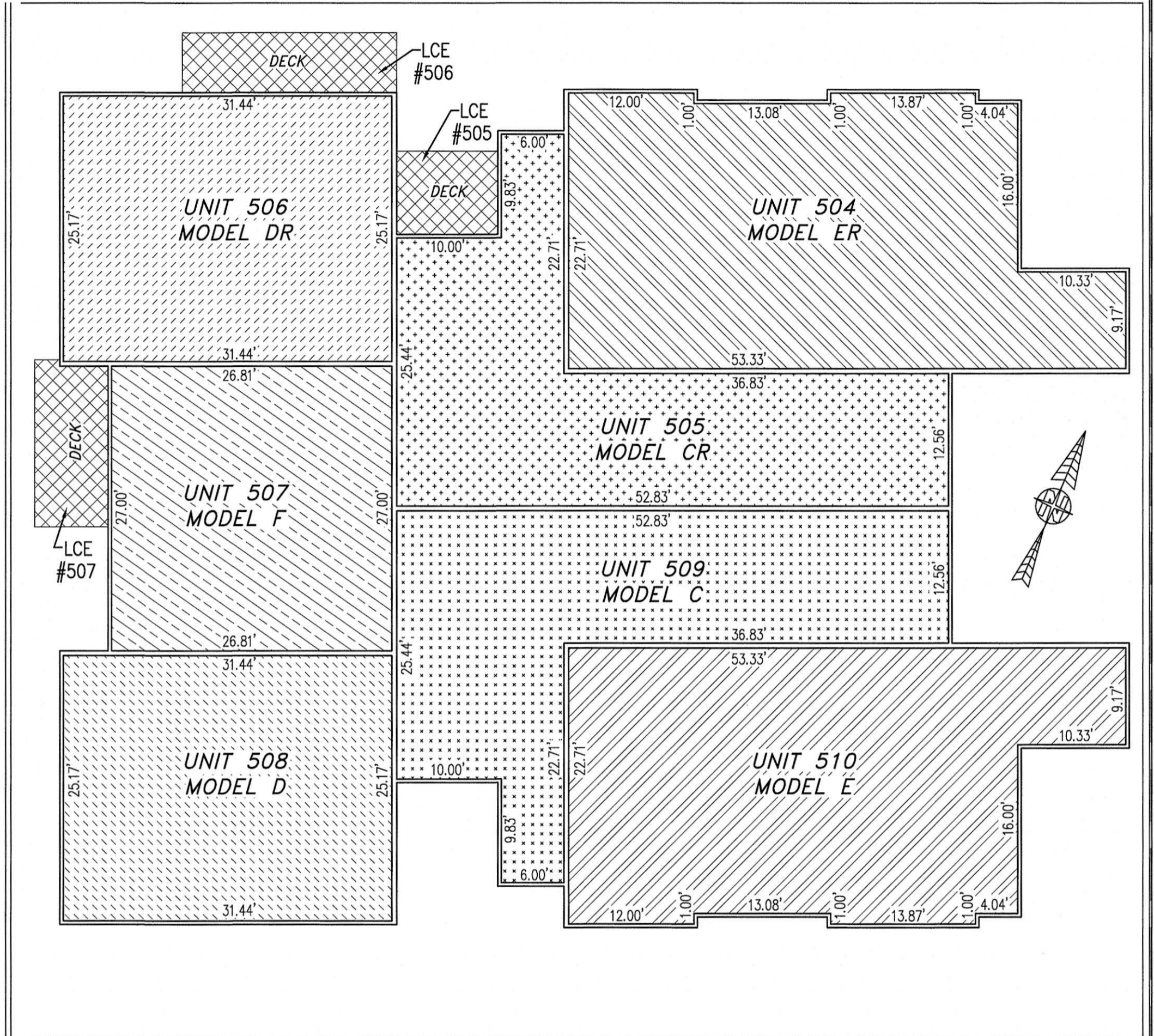

SECOND FLOOR

UNIT ID	UNIT DESCRIPTION	UNIT ADDRESS	PARKING SPACE
A	-INDICATES AREA OF UNIT 501	#501 PROMENADE LANE	74
B	-INDICATES AREA OF UNIT 502	#502 PROMENADE LANE	73
AR	-INDICATES AREA OF UNIT 503	#503 PROMENADE LANE	70
ER	-INDICATES AREA OF UNIT 504	#504 PROMENADE LANE	66
CR	-INDICATES AREA OF UNIT 505	#505 PROMENADE LANE	61
DR	-INDICATES AREA OF UNIT 506	#506 PROMENADE LANE	60
F	-INDICATES AREA OF UNIT 507	#507 PROMENADE LANE	59
D	-INDICATES AREA OF UNIT 508	#508 PROMENADE LANE	58
C	-INDICATES AREA OF UNIT 509	#509 PROMENADE LANE	76
E	-INDICATES AREA OF UNIT 510	#510 PROMENADE LANE	75
HP	HOUSE PANEL (ELECTRIC)	#511 PROMENADE LANE	N/A
FPSR	FIRE PROTECTION SPRINKLER ROOM	#512 PROMENADE LANE	N/A
	-INDICATES COMMON ELEMENT (EXCLUDING AREAS OUTSIDE OF SUBMITTED LAND)		
	-INDICATES LIMITED COMMON ELEMENT (LCE) ASSIGNED TO A UNIT. # UNIT ASSIGNED		

I HEREBY CERTIFY THAT THIS PLAN IS ACCURATE AND THAT IT COMPLIES WITH THE PROVISIONS OF THE CODE OF VIRGINIA OF 1950 AS AMENDED, § 55-79.58 AND I FURTHER CERTIFY THAT ALL UNITS THEREOF DEPICTED HEREON, PURSUANT TO THE CODE OF VIRGINIA § 55-79.58B, ARE SUBSTANTIALLY COMPLETE.

5 Large/Small Plat(s) Recorded herewith as # 190001499



City of Williamsburg & County of James City
Circuit Court: This PLAT was recorded on 2-1-2019
at 1:52 AM (PM) PB PG
Document # 190001499
MONA A. FOLEY, CLERK
Mona A. Foley, Clerk

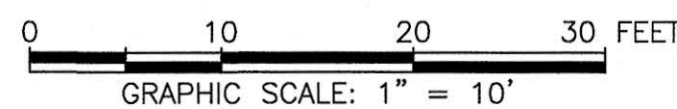

JCC Subdivision Agent Approval Not Required

THIS SHEET: FLOOR PLANS

PHASE 5
CONDOMINIUM PLAT AND PLAN
OF
THE PROMENADE
AT
JOHN TYLER
A CONDOMINIUM
JAMES CITY COUNTY, VIRGINIA

Jo# 160921

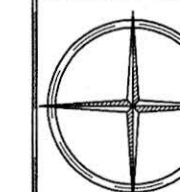

Hayden Frye and Associates, Inc.
Land Surveyors
333 KELLAM ROAD, SUITE 200
VIRGINIA BEACH, VA., 23462
PH: (757) 491-7228 FX: (757) 491-7229

DATE: JANUARY 24, 2019
SCALE: 1"=10'
SHEET 5 OF 5 THIS PHASE