

180899

I, AHMED H. HASSAN, A DULY REGISTERED ARCHITECT, DO HEREBY CERTIFY THAT THIS PLAN FOR 2ND STREET SHOPPES CONDOMINIUM COMPLIES WITH THE PROVISIONS OF VIRGINIA CODE ANNOTATE SUBSECTION 55-79.58 (B), AS AMENDED.

AH
 AHMED H. HASSAN, AIA

NOVEMBER 1, 2017
 DATE



- NOTE:
1. CONDOMINIUM LIMITS ARE MEASURED FROM INTERIOR FACE OF GYPSUM WALL BOARD.
 2. SEE SITE PLAN FOR HORIZONTAL PERIMETER DIMENSIONS

UNIT	AREA	NOTES
B100	3,364 SQUARE FEET	
100	3,364 SQUARE FEET	
101	4,541 SQUARE FEET	INCLUDES CONNECTION TO CONDO 100 COMMON AREA STAIR TO SECOND LEVEL.
101.B	189 SQUARE FEET	
102	1,472 SQUARE FEET	
103	1,428 SQUARE FEET	
104	1,404 SQUARE FEET	
105	1,423 SQUARE FEET	
106	2,394 SQUARE FEET	
200	2,374 SQUARE FEET	
201	861 SQUARE FEET	

B UNIT AREA CONDOMINIUM LIMITS
 SCALE: NOT TO SCALE

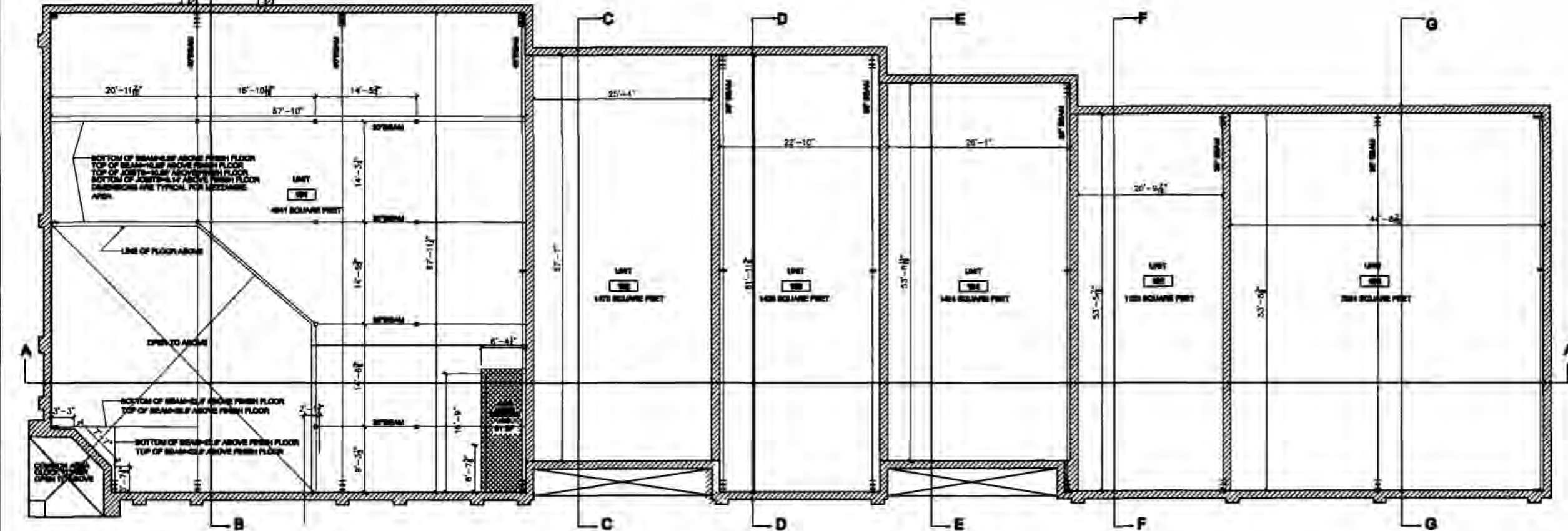
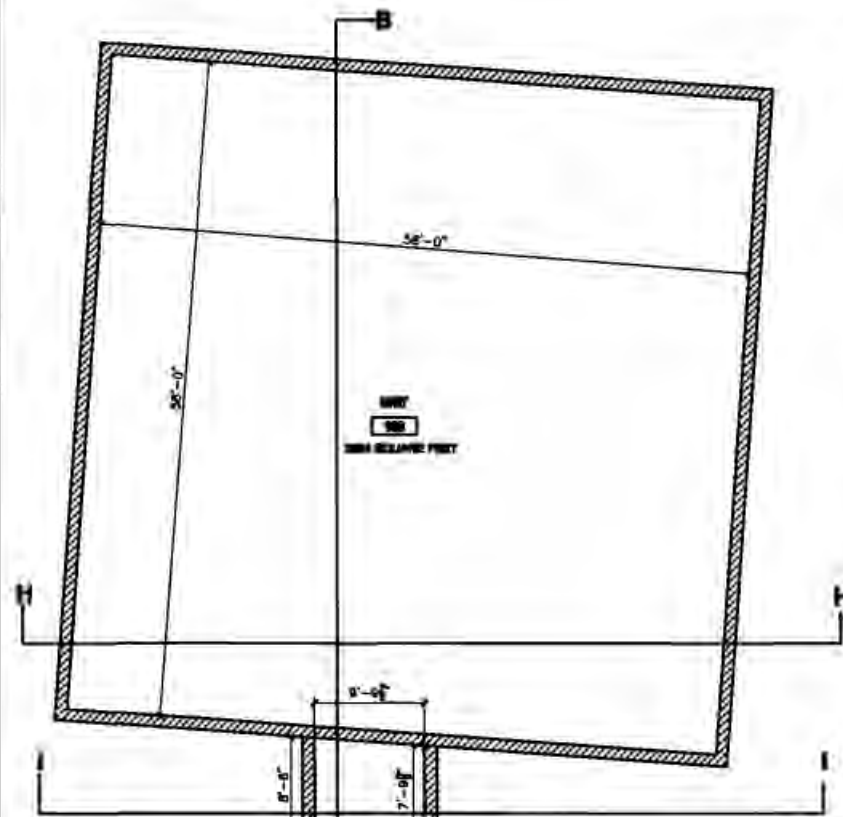

A FIRST FLOOR CONDOMINIUM PLAN
 SCALE: 3/8"=1'-0" 2 Large & 6 Large/Small Plat(s) Recorded herewith as # 180899

City of Williamsburg & County of James City
 Circuit Court: This PLAT was recorded on
 Feb. 1, 2018
 at 2:26 AM/PM, PB PG
 Document # 180899
 MONA A. FOLEY, CLERK
Monica Foley Clerk

HATCH KEY

[Hatched Box]	UNIT
[Hatched Box]	COMMON AREA
[Hatched Box]	COMMON AREA STAIR

112 DUNES
 WILLIAMSBURG VIRGINIA 23186
 PHONE: 757-208-0577
 WWW.AH2ARCHITECTURE.COM

architectural
AH2

CONDOMINIUM DOCUMENTS
 FIRST FLOOR PLAN
 THE SHOPS AT SECOND STREET
 211 SECOND STREET
 WILLIAMSBURG VIRGINIA 23186

DATE: JULY 08, 2017
 DRAWN BY: AH HASSAN
 CHECKED BY: JAH
 SHEET NO: 1