

180019704

BUILDING 18 (DUPLEX)

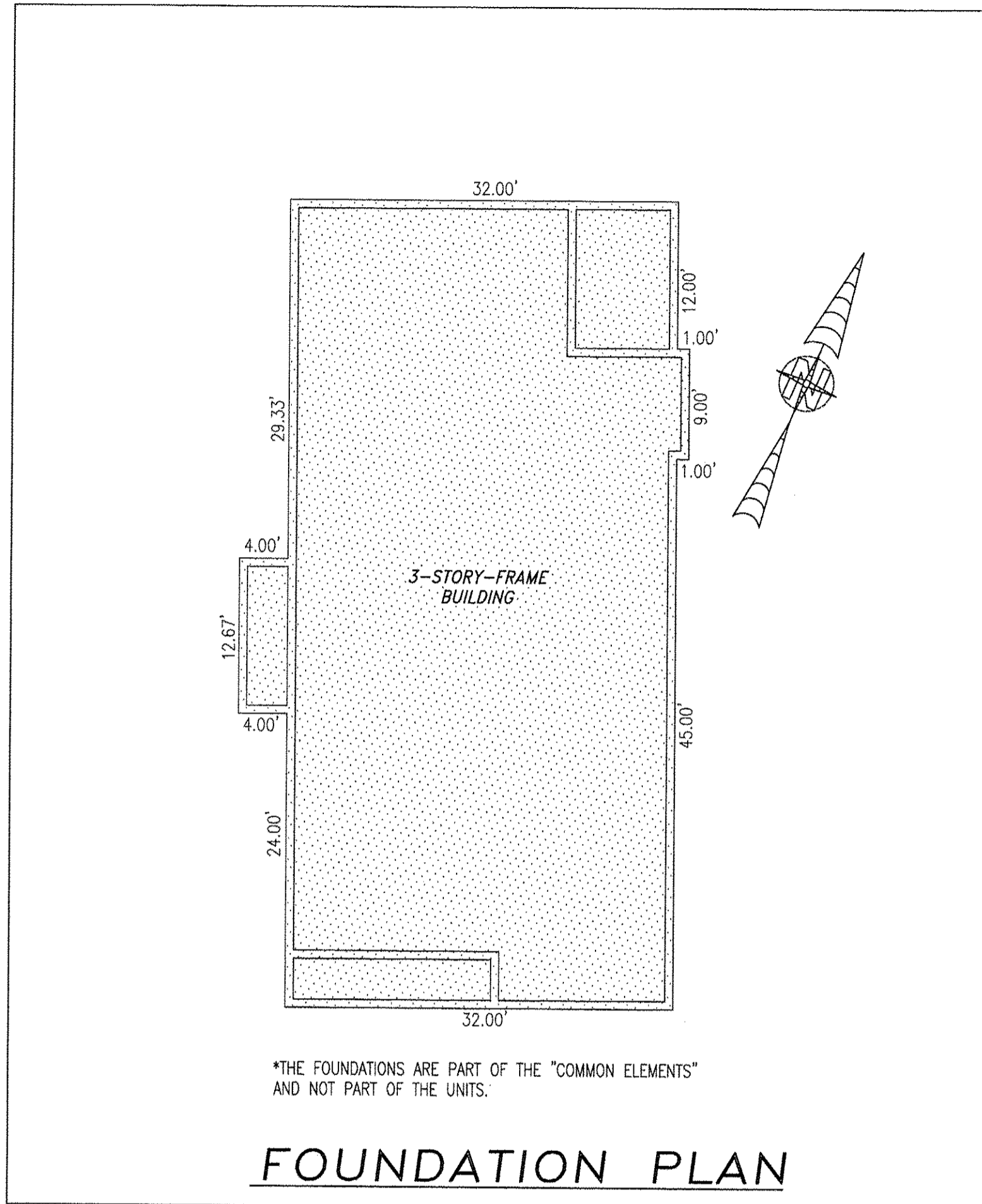

FOUNDATION PLAN

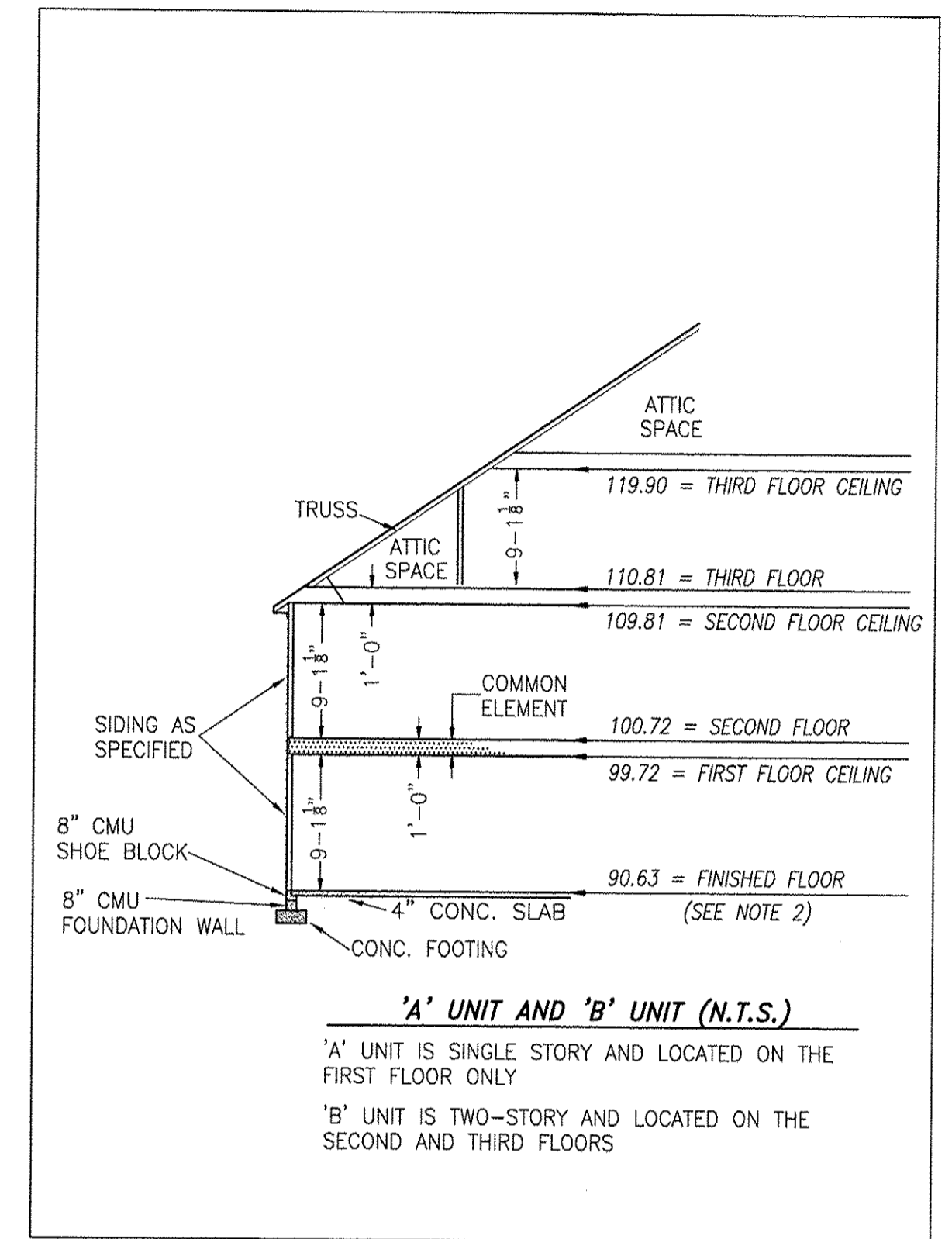

TYPICAL BUILDING SECTION

NOT TO SCALE (N.T.S.)

NOTES:

1. VERTICAL DATUM REFERENCE: NATIONAL GEODETIC VERTICAL DATUM OF 1929 (NGVD29).
2. FINISHED FLOOR ELEVATION SHOWN WAS TAKEN FROM AS-BUILT SURVEY OF BUILDING #18 (DUPLEX) THE PROMENADE AT JOHN TYLER BY HAYDEN FRYE AND ASSOCIATES. FIELD WORK WAS PERFORMED ON 12-04-18.

5 Large/Small Plat(s) Recorded
herewith as # 180019704

City of Williamsburg & County of James City
Circuit Court: This PLAT was recorded on
12-11-2018
at 1:08 AM PM, PB PG
Document # 180019704
MONA A. FOLEY, CLERK
Mona A. Foley, Clerk

I HEREBY CERTIFY THAT THIS PLAN IS ACCURATE AND THAT IT COMPLIES WITH THE PROVISIONS OF THE CODE OF VIRGINIA OF 1950 AS AMENDED, § 55-79.58 AND I FURTHER CERTIFY THAT ALL UNITS THEREOF DEPICTED HEREON, PURSUANT TO THE CODE OF VIRGINIA § 55-79.58B, ARE SUBSTANTIALLY COMPLETE.



THIS SHEET: FOUNDATION PLAN AND SECTION

PHASE 18
CONDOMINIUM PLAT AND PLAN
OF
THE PROMENADE
AT
JOHN TYLER
A CONDOMINIUM
JAMES CITY COUNTY, VIRGINIA

Jo# 160921

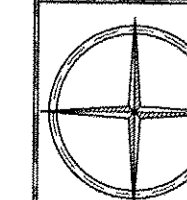

Hayden Frye and Associates, Inc.

Land Surveyors

333 KELLAM ROAD, SUITE 200
VIRGINIA BEACH, VA., 23462
PH: (757) 491-7228 FX: (757) 491-7229

DATE: DECEMBER 5, 2018

SCALE: 1"=10'

SHEET 4 OF 5 THIS PHASE

—INDICATES COMMON ELEMENT

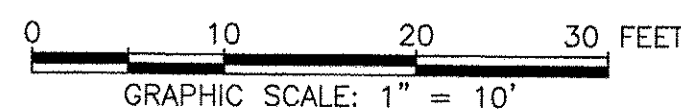

JCC Subdivision Agent *Ebc*
Approval Not Required