

180018358

# BUILDING 6 (10-PLEX)

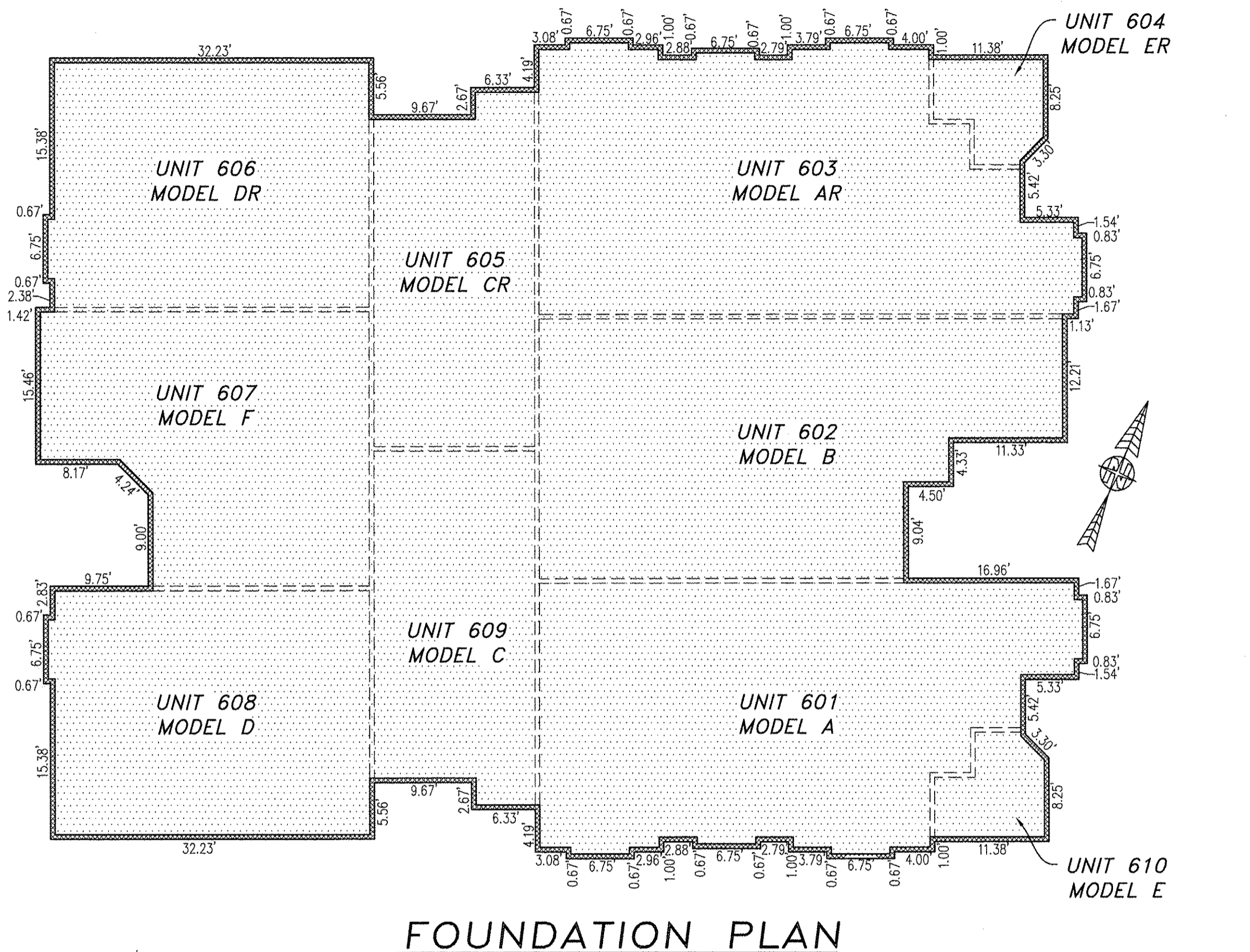

FOUNDATION PLAN

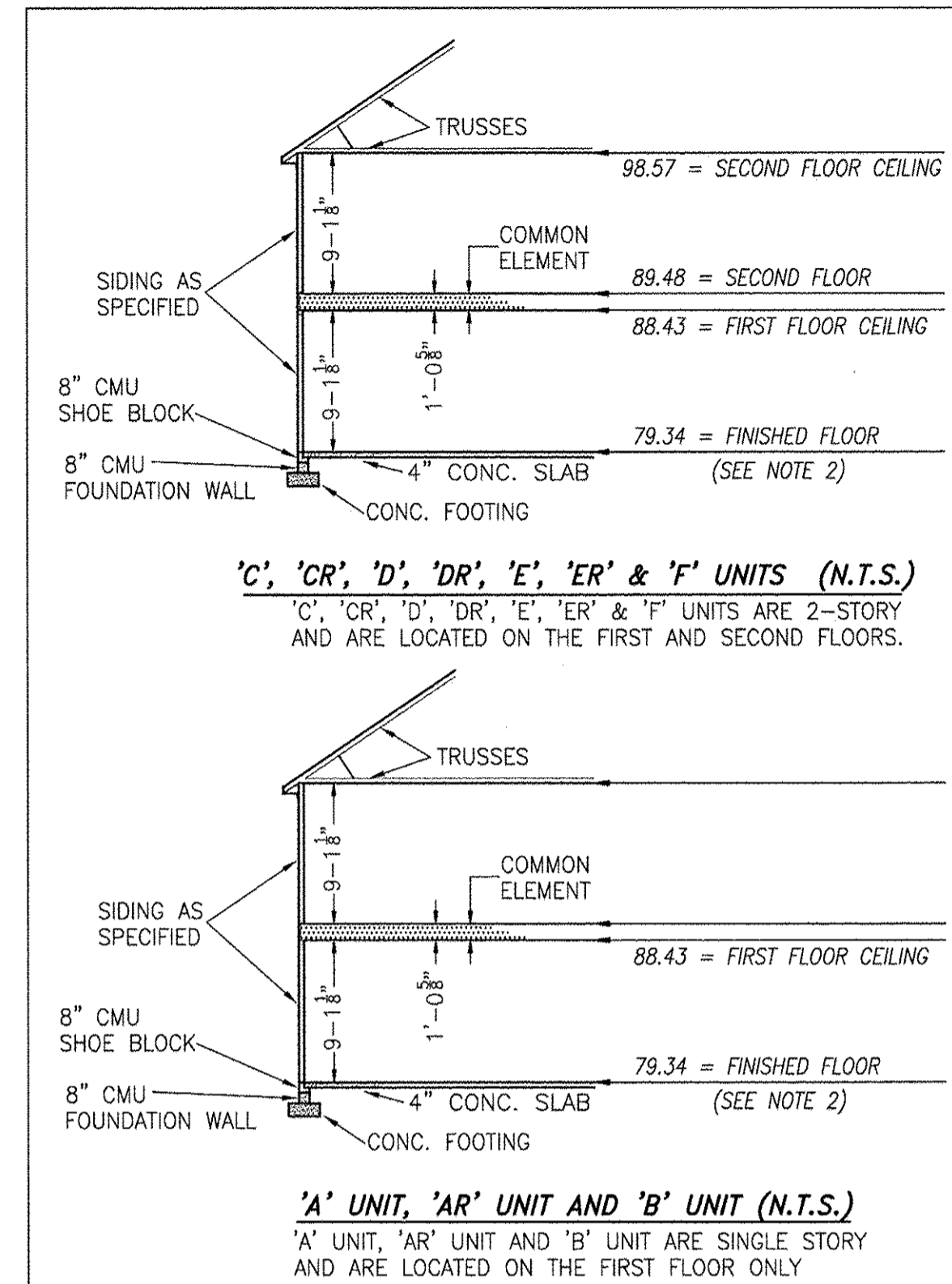

## TYPICAL BUILDING SECTION

NOT TO SCALE (N.T.S.)

- NOTES:
1. VERTICAL DATUM REFERENCE: NATIONAL GEODETIC VERTICAL DATUM OF 1929 (NGVD29).
  2. FINISHED FLOOR ELEVATION SHOWN WAS TAKEN FROM AS-BUILT SURVEY OF BUILDING #6 (10-PLEX) THE PROMENADE AT JOHN TYLER BY HAYDEN FRYE AND ASSOCIATES PERFORMED ON 11/02/2018.

I HEREBY CERTIFY THAT THIS PLAN IS ACCURATE AND THAT IT COMPLIES WITH THE PROVISIONS OF THE CODE OF VIRGINIA OF 1950 AS AMENDED, § 55-79.58 AND I FURTHER CERTIFY THAT ALL UNITS THEREOF DEPICTED HEREON, PURSUANT TO THE CODE OF VIRGINIA § 55-79.58B, ARE SUBSTANTIALLY COMPLETE.

JCC Subdivision Agent <sup>E6</sup>  
 Approval Not Required

THIS SHEET: FOUNDATION PLAN AND SECTION

5 Large/Small Plat(s) Recorded  
 herewith as # 180018358

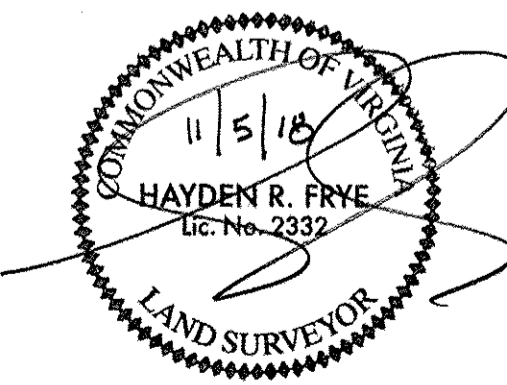

City of Williamsburg & County of James City  
 Circuit Court: This PLAT was recorded on  
 Nov. 13, 2018  
 at 8:47 AM/PM, PB PG  
 Document # 180018358  
 MONA A. FOLEY, CLERK  
 [Signature] Clerk

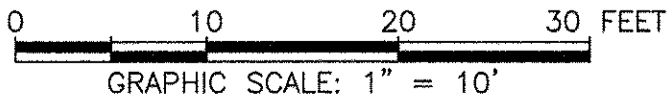

[Dotted Box] -INDICATES COMMON ELEMENT

PHASE 6  
 CONDOMINIUM PLAT AND PLAN  
 OF  
**THE PROMENADE**  
 AT  
**JOHN TYLER**  
 A CONDOMINIUM  
 JAMES CITY COUNTY, VIRGINIA

Jo# 160921  
 Hayden Frye and Associates, Inc.  
**Land Surveyors**  
 333 KELLAM ROAD, SUITE 200  
 VIRGINIA BEACH, VA., 23462  
 PH: (757) 491-7228 FX:(757) 491-7229

DATE: NOVEMBER 5, 2018  
 SCALE: 1"=10'  
 SHEET 4 OF 5 THIS PHASE