

180016209

BUILDING 21 (DUPLEX)

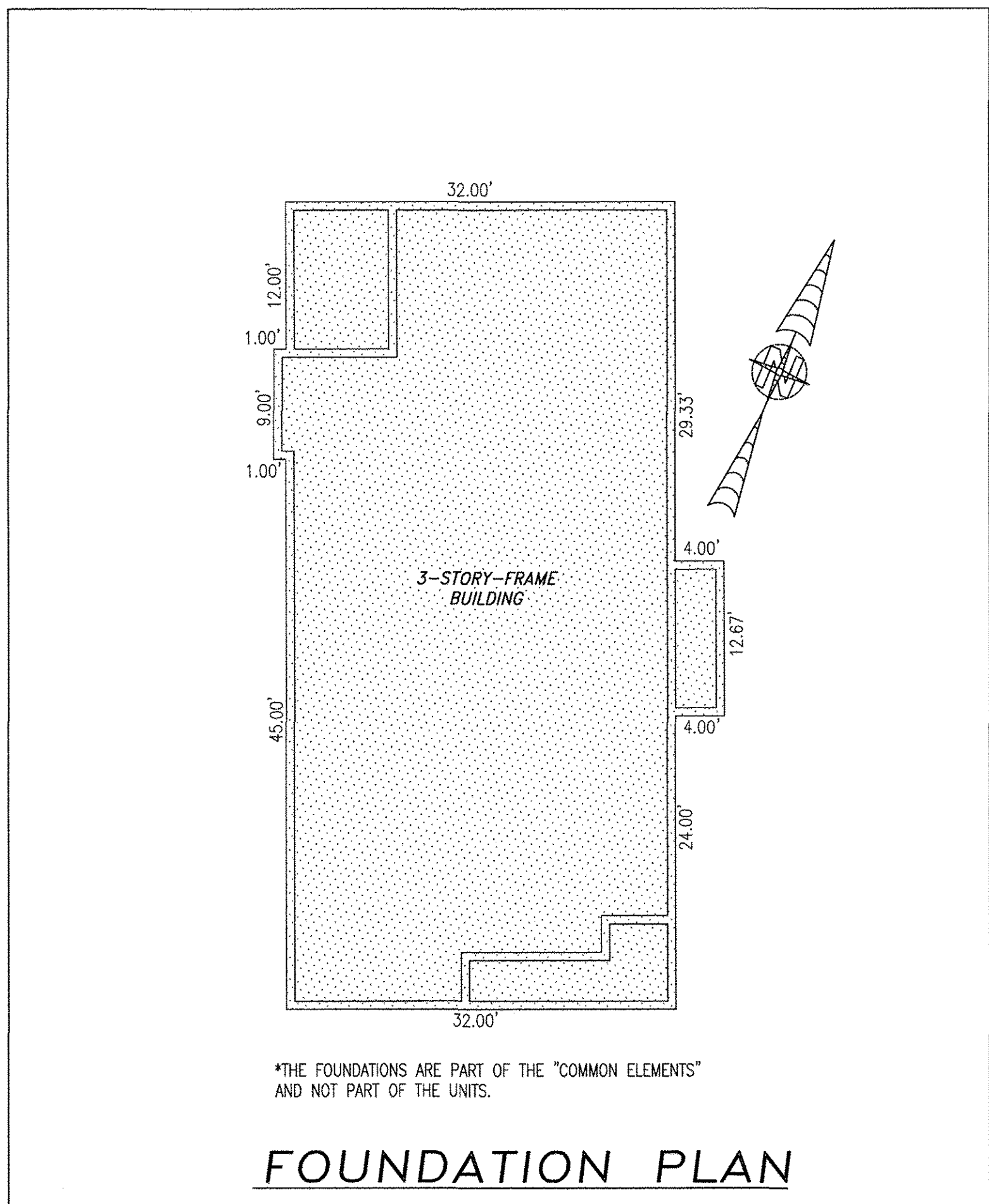

FOUNDATION PLAN

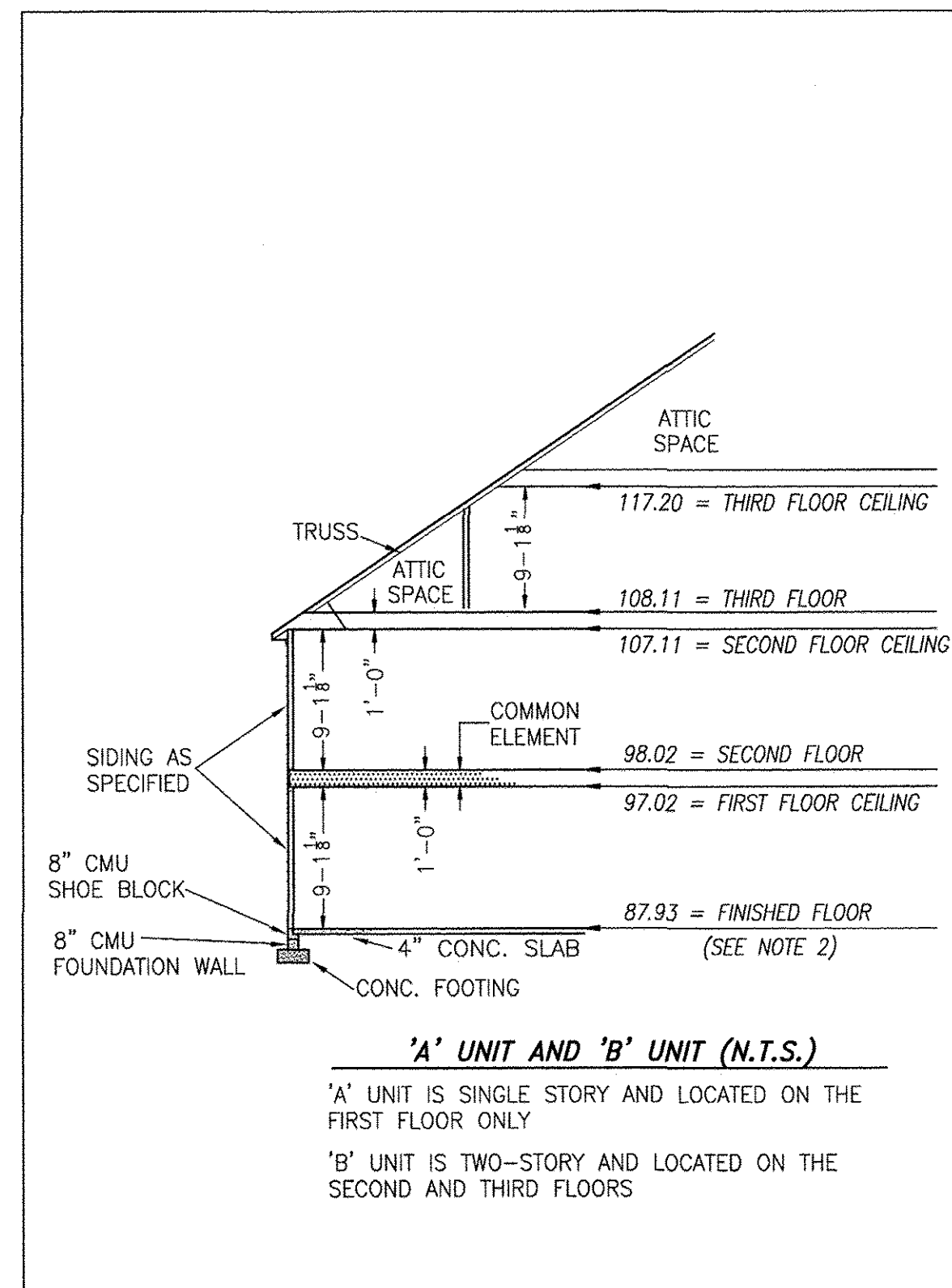

TYPICAL BUILDING SECTION

NOT TO SCALE (N.T.S.)

NOTES:

1. VERTICAL DATUM REFERENCE: NATIONAL GEODETIC VERTICAL DATUM OF 1929 (NGVD29).
2. FINISHED FLOOR ELEVATION SHOWN WAS TAKEN FROM AS-BUILT SURVEY OF BUILDING #21 (DUPLEX) THE PROMENADE AT JOHN TYLER BY HAYDEN FRYE AND ASSOCIATES. FIELD WORK WAS PERFORMED ON 09-25-18.

I HEREBY CERTIFY THAT THIS PLAN IS ACCURATE AND THAT IT COMPLIES WITH THE PROVISIONS OF THE CODE OF VIRGINIA OF 1950 AS AMENDED, § 55-79.58 AND I FURTHER CERTIFY THAT ALL UNITS THEREOF DEPICTED HEREON, PURSUANT TO THE CODE OF VIRGINIA § 55-79.58B, ARE SUBSTANTIALLY COMPLETE.

5 Large/Small Plat(s) Recorded
herewith as # 180016209

City of Williamsburg & County of James City
Circuit Court: This PLAT was recorded on
Oct 11, 2018
at 8:51 AM/PM, PB PG
Document # 180016209
MONA A. FOLEY, CLERK
Mona A. Foley, Clerk

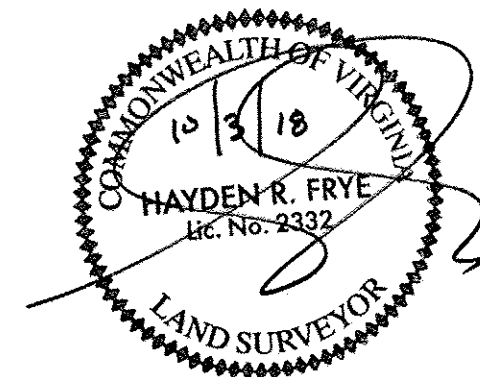

JCC Subdivision Agent
Approval Not Required *EBL*

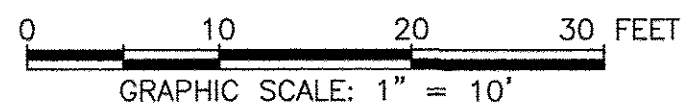

THIS SHEET: FOUNDATION PLAN AND SECTION

PHASE 21
CONDOMINIUM PLAT AND PLAN
OF
THE PROMENADE
AT
JOHN TYLER
A CONDOMINIUM
JAMES CITY COUNTY, VIRGINIA

Job# 160921

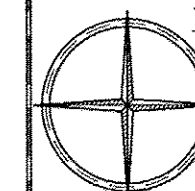

Hayden Frye and Associates, Inc.

Land Surveyors
333 KELLAM ROAD, SUITE 200
VIRGINIA BEACH, VA., 23462
PH: (757) 491-7228 FX:(757) 491-7229

DATE: SEPTEMBER 30, 2018
SCALE: 1"=10'
SHEET 4 OF 5 THIS PHASE

-INDICATES COMMON ELEMENT