

# BUILDING 7 (10-PLEX)

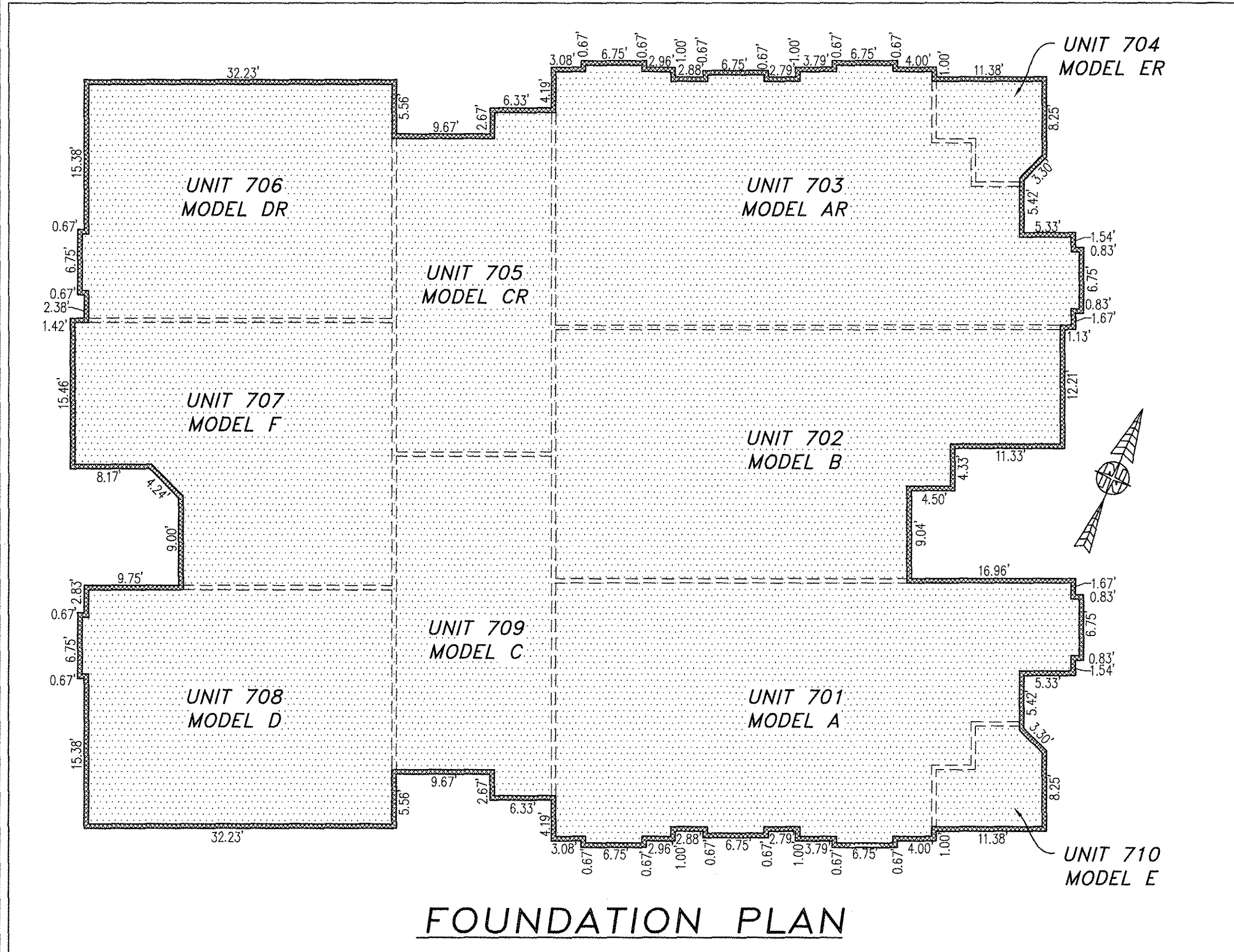

**FOUNDATION PLAN**

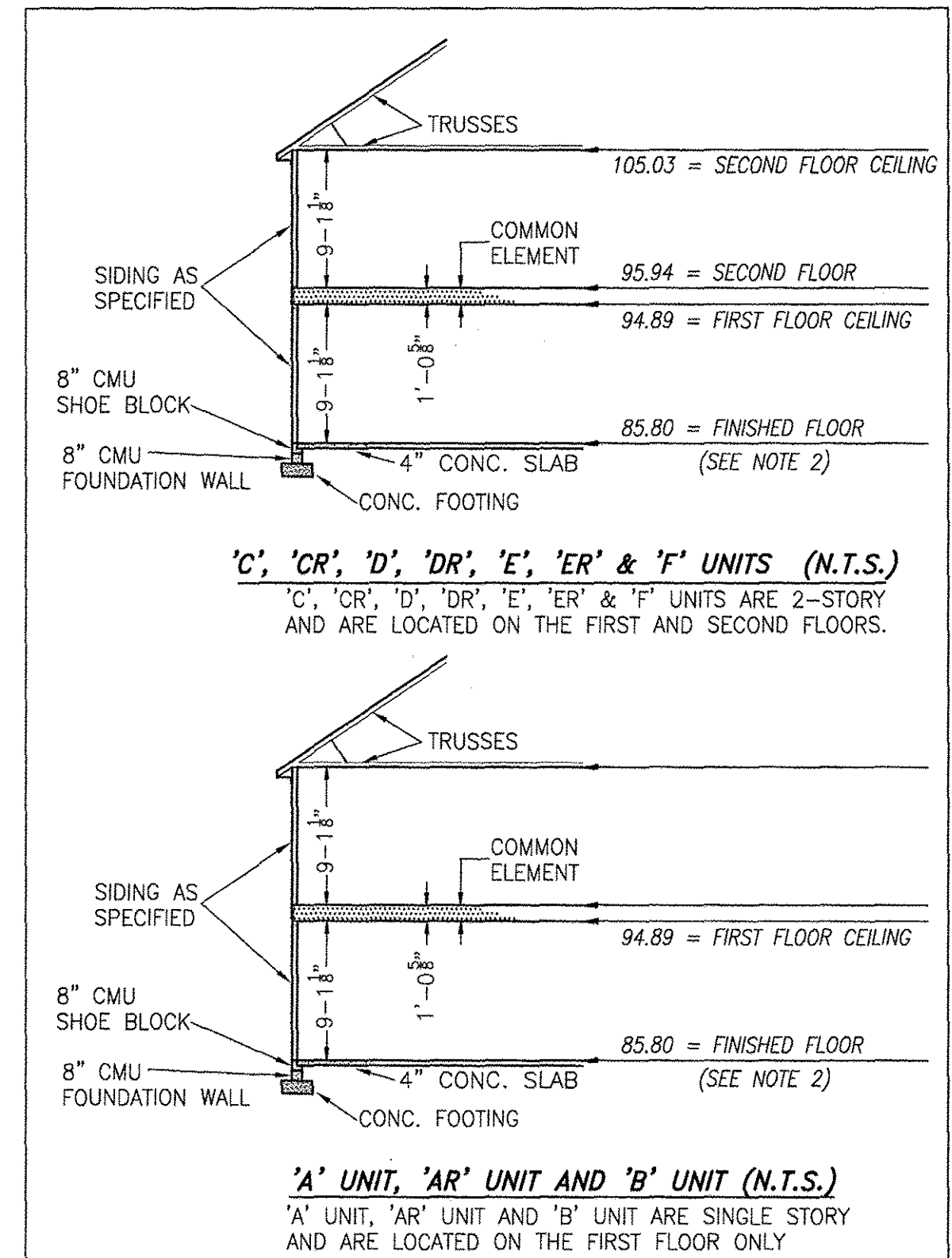

**TYPICAL BUILDING SECTION**

NOT TO SCALE (N.T.S.)

**NOTES:**

1. VERTICAL DATUM REFERENCE: NATIONAL GEODETIC VERTICAL DATUM OF 1929 (NGVD29).
2. FINISHED FLOOR ELEVATION SHOWN WAS TAKEN FROM AS-BUILT SURVEY OF BUILDING #7 (10-PLEX) THE PROMENADE AT JOHN TYLER BY HAYDEN FRYE AND ASSOCIATES PERFORMED ON 09/07/2018.

5 Large/Small Plat(s) Recorded  
herewith as # 180014663

City of Williamsburg & County of James City  
Circuit Court: This PLAT was recorded on  
September 17, 2018  
at 11:11 AM/PM, PB PG  
Document # 180014663  
MONA A. FOLEY, CLERK  
Mona A. Foley, Clerk  
Elizabeth O'Connor DC

I HEREBY CERTIFY THAT THIS PLAN IS ACCURATE AND THAT IT COMPLIES WITH THE PROVISIONS OF THE CODE OF VIRGINIA OF 1950 AS AMENDED, § 55-79.58 AND I FURTHER CERTIFY THAT ALL UNITS THEREOF DEPICTED HEREON, PURSUANT TO THE CODE OF VIRGINIA § 55-79.58B, ARE SUBSTANTIALLY COMPLETE.

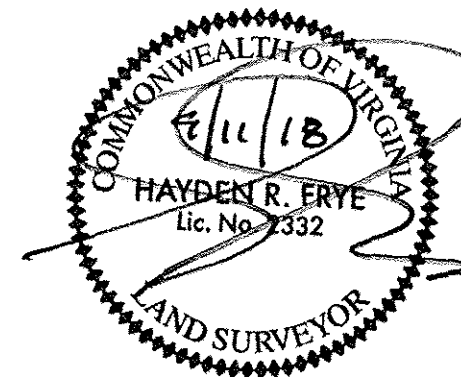

THIS SHEET: FOUNDATION PLAN AND SECTION

**PHASE 7**  
**CONDOMINIUM PLAT AND PLAN**  
OF  
**THE PROMENADE**  
AT  
**JOHN TYLER**  
A CONDOMINIUM  
JAMES CITY COUNTY, VIRGINIA

Job# 160921

Hayden Frye and Associates, Inc.

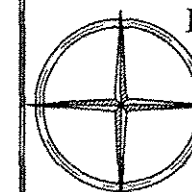

**Land Surveyors**  
333 KELLAM ROAD, SUITE 200  
VIRGINIA BEACH, VA, 23462  
PH: (757) 491-7228 FX: (757) 491-7229

DATE: SEPTEMBER 10, 2018  
SCALE: 1"=10'  
SHEET 4 OF 5 THIS PHASE

JCC Subdivision Agent Approval Not Required

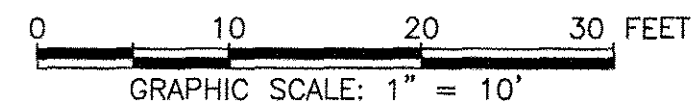

---INDICATES COMMON ELEMENT