

180001779

BUILDING 25 (DUPLEX)

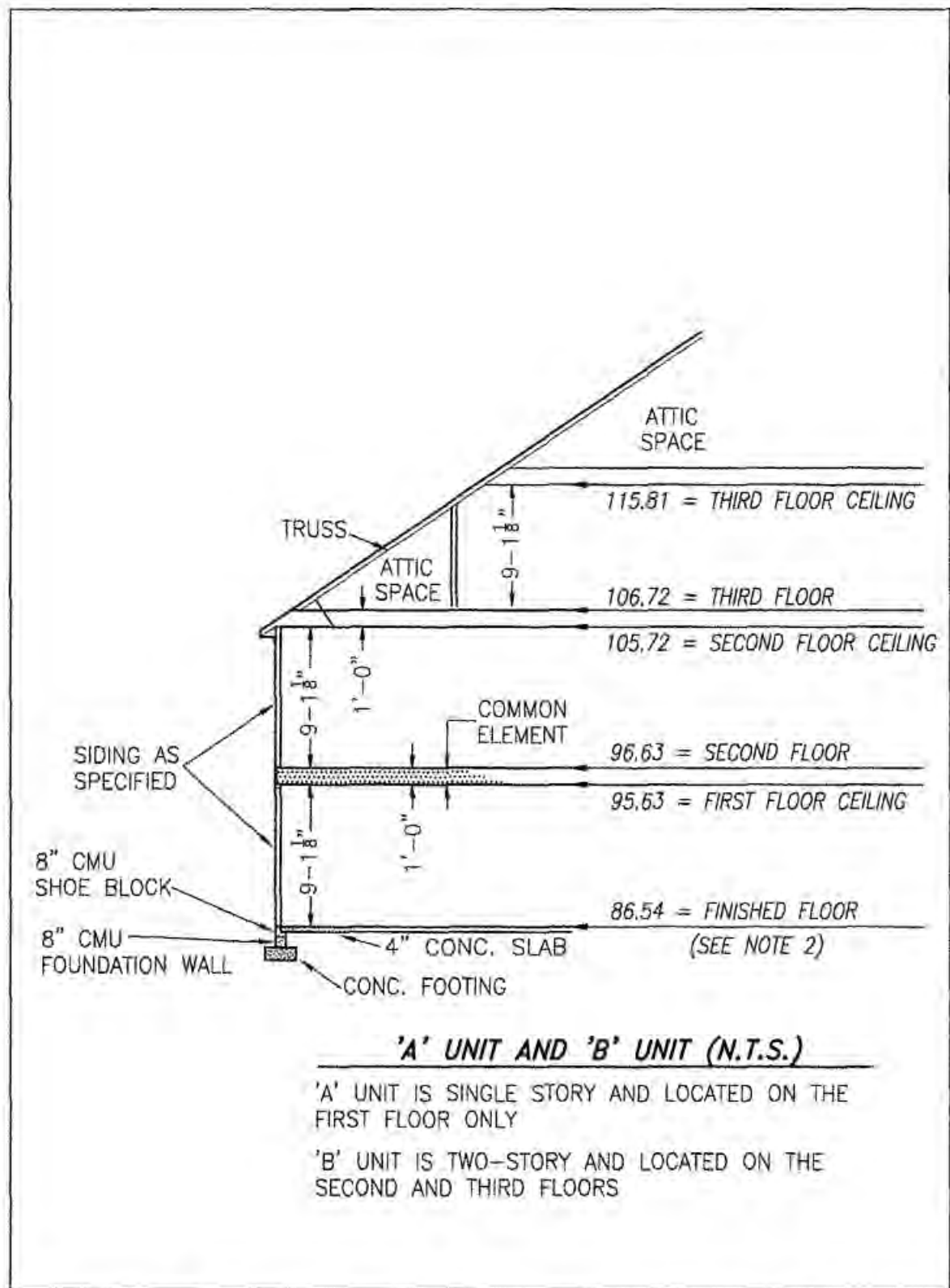
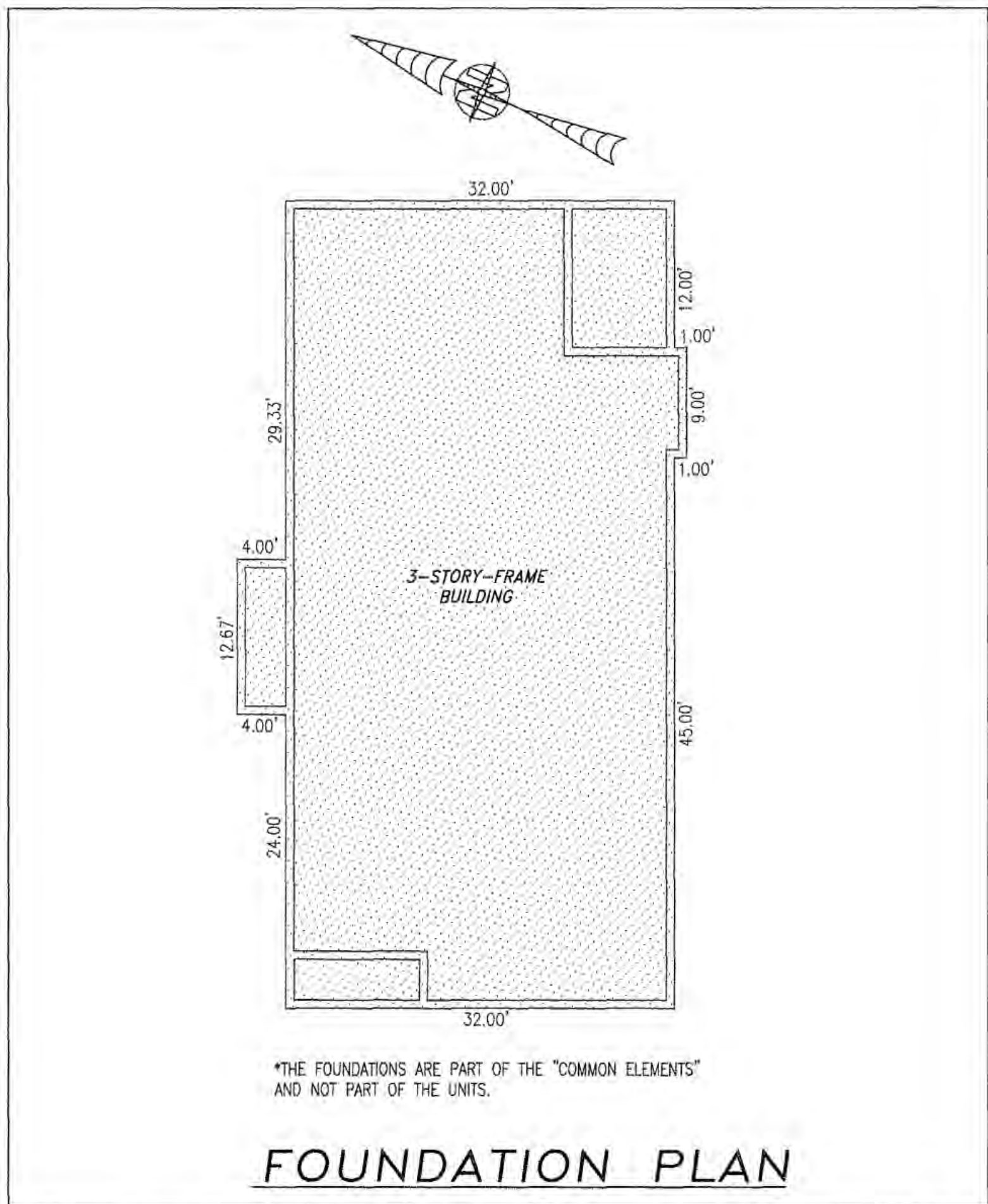

**TYPICAL BUILDING SECTION**

NOT TO SCALE (N.T.S.)

- NOTES:
1. VERTICAL DATUM REFERENCE: NATIONAL GEODETIC VERTICAL DATUM OF 1929 (NGVD29).
  2. FINISHED FLOOR ELEVATION SHOWN WAS TAKEN FROM AS-BUILT SURVEY OF BUILDING #25 (DUPLEX) THE PROMENADE AT JOHN TYLER BY HAYDEN FRYE AND ASSOCIATES DATED: 12/18/2017.

I HEREBY CERTIFY THAT THIS PLAN IS ACCURATE AND THAT IT COMPLIES WITH THE PROVISIONS OF THE CODE OF VIRGINIA OF 1950 AS AMENDED, § 55-79.58 AND I FURTHER CERTIFY THAT ALL UNITS THEREOF DEPICTED HEREON, PURSUANT TO THE CODE OF VIRGINIA § 55-79.58B, ARE SUBSTANTIALLY COMPLETE.

5 Large/Small Plat(s) Recorded  
herewith as # 180001779

City of Williamsburg & County of James City  
Circuit Court: This PLAT was recorded on  
23 Jan 2018  
at 9:30 AM/PM, PB PG  
Document # 180001779  
MONA A. FOLEY, CLERK

*Mona A. Foley*, Clerk  
*Jeanne Swafford D.C.*

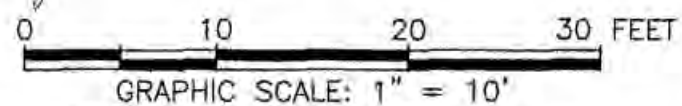

JCC Subdivision Agent *EGC*  
Approval Not Required

THIS SHEET: FOUNDATION PLAN AND SECTION

**PHASE 25**  
**CONDOMINIUM PLAT AND PLAN**  
OF  
**THE PROMENADE**  
AT  
**JOHN TYLER**  
A CONDOMINIUM  
JAMES CITY COUNTY, VIRGINIA

Job# 180921

Hayden Frye and Associates, Inc.  
**Land Surveyors**

DATE: JANUARY 9, 2018  
SCALE: 1"=10'  
SHEET 4 OF 5 THIS PHASE

333 KELLAM ROAD, SUITE 200  
VIRGINIA BEACH, VA., 23462  
PH: (757) 491-7228 FX: (757) 491-7229

-INDICATES COMMON ELEMENT