

170021156

BUILDING 26 (DUPLEX)

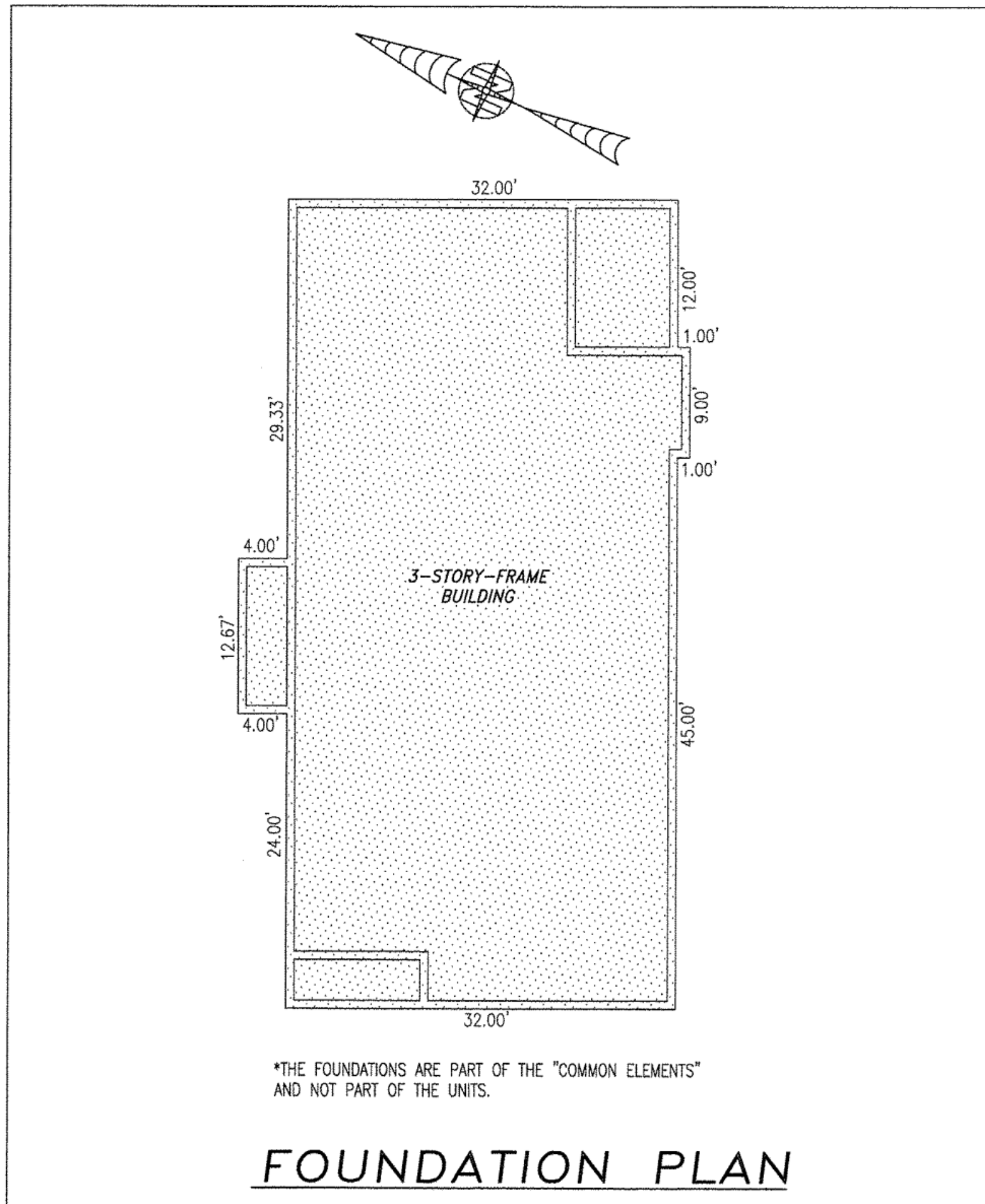

FOUNDATION PLAN

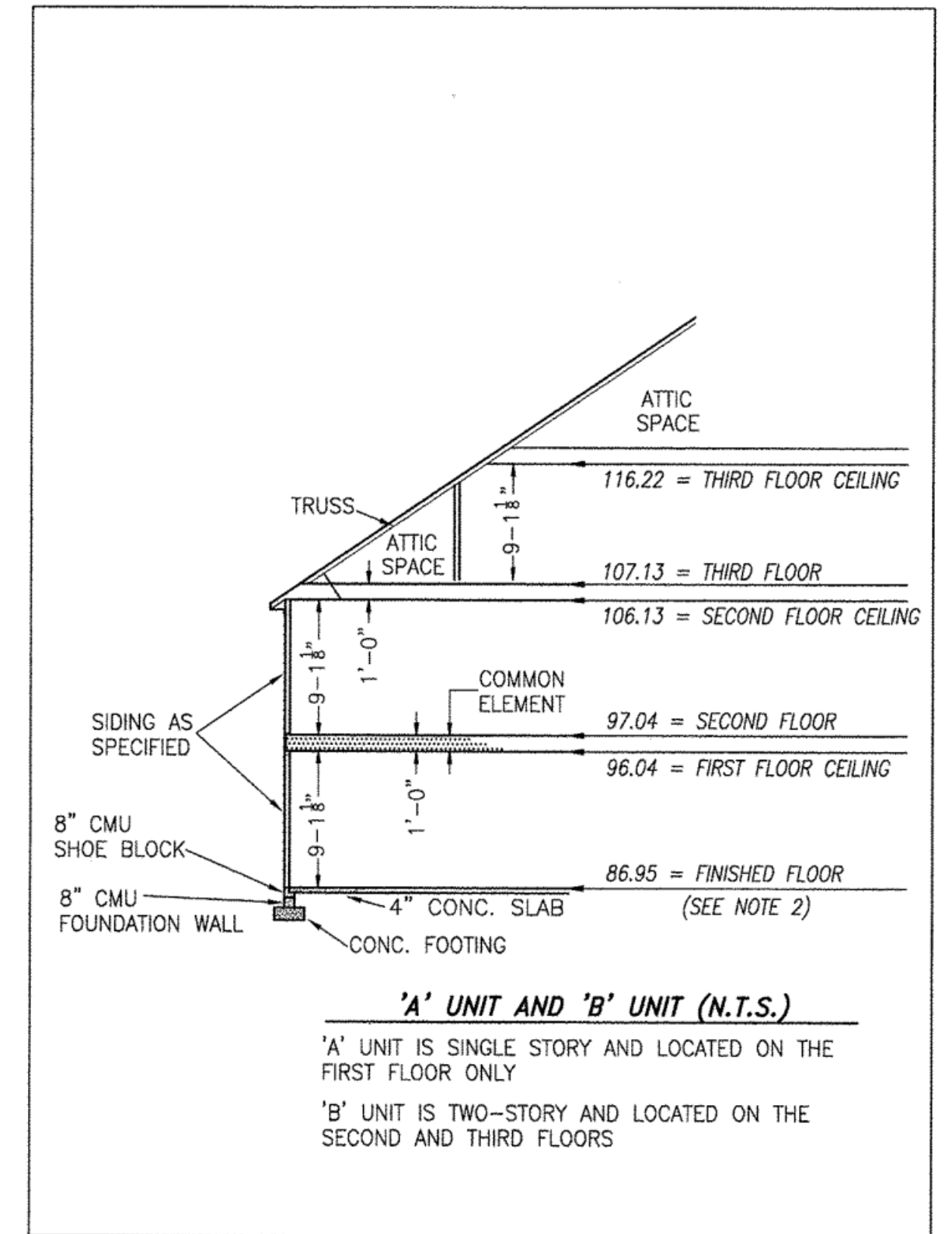

TYPICAL BUILDING SECTION

NOT TO SCALE (N.T.S.)

NOTES:

1. VERTICAL DATUM REFERENCE: NATIONAL GEODETIC VERTICAL DATUM OF 1929 (NGVD29).
2. FINISHED FLOOR ELEVATION SHOWN WAS TAKEN FROM AS-BUILT SURVEY OF BUILDING #26 (DUPLEX) THE PROMENADE AT JOHN TYLER BY HAYDEN FRYE AND ASSOCIATES DATED: 10/25/2017.

I HEREBY CERTIFY THAT THIS PLAN IS ACCURATE AND THAT IT COMPLIES WITH THE PROVISIONS OF THE CODE OF VIRGINIA OF 1950 AS AMENDED, § 55-79.58 AND I FURTHER CERTIFY THAT ALL UNITS THEREOF DEPICTED HEREON, PURSUANT TO THE CODE OF VIRGINIA § 55-79.58B, ARE SUBSTANTIALLY COMPLETE.

5 Large/Small Plat(s) Recorded
 Document # 170021156

City of Williamsburg & County of James City
 Circuit Court: This PLAT was recorded on
 Nov. 7, 2017
 at 3:16 PM, PB PG
 Document # 170021156
 MONA A. FOLEY, CLERK

Mona A. Foley Clerk
Geno Zabillaga, P.C.

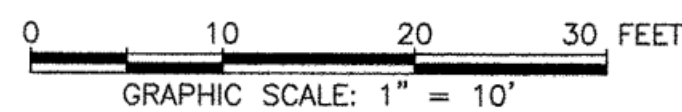

-INDICATES COMMON ELEMENT

THIS SHEET: FOUNDATION PLAN AND SECTION

PHASE 26
CONDOMINIUM PLAT AND PLAN
 OF
THE PROMENADE
 AT
JOHN TYLER
 A CONDOMINIUM
 JAMES CITY COUNTY, VIRGINIA

Jo# 160921



Hayden Frye and Associates, Inc.
Land Surveyors

333 KELLAM ROAD, SUITE 200
 VIRGINIA BEACH, VA., 23462
 PH: (757) 491-7228 FX: (757) 491-7229

DATE: OCTOBER 25, 2017

SCALE: 1"=10'

SHEET 4 OF 5 THIS PHASE

JCC Subdivision Agent
 Approval Not Required