

160014811

CURVE TABLE with columns: CURVE #, DELTA, RADIUS, LENGTH, TANGENT, CHORD, CHORD BEARING. Rows C1 to C44.

CURVE TABLE with columns: CURVE #, DELTA, RADIUS, LENGTH, TANGENT, CHORD, CHORD BEARING. Rows C45 to C88.

CURVE TABLE with columns: CURVE #, DELTA, RADIUS, LENGTH, TANGENT, CHORD, CHORD BEARING. Rows C89 to C132.

CURVE TABLE with columns: CURVE #, DELTA, RADIUS, LENGTH, TANGENT, CHORD, CHORD BEARING. Rows C133 to C137.

EASEMENT LINE TABLE (SEE SHEET 7)

LINE TABLE with columns: LINE, BEARING, LENGTH. Rows L1 to L14.

11 Large/Small Plat(s) Recorded herewith as # 160014811

City of Williamsburg & County of James City Circuit Court: This PLAT was recorded on 8-19-2016 at 2:41 AM/PM, PB PG Document # 160014811 MONA A. FOLEY, CLERK

Revision table with columns: Rev, Date, Description, Revised By. Row 1: 5-9-16, REVISED PER COUNTY COMMENTS DATED 4-1-16, JFS

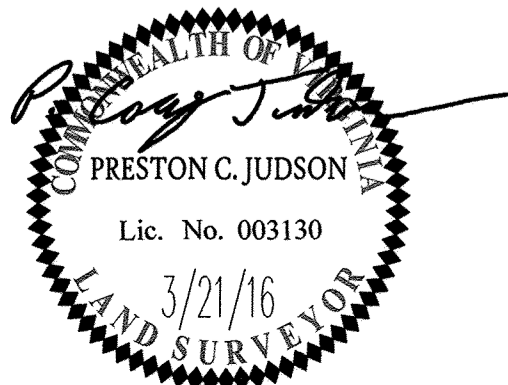

AES CONSULTING ENGINEERS logo and contact information: 5248 Olde Towne Road, Suite 1, Williamsburg, Virginia 23188. Phone: (757) 253-0040. Fax: (757) 220-8994. www.aesva.com

PLAT OF SUBDIVISION WHITE HALL SECTION 4, LOTS 400-494. STONEHOUSE DISTRICT JAMES CITY COUNTY VIRGINIA

Project Contacts: PCJ/JFS, Project Number: 9048-20B, Scale: NONE, Date: 3/21/2016, Sheet Number: 11 OF 11