

Colonial Heritage Phase V1 Sections 1&2

NOT TO SCALE

N/F
 COLONIAL HERITAGE LLC
 499 JOLLY POND ROAD
 WILMINGTON, VA 23188-7326
 Map J 2240100007

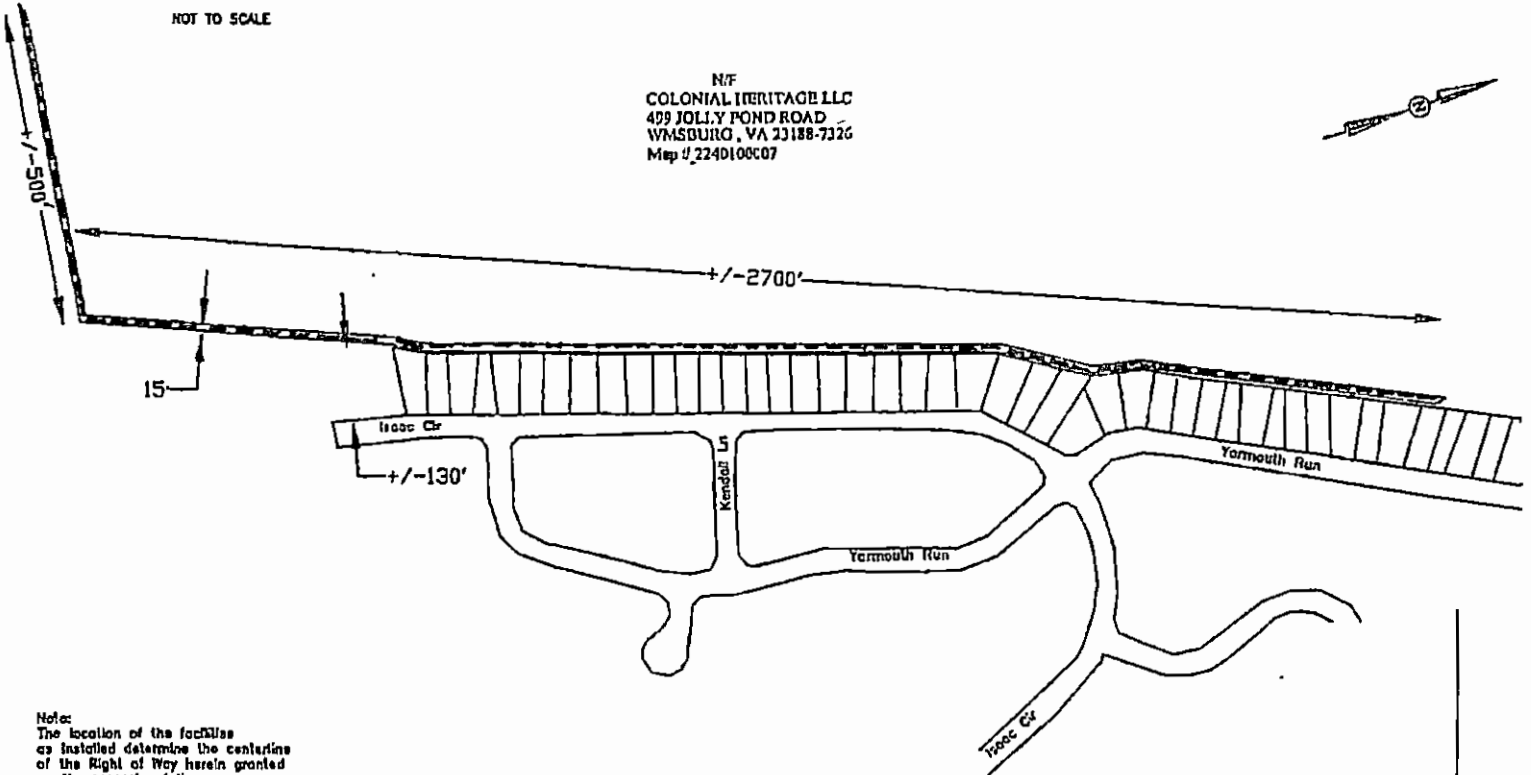
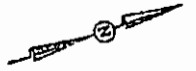

OWNER INITIALS _____

Note:
 The location of the facilities as installed determine the centerline of the Right of Way herein granted on the property of the owner.

rd
 ----- Location of Boundary Lines of Right of Way
 15' In Width

VERIZON VIRGINIA INC. RIGHT-OF-WAY PLAT	OWNER: Colonial Heritage LLC 499 Jolly Pond Rd Williamsburg Va. 23188	CITY/COUNTY: James City Co.									
----- ^r 15' VERIZON EASEMENT WHICH OVERLAYS THE 15' DOMINION POWER EASEMENT	CONTACT TEL. NO.: 757-748-3969	TAX MAP&PARCEL ID:2240100007									
ENGINEERING ASSISTANT : FRED PLEASANTS	GRANTOR'S NAME:	MAGISTERIAL DISTRICT: STONEHOUSE									
PHONE NO.: (757) 875-2506	2 ND GRANTOR:	GRID	<table border="1" style="width: 100%; border-collapse: collapse;"> <tr> <td style="width: 25%;">SH</td> <td style="width: 25%;">E-W</td> <td style="width: 25%;">N-S</td> <td style="width: 25%;">SH. 4</td> </tr> <tr> <td style="text-align: center;">8452</td> <td style="text-align: center;">D</td> <td style="text-align: center;">7</td> <td style="text-align: center;">OF 4.</td> </tr> </table>	SH	E-W	N-S	SH. 4	8452	D	7	OF 4.
SH	E-W	N-S	SH. 4								
8452	D	7	OF 4.								
CENTRAL OFFICE : Williamsburg BC-339772-R RWO# 4A0CH8A	PLAT NO. F3548										