

LINE TABLE		
LINE	BEARING	LENGTH
L1	S51°34'18"W	140.02'
L2	S38°27'37"E	14.72'
L3	S36°26'30"W	17.26'
L4	S42°47'46"W	23.32'
L5	S0°41'30"E	9.54'
L6	S46°50'27"W	22.86'
L7	S6°45'11"E	20.24'
L8	S46°06'02"W	9.80'
L9	S14°22'26"W	25.94'
L10	S7°50'19"W	57.30'
L11	N82°21'33"W	15.00'
L12	N7°50'19"E	58.20'
L13	N14°22'26"E	34.79'
L14	S81°16'55"W	21.99'
L15	S53°39'35"W	18.76'
L16	S25°39'46"W	14.83'
L17	S3°30'09"E	27.35'
L18	S82°56'18"W	42.33'
L19	N52°49'32"W	6.53'
L20	N89°35'31"W	13.48'
L21	N78°23'41"W	14.43'
L22	N64°31'23"W	9.68'
L23	N20°51'49"W	24.81'
L24	N6°12'08"W	5.25'
L25	N40°00'42"W	16.71'
L26	N27°49'14"W	12.81'
L27	N15°32'32"W	12.81'
L28	N3°15'50"W	12.81'
L29	N9°00'52"E	12.81'

LINE TABLE		
LINE	BEARING	LENGTH
L30	N21°17'34"E	12.81'
L31	N33°34'17"E	12.81'
L32	N45°50'59"E	12.81'
L33	N52°10'15"E	82.20'
L34	N49°52'17"E	47.98'
L35	N37°22'19"E	57.29'
L36	N44°55'04"E	85.89'
L37	N49°10'20"E	15.56'
L38	N57°40'52"E	15.56'
L39	N61°27'36"E	58.43'
L40	N65°16'08"E	13.07'
L41	N78°57'07"E	13.07'
L42	S87°21'53"E	13.07'
L43	S73°40'53"E	13.07'
L44	S59°59'53"E	13.07'
L45	S46°18'53"E	13.07'
L46	S32°37'53"E	13.07'
L47	S18°56'53"E	13.07'
L48	S12°17'39"E	34.58'
L49	S45°29'33"W	22.57'
L50	S33°56'28"W	22.57'
L51	S51°19'38"W	33.92'

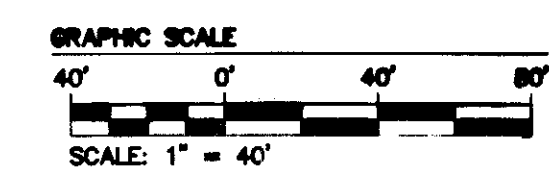
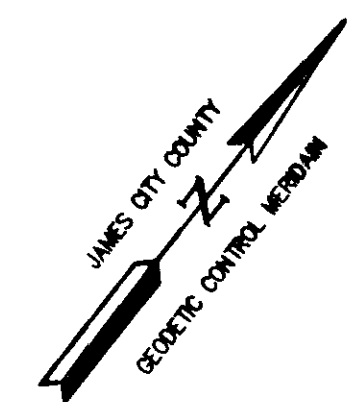

- NOTE:
- SEE SHEETS 7 AND 8 FOR PROPOSED LOTS, RIGHT-OF-WAYS, OPEN SPACES, AND EASEMENTS.
 - THIS SHEET ADDRESSES BMP#1 AND MAINTENANCE AND ACCESS EASEMENTS ONLY.
 - SEE SHEET 9 FOR LOT AND RIGHT OF WAY LINE AND CURVE TABLES.

City of Williamsburg & County of James City
 Circuit Court: This PLAT was recorded on
 2-19-2014
 at 1:47 AM/PM, PB PG
 Document # 160003088
 MONA A. FOLEY, CLERK
 Clerk

10 Large/Small Plat(s) Recorded
 herewith as # 160003088

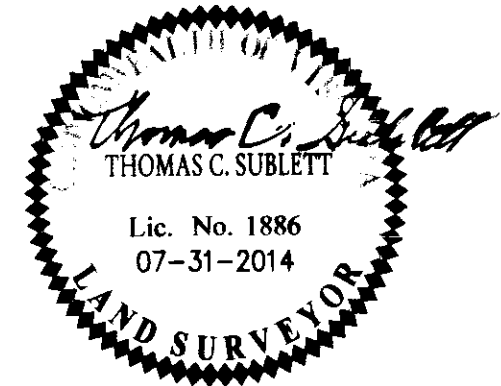

AES
 CONSULTING ENGINEERS
 5248 Old Towne Road, Suite 1
 Williamsburg, Virginia 23188
 Phone: (757) 253-0040
 Fax: (757) 220-8994
 www.aesva.com
 Hampton Roads | Central Virginia | Middle Peninsula

PLAT OF BOUNDARY LINE EXTINGUISHMENT, ADJUSTMENT AND
 SUBDIVISION OF LOTS 10 - 19, 21 - 33, 6015 RICHMOND ROAD
 AND RIGHT-OF-WAY DEDICATION
 PHASE 2 OF
FOREST HEIGHTS NEIGHBORHOOD
 PREPARED FOR:
 JAMES CITY COUNTY HOUSING & COMMUNITY DEVELOPMENT
 POWHATAN DISTRICT JAMES CITY COUNTY VIRGINIA

Project Contacts:	TCS/JFS
Project Number:	W10119-E-03
Scale:	NOTED
Date:	07-31-2014
Sheet Number:	

10 of 10

Rev	Date	Description	Revised By
2	5/07/15	REVISED PER COUNTY COMMENTS	JFS
1	1/14/15	REVISED PER COUNTY COMMENTS	JFS