

10 Large (Small Plats) Recorded herewith as # 150011480	City of Williamsburg & County of James City Circuit Court: This PLAT was recorded on June 10, 2015 at 2:26 AM (PM) PG. Document # 150011480		
	BETSY B. WOOLRIDGE, CLERK Dep. Clerk		
1	04/01/15	REVISED PLAT COUNTY DOCUMENTS	Revised By

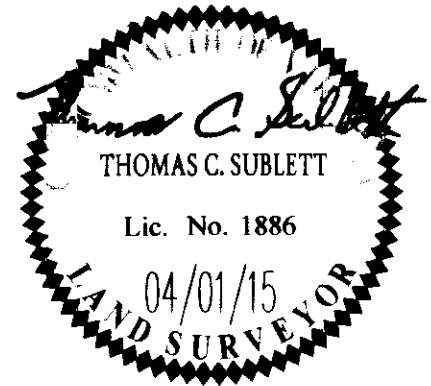

**AES CONSULTING ENGINEERS**  
Hampton Roads | Central Virginia | Middle Peninsula

5248 Olde Towne Road, Suite 1  
Williamsburg, Virginia 23188  
Phone: (757) 253-0040  
Fax: (757) 220-8994  
www.aesva.com

**PLAT OF SUBDIVISION**  
**THE SETTLEMENT AT POWHATAN CREEK**  
**PHASE III-B**  
**LOTS 207-220, 223-231, 237-248, 265-271 AND**  
**COMMON AREA 6B**

BERKELEY DISTRICT | JAMES CITY COUNTY | VIRGINIA

Project Contacts:	TCS
Project Number:	0254-11B
Scale:	1"=30'
Date:	01/16/16
Sheet Number:	6 of 10