

140003368

CERTIFICATION OF SOURCE OF TITLE

THIS IS TO CERTIFY THAT THE LAND EMBRACED IN THIS SUBDIVISION IS IN THE NAME OF XANTERRA KINGSMILL, LLC AND WAS ACQUIRED FROM BUSCH PROPERTIES INC. BY DEED DATED JULY 29, 2010, RECORDED IN THE CLERKS OFFICE OF THE CIRCUIT COURT OF THE COUNTY OF JAMES CITY, VIRGINIA AS INSTRUMENT # 100015441 AND CORRECTION DEED RE-RECORDED AS INSTRUMENT # 100017762, AND IN THE COUNTY OF YORK, VIRGINIA AS INSTRUMENT # 100012374.

OWNER'S CONSENT AND DEDICATION

THE PLATTING OR DEDICATION OF THE FOLLOWING DESCRIBED LAND, PARCELS R-12A AND R-12B, IS WITH THE FREE CONSENT AND IN ACCORDANCE WITH THE DESIRE OF THE UNDERSIGNED OWNERS:

Signature: Gordon Taylor, Date: 9-9-13, Title: Vice President

CERTIFICATE OF NOTARIZATION

STATE OF COLORADO, CITY/COUNTY OF ARAPAHOE

I, USA K CELANIK, A NOTARY PUBLIC IN AND FOR THE CITY/COUNTY AND STATE AFORESAID, DO HEREBY CERTIFY THAT THE ABOVE PERSONS WHOSE NAMES ARE SIGNED TO THE FOREGOING WRITING HAVE ACKNOWLEDGED THE SAME BEFORE ME IN THE CITY/COUNTY AND STATE AFORESAID.

GIVEN UNDER MY HAND THIS 9th DAY OF SEPTEMBER 2013, MY COMMISSION EXPIRES JUNE 1, 2015

Notary Public Signature, Notary Registration Number: 20034013503

SURVEYOR'S CERTIFICATE

I HEREBY CERTIFY THAT TO THE BEST OF MY KNOWLEDGE AND BELIEF, THIS PLAT COMPLIES WITH ALL OF THE REQUIREMENTS OF THE BOARD OF SUPERVISORS AND ORDINANCES OF THE COUNTY OF JAMES CITY, VIRGINIA, AND THE COUNTY OF YORK, VIRGINIA, REGARDING THE PLATTING OF SUBDIVISIONS WITHIN SAID COUNTIES

Signature: Robert D. Mann, Date: 9/3/2013, License: #002509

CERTIFICATE OF APPROVAL

THIS SUBDIVISION IS APPROVED BY THE UNDERSIGNED IN ACCORDANCE WITH EXISTING SUBDIVISION REGULATIONS AND MAY BE ADMITTED TO RECORD.

Signature: Charles Catlett, Date: 9/25/13, Virginia Department of Transportation

Signature: [Agent], Date: 2/19/14, Subdivision Agent of the County of James City

Signature: Al Maddalena, Date: 1/23/14, Subdivision Agent of the County of York

REFERENCE

INSTRUMENT # 090016218 - BOUNDARY LINE ADJUSTMENT PLAT, PARCEL D-1
INSTRUMENT # 100014988 - BOUNDARY PLAT, PARCEL R-15 KINGSMILL ROAD
P.B. 31, PG. 19 - PLAT OF RIGHT-OF-WAY & DRAINAGE EASEMENTS FOR KINGSMILL ROAD
P.B. 10, PG. 606 - PLAT OF SUBDIVISION OF PARCEL "2" - BUSCH CORPORATE CENTER

AREA TABLE

Table with 6 columns: PARCEL NAME, SQ. FT., ACRES, PARCEL NAME, SQ. FT., ACRES. Includes rows for PARCEL R-12A, PARCEL R-12B, and TOTAL AREA SUBDIVIDED.

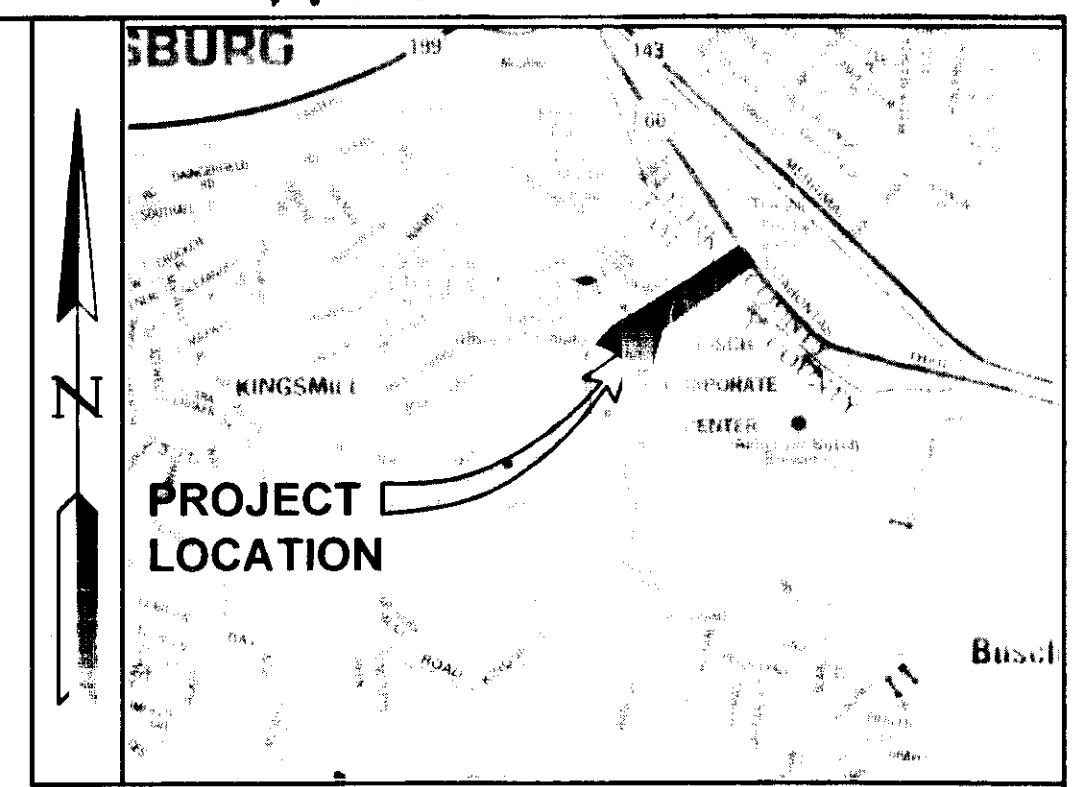
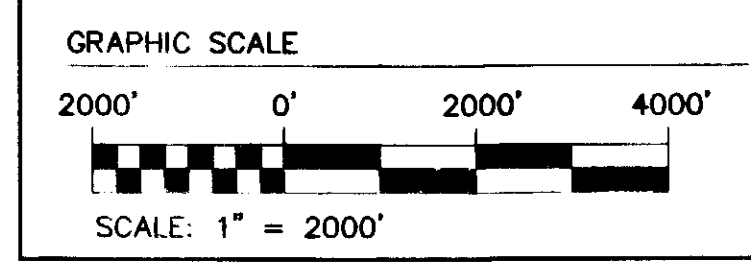
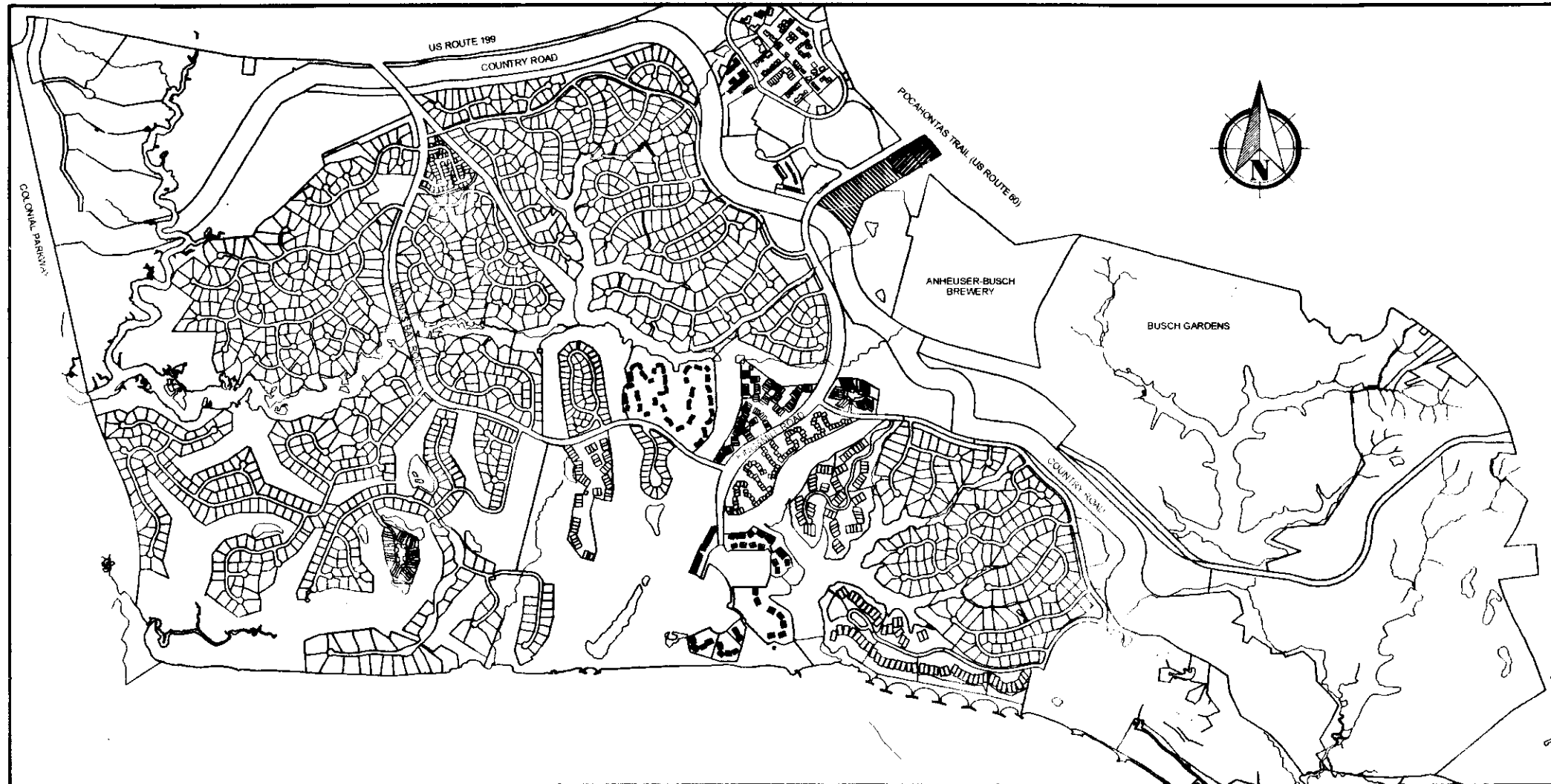

VICINITY MAP SCALE 1"=2000'

GENERAL NOTES

- 1. PROPERTY IS ZONED LIMITED BUSINESS/INDUSTRIAL, M1 (JAMES CITY COUNTY), GENERAL BUSINESS, GB (YORK COUNTY).
2. LOT IS SERVED BY PUBLIC WATER AND SEWER.
3. ALL UTILITIES SHALL BE PLACED UNDERGROUND.
4. THIS PLAT IS BASED UPON RECORD INFORMATION AND DOES NOT REPRESENT A CURRENT FIELD SURVEY...
5. THE PROPERTY SHOWN HEREON IS A PORTION OF TAX MAP PARCEL NO. 5020100078 AND YORK COUNTY GPIN G12D-4751-2165.
6. PROPERTY LIES IN ZONE 'X', AREAS DETERMINED TO BE OUTSIDE THE 0.2% ANNUAL CHANCE FLOODPLAIN...
7. UNLESS OTHERWISE NOTED, ALL DRAINAGE EASEMENTS DESIGNATED ON THIS PLAT SHALL BE PRIVATE.
8. ANY EXISTING UNUSED WELLS SHALL BE ABANDONED IN ACCORDANCE WITH STATE PRIVATE WELL REGULATIONS...
9. UTILITY EASEMENTS DENOTED AS "JCSA UTILITY EASEMENTS" ARE FOR THE EXCLUSIVE USE OF THE JCSA...
10. ALL STREETS SHOWN ON THIS PLAT ARE PRIVATE RIGHT-OF-WAYS THAT SHALL NOT BE MAINTAINED BY THE COUNTY OR THE VIRGINIA DEPARTMENT OF TRANSPORTATION (VDOT).
11. MONUMENTS SHALL BE SET IN ACCORDANCE WITH SECTION 19-34 THRU 19-36 OF THE COUNTY CODE...
12. PHYSICAL IMPROVEMENTS SHOWN HEREON ARE TAKEN FROM JAMES CITY COUNTY GIS AND HAVE NOT BEEN FIELD VERIFIED.

STATE OF VIRGINIA, CITY OF WILLIAMSBURG & COUNTY OF JAMES CITY CIRCUIT COURT. THIS 4TH DAY OF March, 2014. THE PLAT SHOWN HEREON WAS PRESENTED AND ADMITTED TO THE RECORD AS THE LAW DIRECTS @ 10:31 AM/PM

INSTRUMENT # 140003368, TESTE: Betsy B Woolridge, Deputy Clerk

STATE OF VIRGINIA, COUNTY OF YORK CIRCUIT COURT. THIS DAY OF 20. THE PLAT SHOWN HEREON WAS PRESENTED AND ADMITTED TO THE RECORD AS THE LAW DIRECTS @ AM/PM

INSTRUMENT #, TESTE: CLERK

2 Large/Small Plat(s) Recorded herewith as # 140003368

Table with 4 columns: Date, Description, Revised, and other details. Includes entries for 9/3/13 and 7/11/13.

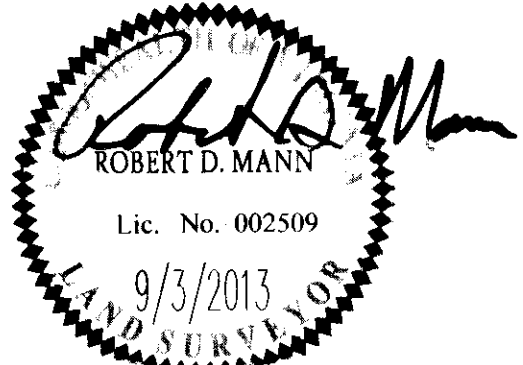

AES CONSULTING ENGINEERS logo and contact information: 1317 Executive Blvd, Suite 150, Chesapeake, Virginia 23320, Phone: (757) 410 7436, www.aesva.com

COMPOSITE PLAT OF SUBDIVISION, PARCEL R-12, BUSCH CORPORATE CENTER, PROPERTY OF XANTERRA KINGSMILL, LLC. Includes location: ROBERTS DISTRICT, BRUTON DISTRICT, COUNTY OF JAMES CITY, COUNTY OF YORK, VIRGINIA, VIRGINIA.

Project Contacts: RDM, Project Number: 7753-40, Scale: 1"=100', Date: 01/29/13, Sheet Number: 1