

130022751

CURVE TABLE						
CURVE #	DELTA	RADIUS	LENGTH	TANGENT	CHORD	CHORD BEARING
C1	108°59'44"	30.00'	57.07'	42.06'	48.85'	N73°30'05"E
C2	58°09'21"	515.00'	522.73'	286.39'	500.58'	S22°55'08"E
C3	99°50'51"	30.00'	52.28'	35.66'	45.91'	S56°04'58"W
C4	32°49'55"	370.00'	212.02'	109.01'	209.13'	S57°34'32"E
C5	32°15'18"	80.30'	45.21'	23.22'	44.61'	S25°01'55"E
C6	23°32'18"	311.00'	127.77'	64.80'	126.87'	S59°29'50"W
C7	110°42'16"	139.00'	268.57'	201.13'	228.70'	N77°10'06"W
C8	1°51'44"	1970.00'	64.03'	32.02'	64.03'	S47°37'24"E
C9	3°52'03"	2030.00'	137.03'	68.54'	137.00'	S46°37'15"E
C10	4°04'49"	725.00'	51.63'	25.83'	51.62'	N36°01'22"E
C11	78°40'07"	175.00'	240.28'	143.41'	221.85'	N5°21'06"W
C12	36°04'05"	300.00'	188.85'	97.67'	185.75'	N26°39'07"W
C13	19°26'31"	247.13'	83.86'	42.34'	83.46'	N82°59'58"E
C14	8°58'42"	300.00'	47.01'	23.55'	46.96'	N68°47'21"E
C15	29°34'42"	125.00'	64.53'	33.00'	63.82'	N79°05'21"E
C16	91°22'48"	125.00'	199.36'	128.05'	178.89'	S40°25'50"E
C17	86°38'12"	175.00'	264.62'	165.02'	240.12'	N42°48'08"W
C18	29°34'40"	175.00'	90.34'	46.20'	89.34'	S79°05'24"W
C19	8°58'38"	250.00'	39.17'	19.63'	39.13'	S68°47'23"W
C20	49°23'05"	400.00'	344.77'	183.91'	334.20'	N32°23'57"W
C21	30°44'39"	265.94'	142.70'	73.11'	140.99'	N41°43'07"W
C22	0°46'41"	525.00'	7.13'	3.57'	7.13'	N26°44'08"W
C23	53°27'35"	200.00'	186.61'	100.72'	179.91'	S49°28'29"E
C24	55°24'59"	275.00'	265.98'	144.43'	255.73'	S50°27'11"E
C25	90°00'00"	145.00'	227.77'	145.00'	205.06'	N56°50'19"E

CURVE TABLE						
CURVE #	DELTA	RADIUS	LENGTH	TANGENT	CHORD	CHORD BEARING
C26	9°25'00"	425.00'	69.85'	35.00'	69.77'	N16°32'48"E
C27	98°55'49"	30.00'	51.80'	35.08'	45.60'	N70°43'07"E
C28	32°34'35"	750.03'	426.44'	219.16'	420.72'	S76°06'14"E
C29	21°06'07"	763.02'	281.02'	142.12'	279.43'	N78°16'25"E
C30	10°00'00"	1487.00'	259.53'	130.10'	259.20'	S52°46'27"E
C31	10°28'49"	2230.30'	407.96'	204.55'	407.39'	S65°01'57"E
C32	27°34'21"	930.01'	447.55'	228.20'	443.24'	S10°34'41"W
C33	27°35'11"	104.99'	50.55'	25.78'	50.06'	N87°53'43"E
C34	40°21'27"	91.50'	64.45'	33.63'	63.13'	S71°51'51"E
C35	20°31'23"	72.00'	25.79'	13.03'	25.65'	S61°56'58"E
C36	44°01'34"	75.00'	57.63'	30.32'	56.22'	N85°46'28"E
C37	31°17'39"	152.00'	83.02'	42.57'	81.99'	N48°06'46"E
C38	10°03'33"	175.00'	30.72'	15.40'	30.68'	N4°30'49"W
C39	19°42'29"	162.50'	55.90'	28.23'	55.62'	N43°28'32"E
C40	116°02'08"	83.50'	169.11'	133.72'	141.65'	S88°21'39"E
C41	11°46'11"	140.50'	28.86'	14.48'	28.81'	N44°51'35"W
C42	20°24'06"	232.50'	82.79'	41.84'	82.35'	N40°32'38"W
C43	116°02'08"	108.50'	219.74'	173.76'	184.06'	N88°21'39"W
C44	24°18'27"	137.50'	58.33'	29.61'	57.90'	S45°46'31"W
C45	58°27'10"	175.00'	178.53'	97.91'	170.89'	N56°53'39"W

LINE TABLE		
LINE	BEARING	LENGTH
L1	N43°18'28"E	60.00'
L2	N17°30'05"E	51.22'
L3	S72°29'58"E	50.00'
L4	S17°30'02"W	32.55'
L5	S74°06'09"W	3.40'
L6	N67°29'51"E	33.67'
L7	N53°19'47"E	61.02'
L8	N33°37'17"E	40.28'
L9	N28°31'21"E	22.52'
L10	S67°29'51"W	30.09'
L11	N67°43'22"E	31.59'
L12	S47°46'27"E	5.00'

LINE TABLE		
LINE	BEARING	LENGTH
L13	S71°01'07"E	50.00'
L14	S36°20'57"E	14.76'
L15	S1°15'37"E	25.92'
L16	S83°10'03"W	13.29'
L17	S88°53'58"W	35.69'
L18	N80°44'53"W	18.47'
L19	N86°08'03"E	24.08'
L20	N42°20'51"E	35.32'
L21	N22°01'43"E	23.51'
L22	S74°48'06"E	22.93'
L23	N76°15'54"E	20.70'
L24	S23°17'21"W	18.88'

LINE TABLE		
LINE	BEARING	LENGTH
L25	S50°33'46"E	42.00'
L26	S13°32'20"E	32.81'
L27	N88°06'01"E	41.58'
L28	S42°11'44"E	18.53'
L29	N87°57'26"E	8.62'
L30	S17°47'11"W	26.92'
L31	S72°12'49"E	21.97'

EASEMENT CENTERLINE TABLE		
LINE	BEARING	LENGTH
CLE1	S26°43'39"W	237.47'
CLE2	S86°21'19"W	31.06'
CLE3	S75°21'43"W	188.46'
CLE4	N29°45'50"E	64.43'
CLE5	N16°31'12"E	127.82'
CLE6	N84°05'03"W	80.69'
CLE7	N45°36'46"W	185.50'
CLE8	S52°19'06"W	281.07'
CLE9	S0°00'00"E	38.90'
CLE10	S64°15'33"E	66.74'
CLE11	S40°41'45"E	72.93'

2	9/3/13	REVISED AS PER COMMENT LETTERS	JCA
1	7/11/13	REVISED AS PER COMMENT LETTERS	JCA

City of Williamsburg & County of James City
 Circuit Court: This PLAT was recorded on
2 October, 2013
 at **12:53** AM/PM, PB **PG**
 Document # **130022751**
BETSY B. WOOLRIDGE, CLERK
[Signature], Dep. Clerk

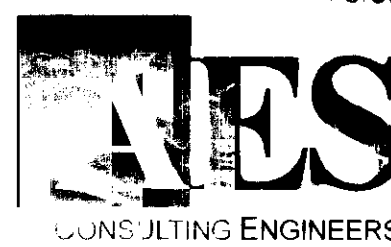
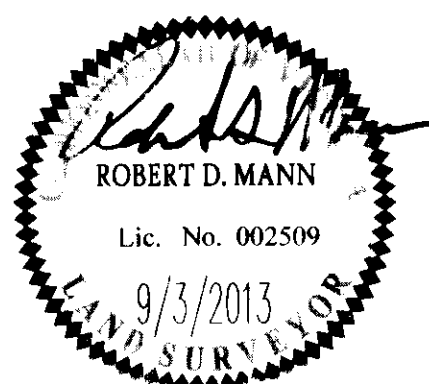

1317 Executive Blvd, Suite 150
 Chesapeake, Virginia 23320
 Phone: (757) 410-7436

www.aesva.com

Hampton Roads | Central Virginia | Middle Peninsula

COMPOSITE PLAT OF SUBDIVISION
 PARCEL R-2
 KINGSMILL RESORT
 PROPERTY OF
XANTERRA KINGSMILL, LLC
 ROBERTS DISTRICT COUNTY OF JAMES CITY VIRGINIA

Project Contacts:	RDM
Project Number:	7753-40
Scale:	1"=100'
Date:	01/29/13
Sheet Number:	9