

CURVE TABLE

CURVE #	DELTA	RADIUS	LENGTH	TANGENT	CHORD	CHORD BEARING
C1	32°13'56"	100.00'	56.26'	28.89'	55.52'	S60°35'59"W
C2	90°00'00"	10.00'	15.71'	10.00'	14.14'	N58°17'03"W
C3	90°00'00"	10.00'	15.71'	10.00'	14.14'	S31°42'57"W

2 Large/Small Plat(s) Recorded herewith as # 130022585

**NOTE:**  
THIS RIGHT-OF-WAY IS PLATTED WITH THE INTENT OF BEING EXTENDED AND CONTINUED IN ORDER TO PROVIDE INGRESS AND EGRESS TO AND FROM FUTURE SUBDIVISIONS.

City of Williamsburg & County of James City  
Circuit Court: This PLAT was recorded on  
**1 October, 2013**  
at 10:19 AM/PM, PG —  
Document # 130022585  
BETSY B. WOOLRIDGE, CLERK  
*Betsy Woolridge*, Dep. Clerk

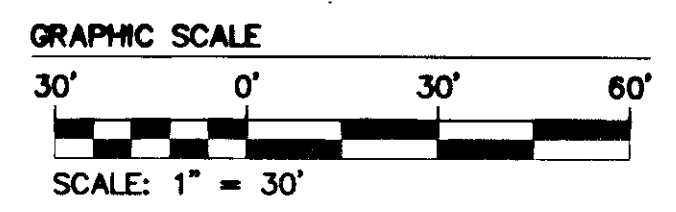

Rev.	Date	Description	JRK Revised By
1	7-3-13	REVISIONS PER JAMES CITY COUNTY	JRK

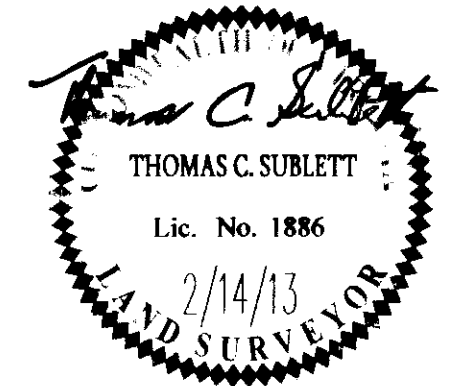

**AMES**  
CONSULTING ENGINEERS  
5248 Old Towne Road, Suite 1  
Williamsburg, Virginia 23188  
Phone: (757) 253-0040  
Fax: (757) 220-8994  
www.amesva.com  
Hampton Roads | Central Virginia | Middle Peninsula

PLAT OF SUBDIVISION  
PHASE X, SECTION 7  
LOTS 79-88  
NEW TOWN  
OWNED BY ABVA DEVELOPMENT, LP  
JAMESTOWN DISTRICT JAMES CITY COUNTY VIRGINIA

Project Contacts: TCS/JRK  
Project Number: 6632-07-05B  
Scale: 1" = 30' Date: 2/14/13  
Sheet Number  
**2 of 2**