

EX. 20' PRIVATE UTILITY EASEMENT
DOC. #040017945

KRISTIANSD &
PARCEL 1, PART OF BROWN
SECTION 4
LOT 105
SHARYN FORD
D.B. 462, PG. 311
ZONED: R2

EX. 30' DRAINAGE AND UTILITY EASEMENT
DOC. #040017945, DOC. #030017770,
P.B. 90, PG. 61

EX. 20' EXCLUSIVE JCSA
UTILITY EASEMENT
DOC. #040017945
DOC. #030017770
P.B. 90, PG. 61

SURVEY TIE-LINE
(CENTERLINE OF STREAM
IS BOUNDARY LINE)

COLONIAL HERITAGE, L.L.C.
PHASE 1, SECTION 2
COMMON OPEN SPACE #2
INSTR. #03000331
LP #030000329
LP #030023467
PARCEL ID #232090001C

VERTICAL DATUM
JAMES CITY COUNTY GEODETIC
CONTROL NETWORK - NGVD29

FINISH FLOOR ELEVATION			
PHASE	BUILDING SLAB	GARAGE SLAB LEVEL 1	GARAGE SLAB LEVEL 2
1-A	91.14	90.47	N/A
3-A	92.98	92.27	N/A
4-A	92.99	92.26	N/A
5-A	90.95	90.36	N/A
6-A	92.31	91.78	N/A
7-A	92.91	92.37	N/A
8-A	94.87	94.22	N/A
9-A	94.10	93.28	N/A
10-A	93.23	92.50	N/A
11-A	92.15	91.36	N/A
12-A	91.16	89.77	90.62
13-A	87.30	86.04	86.75
14-A	82.92	81.10	81.69
15-A	83.28	81.36	81.94
16-A	88.51	86.20	87.20
18-A	91.30	90.58	90.87

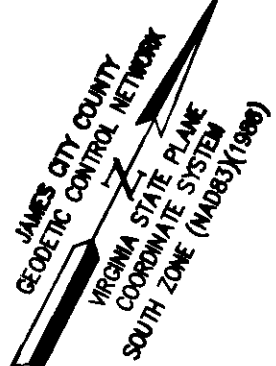

EX. 25' JCSA SEWER
EASEMENT
D.B. 214, PG. 266

LIMITS OF WETLANDS
(MARKED BY WILLIAMSBURG
ENVIRONMENTAL GROUP AND FIELD
LOCATED BY AES CONSULTING
ENGINEERS ON 4-2-04)

LEGEND

- CE COMMON ELEMENT
- CO CLEAN OUT
- WM WATER METER
- S SANITARY MANHOLE
- FH FIRE HYDRANT
- WV WATER VALVE

9 Large/Small Plat(s) Recorded
herewith as # 110021800

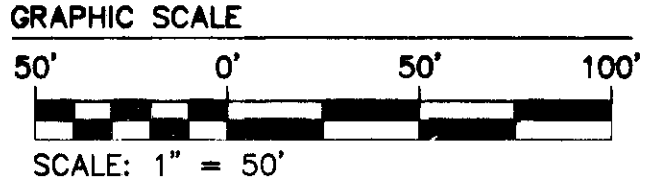

Rev	Date	Description	Revised By

City of Williamsburg & County of James City
Circuit Court: This PLAT was recorded on
21 October 2011
at 2:43 AM/PM PB PG
DOCUMENT # 110021800
BETSY B. WOOLRIDGE, CLERK
Betsy Woolridge Clerk

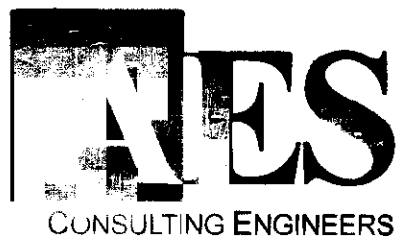
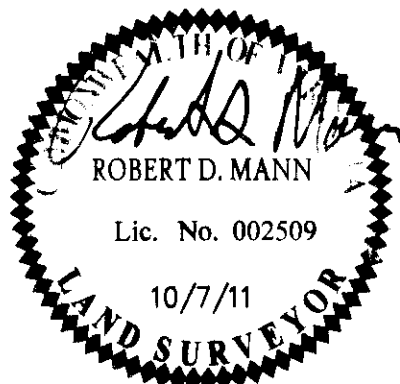

5248 Olde Towne Road, Suite 1
Williamsburg, Virginia 23188
Phone: (757) 253-0040
Fax: (757) 220-8994
www.aesva.com

Hampton Roads | Central Virginia | Middle Peninsula

"EXHIBIT 1"
PLAT OF CONDOMINIUM
WILLIAMSBURG VILLAGE AT NORGE CONDOMINIUM
PHASE 18-A
UNITS #1801, 1802, 1803, AND 1804
STONEHOUSE DISTRICT COUNTY OF JAMES CITY VIRGINIA

Project Contacts: AES
Project Number: 9286-02-B
Scale: 1"=50' Date: 10-7-2011
Sheet Number
2 OF 9