

**CERTIFICATION OF SOURCE OF TITLE: PARCEL R-9**

THIS IS TO CERTIFY THAT THE LAND EMBRACED IN THIS SUBDIVISION IS IN THE NAME OF BUSCH PROPERTIES, INC., A DELAWARE CORPORATION AND WAS ACQUIRED FROM ANHEUSER-BUSCH, INCORPORATED, A MISSOURI CORPORATION BY DEED DATED NOVEMBER 14, 1972 IN DEED BOOK 141, PAGE 313, DULY RECORDED IN THE CLERK'S OFFICE OF THE CIRCUIT COURT OF THE COUNTY OF JAMES CITY, VIRGINIA.

**CERTIFICATION OF SOURCE OF TITLE: PARCEL R-11**

THIS IS TO CERTIFY THAT THE LAND EMBRACED IN THIS SUBDIVISION IS IN THE NAME OF BUSCH PROPERTIES, INC., A DELAWARE CORPORATION AND WAS ACQUIRED FROM ANHEUSER-BUSCH, INCORPORATED, A MISSOURI CORPORATION BY DEED DATED JUNE 7, 1994 IN DEED BOOK 714, PAGE 469, DULY RECORDED IN THE CLERK'S OFFICE OF THE CIRCUIT COURT OF THE COUNTY OF JAMES CITY, VIRGINIA.

**CERTIFICATION OF SOURCE OF TITLE: CARTER'S GROVE COUNTRY ROAD**

THIS IS TO CERTIFY THAT THE LAND EMBRACED IN THIS SUBDIVISION IS IN THE NAME OF BUSCH PROPERTIES, INC., A DELAWARE CORPORATION ("BUSCH" - INDEX AS GRANTOR AND GRANTEE) AND WAS ACQUIRED FROM THE COLONIAL WILLIAMSBURG FOUNDATION, A VIRGINIA CORPORATION ("CW" - INDEX AS GRANTOR AND GRANTEE) WHICH IS THE SUCCESSOR TO BOTH COLONIAL WILLIAMSBURG, INCORPORATED ("CWI") AND WILLIAMSBURG RESTORATION, INCORPORATED ("WRI"), ANHEUSER-BUSCH, INCORPORATED, A MISSOURI CORPORATION ("A-B" - INDEX AS GRANTOR) BY BOUNDARY LINE DEED DATED NOVEMBER 28, 2006 IN INSTRUMENT #060029609, DULY RECORDED IN THE CLERK'S OFFICE OF THE CIRCUIT COURT OF THE COUNTY OF JAMES CITY, VIRGINIA.

**OWNER'S CONSENT AND DEDICATION**

THE SUBDIVISION OF THE PROPERTY SHOWN HEREON IS WITH THE FREE CONSENT AND IN ACCORDANCE WITH THE DESIRES OF THE UNDERSIGNED OWNERS, PROPRIETORS, AND OR TRUSTEES.

Robin D. Carson DATE 7/9/10  
 ROBIN D. CARSON  
 EXECUTIVE VICE PRESIDENT  
 BUSCH PROPERTIES, INC.

**CERTIFICATE OF NOTARIZATION**

STATE OF VIRGINIA, CITY/COUNTY OF JAMES CITY  
 TO-WIT:

I, GWEN C. SCHATZMAN, A NOTARY PUBLIC IN AND FOR THE CITY/COUNTY AND STATE AFORESAID, DO HEREBY CERTIFY THAT THE ABOVE PERSONS WHOSE NAMES ARE SIGNED TO THE FOREGOING WRITING HAVE ACKNOWLEDGED THE SAME BEFORE ME IN THE CITY/COUNTY AND STATE AFORESAID.

GIVEN UNDER MY HAND THIS 9<sup>th</sup> DAY OF JULY, 2010.

MY COMMISSION EXPIRES 11/30/2013

Gwen C. Schatzman  
 NOTARY PUBLIC  
 NOTARY REGISTRATION NUMBER: 361448  
 Gwen C. Schatzman  
 Commonwealth of Virginia  
 Notary Public  
 Commission No. 361448  
 My Commission Expires 11/30/2013

**SURVEYOR'S CERTIFICATE**

I HEREBY CERTIFY THAT TO THE BEST OF MY KNOWLEDGE AND BELIEF, THIS PLAT COMPLIES WITH ALL OF THE REQUIREMENTS OF THE BOARD OF SUPERVISORS AND ORDINANCES OF THE COUNTY OF JAMES CITY, VIRGINIA, REGARDING THE PLATTING OF SUBDIVISIONS WITHIN THE COUNTY.

Robert D. Mann 6/24/10  
 ROBERT D. MANN, L.S. LIC. NO. 002509 DATE

**CERTIFICATE OF APPROVAL**

THIS SUBDIVISION IS APPROVED BY THE UNDERSIGNED IN ACCORDANCE WITH EXISTING SUBDIVISION REGULATIONS AND MAY BE ADMITTED TO RECORD.

[Signature] 7-15-10  
 SUBDIVISION AGENT OF JAMES CITY COUNTY

**AREA TABULATION  
 CARTER'S GROVE COUNTRY ROAD**

	SQUARE FEET	ACRES
ADDITION #1 TO CARTER'S GROVE COUNTRY ROAD	172,534 S.F.±	3.961 AC.±
ADDITION #2 TO CARTER'S GROVE COUNTRY ROAD	755,701 S.F.±	17.348 AC.±
ADDITION #1 TO PARCEL R-9	18,463 S.F.±	0.424 AC.±

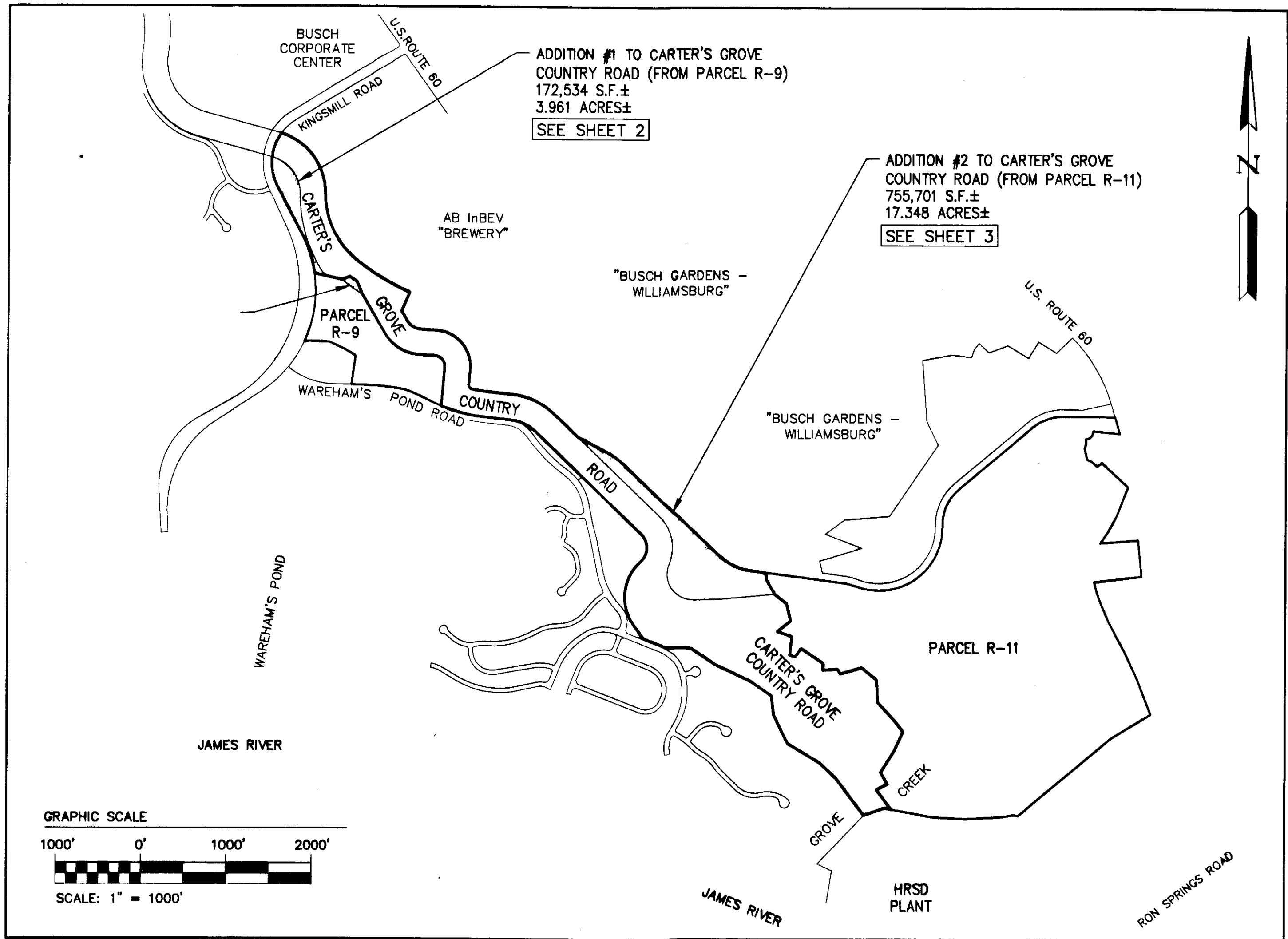

**NOTES:**

- PROPERTY IS ZONED R-4, RESIDENTIAL PLANNED COMMUNITY.
- THE PROPERTY SHOWN IS PART OF TAX MAP PARCEL (51-3)(1-2).
- ALL UTILITIES SHALL BE PLACED UNDERGROUND.
- ALL LOTS ARE TO BE SERVED BY PUBLIC WATER OF THE CITY OF NEWPORT NEWS, DEPARTMENT OF PUBLIC UTILITIES, AND SEWER SYSTEMS OF THE JAMES CITY SERVICE AUTHORITY.
- UNLESS OTHERWISE NOTED, ALL DRAINAGE EASEMENTS SHALL BE PRIVATE.
- WETLANDS AND LAND WITHIN THE RESOURCE PROTECTION AREAS SHALL REMAIN IN A NATURAL UNDISTURBED STATE EXCEPT FOR THOSE ACTIVITIES PERMITTED BY SECTION 23-7(c) OF THE JAMES CITY COUNTY CODE.
- NEW MONUMENTS SHALL BE SET IN ACCORDANCE WITH SECTIONS 19-34 THROUGH 19-36 OF THE SUBDIVISION ORDINANCE.
- THIS PLAT WAS PREPARED WITHOUT THE BENEFIT OF A CURRENT TITLE REPORT AND MAY NOT SHOW ALL ENCUMBRANCES ON THE PROPERTY.
- THIS PLAT IS A COMPOSITE OF EXISTING DEED AND PLATS OF RECORD. A FIELD SURVEY OF THE PROPERTY HAS NOT BEEN PERFORMED.

3 Large/Small Plat(s) Recorded  
 Instrument # 100014376

STATE OF VIRGINIA  
 CITY OF WILLIAMSBURG & COUNTY OF JAMES CITY CIRCUIT COURT, THIS 16<sup>th</sup> DAY OF July, 2010, THE PLAT SHOWN HEREON WAS PRESENTED AND ADMITTED TO THE RECORD AS THE LAW DIRECTS. @ 12:39 AM/PM

INSTRUMENT # 100014376  
 TESTE: Betsy B. Woolridge  
 BETSY B. WOOLRIDGE, CLERK  
 By Christina St. George, Dep. Clerk

Rev.	Date	Description	Revised By
2	6/24/2010	BOUNDARY LINE ADJUSTMENT AND EASEMENT ADDITION	RDM
1	6/18/2010	ADDED EASEMENTS, WETLANDS AND RPA	RDM

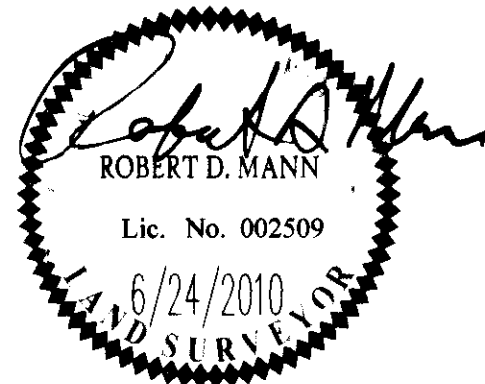

**AVES**  
 CONSULTING ENGINEERS  
 5245 Old Towne Road, Suite 1  
 Williamsburg, Virginia 23188  
 Phone: (757) 253-0040  
 Fax: (757) 220-8994  
 www.avesva.com  
 Hampton Roads | Central Virginia | Middle Peninsula

COMPOSITE PLAT OF BOUNDARY LINE ADJUSTMENT  
**CARTER'S GROVE COUNTRY ROAD  
 AND PARCELS R-9 & R-11**  
 KINGSMILL ON THE JAMES  
 ROBERTS DISTRICT JAMES CITY COUNTY VIRGINIA

Project Contacts: **RDM**  
 Project Number: **7783-28**  
 Scale: **1" = 1000'** Date: **04-06-2010**  
 Sheet Number: **1 OF 3**