

100008359

CURVE TABLE						
CURVE	RADIUS	LENGTH	TANGENT	DELTA	CHORD BEARING	CHORD
C1	338.66'	28.89'	14.45'	4°53'14"	N27°29'26"E	28.88'
C2	333.00'	162.85'	83.09'	28°01'13"	N19°45'31"E	161.23'
C3	37.00'	56.02'	34.96'	86°45'02"	N49°08'35"E	50.82'

LINE TABLE		
LINE	BEARING	DISTANCE
L1	N05°46'04"E	63.26'
L2	N48°19'20"W	68.74'
L3	N07°34'36"E	43.39'
L4	N00°00'00"E	222.08'
L5	N50°38'19"E	130.92'
L6	S16°22'46"W	264.24'
L7	S87°28'54"E	6.72'

**NOTES:**

THIS PLAT WAS PREPARED WITHOUT THE BENEFIT OF A TITLE BINDER, THEREFOR ALL EXISTING EASEMENTS MAY NOT BE SHOWN.

Large/Small Plat(s) Recorded herewith as # 100008359

City of Williamsburg & County of James City Circuit Court: This PLAT was recorded on 4-30-2010 at 2:13 AM/PM, PB      PG      DOCUMENT # 100008359 BETSY B. WOOLRIDGE, CLERK

*Betsy B. Woolridge* Clerk

**PLAT SHOWING A VARIABLE WIDTH CONSERVATION EASEMENT ACROSS THE PROPERTY OF JAMES CITY COUNTY, VIRGINIA**

Powhatan District	James City County, Va
DATE: SEPT.9, 2009	SCALE: 1"=300'
SHEET: 1 OF 1	J.N.: 24136
DRAWN BY: M.S.F.	CHECK BY: M.C.S.

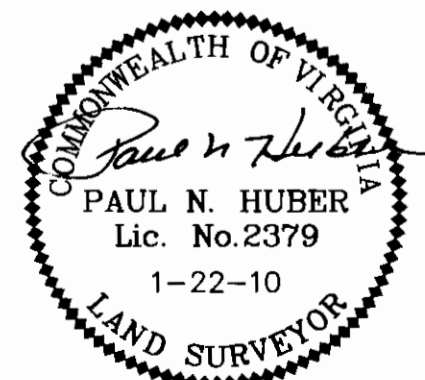

REVISED: 1-22-10 (COMMENTS)  
REVISED: 1-6-10 (COMMENTS)

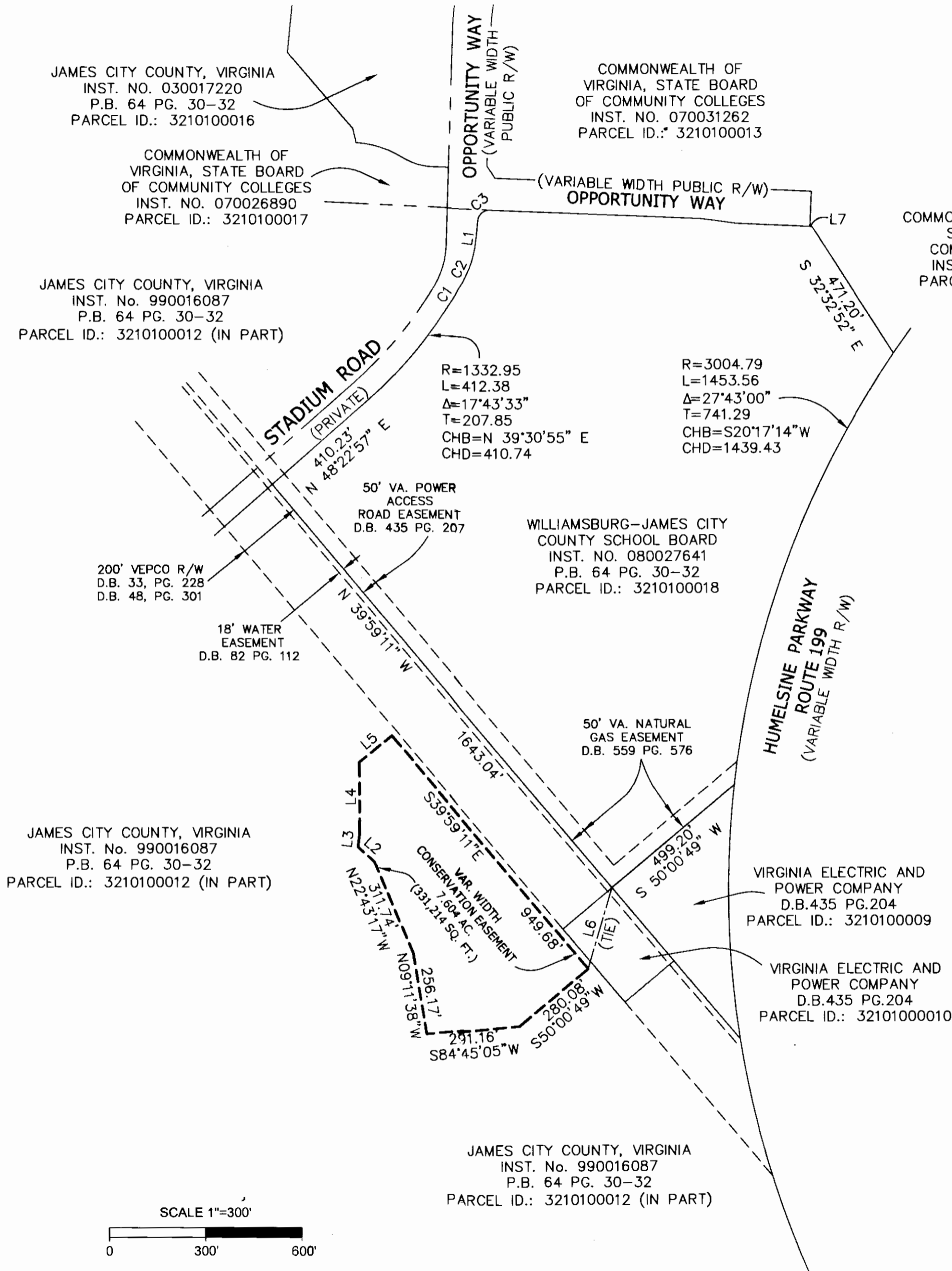

JAMES CITY COUNTY, VIRGINIA  
INST. NO. 030017220  
P.B. 64 PG. 30-32  
PARCEL ID.: 3210100016

COMMONWEALTH OF VIRGINIA, STATE BOARD OF COMMUNITY COLLEGES  
INST. NO. 070026890  
PARCEL ID.: 3210100017

JAMES CITY COUNTY, VIRGINIA  
INST. No. 990016087  
P.B. 64 PG. 30-32  
PARCEL ID.: 3210100012 (IN PART)

COMMONWEALTH OF VIRGINIA, STATE BOARD OF COMMUNITY COLLEGES  
INST. NO. 070031262  
PARCEL ID.: 3210100013

COMMONWEALTH OF VIRGINIA, STATE BOARD OF COMMUNITY COLLEGES  
INST. NO. 070031262  
PARCEL ID.: 3210100013

WILLIAMSBURG-JAMES CITY COUNTY SCHOOL BOARD  
INST. NO. 080027641  
P.B. 64 PG. 30-32  
PARCEL ID.: 3210100018

VIRGINIA ELECTRIC AND POWER COMPANY  
D.B.435 PG.204  
PARCEL ID.: 3210100009

VIRGINIA ELECTRIC AND POWER COMPANY  
D.B.435 PG.204  
PARCEL ID.: 3210100010

JAMES CITY COUNTY, VIRGINIA  
INST. No. 990016087  
P.B. 64 PG. 30-32  
PARCEL ID.: 3210100012 (IN PART)

JAMES CITY COUNTY, VIRGINIA  
INST. No. 990016087  
P.B. 64 PG. 30-32  
PARCEL ID.: 3210100012 (IN PART)

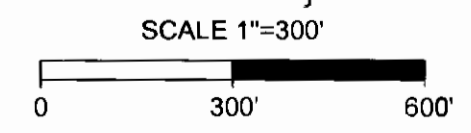

THIS DRAWING PREPARED AT THE CORPORATE OFFICE  
1001 Boulders Parkway, Suite 300 | Richmond, VA 23225  
TEL 804.200.6500 FAX 804.560.1016 www.timmons.com

YOUR VISION ACHIEVED THROUGH OURS.  
Site Development Residential Infrastructure Technology

**TIMMONS GROUP**