

100007851

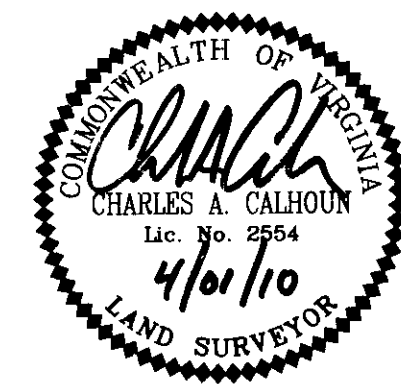

SUBDIVISION PLAT OF
SECTION FOUR
FENWICK HILLS
STONEHOUSE DISTRICT, JAMES CITY COUNTY, VIRGINIA
DATE: 12/22/09 SCALE: 1" = 250' JOB# 06-259
REV: 4/01/10 SHEET 4 OF 4

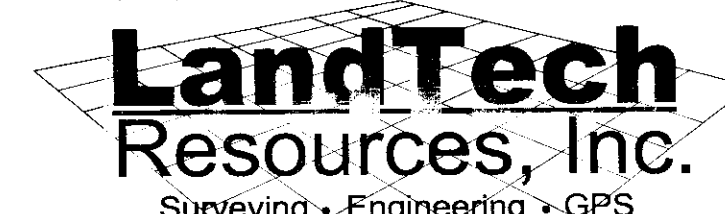

205-E Bulifants Blvd., Williamsburg, VA 23188
Phone: (757) 565-1677 Fax: (757) 565-0782
web: landtechresources.com

CURVE TABLE

CURVE	RADIUS	ARC LENGTH	CHORD LENGTH	CHORD BEARING	DELTA ANGLE	TANGENT
C1	337.06'	163.54'	161.94'	N 43°40'24" W	27°48'00"	83.41'
C2	25.00'	39.27'	35.36'	S 77°25'36" W	90°00'00"	25.00'
C3	25.00'	39.27'	35.36'	N 12°34'24" W	90°00'00"	25.00'
C4	105.00'	98.29'	94.74'	N 84°23'29" W	53°38'10"	53.08'
C5	25.00'	22.39'	21.65'	S 43°07'54" W	51°19'04"	12.01'
C6	55.00'	271.31'	68.75'	S 21°12'34" E	282°38'08"	44.04'
C7	25.00'	22.39'	21.65'	S 85°33'02" E	51°19'04"	12.01'
C8	155.00'	145.10'	139.86'	N 84°23'29" W	53°38'10"	78.36'
C9	387.06'	125.75'	125.19'	N 48°15'59" W	18°36'50"	63.43'
C10	25.00'	36.23'	33.14'	S 80°28'29" E	83°01'49"	22.13'
C11	145.00'	133.44'	128.78'	N 31°38'44" E	52°43'46"	71.87'
C12	95.00'	98.84'	94.44'	N 26°30'03" W	59°36'41"	54.42'
C13	25.00'	22.40'	21.65'	N 81°58'14" W	51°19'41"	12.01'
C14	55.01'	271.39'	68.76'	S 33°41'27" W	282°39'02"	44.03'
C15	25.00'	22.39'	21.65'	S 30°38'42" E	51°19'21"	12.01'
C16	145.00'	150.86'	144.15'	N 26°30'03" W	59°36'41"	83.06'
C17	195.00'	186.18'	179.19'	N 30°39'27" E	54°42'19"	100.87'
C18	25.00'	36.23'	33.14'	S 16°29'42" W	83°01'50"	22.13'
C19	387.06'	111.11'	110.73'	N 16°47'49" W	16°26'50"	55.94'
C20	352.05'	81.17'	80.99'	S 15°10'43" E	13°12'39"	40.77'
C21	337.06'	58.83'	58.75'	N 52°34'24" W	10°00'00"	29.49'
C22	105.00'	77.32'	75.59'	N 78°40'10" W	42°11'31"	40.51'
C23	105.00'	20.97'	20.94'	S 74°30'45" W	11°26'39"	10.52'
C24	55.00'	4.23'	4.23'	N 19°40'37" E	4°24'31"	2.12'
C25	55.00'	74.83'	69.19'	N 60°51'28" E	77°57'10"	44.50'
C26	55.00'	49.77'	48.09'	S 54°14'28" E	51°50'59"	26.74'
C27	55.00'	51.30'	49.46'	S 01°35'36" E	53°26'46"	27.69'
C28	55.00'	47.03'	45.61'	S 49°37'37" W	48°59'39"	25.06'
C29	55.00'	44.14'	42.97'	N 82°53'02" W	45°59'04"	23.34'
C30	155.00'	45.80'	45.63'	S 77°15'20" W	16°55'49"	23.07'
C31	155.00'	65.16'	64.69'	N 82°14'06" W	24°05'17"	33.07'
C32	155.00'	34.13'	34.07'	N 63°52'56" W	12°37'04"	17.14'
C33	387.06'	56.08'	56.03'	N 53°25'22" W	8°18'04"	28.09'

LINE TABLE

LINE	BEARING	DISTANCE
L1	N 56°18'23" W	5.46'
L2	S 56°18'23" E	5.46'

CONSERVATION EASEMENT LINE TABLE

LINE	BEARING	DISTANCE
E1	S 19°48'32" W	3.98'
E2	N 32°25'36" E	11.60'
E3	N 58°09'00" W	43.57'
E4	N 49°11'06" W	55.90'
E5	S 58°55'36" W	25.80'
E6	N 57°34'24" W	40.60'
E7	N 52°54'50" E	39.33'
E8	N 37°51'02" W	40.74'

CURVE TABLE

CURVE	RADIUS	ARC LENGTH	CHORD LENGTH	CHORD BEARING	DELTA ANGLE	TANGENT
C34	387.06'	69.67'	69.57'	N 44°06'57" W	10°18'46"	34.93'
C35	55.00'	25.83'	25.60'	N 85°49'07" E	26°54'22"	13.16'
C36	55.00'	49.23'	47.61'	S 55°05'26" E	51°16'32"	26.40'
C37	55.00'	41.17'	40.22'	S 08°00'47" E	42°52'46"	21.60'
C38	55.00'	55.25'	52.96'	S 42°11'53" W	57°32'34"	30.21'
C39	55.00'	48.02'	46.51'	N 84°01'26" W	50°00'48"	25.66'
C40	55.00'	51.88'	49.98'	N 32°00'02" W	54°02'00"	28.05'
C41	145.00'	7.40'	7.39'	N 54°50'43" W	2°55'20"	3.70'
C42	145.00'	66.92'	66.33'	N 40°09'44" W	26°26'38"	34.07'
C43	145.00'	59.02'	58.61'	N 15°16'47" W	23°19'17"	29.92'
C44	145.00'	17.52'	17.51'	N 00°09'25" W	6°55'26"	8.77'
C45	195.00'	51.31'	51.17'	N 10°50'37" E	15°04'37"	25.81'
C46	195.00'	67.06'	66.73'	N 28°14'03" E	19°42'14"	33.86'
C47	195.00'	67.81'	67.47'	N 48°02'53" E	19°55'27"	34.25'
C48	387.06'	64.09'	64.02'	N 20°16'36" W	9°29'16"	32.12'
C49	387.06'	47.01'	46.98'	N 12°03'11" W	6°57'34"	23.54'
C50	337.06'	104.71'	104.29'	N 38°40'24" W	17°48'00"	52.78'

City of Williamsburg & County of James City
Circuit Court: This PLAT was recorded on
4-21-2010
at 11:15 AM PM PB PG
DOCUMENT # 100007851
BETSY B. WOOLRIDGE, CLERK
Betsy B. Woolridge Clerk

4 Large-Scale Plans Recorded
herein as 100007851