

090004678

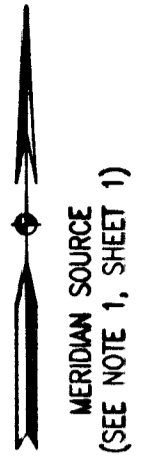
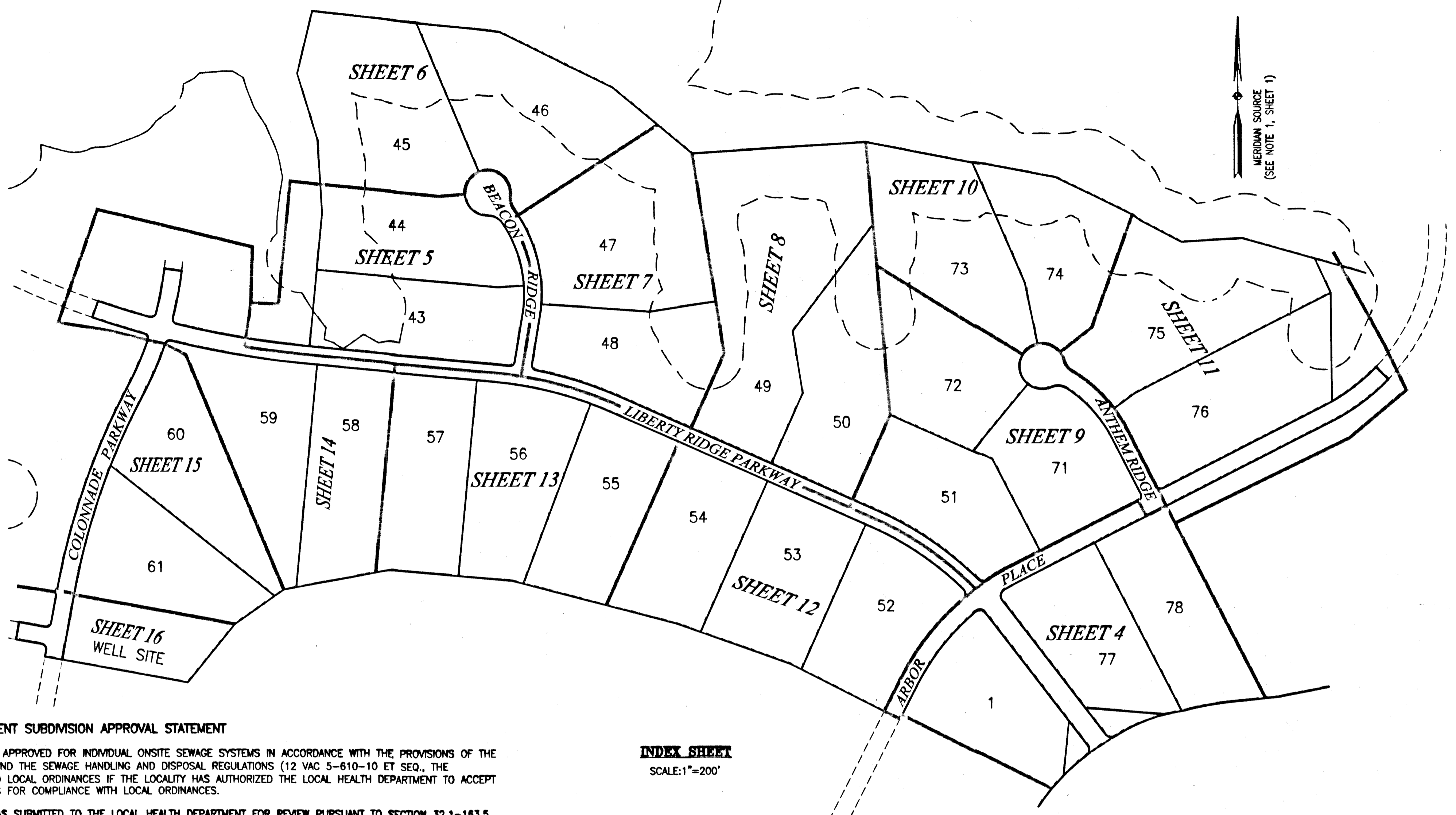

HEALTH DEPARTMENT SUBDIVISION APPROVAL STATEMENT

THIS SUBDIVISION IS APPROVED FOR INDIVIDUAL ONSITE SEWAGE SYSTEMS IN ACCORDANCE WITH THE PROVISIONS OF THE CODE OF VIRGINIA, AND THE SEWAGE HANDLING AND DISPOSAL REGULATIONS (12 VAC 5-610-10 ET SEQ., THE "REGULATIONS"), AND LOCAL ORDINANCES IF THE LOCALITY HAS AUTHORIZED THE LOCAL HEALTH DEPARTMENT TO ACCEPT PRIVATE EVALUATIONS FOR COMPLIANCE WITH LOCAL ORDINANCES.

THIS SUBDIVISION WAS SUBMITTED TO THE LOCAL HEALTH DEPARTMENT FOR REVIEW PURSUANT TO SECTION 32.1-163.5 OF THE CODE OF VIRGINIA WHICH REQUIRES THE HEALTH DEPARTMENT TO ACCEPT PRIVATE SOIL EVALUATIONS AND DESIGNS FROM AN AUTHORIZED ONSITE SOIL EVALUATOR (AOSE) OR A PROFESSIONAL ENGINEER WORKING COLLABORATIVELY WITH AN AOSE FOR RESIDENTIAL DEVELOPMENT. THE DEPARTMENT IS NOT REQUIRED TO PERFORM A FIELD CHECK OF SUCH EVALUATIONS. THIS SUBDIVISION WAS CERTIFIED AS BEING IN COMPLIANCE WITH THE BOARD OF HEALTH'S REGULATIONS BY: HAROLD L. MATHEWS, AOSE #16 PH. 1-800-287-9604.

THIS SUBDIVISION APPROVAL IS ISSUED IN COMPLIANCE WITH THAT CERTIFICATION.

PURSUANT TO SECTION 360 OF THE "REGULATIONS", THIS APPROVAL IS NOT AN ASSURANCE THAT SEWAGE DISPOSAL SYSTEM CONSTRUCTION PERMITS WILL BE ISSUED ON ANY LOT IN THE SUBDIVISION UNLESS THAT LOT IS SPECIFICALLY IDENTIFIED AS HAVING AN APPROVED SITE FOR AN ONSITE SEWAGE DISPOSAL SYSTEM, AND UNLESS ALL CONDITIONS AND CIRCUMSTANCES ARE PRESENT AT THE TIME OF APPLICATION FOR A PERMIT AS ARE PRESENT AT THE TIME OF THIS APPROVAL. THIS SUBDIVISION MAY CONTAIN LOTS THAT DO NOT HAVE APPROVED SITES FOR ONSITE SEWAGE SYSTEMS.

THIS SUBDIVISION APPROVAL IS ISSUED IN RELIANCE UPON THE CERTIFICATION THAT APPROVED LOTS ARE SUITABLE FOR "TRADITIONAL SYSTEMS" UNLESS OTHERWISE STATED. HOWEVER, ACTUAL SYSTEM DESIGN MAY BE DIFFERENT AT THE TIME CONSTRUCTION PERMITS ARE ISSUED.

THE APPROVED ONSITE SEWAGE SYSTEM SITES ARE SHOWN ON THIS PLAT. IF SAID SITES ARE NOT SHOWN ON THIS PLAT, THOSE SITES ARE SHOWN ON A SEPARATE PLAT ON FILE WITH THE PENINSULA HEALTH DISTRICT, WILLIAMSBURG AREA OFFICE, 1126 PROFESSIONAL DR., WILLIAMSBURG, VA 23185.

SEE SHEET 1 FOR NOTES AND CERTIFICATIONS
SEE SHEET 3 FOR LINE, CURVE AND AREA TABLES

INDEX SHEET
SCALE: 1"=200'

16 Large/Small Plat(s) Recorded
herewith as # 090004678

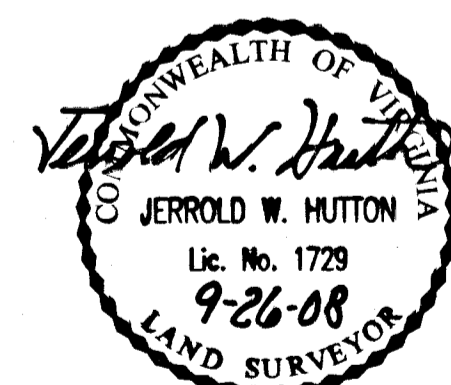

**SUBDIVISION PLAT
OF
LIBERTY RIDGE**

SECTION 1
JAMES CITY COUNTY, VIRGINIA
SCALE: AS NOTED
JANUARY 28, 2008
REVISED: SEPTEMBER 26, 2008

COMMONWEALTH OF VIRGINIA
CITY OF WILLIAMSBURG & COUNTY OF JAMES CITY CIRCUIT COURT, THIS 12 DAY OF February, 2008.
THE PLAT SHOWN HEREON WAS PRESENTED AND ADMITTED TO THE RECORD AS THE LAW DIRECTS. AT 10:41 AM/PM INSTRUMENT # 090004678

TESTE: *Betsy B. Woolridge*
BETSY B. WOOLRIDGE, CLERK
By *Claudia M. Binkholz, Dep. Clerk*



ROUSE-SIRINE ASSOCIATES, LTD.
LAND SURVEYORS & MAPPING CONSULTANTS
333 OFFICE SQUARE LANE
VIRGINIA BEACH, VIRGINIA 23462
TEL. (757)490-2308; FAX: (757)499-9136
www.rouse-sirine.com