

S:\Jobs\663215D-VentureEast\dwg\Sun\Plat\Phase 07 Unit 225\663215D Condo Unit 225 02 2nd FLOOR PLAN.dwg, 6/16/2008 11:45:36 AM, rob.mann

080021555

NOTES:

1. COMMON ELEMENTS, LIMITED COMMON ELEMENTS AND UNITS ARE SUBSTANTIALLY COMPLETE.
2. ALL BUILDING FLOOR PLANS AND DETAILS SHOWN ARE PER ARCHITECTURAL PLANS PROVIDED TO AES CONSULTING ENGINEERS BY THE DEVELOPER.
3. THE LOWER (HORIZONTAL) BOUNDARY OF EACH UNIT AS SHOWN IN THE PLAN IS THE HORIZONTAL PLANE OF THE UPPER SURFACE OF THE CONCRETE FLOOR SLAB.
4. THE UPPER (HORIZONTAL) BOUNDARY IS THE PLANE OF THE LOWER SURFACE OF THE SUSPENDED ACOUSTIC CEILING OF THE UNIT.
5. THE VERTICAL (SIDE) BOUNDARIES OF THE UNIT SHALL BE THE VERTICAL PLANE OF THE CENTERLINE OF THE INTERIOR WALL DIVIDING ANY TWO UNITS AND/OR THE OUTSIDE FACE OF THE EXTERIOR WALL OF THE PERIMETER UNIT, EXTENDED TO INTERSECTIONS WITH EACH OTHER AND WITH THE UPPER AND LOWER UNIT BOUNDARIES.
6. LOWER, UPPER AND SIDE BOUNDARIES ARE MORE FULLY DESCRIBED IN THE DECLARATION OF CONDOMINIUM.
7. THE INTERIOR WALLS AND ELEMENTS AS SHOWN HEREON WERE TAKEN DIRECTLY FROM ARCHITECTURAL DRAWINGS PROVIDED BY THE DEVELOPER AND ARE INTENDED FOR REFERENCE PURPOSES ONLY. INTERIOR PARTITION WALLS AND ELEMENTS HAVE NOT BEEN FIELD VERIFIED AND ARE NOT SHOWN.

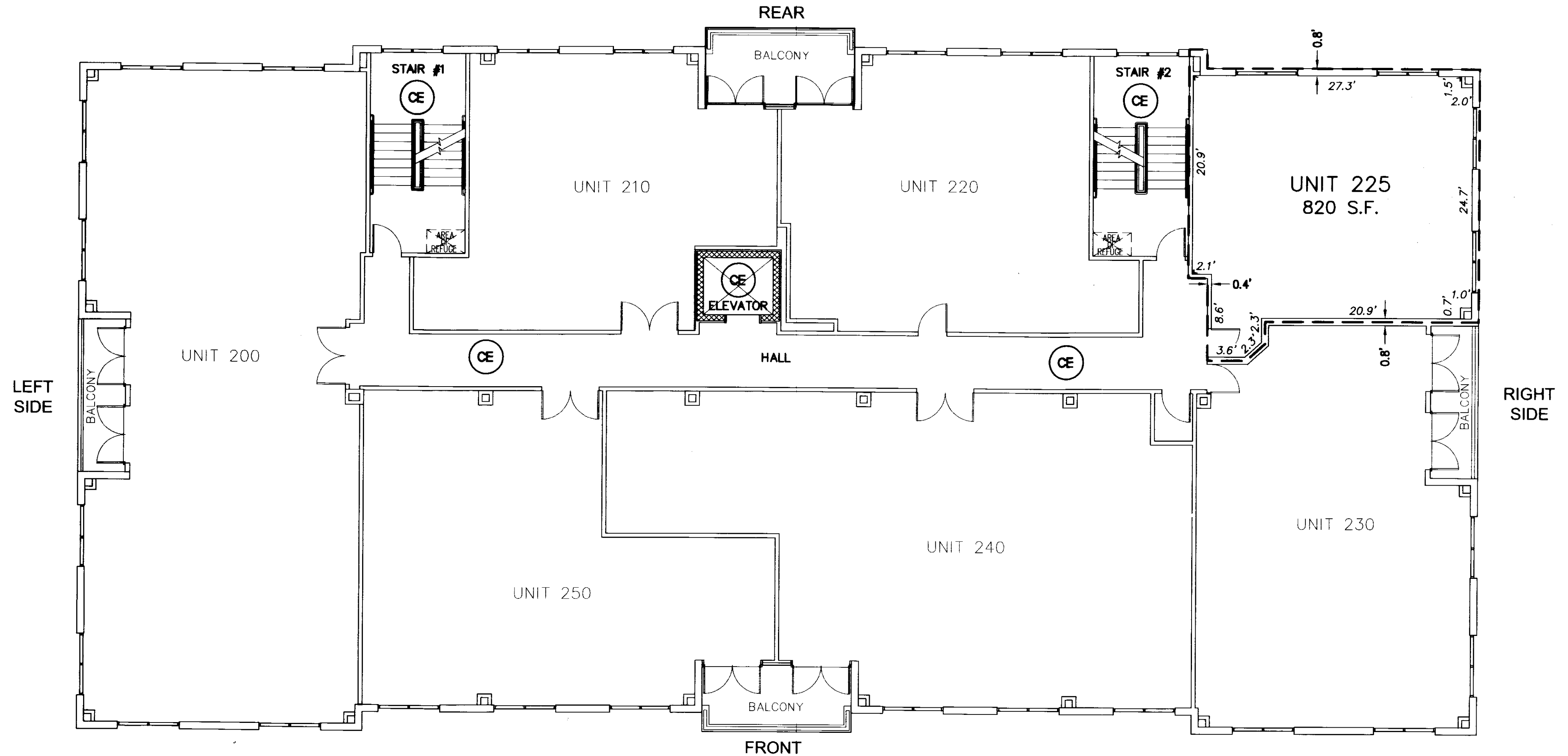
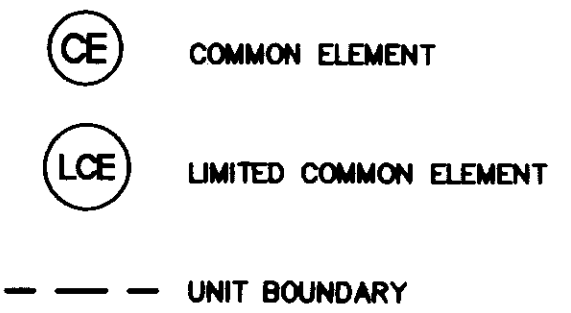

SECOND FLOOR PLAN

NOT TO SCALE

Large/Small Plat(s) Recorded herewith as # 080021555

"EXHIBIT 1"

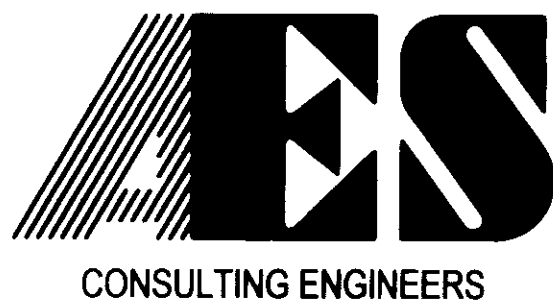

5248 Olde Towne Road, Suite 1
Williamsburg, Virginia 23188
(757) 253-0040
Fax (757) 220-8994

WILLIAMSBURG • RICHMOND • GLOUCESTER • FREDERICKSBURG

PLAN OF CONDOMINIUM
PATRIOT PARK, A CONDOMINIUM
PHASE 7, UNIT 225
OWNER/DEVELOPER: PATRIOT DEVELOPMENT ASSOCIATES, LLC
BERKELEY DISTRICT JAMES CITY COUNTY VIRGINIA

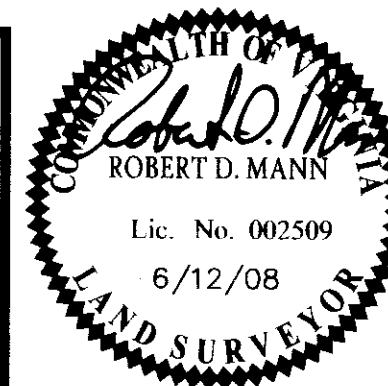

No.	DATE	REVISION / COMMENT / NOTE

City of Williamsburg & County of James City
Circuit Court: This PLAT was recorded on
at 3:15 AM PM, PG. 27 August 2008
DOCUMENT # 080021555
BETSY B. WOOLRIDGE, CLERK
Betsy B. Woolridge Clerk

DESIGNED BY	DESIGNED DATE	DRAWN BY	DRAWN DATE
AES		AWT	
Scale		Date	
NTS		6/12/08	
Project No.	6632-6-15D		
Drawing No.	2 of 5		

DESIGNED BY	DESIGNED DATE	DRAWN BY	DRAWN DATE
AES		AWT	
Scale		Date	
NTS		6/12/08	
Project No.	6632-6-15D		
Drawing No.	2 of 5		