

#070017438

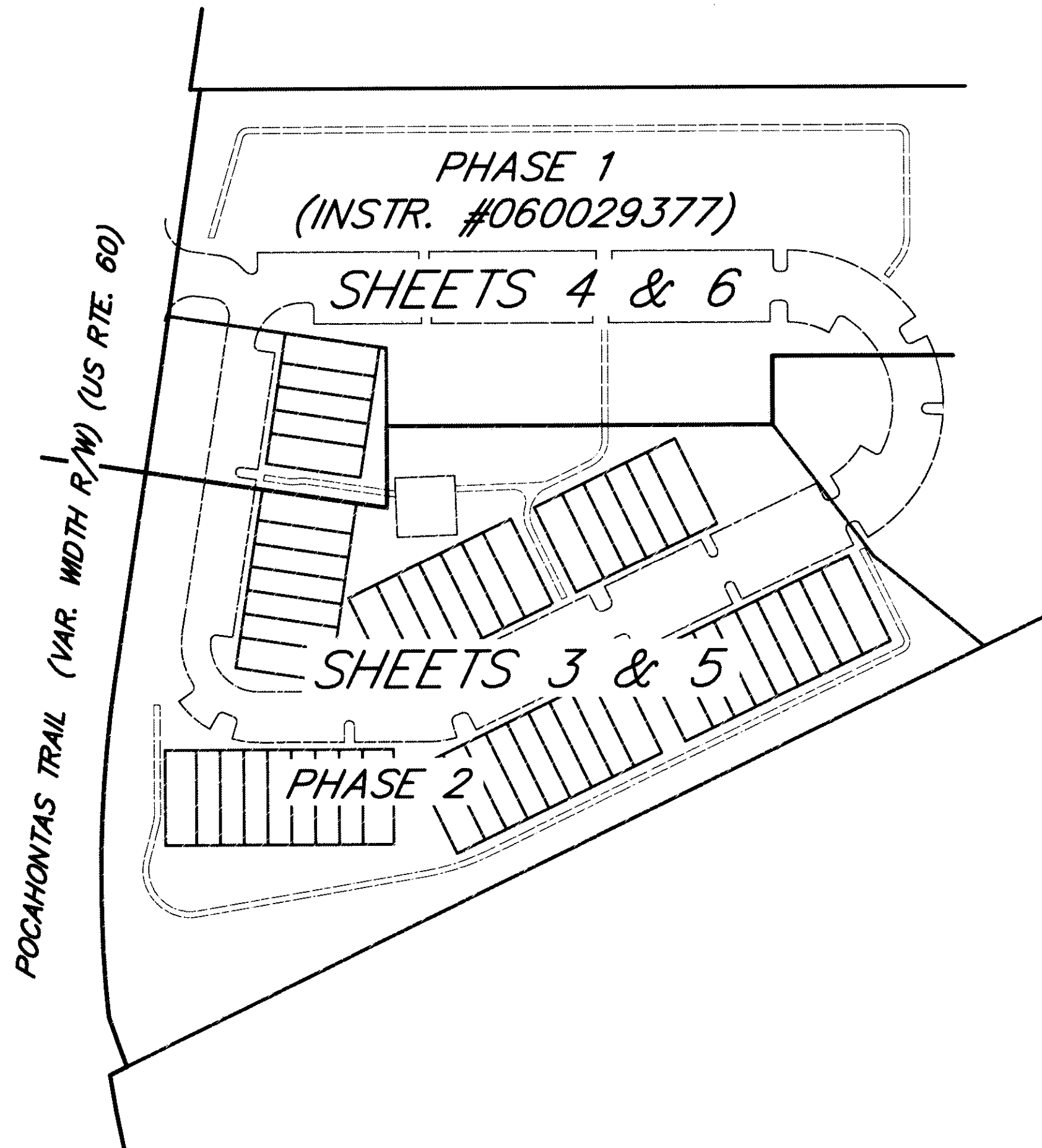

VIRGINIA STATE PLANE COORDINATE
SYSTEM, SOUTH ZONE, NAD 83/86

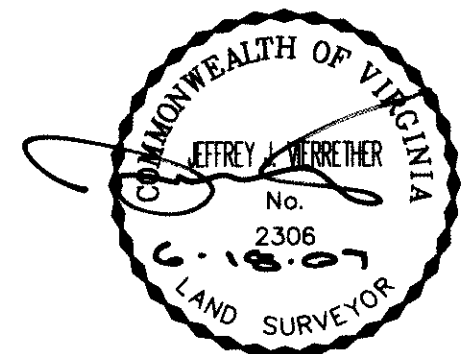

SUBDIVISION PLAT
OF
POCAHONTAS SQUARE, PHASE 2
JAMES CITY COUNTY, VIRGINIA
MAY 2, 2007

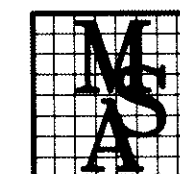

MSA, P.C.
Landscape Architecture · Planning · Surveying
Engineering · Environmental Sciences
5033 ROUSE DRIVE, VIRGINIA BEACH, VA 23462-3708
PHONE (757) 490-9264 · FAX (757) 490-0634

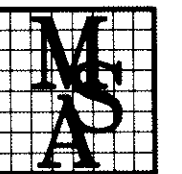

GRAPHIC SCALE
1" = 100'

6 (larger than Plat) Recorded
herewith as 070017438

City of Williamsburg & County of James City
Circuit Court: This PLAT was recorded on
19 June 2007
at 9:52 AM/PM PB PG
DOCUMENT # 070017438
BETSY B. WOOLRIDGE, CLERK
Betsy B. Woolridge Clerk

SHEET INDEX

SEE SHEET 1 OF 6 FOR NOTES AND CERTIFICATES