

#070006615

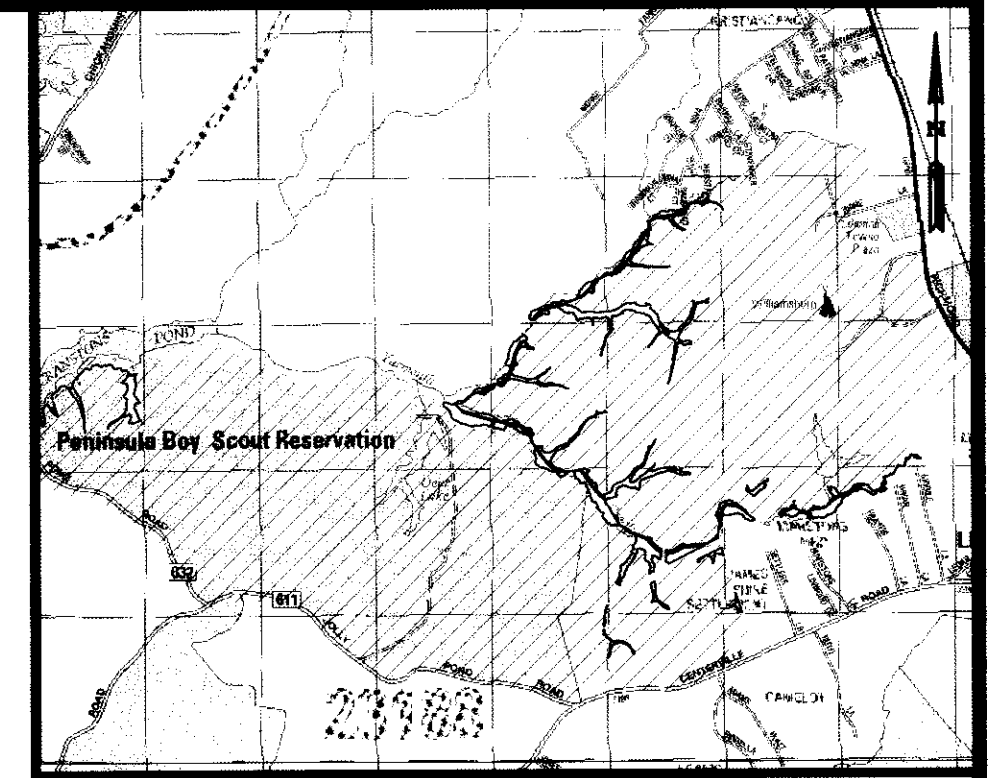

VICINITY MAP  
SCALE 1"=3000'

NOTE:  
THE LINES SHOWN ON THIS MAP ARE NOT INTENDED TO BE PROPERTY LINES AND ARE SHOWN ONLY TO DESIGNATE THE PRESERVATION AREA.

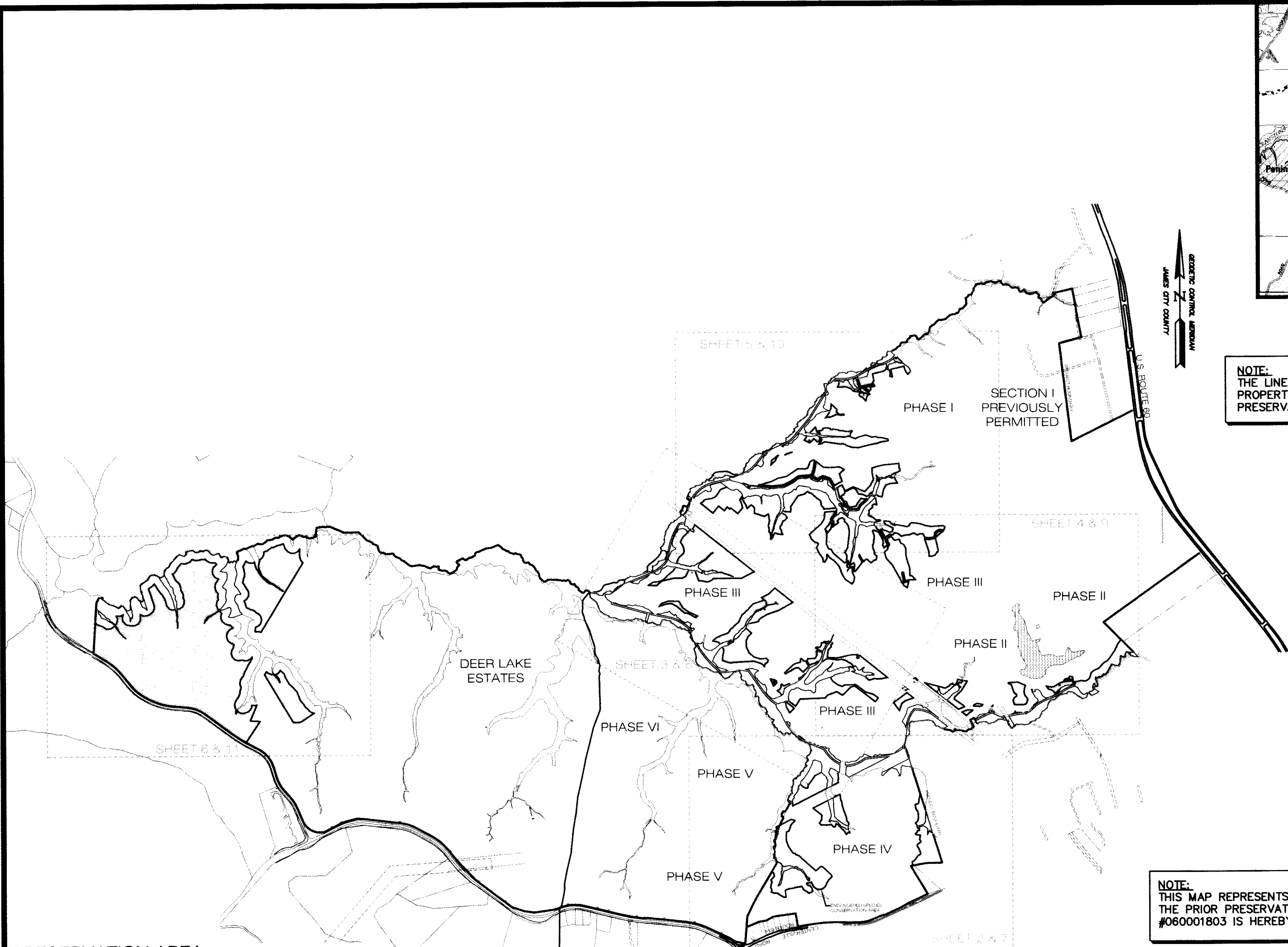

NOTE:  
THIS MAP REPRESENTS THE CURRENT PRESERVATION AREAS. THE PRIOR PRESERVATION MAP RECORDED JANUARY 25, 2006 #060001803 IS HEREBY VOIDED.

PRESERVATION AREA	
BUFFERS ADJACENT TO WETLANDS	143.69 ACRES
NON-RPA UPLAND BUFFER ADJACENT TO STREAM CHANNELS	19.40 ACRES
WETLANDS	47.10 ACRES
ENDANGERED SPECIES CONSERVATION AREA	1.05 ACRES
<b>TOTAL ACRES</b>	<b>211.24 ACRES</b>
STREAM CHANNEL	12.090 LF
<b>TOTAL LF</b>	<b>12,090 LF</b>

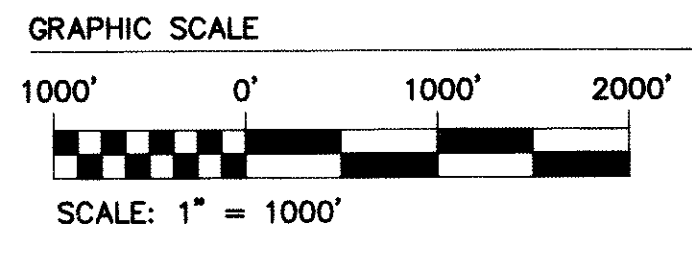

STATE OF VIRGINIA  
CITY OF WILLIAMSBURG & COUNTY OF JAMES CITY CIRCUIT COURT. THIS 8<sup>th</sup> DAY OF March, 2007.  
THE MAP SHOWN HEREON WAS PRESENTED AND ADMITTED TO THE RECORD AS THE LAW DIRECTS. © 8:51 AM/PM  
INSTRUMENT # 070006615  
TESTE: Betsy B. Woolridge  
BETSY B. WOOLRIDGE, CLERK  
By Claudia H. Binkholz, Esq. Clerk

S:\Jobs\888111-1-Preservation Map and Exhibit-DEQ\dwg\Cad\MAP SHOWING PRESERVATION AREAS.dwg, 3/2/2007 1:35:18 PM, roy.pennington

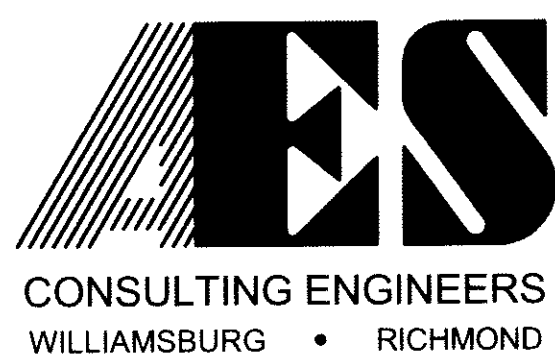

5248 Olde Towne Road, Suite 1  
Williamsburg, Virginia 23188  
(757) 253-0040  
Fax (757) 220-8994

MAP SHOWING PRESERVATION AREAS  
LOCATED ON THE PROPERTY OWNED BY  
COLONIAL HERITAGE  
STONEHOUSE DISTRICT COUNTY OF JAMES CITY VIRGINIA

No.	DATE	REVISION / COMMENT / NOTE	REVISED BY	REVIEWED BY

Designed AES	Drawn AES
Scale 1"=1000'	Date 01/15/2007
Project No. 8881-11-O	
Drawing No. 1 of 28	